



Purchasing Division

ADDENDUM NO. 2

DATE: April 10, 2020
FROM: City of Grand Junction Purchasing Division
TO: All Offerors
RE: 2020 Contract Street Maintenance – Asphalt Overlays IFB-4775-20-DH

Offerors responding to the above referenced solicitation are hereby instructed that the requirements have been clarified, modified, superseded and supplemented as to this date as hereinafter described.

Please make note of the following clarifications:

1. Q. Regarding the drawing that was supplied by River City for the proposed Storage and Transfer buildout. Can the City please provide a drawing with existing contour elevations vs proposed.

A. See attached drawings/clarification. Also, any excess materials developed can be wasted or stockpiled on-site. No haul off will be necessary.

The original solicitation for the project noted above is amended as noted.

All other conditions of subject remain the same.

Respectfully,

A handwritten signature in black ink, appearing to read "Duane Hoff Jr.", written over a horizontal line.

Duane Hoff Jr., Senior Buyer
City of Grand Junction, Colorado

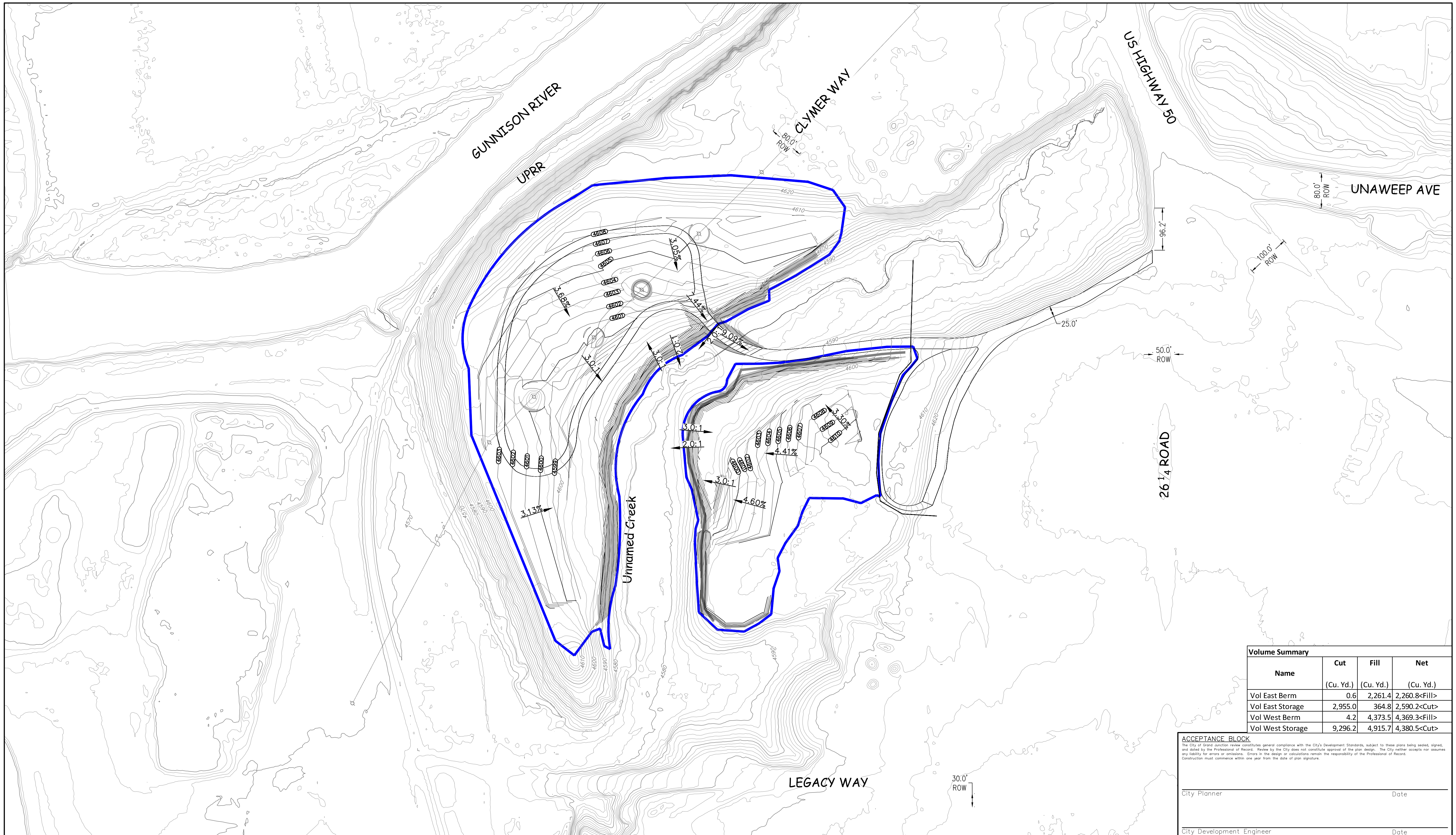

Volume Summary			
Name	Cut (Cu. Yd.)	Fill (Cu. Yd.)	Net (Cu. Yd.)
Vol East Berm	0.6	2,261.4	2,260.8<Fill>
Vol East Storage	2,955.0	364.8	2,590.2<Cut>
Vol West Berm	4.2	4,373.5	4,369.3<Fill>
Vol West Storage	9,296.2	4,915.7	4,380.5<Cut>

ACCEPTANCE BLOCK
 The City of Grand Junction review constitutes general compliance with the City's Development Standards, subject to these plans being sealed, signed, and dated by the Professional of Record. Review by the City does not constitute approval of the plan design. The City neither accepts nor assumes any liability for errors or omissions. Errors in the design or calculations remain the responsibility of the Professional of Record. Construction must commence within one year from the date of plan signature.

City Planner _____ Date _____

City Development Engineer _____ Date _____

UNCC
800.922.1987
www.uncc.org

Know what's below.
Call before you dig.

CALL 2 BUSINESS DAYS IN ADVANCE BEFORE YOU DIG, GRADE, OR EXCAVATE FOR THE MARKING OF UNDERGROUND MEMBER UTILITIES.

CONTOUR INTERVAL = 1 FOOT
ORIGINAL SHEET SIZE: 22 x 34

REVISIONS			
NO.	DATE	DESCRIPTION	BY

PRELIMINARY

RIVER CITY CONSULTANTS
 744 Horizon Court, Suite 110
 Grand Junction, CO 81505
 Phone: 970.241.4722
 Fax: 970.241.9841
 www.rcwest.com

PROJECT #1108-005 DATE ISSUED: 2020.04.09
 DRAWN BY: MJK HORIZ: AS SHOWN
 CHECKED BY: IDG VERT: N/A

CITY OF GRAND JUNCTION

MATERIALS STORAGE AND TRANSFER

GRADING PLAN

C1.5