

RECORDER'S STAMP



KNOW ALL MEN BY THESE PRESENTS, That I,

SILMON SMITH

of the County of Mesa
and State of Colorado, for the consideration of Ten Dollars and
other good and valuable consideration Dollars, in hand
paid, hereby sell and quit claim to The City of Grand Junction
and the County of Mesa

of the County of
and State of Colorado, the following real property, situate in the
County of Mesa

and State of Colorado, to-wit:

The Southeast quarter of the Northwest quarter and the Southwest
quarter of the Northeast quarter of Section 32, Township 1 North,
Range 1 East, Ute Meridian except beginning at a point on the South
line of the Southeast quarter of the Northwest quarter, Section 32
Township 1 North, Range 1 East, Ute Meridian which is South 89°54'
West 267.30 feet from the Southeast corner of said Southeast quarter
Northwest quarter, Section 32, thence, South 89°54' West 445.8 feet
along said South line of the Southeast quarter of the Northwest quar-
ter, Section 32, thence, North 54°54' West 742.9 feet parallel to the
center line of the Grand Junction Northwest-Southeast Airport runway
projected to the West line of said Southeast quarter Northwest quarter,
Section 32, thence, North 00°18' East 891.16 feet to Northwest corner
of said Southeast quarter Northwest quarter, Section 32, thence,
North 89°48' East 464.18 feet along the North line of said Southeast
quarter Northwest quarter, Section 32, thence, South 54°54' East
1236.94 feet parallel to the center line of the Grand Junction North-
west-Southeast Airport runway projected; thence, South 35°06' West
743.03 feet to the point of beginning. Said tract containing 49.42
acres. Reserving unto the grantor all oil, gas and mineral rights,
with right to prospect for, drill, mine and remove the same with
reasonably necessary drill sites with ingress and egress and subject
to the limitations in the Subordination Agreement, of even date here-
with.

with all its appurtenances.

Signed and delivered this 13th day of June, A. D. 19 61

In the presence of

Silmon Smith [SEAL]

[SEAL]

[SEAL]

STATE OF COLORADO, }
County of Mesa } ss.

The foregoing instrument was acknowledged before me this 13th day of June
1961, by* SILMON SMITH

My commission expires July 35, 1961

. Witness my hand and official seal.

Mildred A. Miller
Notary Public.

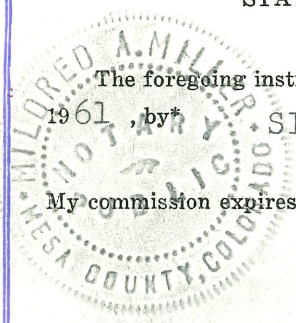

AMT. OF FEE IMPOSED... COLLECTED... EXCUSSED... PROTESTED

*If by natural person or persons here insert name or names; if by person acting in representative or official capacity or as attorney-in-fact, then insert name of person as executor, attorney-in-fact or other capacity or description; if by officer of corporation, then insert name of such officer or officers, as the president or other officers of such corporation, naming it.—Statutory Acknowledgment, Session 1927.

8/10/61

Airport
793787

No.

QUIT CLAIM DEED

~~INDEXED~~ *mb*

Silmon Smith

TO

City of Grand Junction, Colo.

Airport

STATE OF COLORADO, **MESA** } ss.
County of

I hereby certify that this instrument was filed
for record in my office, at *345*
o'clock *P*, **JUN 13 1961**, 19
and is duly recorded in book *805*
page *31*

Annice M. Dunston
Recorder.
By *Annice M. Dunston*
Deputy.

Fees, \$ *1.25* *55*
14

6/21/61

SUBORDINATION AGREEMENT

THIS AGREEMENT, Made and entered into this 13th day of June ~~April~~ 1961 by and between SILMON SMITH, hereinafter referred to as "First Party" and THE CITY OF GRAND JUNCTION AND THE COUNTY OF MESA, COLORADO, hereinafter referred to as "Second Party".

WITNESSTH:

That whereas, First Party is the owner of the oil, gas and minerals in and to that certain tract of land situate in the County of Mesa, State of Colorado and more specifically described as follows:

The Southeast quarter of the Northwest quarter, Section 32, Township 1 North, Range 1 East, Ute Meridian, and the Southwest quarter of the Northeast quarter, Section 32, Township 1 North, Range 1 East, Ute Meridian, containing 80 acres.

and

WHEREAS, Second Party is the owner and operator of Walker Field, a city-county airport, hereinafter referred to as the "Airport", situated in the County of Mesa, State of Colorado, which land above described has been acquired as a part of the airport property; and

WHEREAS, it is deemed necessary that the land above described be and remain free and clear of any structure, or other object, which is or would constitute an obstruction or hazard to the flight of aircraft, of landing and taking off at said airport.

NOW THEREFORE, for valuable considerations paid by Second Party to First Party, the receipt and sufficiency of which is hereby acknowledged, First Party for himself, his heirs, successors

8/6-m

793788

~~INDEXED mb~~

COUNTY OF MESA)
STATE OF COLORADO)

BOOK

346
Airport

Land

Salmon Smith

STATE OF COLORADO } ss

County of MESA
I hereby certify that this instrument was
Filed for record

JUN 13 1961

at 346 in Book 805 of 32
ANNIE M. DUNSTON, County Clerk & Recorder
By Barbara Lemay Deputy

City Hall
375

The foregoing instrument was acknowledged before me this

day of April, 1961, by GILL A. AIRPORT as Airport Manager.

for the City of Grand Junction and County of Mesa, Colorado.

My commission expires: December 1962

Richard L. ...

William J. ...

Notary Public

NE cor SW 1/4 NE 1/4
SEC 32

CLEAR ZONE APPROACH AREA
SE END OF NW-SE RUNWAY
WALKER FIELD AIRPORT

EXHIBIT "A"

State of Colorado)
County of Mesa) ss.

Recorded at 3:47
Reception No. 793789
10 o'clock P.M. June 13 1961
Annie M. Dunston
Recorder Annie M. Dunston

BOOK 805 PAGE 35

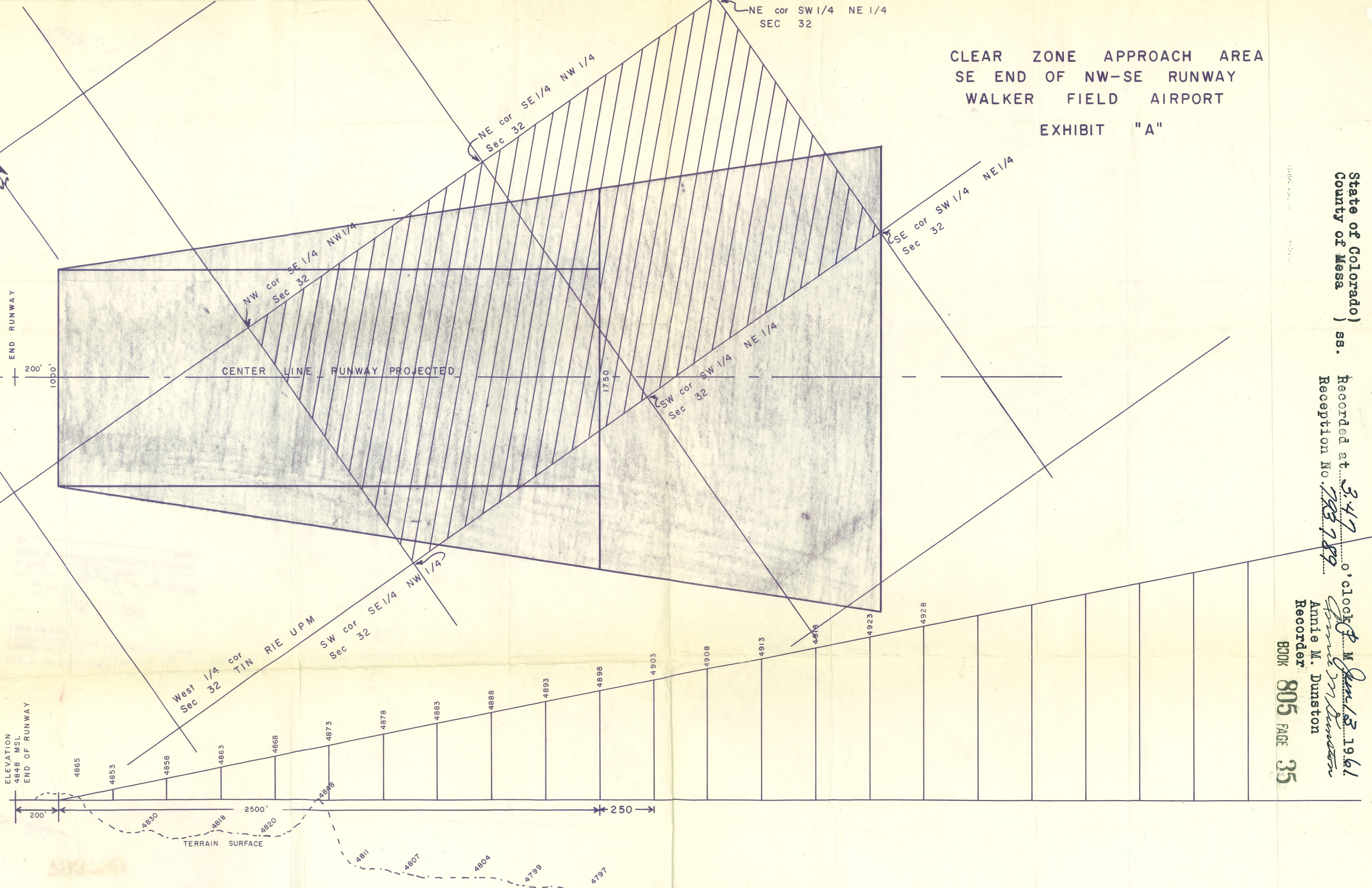

Vertical Scale 1/10 horizontal
Horizontal Scale 0 100 200 300 400 800 1200

Hatched Area Land to be acquired from Smith
Shaded Area Instrument Clear Zone