

1 LONGITUDINAL SECTION
SCALE: 1/8" = 1'-0"

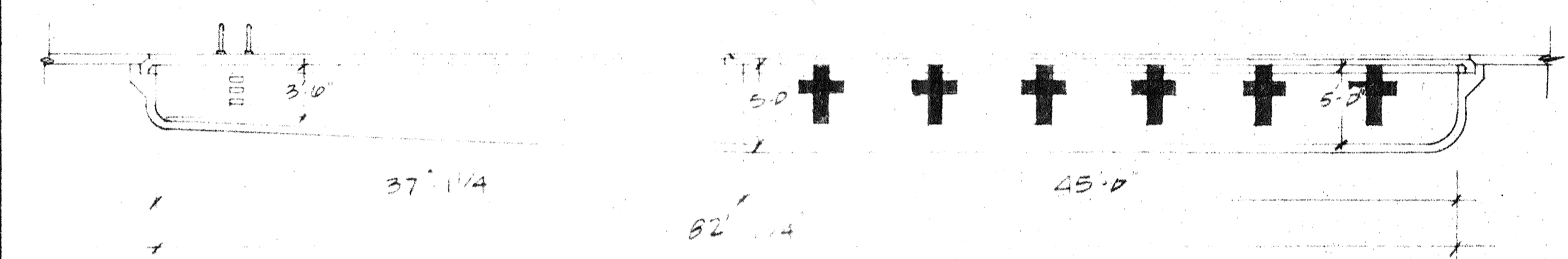

2 TRANSVERSE SECTION
SCALE: 1/8" = 1'-0"

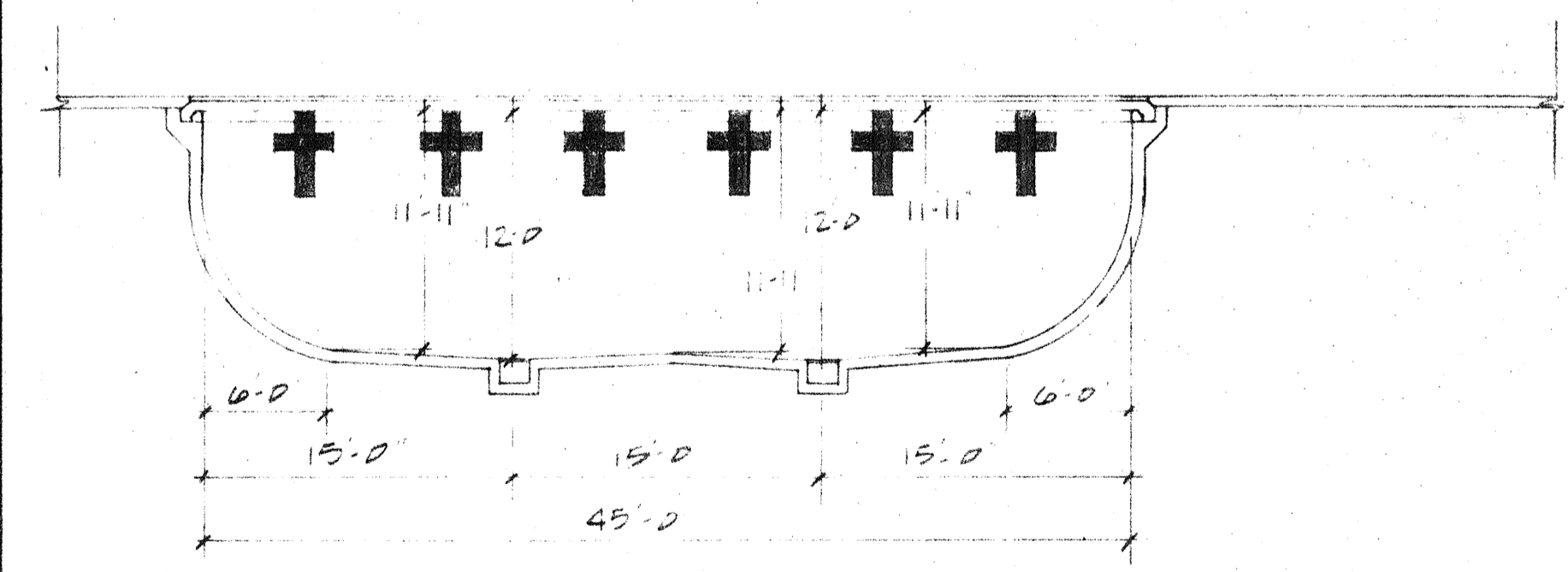

3 TRANSVERSE SECTION
SCALE: 1/8" = 1'-0"

8" PERIMETER OVERFLOW LINE & ELEV. (-) 1'-0 3/8"
6" x 8" REDUCING BUSHING
HYDROANALYZER & FLOWCELL
SODA ASH FEEDER W/ 50 GAL. SOLUTION TANKS & AGITATOR.
20 AMP, 110V, 1Ø, 60 ~ RECEPTACLE FOR HYDROANALYZER.
3/4" LINE FROM HYDROANALYZERS FLOWCELL.
8" MAIN DRAIN GATE VALVE.
LADDER RUNG
2" FRESH WATER MAKE-UP LINE.
* VAC AIR RELEASE & VACUUM CONTROL PANEL.
LAARS GAS FIRED HEATER MODEL AL-1100 1,100,000 BTU/HR.
STANCHION POST (5 REQ'D)
3/4" POLYETHYLENE SAFETY ROPE (22'-0" REQ'D)
40 SQ. FT. VACUUM SAND FILTER
6" x 8" REDUCING BUSHING
LADDER RUNG
3/4" ROPE HOOK TERMINAL (2 REQ'D)
MARLOW RECIRCULATING PUMP & MOTOR, MODEL 6T56, 15 HP, 230/460 V, 3Ø, 60 ~, 1750 RPM, RATED FOR 697.5 GPM @ 20' TDH.

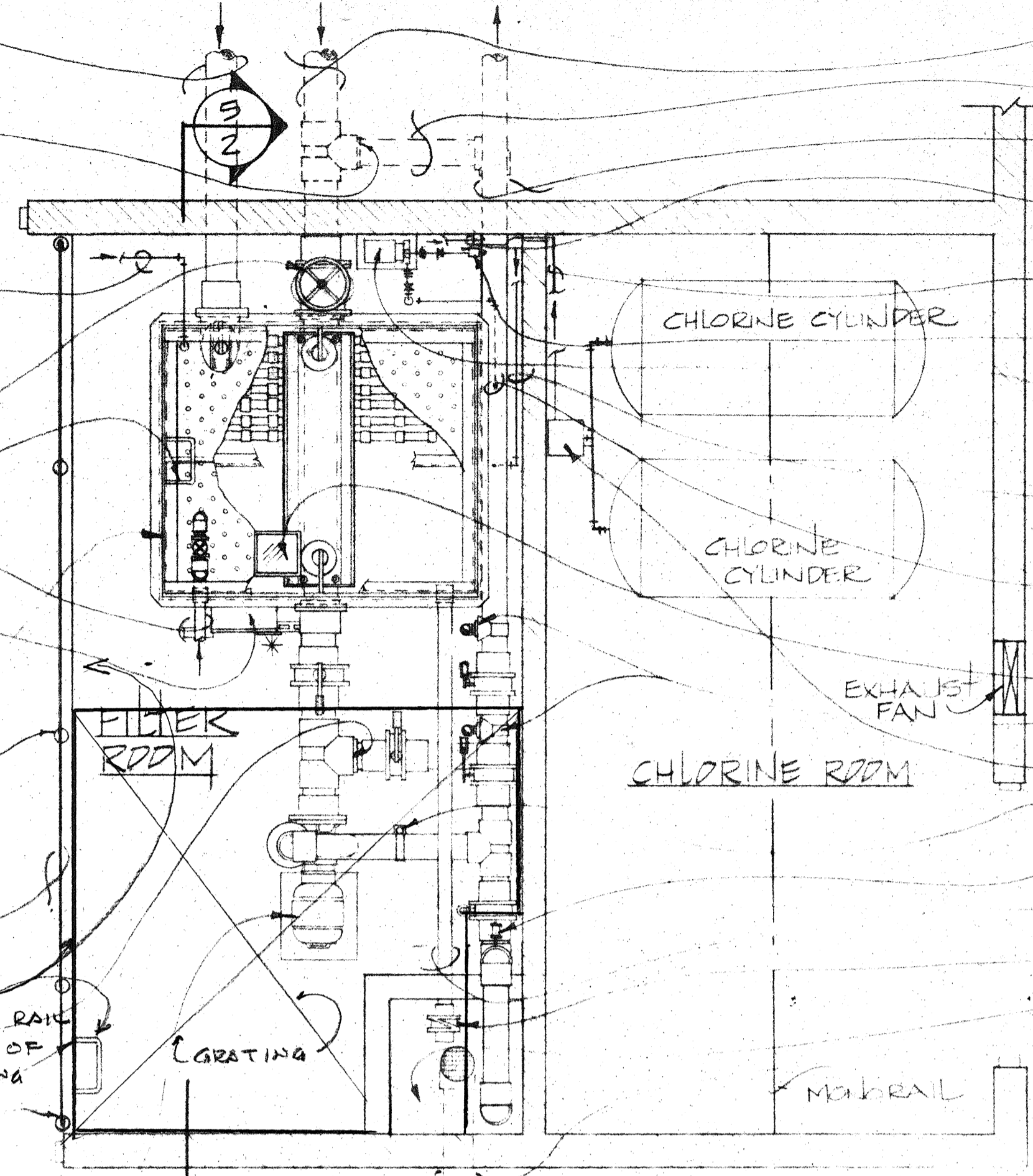

4 FILTER ROOM PLAN
SCALE: 3/8" = 1'-0"

8" MAIN DRAIN LINE & ELEV. = (-) 5'-5 3/8"
6" BYPASS TO DRAIN POOL
6" RETURN TO POOL LINE & ELEV. = (-) 1'-11 1/16"
SODA ASH CHEMICAL LINE FROM FEEDER TO TAP IN RETURN
GAS CHLORINE LINE
CHLORINE EJECTOR
CHLORINE BOOSTER PUMP, AURORA MODEL 135-1505, 1 HP, 1Ø, 60 ~, RATED FOR 195 GPM @ 100' TDH.
3/4" SAMPLE LINE TO HYDROANALYZER'S FLOWCELL (TAP BOTTOM OF RETURN LINE)
BOOSTER PUMP SUCTION LINE (TAP BOTTOM OF RETURN LINE)
PLEXI-GLASS VIEW PORT
HEATER CONNECTIONS
GAS CHLORINATOR
FLOWMETER
SIGHT GLASS
3" FILTER OVERFLOW LINE
3" CHECK VALVE
3'-0" x 3'-0" SUMP PIT
GRAVITY DRAIN TO DISPOSAL POINT FOR 697.5 GPM FOR 2 TO 4 MINUTES.

NOTE: VAC AIR RELEASE & VACUUM CONTROL PANEL ASSEMBLY 5V, 60V, 2 AMP. CIRCUIT POWER TO BE CONNECTED TO 115 V ELECTRICAL HEAD CONTACTOR MAIN PUMP & MOTOR. INTER. ELECTRICAL WIRING & CONNECTIONS TO BE MADE BY CONTRACTOR.

NOTE: THE SODA ASH FEEDER & BOOSTER PUMP RELAY ARE EACH ACTUATED BY THE HYDROANALYZER.

3/4" SAMPLE LINE TO HYDROANALYZER'S FLOWCELL (TAP BOTTOM OF RETURN LINE).
BOOSTER PUMP SUCTION LINE (TAP BOTTOM OF RETURN LINE).
CHLORINE BOOSTER PUMP AURORA MODEL 135-1505, 1 HP, 1Ø, 60 ~, RATED FOR 195 GPM @ 100' TDH.
BOOSTER PUMP DISCHARGE LINE TO CHLORINE EJECTOR.
CHLORINE EJECTOR
6" RETURN LINE & ELEV. (-) 1'-11 1/16"
7'-0 3/8" x 6'-0 3/8" x 9'-0" DEEP VACUUM SAND FILTER W/ 40 SQ. FT. OF FILTER AREA.
8" PERIMETER OVERFLOW LINE & ELEV. (-) 1'-9 3/8"
8" MAIN DRAIN LINE & ELEV. (-) 5'-5 3/8"
8" MAIN DRAIN GATE VALVE
6" BYPASS TO DRAIN POOL
9'-0 3/8" x 8'-0 3/8" x 1'-6" THICK CONCRETE SLAB

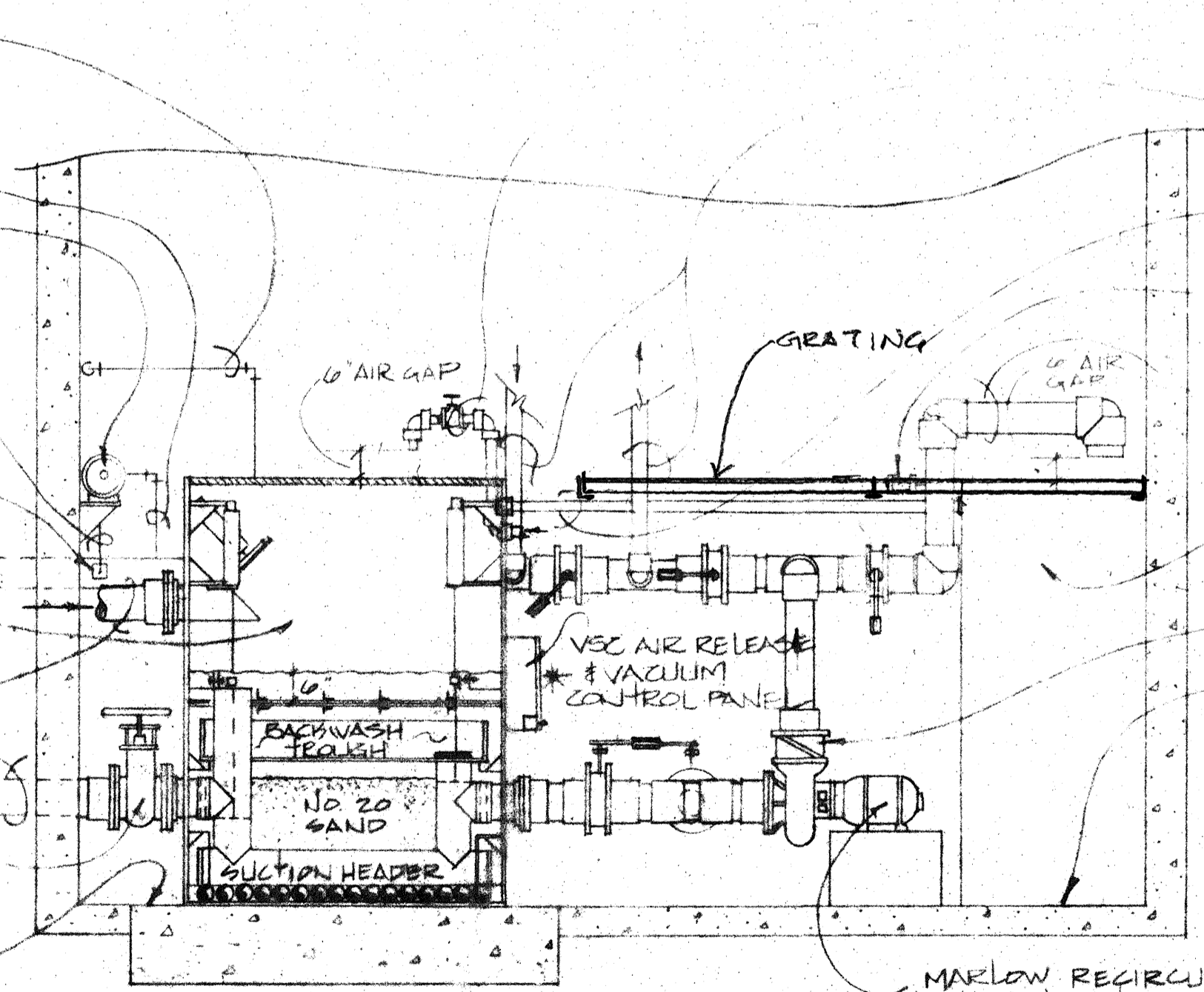

5 FILTER ROOM ELEVATION
SCALE: 3/8" = 1'-0"

MARLOW RECIRCULATING PUMP & MOTOR, MODEL 6T56, 15 HP, 230/460 V, 3Ø, 60 ~, 1750 RPM, RATED FOR 697.5 GPM @ 20' TDH.

| | | | | |
|--------------------------------------------------------------------------------------------------------------------------------------------------|-------------------------------------------------------------------------------------------------------------------------------------------------------------------------------|---------------------------------------------|-------------------------------------------------------------------------------------------------------------------------------------|-----|
| A Professional Corporation ARIX Engineers Architects Planners Greeley, Colorado Grand Junction, Colorado Riverton, Wyoming | THIS DRAWING IS THE PROPERTY OF ARIX, AND IS NOT TO BE REPRODUCED, MODIFIED OR USED FOR ANY OTHER PROJECT OR EXTENSION OF THIS PROJECT EXCEPT BY AGREEMENT WITH SAID COMPANY. | SCALE: AS SHOWN | CITY OF GRAND JUNCTION MESA COUNTY ORCHARD MESA POOL GRAND JUNCTION, COLORADO POOL SECTIONS & FILTER ROOM LAYOUT | R-2 |
| | | DRAWN: MJG CHECKED: FAP APPROVED: FAP | | |