

GRAND JUNCTION CANNABIS LICENSING AUTHORITY

MINUTES

January 4, 2023

I. Call to Order

The meeting was called to order at 9:00 a.m. Those present were Hearing Officer Stephanie Rubinstein, City Attorney John Shaver, Staff Attorney DeLayne Merritt, Principal Planner Nicole Galehouse, Police Officer Travis Wright and Deputy City Clerk Janet Harrell.

Hearing Officer Rubinstein confirmed a representative was present.

II. New License Applications – Findings and Decision

1. Basis, LLC dba Azul, 421 Brach Drive, Grand Junction, CO 81507, Retail

Member: Kate Ramsay, 2955 Kannah Creek Road, Whitewater, CO 81527

Member: Daniel Ramsay, 2955 Kannah Creek Road, Whitewater, CO 81527

Member: Alanna Spees, 636 19 1/2 Road, Grand Junction, CO 81507

Member: Oliver Spees, 636 19 1/2 Road, Grand Junction, CO 81507

Member: Nicholas Easley, 1001 Bannock Street, Suite 419, Denver, CO 80204 (remotely)

Hearing Officer Rubinstein said she received the applicant's response to the City's comments, marked Exhibit 1. She then explained that although the submission is marked "confidential," it will not remain so as a hearing exhibit. Ms. Ramsay acknowledged that and noted, upon request, that an updated security plan was e-mailed to the City, marked Exhibit 2.

Staff Attorney Merritt reviewed the deficiencies in the City Findings Report not addressed in Exhibits 1 and 2. She said the Letter of Intent (LOI) does not guarantee secured funding as either party may withdraw and not execute an agreement, the insurance quote is valid only for 30 days, and further clarification is needed regarding their use of a vault to determine if it meets City Code security requirements.

Hearing Officer Rubinstein asked Mr. Easley to confirm that the only thing that would preclude funding for Basis, LLC is if they do not receive a City license. He said yes.

City Attorney Shaver asked if a loan agreement had been prepared and is simply awaiting execution if Basis, LLC is granted a license. Mr. Easley said no; an agreement would not be drawn up until the license was granted. City Attorney Shaver clarified that the contingency is twofold: a license must be granted, followed by a successful loan negotiation and execution. Mr. Easley concurred.

City Attorney Shaver asked if any capital contribution changes have been made to the Member Schedule (Exhibit 1, page 11) since October 7, 2022, which was provided to clarify LLC member capital contributions and interest. Mr. Easley said the only changes had been member-prorated payments for ongoing expenses such as legal fees and leases.

Mr. Easley clarified that the storage of cannabis products would be in a safe that is inside the vault.

Staff Attorney Merritt explained the City Code requires disclosure of financial contributions. The concern is that the LOI is contingent.

Hearing Officer Rubinstein asked if anyone present would like to speak regarding the application. There was no one.

Staff Attorney Merritt recommended that the insurance quote be valid throughout the application process.

Hearing Officer Rubinstein said she reviewed the application and Exhibits 1 and 2 and considered the statements of the applicant and the City related to the alleged deficiencies. She found the deficiencies have been resolved, that the application is complete, and it will proceed to the randomized selection process. This ruling is final, and any appeal must be filed with the 21st Judicial District. A written order will be issued.

III. Other Business

There was none.

IV. Adjournment

The meeting was adjourned at 9:40 a.m.

City of Grand Junction
City Clerk
250 N 5th Street
Grand Junction, CO 81501

Re: Agenda Findings

This letter is being provided in response to the City of Grand Junction, City Clerk, with respect to the agenda for the hearing for Basis, LLC being held on 4 Jan 2023. The hearing agenda was utilized for the format of the responses contained herein from Basis, LLC with respect to the items of interest. Items identified within the original agenda document which were determined to be complete were omitted from this letter.

The Application is deficient as follows:

- 1. Applicant did not adequately disclose financial contributions to be made in the cannabis business.**
 - a. **Response:** Basis, LLC has provided the following information with regard to the financial contributions. Please note that until 21 June 2022, the financial contributions associated with this retail cannabis application were made via Swiftwater Investments, LLC, the property management company. This entity has the same owners as Basis, LLC.
 - i. MV Letter of Intent - provided at 7 Oct 2022 hearing and as **Attachment 1: Basis, LLC MV LOI 11 Oct 2022, pg. 7-10 of this document.**
 - ii. Basis, LLC Financial Table - provided at the 7 Oct 2022 hearing and as **Attachment 2: Basis, LLC Financial Table 7 Oct 2022, pg. 11**
 - iii. Basis, LLC Financial Transactional Data - **Attachment 3: Basis, LLC (dba Azul) Itemized Expenses 7 Oct 2022, pg. 12-13.**

Proposed Operating Plan

All requirements for the Proposed Operating Plan have not been met. The Proposed Operating Plan is deficient as follows:

- 1. There is no statement from the landlord that the building systems either meet the requirements of the code(s) or can be modified to do so.**
 - a. **Response:** Basis, LLC provided Building Owner Signed Statement within the initial application, the notarized file is included here as **Attachment 4: Building Owner Signed Statement Basis, LLC 26 May 2022, pg. 14-15 of this file,** This file was notarized and signed by Hayden S. Howard on 26 May 2022. The attachment indicates that, *"The following systems can or will be modified to meet the requirements of this and other codes if necessary; Electrical Systems, HVAC*

Systems, Fire Suppression System, Burglar Alarm System, Surveillance System, and/or other Systems.”

2. **Operating Plan does not include information as required on page 3 of the Operating Plan form regarding the square footage and construction of the building as well as proposed improvements.**
 - a. **Response:** Please see **Attachment 5: Operating Plan Addendum and Site Plans and Security Plans (Attachment 5), pg. 16-31** and below for details pertaining to the square footage, construction and proposed improvements. Please note that the total building size square footage was also included on pg. 32 of the operating plan of the original Operating Plan submission but is listed on **pg. 17** of this attachment.
 - i. **Total square footage: 8,586.325, heated square footage: 6,960.**
 1. Commercial building construction details:
 - a. Frame: Masonry
 - b. Interior: Drywall
 - c. Exterior Wall: Face Brick
 - d. Roof: Concrete Tile, Roof Style: Irregular
 - e. Heating: forced air, Heat Fuel: Gas
 - ii. Proposed Improvements, construction
 1. Summary of construction and improvements is found below, more detailed information is found within the **Attachment 5, pg. 18-20**. Improvements to the facility will be made to bring the building to code as needed with respect to Electrical Systems, HVAC Systems, Fire Suppression System, Burglar Alarm System, Surveillance System, and/or other Systems. There will be internal construction of walls to create administrative areas, limit customer access, and close off portions of the building that would be used for future expansion. A safe will be installed in the dispensary managers office for storage of sensitive HR documents, business records, inventory lists, or any other document that requires additional storage security. Only management would have access to this safe. The safes and vaults for this facility will be installed and purchased per the definition of a “safe” provided from the City of Grand Junction. A vault will be installed near the client waiting area to provide storage of cannabis products and cash associated with pre-orders, and potential drive-thru transactions. This vault would only be accessible to the individual working this station and management. There is a proposed drive-through also accounted for that would be new construction being considered on the west side of the building. There will be also be a vault installed near the sales counter/staff lockers to provide storage for cannabis products, and

cash from transactions at the sales counter, only management would have access to this vault. Additional security cameras are to be installed internally and externally as well in addition to installation of security grating and sensors near all exterior windows. The security diagrams provide more specific details for reference in **Attachment 5, pg. 30** for ease of reference. The fire place will also need to be removed to create additional sales space.

3. **It is difficult to determine from the signage plan the height of the wall signage. Cannabis signage is limited to an upper height limit of 20 feet. Need to confirm if the top of the proposed sign is under 20 feet.**
 - a. **Response:** Please see the revised signage diagram as an addendum to **Attachment 5, pg. 23-24**, the architect confirmed on the revised diagram that the top of the proposed wall sign below at the height limit of 20 feet, the top of the wall sign is currently 19 feet 11 inches and has a dimension of 10 feet by 6 feet.
4. **Page 34 indicates that a lighting plan is provided on Page 35, but Page 35 is not included in the application.**
 - a. **Response:** The proposed lighting plan should have been included within the printed application materials initially submitted in June, if it was not located in the application hardcopy, the electronic file of the submission contains the referenced document, this file was shared with the City of Grand Junction on 8 June 2022 via email to the City Clerk for reference, and is included within **Attachment 5, pg. 24-25** for ease of reference.

Insurance Binder, Quote or ACORD

1. **All requirements of the Insurance Binder, Quote or ACORD have been met. Insurance Quote expires 30 days from issuance. The quote was obtained on May 31, 2022. Updated insurance information must be provided.**
 - a. **Response:** Please see **Attachment 6: Updated Insurance Quotes, pg. 32-46**, for the updated insurance quotes for your reference.

Proof of Ownership or Legal Right to Proposed Premises

All requirements for Proof of Ownership or Legal Right to Proposed Premises have not been met. The Proof of Ownership or Legal Right to Proposed Premises are deficient as follows:

1. **The “Amdended Lease Agreement” is dated October 1, 2022, and the effective date is June 16, 2021. The lease term begins June 21, 2021. The effective date and the lease term begin after the application deadline of June 8, 2022.**
 - a. **Response:** The lease term begins 21 June 2021, the application deadline was 8 June 2022, the owners of Basis, LLC had been renting the facility for almost a year before the application was due. The effective date of the “Amended Lease

Agreement” was mutually agreed upon by the owners of Basis, LLC, and the property owner, Howard Family, Inc., to help fulfill the needs of the lease requirement per the October 2022 hearing with the City of Grand Junction. The source of funds for the rent has been the same five people since June of 2021. Initially our group has used a conventional business practice of utilizing a property management company for the rent of the facility for tax reasons. Our group was advised that the submission of the Lease Assignment which was initially included in the application submission in June, was common place for application submissions in this sort of circumstances.

2. **No information provided supporting that Hayden S. Howard has the authority to sign the “Amdended Lease Agreement” on behalf of Howard Family, Inc.**
 - a. **Response:** Please see **Attachment 7: Howard Family, Inc. Authorization Letter, pg. 47-49** for the supporting document which provides evidence that Hayden S. Howard has authority to sign the amended lease agreement, he is the sole member of the Howard Family, Inc. entity. The document was signed by Hayden S. Howard on 30 Dec 2022.
3. **No information provided supporting that Oliver Spees has the authority to sign the “Amdended Lease Agreement” on behalf of Basis, LLC.**
 - a. **Response:** Please see **Attachment 8: Basis, LLC Authorization Letter, pg. 50** for the supporting document which provides evidence that Oliver Spees has authority to sign the amended lease agreement. The document was signed 30 Dec 2022, but the authorization for Oliver Spees to sign documents such as lease agreements has been observed and agreed upon by Basis, LLC owners since 21 May 2021.

Property Authorization

All requirements for the Property Authorization have not been met. The Property Authorization is deficient as follows:

1. **No information provided supporting that Hayden S. Howard has the authority to sign the Property Authorization on behalf of Howard Family, Inc.**
 - a. **Response:** Please see **Attachment 7: Howard Family, Inc. Authorization Letter, pg. 47-49** for the document which provides evidence that Hayden S. Howard has authority to sign the Property Authorization. Please note that Hayden S. Howard is the sole member of this entity. This document was signed as of 30 Dec 2022, but has been observed since business formation 1 Dec 1989.

Floor Plan

All requirements of the Floor Plan have not been met. The Floor Plan is deficient as follows:

1. Applicant proposes to operate separate Limited Access Areas where regulated cannabis and regulated cannabis products are grown, cultivated, manufactured, stored, weighed, packaged, sold, possessed for sale, transferred, or processed for transfer. Per M.E.D. definition, these areas must be contiguous.
 - a. Response: Please find the revised Facility for your review on Attachment 5, pg. 26, and 28.

Security Plan

All requirements of the Security Plan have not been met. The Security Plan is deficient as follows:

1. There is no evidence of external video surveillance as required by M.E.D. Rule 3-225(C)(4).
 - a. Response: Please find the revised Security Diagram for your review, Attachment 5, pg. 30.
2. There is no depiction of video surveillance in the “dispensary manager’s office” nor in the “future expansion area.” GJMC 5.13.029(a)(1) requires security cameras to monitor and record all areas of the premises except restrooms.
 - a. Response: Please find the revised Facility Diagram for your review. Attachment 5, pg. 30.
3. Applicant’s diagrams depict one safe in the dispensary manager’s office and two separated vaults, but there is no explanation of their use. GJMC 5.13.029(a)(2) requires processed cannabis and cash to be stored in safe(s) when the business is closed to the public. GJMC additionally defines “safe.”
 - a. Response: Please find the revised Facility Diagram for your review, Attachment 5, pg. 26, 27, 30, 31.. The revised security plan contains two vaults, and one safe.
 - i. Safe
 1. Location: in the Dispensary Managers Office
 2. Use: Storage of sensitive HR documents, business records, inventory
 3. Access: Only accessible by the management team The safe shall comply with the GJMC definition: means a metal box, attached to the building structure, capable of (a) being locked securely by either a mechanical or electronic combination lock that is protected by a case hardened drill resistant steel plate or drill resistant material of equivalent strength; (b) having door hinges that prevent the removal of the door, including but not limited to hinges that are not exposed to the outside, interlocking door designs, dead bars, jeweler's lugs and an active locking bolts; (c) being constructed in

a manner to prevent opening by human or mechanical force, or through the use of common tools, including but not limited to hammers, bolt cutters, crow bars or pry bars; and (d) being certified by the manufacturer to be adequate for securely storing the quantity of monetary funds and physical cannabis product of the cannabis business.

- ii. Vault, Pre-Order Pickup & Drive Through Product Vault
 1. Location: Located on the west side of the structure next to the drive-thru window and security equipment and security video storage.
 2. Use: Storage of cannabis products
 3. Access: Only accessible by retail employees, please note that while the City of Grand Junction does not define the terms of a Vault, the vaults shall be outfitted with the minimum defined requirements as defined for a "safe."
- iii. Vault, central location:
 1. Location: Near the middle of the structure, north of the staff lockers.
 2. Use: Storage of all cannabis retail products and cash from retail sales.
 3. Access: Only accessible by retail employees and managers. Please note that while the City of Grand Junction does not define the terms of a Vault, the vaults shall be outfitted with the minimum defined requirements as defined for a "safe."

Business Entity Documents

All requirements of the Entity Structure, Ownership Information, Identification, and Finger printing documents have not been met. The Entity Structure, Ownership Information, Identification and Fingerprinting is deficient as follows:

1. No City addendums to the Findings of Suitability were submitted by Applicant.
 - a. **Response:** Please see **Attachment 9: Additional Personnel Questionnaire Basis, LLC, pg. 51-114**, for the City Addendum to the Findings of Suitability. Please note that these forms were completed as of 20 May 2022, we thought this addendum had been included in the printed materials already as well as the digital files shared.

LETTER OF INTENT
TO ENTER INTO A FINANCIAL SOURCE
AGREEMENT

This Letter of Intent to Enter Into a Financial Source Agreement (the “Agreement” or “Letter of Intent”) is entered into and by Basis, LLC (“Applicant”) with an address at 421 Brach Dr, Grand Junction, CO 81507 and Multiverse Capital (“Lender”) with an address at 1001 Bannock Street, Suite 419, Denver, CO 80204 (collectively, the “Parties”) as of 7 October 2022.

WHEREAS, Applicant desires to apply for and obtain a Retail Cannabis License in the City of Grand Junction, CO;

WHEREAS, Lender desires to lend capital to Applicant in accordance with the terms set forth in this Agreement;

WHEREAS, the Applicant and Lender desire to negotiate and enter into a formal Financial Source Agreement in accordance with Colorado law; and

NOW THEREFORE, in consideration of the mutual covenants, promises and undertakings contained herein, the Parties agree to negotiate in good faith in drafting and executing a formal Financial Source Agreement consistent with the following material terms:

1. **Timing.** Upon the approval of Applicant's application by the City of Grand Junction and the State of Colorado for either Cannabis Retail License, Applicant and Lender agree to negotiate a Financial Source Agreement.

2. **No Obligation.** Neither Party is obligated to enter into a Financial Source Agreement, however, since Applicant desires to receive funds from Lender and Lender desires to provide funds to Applicant, both Parties agree to negotiate in good faith with the goal of consummating and executing a Financial Source Agreement in accordance with Colorado Statute and the financing terms contained in this Agreement, which may be modified and amended as needed and agreed.

3. **Principal Amount and Term.** Lender represents and warrants that Lender has the ability, resources, wherewithal, and authority to lend upwards of \$2,500,000.00 (the “Loan”) to Applicant for a period of five (5) years.

4. **Interest & Repayment.** The Parties have discussed the prospective financing terms of the Loan and have initially agreed that the Loan will carry a 12% interest rate, with interest payments to be paid by Applicant to Lender semiannually, and that the Loan will mature and be repaid by Applicant on the fifth annual anniversary of the commencement of the Financial Source Agreement. Repayment options will conform to all requirements prescribed by Colorado Law and any other applicable rules, regulations, or directives of the Colorado Revenue Department.

5. **Security.** The Loan will be secured by collateral to be mutually agreed upon by the Parties as more fully set forth in the Financial Source Agreement.

6. **Modification.** Nothing herein precludes the Parties from adopting and agreeing to a different Loan amount and/or different financing terms as part of their negotiation and drafting of a binding Financial Source Agreement.

7. **Purpose & Intent.** The purpose and intent of this Agreement is to indicate the Lender’s ability and willingness to make the Loan to Applicant in accordance with the terms contained herein as well as the requirements and restrictions imposed by Law.

IN WITNESS WHEREOF, the Parties, intending to be legally bound, have each executed this Letter of Intent on the dates set forth below.

APPLICANT

Basis, LLC

[Redacted Signature]

Kate Ramsay,
CEO

Dated: 11 Oct 2022

LENDER

Multiverse Capital

[Redacted Signature]

By: _____
Sergio Barraza-Ingström, *Managing Partner*

Dated: 11 Oct 2022

Attachment 2) Basis, LLC Financial Table 7 Oct 2022

Schedule A

Basis, LLC (*dba Azul*) Members Schedule

Member Name	Capital Contribution	Membership Interest
Alanna Spees	\$ 10,700.00	11.875%
Oliver Spees	\$ 10,700.00	11.875%
Kate Ramsay	\$ 7,336.56	23.75%
Daniel Ramsay	\$ 7,336.56	23.75%
Nicholas Easley	\$ 30,270.95	23.75%
Hayden "Scott" Howard	\$ 1,500.00	5.0%
	\$ 42,090.14	100%

Please note that at the time the original financial summary for Basis LLC was generated, prior to application submission, the only expenses associated with Basis, LLC (operational company) were the business formation costs. Other expenses incurred prior to the application's submission were captured by Swift Water Investments, LLC (property management company). Please note that the expenses for Swift Water Investments, LLC were previously provided to the City Clerk during the hearing on 7 Oct 2022.

Attachment 3) Basis, LLC (dba Azul) Itemized Expenses 7 Oct 2022

Month	Date	Credit	Debit	Description	Member	Check #	Memo
June							
	6/2/2022	\$3,000.00		Capital contribution	Spees		Rent & expenses
	6/3/2022	\$3,000.00		Capital contribution	Spees		Rent & expenses
	6/3/2022	\$1,900.00		Capital contribution	Spees		To cover lawyers fees
	6/3/2022	\$1,000.00		Capital contribution	Spees		Xcel/energy costs
	6/6/2022		\$350.97	Credit card payment	Swift water checking		
	6/7/2022		\$696.92	Xcel Energy	Swift water checking		
	6/7/2022		\$1,888.00		Swift water checking	#1052	Conerly & Callahan (Drafting docs)
	6/7/2022		\$5,000.00	Dos Rent	Swift water checking	#1051	Dos Rent
	6/8/2022	\$2,500.00	\$2,500.00	Capital contribution	Ramsay		Application-Reimbursement expense
	6/13/2022		\$212.97	Credit card payment	Swift water checking		
	6/24/2022		\$313.52	City of Grand Junction	Swift water checking	#1053	Sewer bill
	6/29/2022	\$1,000.00		Capital contribution	Spees		Utility expenses (Ute and CHUBB)
	6/29/2022	\$852.28		PayPal transfer	PayPal		ConCurrent Event Rental Revenue
July							
	7/1/2022		\$536.20	Ute water		#1055	Domestic water
	7/6/2022		\$519.55	Xcel Energy	Swift water checking		
	7/8/2022		\$760.27	CHUBB	Swift water checking	#1054	Insurance new policy renewal
	7/11/2022	\$2,500.00		Capital contribution	Spees		
	7/12/2022	\$2,427.26		Capital contribution	Ramsay - PayPal Tranfer		Ramsay - PayPal Tranfer
	7/18/2022	\$1,000.00		Capital contribution	Easley		
	7/18/2022		\$212.97	Credit card payment	Swift water checking		
	7/18/2022		\$5,100.00	Dos Rent	Swift water checking	#1057	Dos rent & Xcel additional expense to Scott for reimbursement
	7/25/2022		\$313.52	City of Grand Junction	Swift water checking	#1060	Sewer
August							
	8/1/2022		\$293.66	Ute water	Swift water checking	#1056	Domestic water
	8/4/2022		\$1,090.65	Xcel Energy	Swift water checking		
	8/4/2022		\$500.00		Swift water checking	#1059	Canyon landscaping (yard care)

Month	Date	Credit	Debit	Description	Member	Check #	Memo
	8/5/2022		\$35.00	Overdraft fee Wells Fargo	Swift water checking		
	8/5/2022	\$1,000.00		Capital contribution	Spees		
	8/10/2022	\$2,910.30		Capital contribution	Ramsay -paypal transfer		
	8/10/2022	\$3,000.00		Capital contribution	Spees		
	8/10/2022		\$212.97	Credit card payment	Swift water checking		
	8/10/2022		\$49.47	Wrong paypal account used	Ramsay		
	8/11/2022		\$313.52	City of Grand Junction	Swift water checking	#1062	
	8/15/2022		\$254.42	CHUBB	Swift water checking	#1061	Insurance
	8/15/2022		\$5,000.00	Dos Rent	Swift water checking	#1063	
	8/19/2022	\$2,290.00	\$2,290.00	Paid Vendor, ETG Security Plan Vendor	Easley		
	8/25/2022	\$970.10		Capital contribution	Ramsay -paypal transfer		
	8/29/2022	\$500.00		Dos License Fee	Ramsay		"Dos License Fee" in deposit memo
September							
	9/7/2022		\$951.55	Xcel Energy	Swift water checking		
	9/7/2022		\$257.12	Uter water	Swift water checking	#1065	Domestic water
	9/8/2022		\$800.00	Canyon Landscapes	Swift water checking	#1064	Yard care
	9/9/2022	\$500.00		Capital contribution	Spees		
	9/12/2022	\$500.00		Capital contribution	Spees		
	9/13/2022	\$1,940.20		Rent Deposit	Ramsay		via PayPal
	9/13/2022		\$212.97	Credit card payment	Swift water checking		
	9/13/2022		\$313.52	City of Grand Junction	Swift water checking	#1066	
	9/15/2022	\$4,000.00		Capital contribution	Spees		
	9/19/2022		\$5,000.00	Dos rent	Swift water checking	#1068	
	9/23/2022		\$254.42	CHUBB	Swift water checking	#1067	Insurance
	9/30/2022	\$1,000.00		Capital contribution	Ramsay		Dos Rent contribution
	9/29/2022	\$800.00	\$800.00	Paid Vendor, Jaime Cox	Easley		
October							
	10/4/2022		\$231.92	Ute Water Conservancy	Swift water checking	#1070	Domestic water
	10/05/2022		\$1,015.15	Xcel Energy	Swift water checking		
	10/07/2022		\$249.49	CHUBB	Swift water checking	#1069	

Attachment 4: Building Owner Signed Statement Basis, LLC 26 May 2022

Requirement: The applicant must attach a statement from the landlord or owner (if owner-occupied) that the following systems can or will be modified to meet the requirements of this and other codes; such as electrical systems, HVAC systems, Fire Suppression Systems, Burglar Alarm System, Surveillance System, and/or other systems.

Response: Basis, LLC has attached a statement from the landlord, Howard Family, Inc, signed and notarized on 26 May 2022 that the following systems can or will be modified to meet the requirements of this and other codes; such as electrical systems, HVAC systems, Fire Suppression System, Burglar Alarm System, Surveillance System, and/or other systems.

Table of Contents:

Page #2: Statement from the landlord, Hayden Scott Howard of Howard Family, Inc, signed and notarized on 26 May 2022 that the building's systems can or will be modified to meet the requirements of this and other codes.

Attachment 4: Building Owner Signed Statement Basis, LLC 26 May 2022

WRITTEN CERTIFICATION
OF THE PRESIDENT OF
HOWARD FAMILY, INC.
A STATE OF COLORADO CORPORATION

Date: 26 May 2022

Re: BASIS, LLC (d.b.a. Azul)
City of Grand Junction Cannabis Retail License Application
421 Brach Dr,
Grand Junction, Mesa County, Colorado

To Whom It May Concern,

The undersigned, being the President of the Howard Family, Inc., a State of Colorado Corporation, acting as the Company's legal representative in accordance with the Company's Bylaws, hereby certifies, per the City of Grand Junction's Form GJCBL #0005:

For the building at 421 Brach Dr, Grand Junction, Mesa County, Colorado (Property), to be occupied by Basis, LLC (d.b.a. Azul), the following systems can or will be modified to meet the requirements of this and other codes if necessary; Electrical Systems, HVAC Systems, Fire Suppression System, Burglar Alarm System, Surveillance System, and/or other Systems.

Any and all necessary alterations or improvements to the Property shall be made in accordance with the Lease Agreement dated June 21, 2021, at tenants sole expense.

By: Howard Family, Inc.

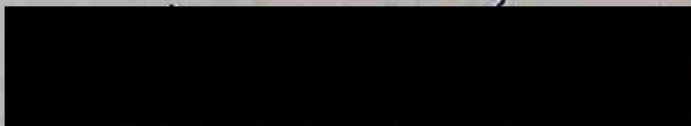

By: Hayden Scott Howard, President

STATE OF Colorado) ss.
COUNTY OF Mesa)

The foregoing instrument was acknowledged before me this 26th day of May, 2022 by Hayden S. Howard.

My commission expires: 02/07/2026 Notary Public Amy Sue Sack



Attachment 5

Operating Plan Addendums and Site Plans and Security Plans

Requirement: Provide the complete square footage and construction description of the building used for the cannabis business (e.g. wood frame, steel frame, masonry, etc.). Provide a description of any planned construction-related improvements at the location (i.e. structural addition, interior remodel, installation of large appliances/equipment, mezzanine installation, interior finish work, exit door/hardware, etc.).

Introduction: The following section describes the construction of the building that Basis, LLC will use for its cannabis business, including the complete square footage. In addition, it will include an outline of any planned construction-related improvements at the location, such as structural addition, interior remodels, installation of large appliances or equipment, mezzanine installation, interior finish work, exit door/hardware, etc. Basis, LLC ensures that all applicable licenses and permits will be obtained and that all applicable regulations, standards, and laws will be adhered to. All changes made to the location will also be designed to be visually appealing and work with the property's existing surroundings to create a layout that matches the motif of the property and its neighboring locations.

Image 1. Facting north-east corner of entrance of facility.



Complete Square Footage and Construction Description of the Building Used (e.g. wood frame, steel frame, masonry, etc.):

Masonry utilizing brick and stucco are the primary construction modalities.

Internally there is some wood framing, but all exterior walls are made out of brick. The structure was built in 1983 and has had a single owner for the past 39 years. The roofing is constructed using concrete tile and is well maintained. The building's historical primary use was as a Mexican restaurant, but the space has also served as a business

place for an accounting office in one of the smaller areas and is currently utilized as an events rental venue. The facility is heated with forced air heat and utilizes natural gas as its fuel source. In 1983, parking lot lighting & poles were installed for safety and visibility purposes and are still functional at this time. There is a small utility shed also located on the property in the northwest corner. This utility shed shall not be utilized for storage of any cannabis products and shall remain locked unless a manager or owner needs to access it for storage purposes. In 1995, the parking lot associated with the building was upgraded to a commercial asphalt lot and has been regularly maintained. There is a patio on the south side of the building which is accessible through entry into the main building. The commercial kitchen is fully stocked and is not being

utilized for cooking commercially, or privately as it is not permitted as such. There are no current plans to utilize the kitchen equipment during the operation of the cannabis retail store. The following attached diagrams and photos will further detail the construction plans for the building being used. Please see below for photos of the current facility.

Image 2. Shows the space found in the southwest corner of the structure.



Image 3. Shows the space found in the central north area of the structure.



Image 4. View from the southeast corner of the parking lot.



The total square footage of the building is 8,586.325 ft. sq., the heated square footage totals: 6,960 ft. sq.

Description of Planned Construction Related Improvements at Location (*i.e. structural addition, interior remodel, installation of large appliances/equipment, mezzanine installation, interior finish work, exit door/hardware, etc.*): The attached diagrams will detail the description of the facility, and any planned construction-related improvements at the location. Additionally, a pre-construction planning spreadsheet and construction diagrams have also been provided and attached at the end of this document. The building structure will require some modification to function as a cannabis retail store. The primary construction needs will serve to ensure the security of the building is optimized through means of construction of walls to remove access to certain portions of the building for retail store customers, and employees alike in some cases. In additional construction of walls, Basis, LLC has provided details for a proposed drive-through feature on the west side of the facility in accordance with the site circulation plan. Measures will be taken to ensure that ventilation of the facility can be secured, in addition to windows, skylights, and roof hatches. If construction is needed for the implementation of the security system, and make improvements to the fire suppression system, and or HVAC of the facility, it will be completed as such in accordance with applicable building regulations.

Per, **GJMC 5.13.039(a)** the company ensures that any modification to their premises will be governed by the standards and procedures set forth in the Colorado Marijuana Code, this Chapter, and any regulations adopted pursuant thereto. Basis, LLC is aware that per **GJMC 5.13.039(b)**, the Authority will administer applications to modify the premises in the same manner as the state licensing authority administers changes of location and modifications of premises for state licenses. As stated in **GJMC 5.13.039(c)**, an application for a proposed modification of the licensed premises will comply with and will be subject to review and approval of the building departments and any other agency that is required to approve such modification. As per **GJMC 5.13.016(e)(24)**, Basis, LLC has provided here, in writing, that all the improvements to the licensed premises will be made as required by the GJMC so that its business operations of cannabis will begin within 12 months of its application being selected for licensure in the random selection process.

Basis, LLC recognizes **GJMC 5.13.012(a)**, and acknowledges that except as otherwise specifically provided, **GJMC 5.13.012** incorporates and adopts the requirements and procedures set forth in the Colorado Marijuana Code and the provisions of the Colorado Rules and Regulations promulgated thereunder, as amended, relating to the definition of terms, licensing, sales, hours of sale, records, inspection, unlawful acts, and all other matters pertaining to regulated cannabis, as set out in full therein and herein. In the event of any conflict between the provisions of **GJMC 5.13.012** and the provisions of the Colorado Marijuana Code or any other applicable state or local law, the more restrictive provision will control. The company will comply with and conduct its business in compliance with all applicable state and local laws, rules and regulations, and the terms and conditions of its license, including any regulations related to building square footage and retrofits. In addition, they acknowledge that non-compliance with any applicable state or local laws, rules, or regulations will be grounds for suspension, revocation, or non-renewal of any license issued hereunder and/or imposition of fine(s), and/or fine(s) in lieu of suspension, and other allowable sanctions. As stated in **GJMC 5.13.012(b)**, Basis, LLC is aware that compliance with any applicable state law or regulation is deemed as an additional requirement for issuance of any license and conduct of any business under this **GJMC 5.13.012**, and noncompliance with any applicable law or regulation will be grounds for

suspension, revocation or non-renewal of any license issued hereunder and/or imposition of fines and other allowable sanctions.

Per **GJMC 5.13.029**, each licensed facility will comply with the requirements of the Colorado Marijuana Code and applicable rules and regulations promulgated thereunder. In addition, the company will submit a security plan with its application and will provide equipment that is in good working order, monitored, and secured 24 hours per day **GJMC 5.13.029(a)**. The plan, at a minimum, will include the installation and use of a safe for storage and any processed cannabis and cash on the premises when the business is closed to the public. The safe, as defined in **GJMC 5.13.013**, will be incorporated into the building structure or securely attached thereto **GJMC 5.13.029(a)(2)**.

As stated in **GJMC 5.13.036(c)**, Basis, LLC will conspicuously post the name and contact information for Kate Ramsay, or owners and any manager inside near the main entrance; also, they will post the regulated cannabis business license and sales tax business license. The company acknowledges **GJMC 5.13.036(d)**, and the ongoing obligation to operate in conformance with this Code and all other applicable laws, rules, and regulations during the term of the license. Basis, LLC is prepared to organize for retrofit activities and will utilize project management timelines to help assist with the process, an example of the management sequence can be reviewed within Table 1, found on page 5 of this narrative.

Conclusion: Basis, LLC is committed to providing a safe and clean customer-friendly experience. The company is prepared to evolve with the rapidly growing cannabis industry and will be ready to make the necessary retrofits and alterations to its facilities to fulfill its business model. As a company, Basis, LLC, will strive to implement leed certification protocols as the business grows. Basis will also ensure that efforts are taken to minimize waste streams from company operations such as management of trash via separation into waste streams for recycling, and operating in a manner that is not wasteful with products used for its operations. Efforts to minimize the use of electricity and heating shall be actively monitored and managed to ensure the facility does not utilize resources unnecessarily.

MONTH 1	MONTH 2	MONTH 3	MONTH 4	MONTH 5	MONTH 6
<p>1.1 Conceptualizing</p> <p>1.11 Finalize Facility design</p> <p>1.12 PFI Facility owner visit</p> <p>1.13 Finalize specifications list</p> <p>1.14 Obtain all permits</p> <p>1.15 Select and Appoint project manager</p> <p>1.16 Liaison with neighbors re: Servitude road, fencing, security and water.</p> <p>1.111 Full spec. Diagrams/blueprints</p> <p>1.112 Cost quote on entire structure with systems</p> <p>1.113 Payment schedule</p> <p>1.122 Site layout</p> <p>1.123 Drainage and sewage</p> <p>1.124 Water infrastructure</p> <p>1.125 Electrical infrastructure</p> <p>1.126 Road works</p> <p>1.131 Infrastructure</p> <p>1.132 Building shell</p> <p>1.133 Foundation</p> <p>1.134 Cost estimate as per District and spec sheet</p> <p>1.141 Project manager</p> <p>1.142 Building and associated systems</p> <p>1.143 Civil</p> <p>1.144 Security</p> <p>1.145 Mechanical</p> <p>1.146 Storage</p> <p>1.147 Architect</p> <p>1.148 General Contractor Construction</p> <p>1.151 Advise</p> <p>1.152 Interview</p> <p>1.153 Contract and appoint</p>	<p>1.2 Pre-Construction and Planning</p> <p>1.21 Environmental impact study on site</p> <p>1.22 Survey by surveying/pending site clearance</p> <p>1.23 Obtain pre-building financing in municipalities and other entities</p> <p>1.24 Architect draws final plans along with civil input</p> <p>1.25 Submit pre-building financing to municipalities and other entities</p> <p>1.211 Initial assessment</p> <p>1.212 Re-evaluation</p> <p>1.213 Minimization Strategy</p> <p>1.214 Site Character permitting</p> <p>1.215 Obtaining ownership (if required by permits)</p> <p>1.221 Survey site and install new boundary NCP</p> <p>1.222 Contour map of site to 100m contours</p> <p>1.223 Soil assessment</p> <p>1.231 Finalize improvements</p> <p>1.232 Water infrastructure layout</p> <p>1.233 Water reclamation and storage</p> <p>1.234 Electrical infrastructure</p> <p>1.235 Access/roadworks</p> <p>1.236 Electrical connections and infrastructure</p> <p>1.241 Final plans drawn up according to spec to Contract of work</p> <p>1.242 Consultant approval for NCP, Submittal</p> <p>1.243 Plans in hand copy</p> <p>1.244 Obtain all permits</p> <p>1.245 Obtain all permits</p> <p>1.246 BIDD</p> <p>1.247 Bid at Quantity</p> <p>1.248 Payment deferral for construction</p> <p>1.251 Complete all applicable application documents for submittal</p> <p>1.252 Submit all documents for permitting required</p> <p>1.253 Final construction cost estimate</p>	<p>1.3 Construction</p> <p>1.31 Site clearance</p> <p>1.32 Permit fence and surveillance installation</p> <p>1.33 Water infrastructure and construction</p> <p>1.34 Water infrastructure and construction</p> <p>1.35 Layout site</p> <p>1.36 Foundations and Excavations</p> <p>1.37 Foundation</p> <p>1.38 Core and Shell</p> <p>1.331 Environmental impact assessment</p> <p>1.332 Site clearance</p> <p>1.333 Site office</p> <p>1.334 Average site clearance</p> <p>1.335 Machinery on site</p> <p>1.336 Foundation</p> <p>1.337 Leveling</p> <p>1.321 Mark out site areas for excavation</p> <p>1.322 Mark out Roads and Perimeters</p> <p>1.323 Mark out vegetation along roads</p> <p>1.331 Excavate and build debris</p> <p>1.332 Excavate foundation and drainage</p> <p>1.333 Labor</p> <p>1.334 Promoter surveillance</p> <p>1.335 Utility and access control</p> <p>1.336 Maintenance and equipment management</p> <p>1.341 Submit application for connection</p> <p>1.342 Install relevant infrastructure and on site supply</p> <p>1.343 Labor</p> <p>1.344 Inspection</p> <p>1.345 Switch on</p> <p>1.351 Improve drainage and build up water system</p> <p>1.352 Install water meter and drainage</p> <p>1.353 Install water storage and recycling system</p> <p>1.354 Install water storage and recycling system</p> <p>1.361 Install roadworks</p> <p>1.362 Install roadworks</p> <p>1.363 Excavate facility</p> <p>1.364 Excavate facility</p> <p>1.365 Excavate facility</p> <p>1.366 Excavate facility</p> <p>1.367 Excavate facility</p> <p>1.371 Install Drainage system</p> <p>1.372 Install Sewerage system</p> <p>1.373 Settlement</p> <p>1.374 Inspect</p> <p>1.381 PFI to deliver from supplier. Initial structure</p> <p>1.382 KPI arrives on site & unpacking</p> <p>1.383 Assembly of kit</p>	<p>1.4 Equipment fitness and install</p> <p>1.41 Internal layout and install</p> <p>1.42 Gas installations</p> <p>1.43 HVAC install</p> <p>1.44 Building Control System/SCS installation</p> <p>1.45 Final inspection</p> <p>1.46 Final inspection (operator, post control ref)</p> <p>1.411 Check all internal fixtures and fittings</p> <p>1.412 Final internal utility</p> <p>1.413 Final internal utility</p> <p>1.414 Final internal utility</p> <p>1.415 Final internal utility</p> <p>1.416 Final internal utility</p> <p>1.421 Install Plumbing</p> <p>1.422 Install Electricity</p> <p>1.423 Install Fire suppression system</p> <p>1.431 Install Gas system including CO2</p> <p>1.432 Install Gas piping and fittings - CO2</p> <p>1.433 Install Gas piping and fittings - LPG</p> <p>1.434 Install Gas piping and fittings - LPG</p> <p>1.435 Install Multi fuel Boiler</p> <p>1.441 Install Venting</p> <p>1.442 Install Ducting</p> <p>1.443 Install Fan and Tabs</p> <p>1.444 Install emergency ventilation</p> <p>1.451 Install wiring</p> <p>1.452 Install switches</p> <p>1.453 Install sensors</p> <p>1.454 Install sensors</p> <p>1.455 Test</p> <p>1.471 Install room equipment according to production and opp plan</p> <p>1.472 Site cleanup and deconstruction</p> <p>1.481 Install upgrade</p> <p>1.482 Install ATHSDIA equipment (operator, kit and PFI)</p> <p>1.483 Install post control plan before cleanup</p>	<p>1.5 Testing and verification</p> <p>1.51 OSHA</p> <p>1.52 System testing</p> <p>1.53 Final inspection</p> <p>1.54 Occupancy certificate from municipality</p> <p>1.511 Fire System</p> <p>1.512 Fire System</p> <p>1.513 Gas</p> <p>1.514 Structure</p> <p>1.515 Electrical</p> <p>1.516 Final inspection</p> <p>1.517 IIRCA</p> <p>1.521 Electrical Systems</p> <p>1.522 Water and plumbing</p> <p>1.523 Water and plumbing</p> <p>1.524 IT systems</p> <p>1.525 Building sensors</p> <p>1.526 Light Duty System</p> <p>1.527 Final inspection</p> <p>1.528 VIBAC</p> <p>1.529 Submittal log</p> <p>1.530 Security</p> <p>1.531 As required for occupancy certificate</p> <p>1.532 ODP</p> <p>1.533 Final inspection</p> <p>1.534 ODP</p> <p>1.535 ODP</p> <p>1.536 ODP</p> <p>1.541 Physical Systems</p> <p>1.542 Water and plumbing</p> <p>1.543 Ventilation System</p> <p>1.544 IT systems</p> <p>1.545 Light Duty System</p> <p>1.546 Light Duty System</p> <p>1.547 Gas and Heating</p> <p>1.548 VIBAC</p> <p>1.549 Security</p> <p>1.541 Occupancy Certificate inspection</p> <p>1.542 Certificate issued and collected</p> <p>1.61 Handover checklist</p> <p>1.62 Final inspection</p> <p>1.63 Final inspection</p> <p>1.64 Final inspection - COMPANY</p> <p>1.65 Final inspection</p> <p>1.66 Final inspection</p> <p>1.67 Final inspection</p> <p>1.68 Final inspection</p> <p>1.611 Complete list of documents including:</p> <p>1.612 Specification list</p> <p>1.613 Equipment use training documentation</p> <p>1.614 Final inspection</p> <p>1.615 Final inspection</p> <p>1.616 Maintenance schedules</p> <p>1.621 Update any changes to reflect in NMP</p> <p>1.622 Notify PFI at knowledge acceptance of new NMP</p> <p>1.631 Blotprints</p> <p>1.632 SOPs</p> <p>1.641 Check facility along with contractors, engineers, UC team etc</p> <p>1.642 Complete sign list</p> <p>1.641 Remedy identified areas not according to spec</p> <p>1.642 Remedy identified areas not according to spec</p> <p>1.643 All areas to be signed off by deconstruct authority and approving authority</p> <p>1.641 Site inspection Scheduled</p> <p>1.642 Remedial work identified</p> <p>1.643 Site Inspection Passed</p> <p>1.671 Identify and Report</p> <p>1.672 Inspect and approve</p> <p>1.681 Handover over scheduled</p> <p>1.682 Handover over conducted and finished</p> <p>1.691 Sign training</p> <p>1.692 Dry run</p>	

Table 1. Provides an example of a standard retrofit sequence of events, not all items may need to be assessed for the proposed Basis, LLC retrofit activities, the comprehensive list is provided to ensure all criteria are reviewed and addressed if and when needed.

Please note, the proposed drive-through is included and the Parking Plan is adjusted to accommodate for this change.

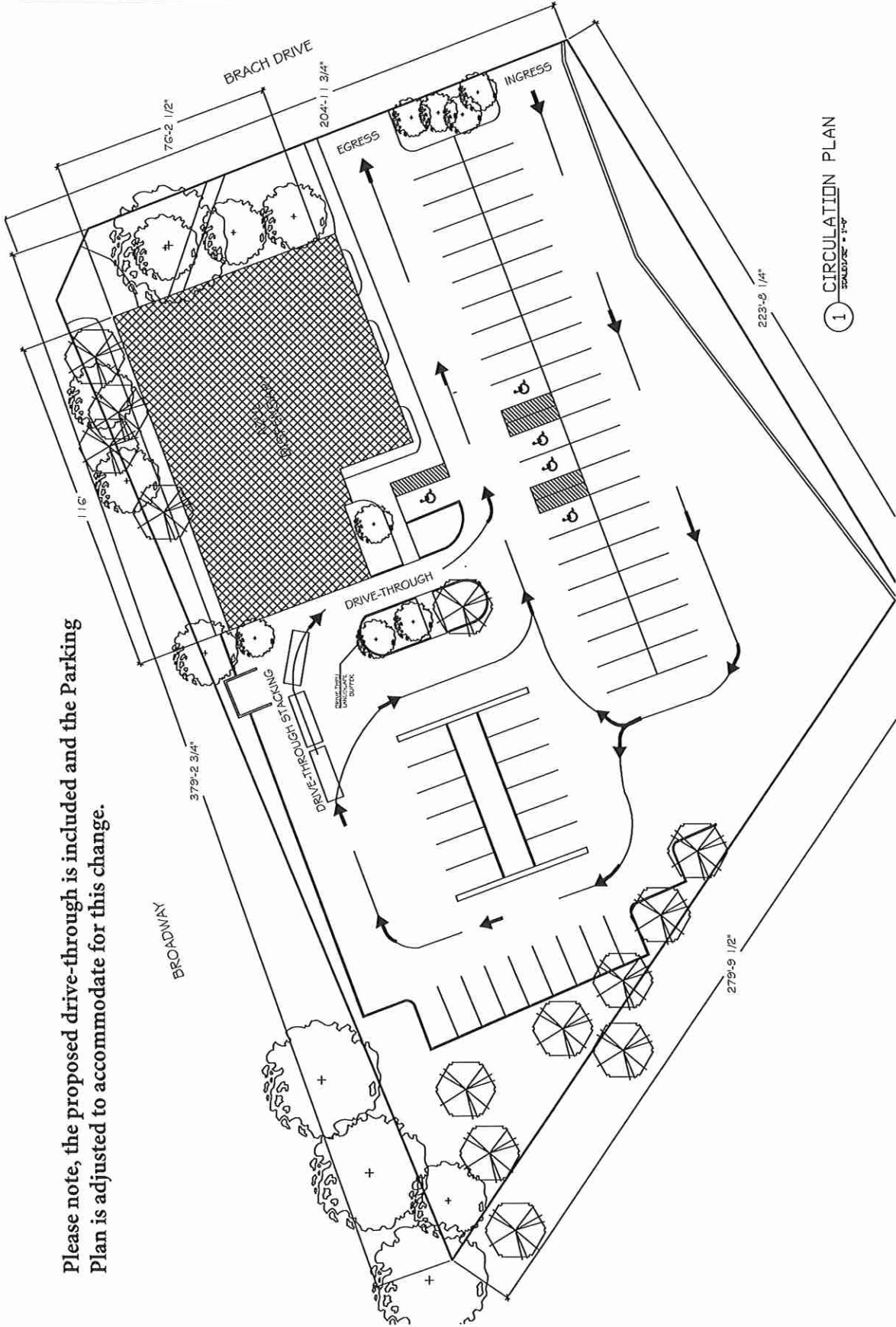

General Notes	
No.	1
Desc.	Drift
Rev.	06.02
By	State
Project Name and Address	
Julima Cox 3674 G 4/10 Rd Palisade, CO 81526	
Project Name and Address	
AZUL DISPENSARY BASIS, LLC 421 Brach Dr Grand Junction, CO 81507	
Sheet	S1
Date	6/2/2022
Scale	AS-NOTED

Proposed Signage Plan

Requirement: The applicant is to provide a professionally-completed signage plan for the proposed cannabis business.

Response: Basis, LLC has provided a professionally-completed signage plan for the proposed cannabis business at 421 Brach Dr, Grand Junction, CO 81507. The plan was completed by Jaime Cox on 2 June 2022, and then revised 30 Dec 2022.

Table of Contents:

Page #2: Signage plan for the proposed cannabis business at 421 Brach Dr, Grand Junction, CO 81507, completed by Jaime Cox on 2 June 2022, and then revised 30 Dec 2022.

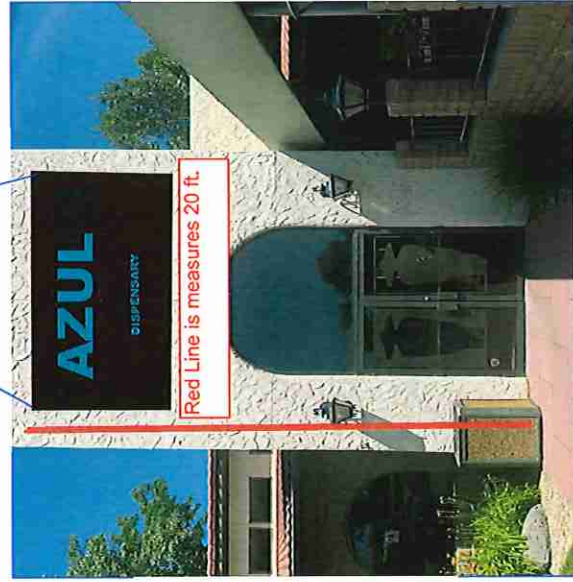
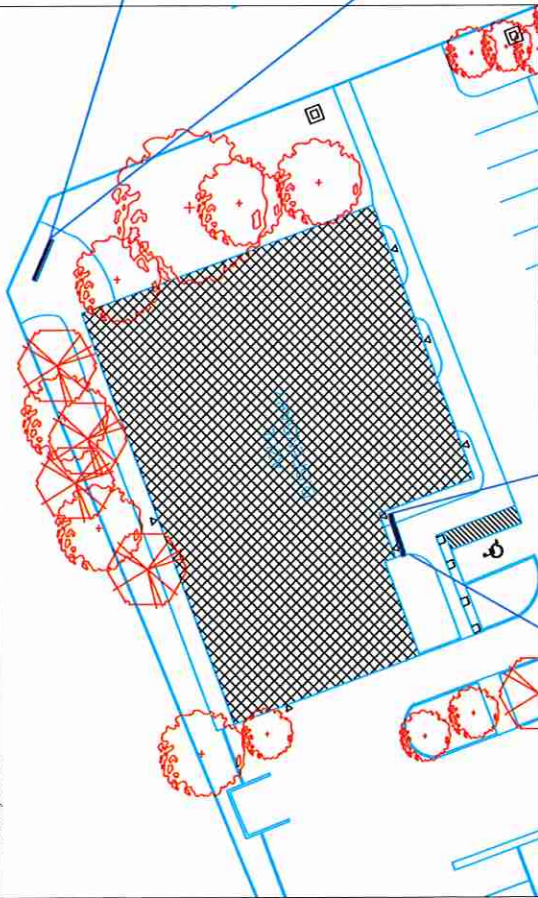

Please note that the maximum height of the proposed wall sign is currently measured to be 19 feet, 11 inches, which is under the 20 foot maximum.

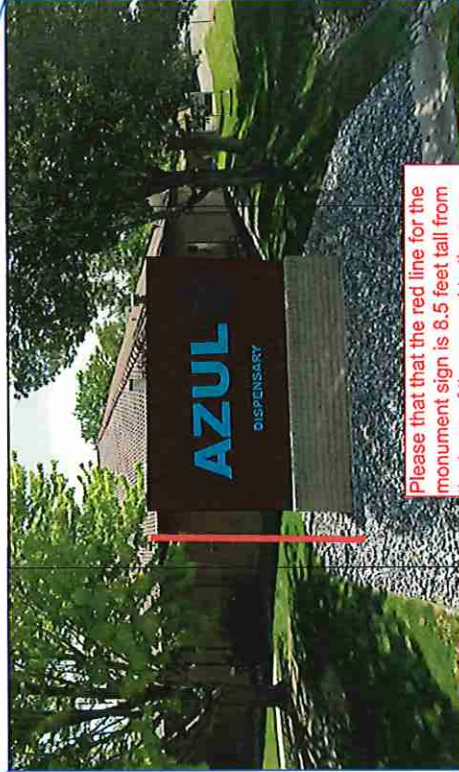

1 SIGNAGE DIAGRAMS
SCALE: 1/8" = 1'-0"
(EACH SIGN IS 10' X 6')

Contract Number	
1	Draft
No.	Revised/Issue
Date	
Project Name and Address	
JoJime Cox 3574, G 4/10 Rd Pellisade, CO 81526	
Project Name and Address AZUL DISPENSARY BASIS, LLC 421 Brech Dr Grand Junction, CO 81507	
Project	BASIS, LLC
Date	6/2/2022
Scale	AS-NOTED
S4	

Proposed Outdoor Lighting Plan

Requirement: The applicant is to provide a professionally-completed outdoor lighting plan for the proposed cannabis business.

Response: Basis, LLC has provided a professionally-completed outdoor lighting plan for the proposed cannabis business at 421 Brach Dr, Grand Junction, CO 81507. The plan was completed by Jaime Cox on 3 June 2022.

Table of Contents:

Page #2: Outdoor lighting plan for the proposed cannabis business at 421 Brach Dr, Grand Junction, CO 81507, completed by Jaime Cox on 3 June 2022.

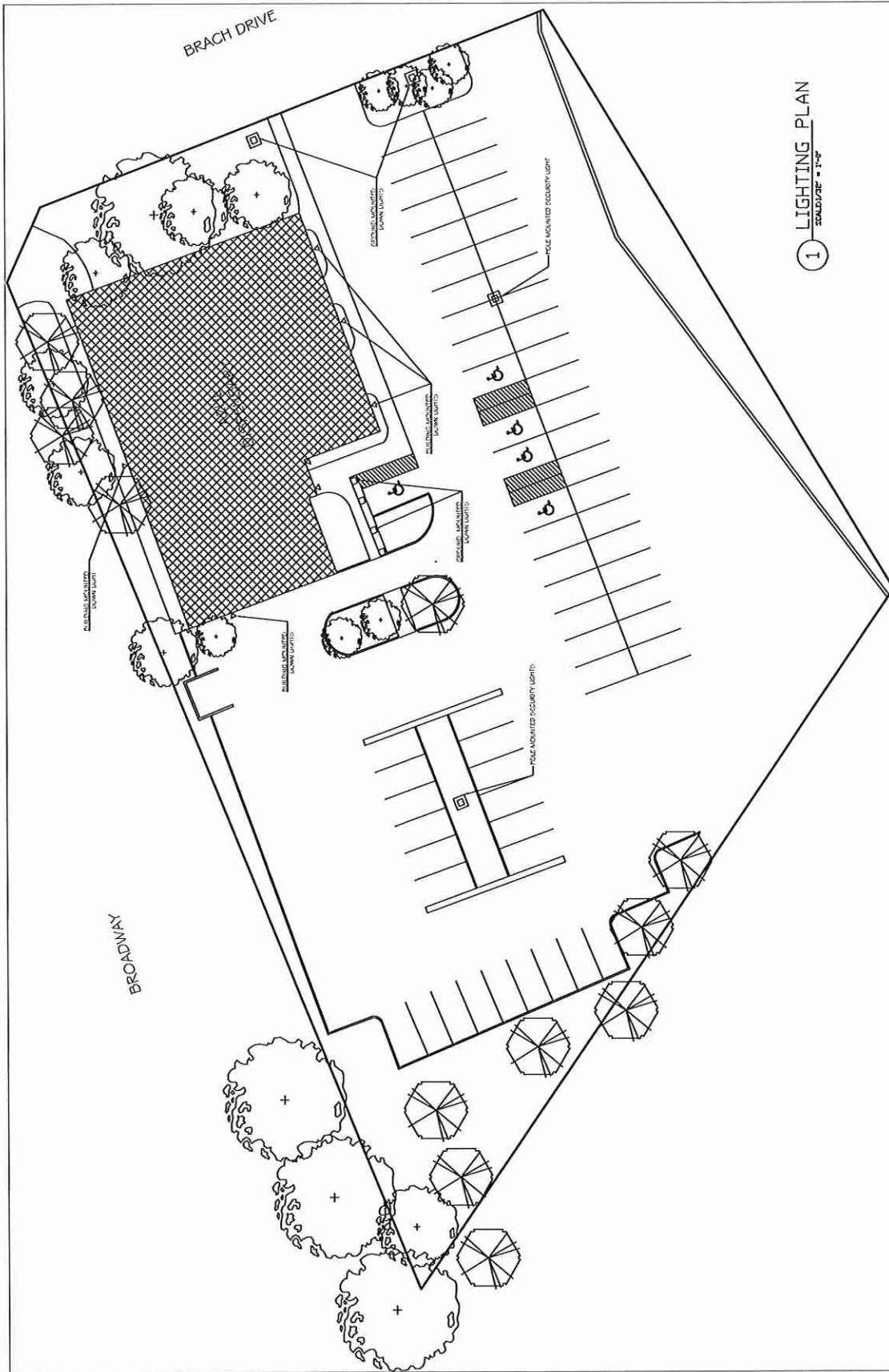

General Notes	
No.	Date
1	08.02
Revisory Number	
Project Name and Address	
Jaime Cox 3674 G 4/10 Rd Pullsade, CO 81526	
Project Name and Address ADULT DISPENSARY BASIS, LLC 421 Brach Dr Grand Junction, CO 81507	
Scale	AS-NOTED
Date	8/2/2022
Sheet	S3

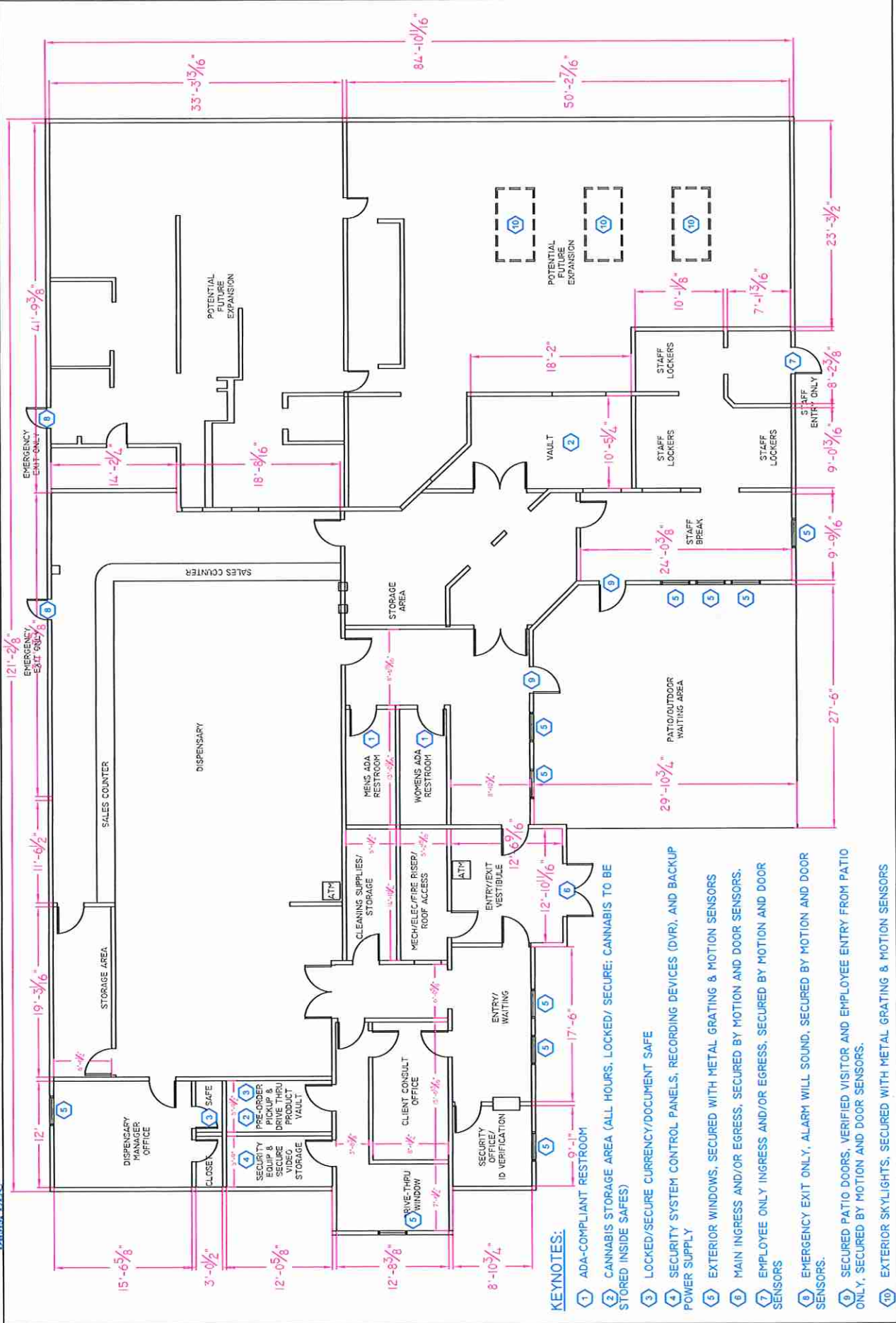

AREA #	USE	RESTRICTION	PHYSICAL BARRIER	INTRUSION DETECTION	ACCESS AUTHENTICATION	SCHEDULE	NOTES	WHO HAS ACCESS
0	EXTERIOR PARKING, GENERAL PUBLIC	UNRESTRICTED GENERAL ACCESS	None	None	None	None	VEHICULAR LICENSE PLATES VISUALLY RECORDED	EMPLOYEE & VISITED VISITORS
1	RESTRICTED, WAITING, IRS, PATIO	RESTRICTED GENERAL ACCESS	EXTERIOR WALLS, METAL DOORS, PATIO FENCE	MOTION & DOOR SENSORS	CARD/PIN READER	UNLOCKED DURING BUSINESS HOURS		EMPLOYEE & VISITED VISITORS
2	RECEPTION	RESTRICTED GENERAL ACCESS	EXTERIOR WALLS, METAL DOORS, PATIO FENCE	MOTION & DOOR SENSORS	CARD/PIN READER	UNLOCKED DURING BUSINESS HOURS		EMPLOYEE & VISITED VISITORS
3	GENERAL ADMIN OFFICE	CONTROLLED ACCESS	INTERIOR/EXTERIOR WALLS, METAL DOORS	MOTION & DOOR SENSORS	PROXIMITY CARD READER ALWAYS CLOSED AND LOCKED			EMPLOYEE & ESCORTED VISITORS
4	DISPENSARY FLOOR, DISPLAYS	CONTROLLED ACCESS	INTERIOR/EXTERIOR WALLS, METAL DOORS	MOTION & DOOR SENSORS	PROXIMITY CARD READER ALWAYS CLOSED AND LOCKED			EMPLOYEE & ESCORTED VISITORS
5	EMPLOYEE AREA, BREAK ROOM, STORAGE	LIMITED ACCESS	INTERIOR/EXTERIOR WALLS, METAL DOORS	MOTION & DOOR SENSORS	CARD/PIN READER	ALWAYS CLOSED AND LOCKED		ALL EMPLOYEES
6	RECEPTION	LIMITED ACCESS	INTERIOR/EXTERIOR WALLS, METAL DOORS	MOTION & DOOR SENSORS	CARD/PIN READER	ALWAYS CLOSED AND LOCKED		ALL EMPLOYEES
7	RECEPTION	LIMITED ACCESS	INTERIOR/EXTERIOR WALLS, METAL DOORS	MOTION & DOOR SENSORS	CARD/PIN READER	ALWAYS CLOSED AND LOCKED		ALL EMPLOYEES
8	MANAGER OFFICE	LIMITED ACCESS	INTERIOR/EXTERIOR WALLS, METAL DOORS	MOTION & DOOR SENSORS	PROXIMITY CARD READER ALWAYS CLOSED AND LOCKED			MANAGEMENT
9	RECEPTION	LIMITED ACCESS	INTERIOR/EXTERIOR WALLS, METAL DOORS	MOTION & DOOR SENSORS	CARD/PIN READER	ALWAYS CLOSED AND LOCKED		MANAGEMENT
10	RECEPTION	LIMITED ACCESS	INTERIOR/EXTERIOR WALLS, METAL DOORS	MOTION & DOOR SENSORS	PROXIMITY CARD READER ALWAYS CLOSED AND LOCKED			SECURITY AND MANAGEMENT
11	RECEPTION	LIMITED ACCESS	INTERIOR/EXTERIOR WALLS, METAL DOORS	MOTION & DOOR SENSORS	PROXIMITY CARD READER ALWAYS CLOSED AND LOCKED			SECURITY AND MANAGEMENT
12	FUTURE EXPANSION AREA	UNRESTRICTED ACCESS	INTERIOR/EXTERIOR WALLS, METAL DOORS	MOTION & DOOR SENSORS	KEYED ACCESS ONLY	ALWAYS CLOSED AND LOCKED		SECURITY AND MANAGEMENT

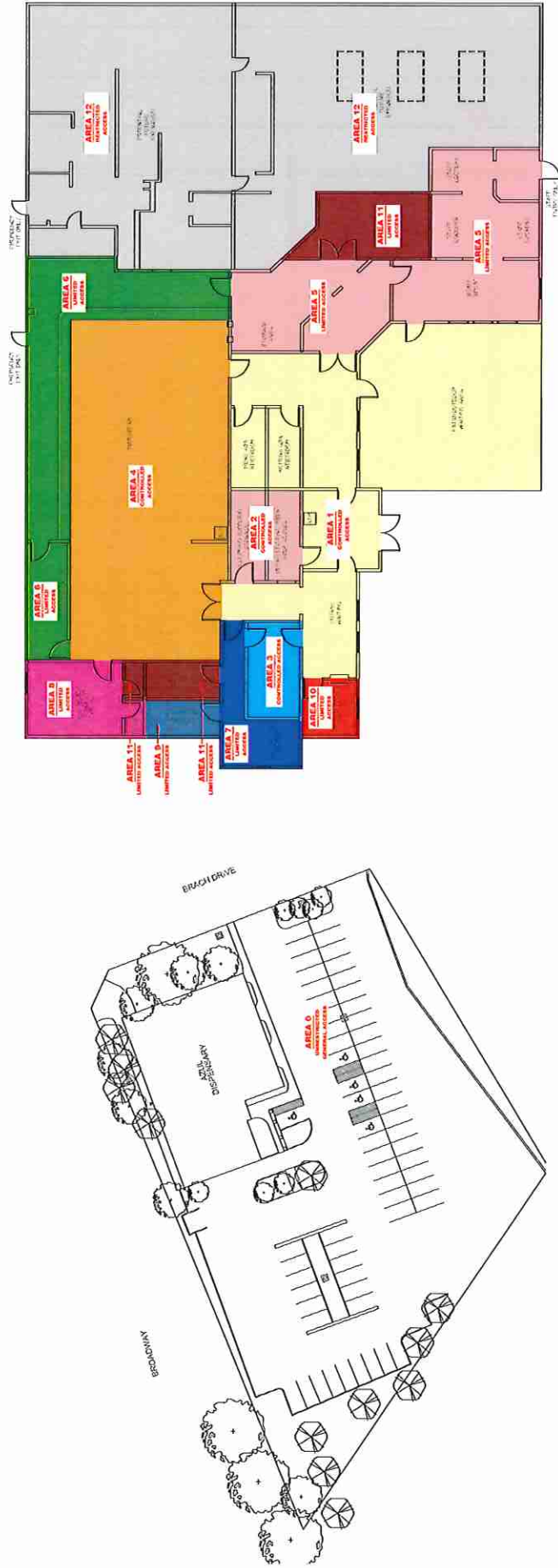

GENERAL NOTES:

1. ALL VISITORS (NON-EMPLOYEES) MUST BE ESCORTED WHILE ON PREMISES.
2. ALL EMPLOYEES SHALL HAVE BADGE/ACCESS CARD, LISTING LOCATION NAME & LICENSE NUMBER. EMPLOYEE NAME AND 2 x 2" COLOR PHOTO.
3. ALL ENTRY AND EXIT DOORS, AND DOORS FACILITATING A CHANGE IN ACCESS LEVEL, SHALL USE A COMMERCIAL GRADE, NON-RESIDENTIAL, DOOR LOCK.

DATE	REVISION	BY	APPROVED BY
08/20/2022	ISSUE FOR PERMIT	AC	AC
08/20/2022	ISSUE FOR PERMIT	AC	AC
08/20/2022	ISSUE FOR PERMIT	AC	AC
08/20/2022	ISSUE FOR PERMIT	AC	AC

SITE ACCESS AREAS



AZUL DISPENSARY
 421 BRACH DRIVE
 GRAND JUNCTION, COLORADO 81507

DATE	REVISION	BY	APPROVED BY
08/20/2022	ISSUE FOR PERMIT	AC	AC
08/20/2022	ISSUE FOR PERMIT	AC	AC
08/20/2022	ISSUE FOR PERMIT	AC	AC
08/20/2022	ISSUE FOR PERMIT	AC	AC

THIS DRAWING, INCLUDING ANY NOTES, IS THE PROPERTY OF ETG AND IS TO BE USED ONLY FOR THE PROJECT AND SITE SPECIFICALLY IDENTIFIED. IT IS NOT TO BE REPRODUCED OR USED FOR OTHER PROJECTS WITHOUT ETG'S WRITTEN CONSENT.

SCALE: AS SHOWN | SECURITY & FIRE ALARM | SS-01

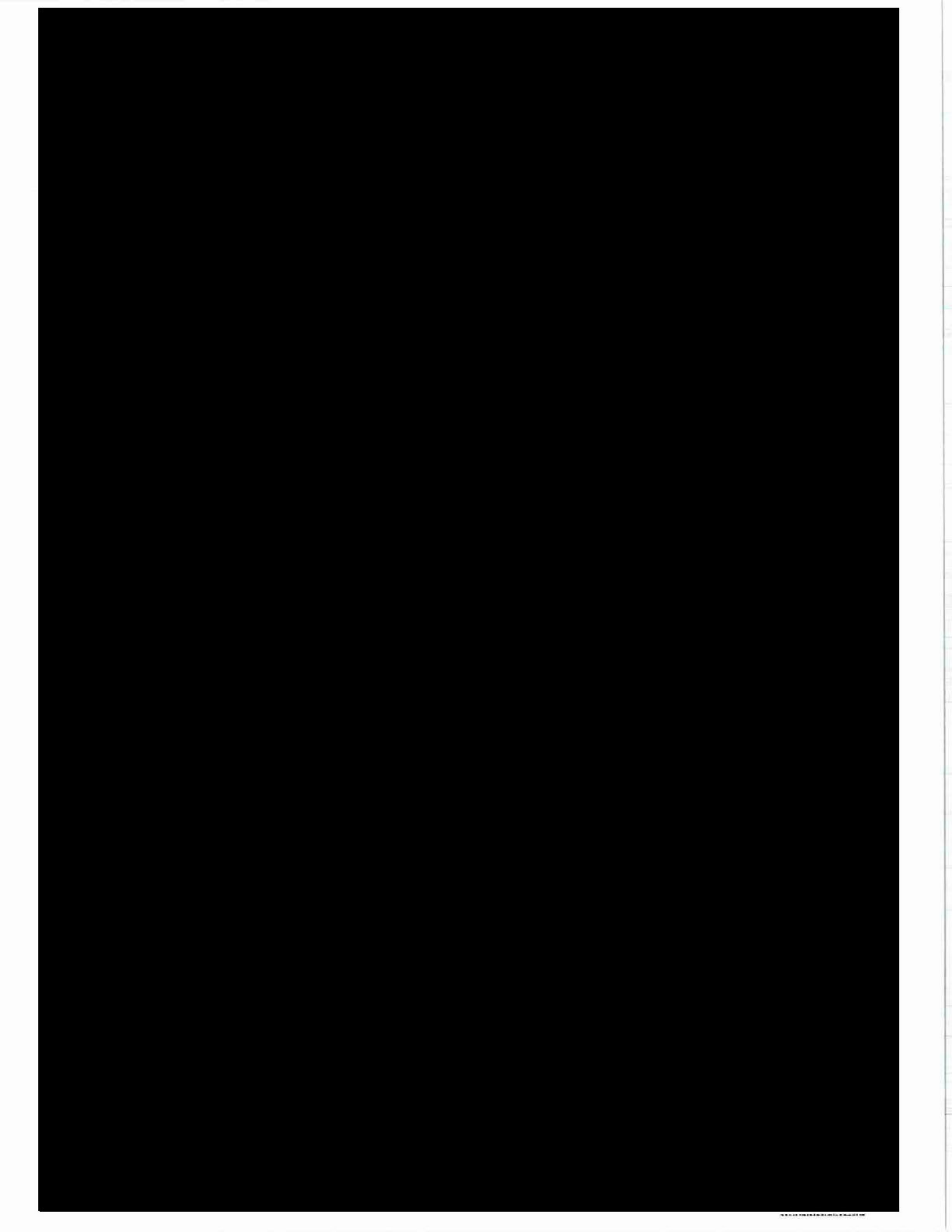

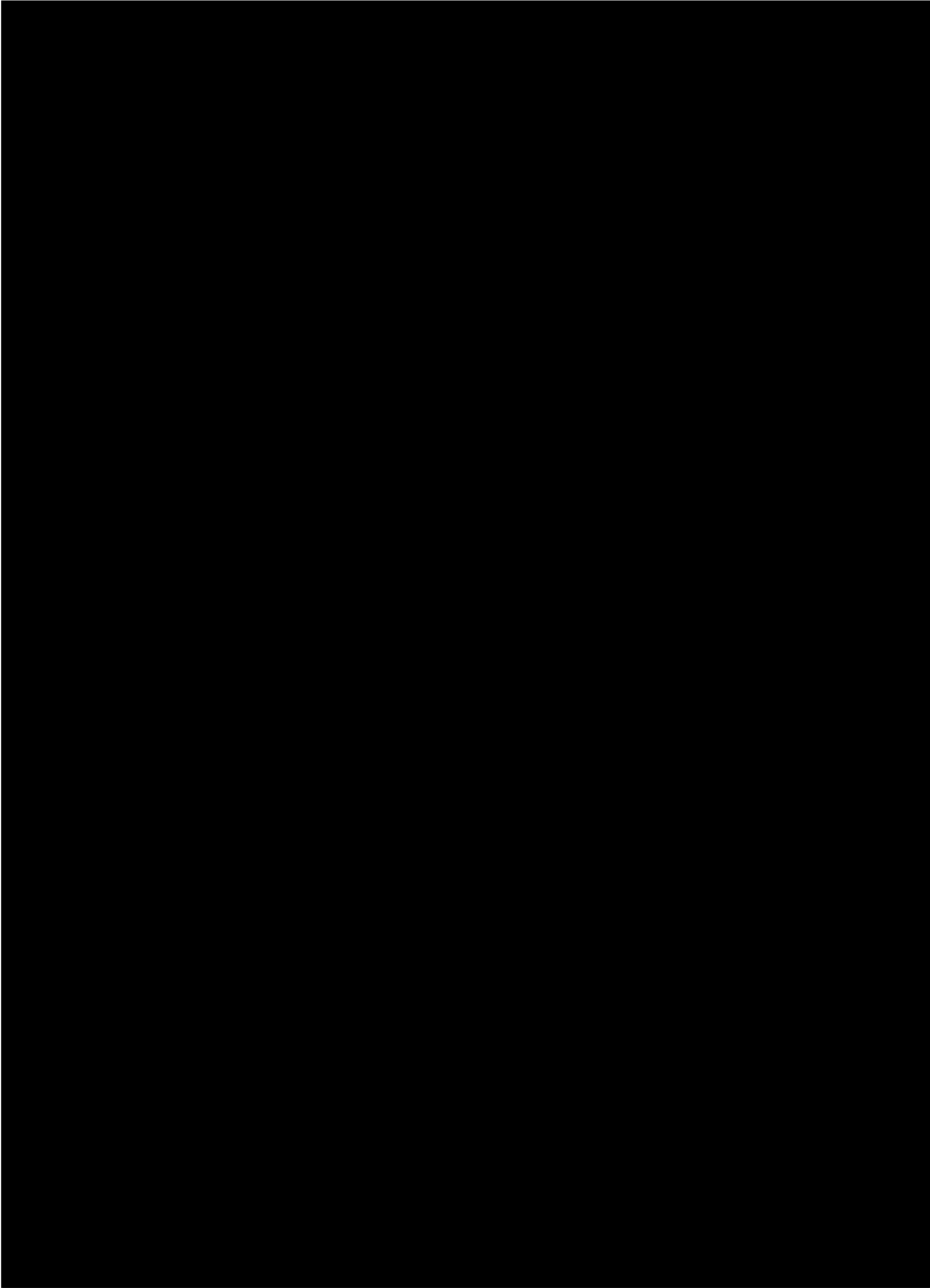



RT Specialty
5680 Greenwood Plaza Blvd
Greenwood Village, CO 80111
Kevin Moogan
303-974-9179

Insurance Proposal

December 29, 2022

Higginbotham Insurance Agency, Inc. - Fort Worth

Attn: Shaleen Martin

901 Lake Street Fort Worth, TX 76102

Applicant: Basis LLC
Azul
421 Brach Dr
Grand Junction, CO 81507

Submission #: APP154068168
Policy Period: 12/29/2022 12:01 AM To 12/29/2023 12:01 AM
Coverage: Liability

Issuing Company: Evanston Insurance Company

We are pleased to submit our proposal for the above captioned applicant.

Please read the attached quote carefully as coverage offered may be more limited than coverage requested.

Note :

Minimum earned premium may apply to this policy. See attached carrier quote for specifics. Please note that all fees are fully earned at inception.

TRIA coverage if applicable is offered on the attached carrier's quote.

Please review any minimum and deposit, audit, and/or cancellation provisions on the attached carrier quote for details regarding possible return premiums and additional premium charges.

I look forward to hearing from you, and please call if you have any questions.

Thank you for your business.

Regards,

Kevin Moogan
Brokerage Underwriter
RT Specialty
kevin.moogan@rtspecialty.com
303-974-9179

Trip Fessenden
Associate Underwriter
RT Specialty
trip.fessenden@rtspecialty.com
720-722-6472



RT Specialty
 5680 Greenwood Plaza Blvd
 Greenwood Village, CO 80111
 Kevin Moogan
 303-974-9179

Insurance Proposal

Cost Summary

General Liability Premium	\$515.00
Policy Fee	\$175.00
CO Surplus Lines Tax	\$20.70
Total Policy Cost	\$710.70

Minimum Earned

Note: There may be a minimum earned on this policy. Please refer to the carrier quote for more details on the minimum earned percentage.

Agent Commission: 11.50%

Disclosures

In the process of reviewing and attempting to place insurance for your client, we may perform any number of tasks that may or may not include: the review and assessment of your application, losses and risk profile, communicating with various insurance carriers or their representatives, risk analysis, policy or coverage comparison, inspections, reviewing coverage terms offered, policy issuance and servicing of the policy post binding. We may charge a fee for these services in addition to any commission that may be payable to us by the Insurance Carrier with whom we bind your client's business.

Any fees charged are fully earned at inception of the policy and will not be returned unless required by applicable law. Fees may be applicable to any transaction requiring additional premium including audits and endorsements as well as new and renewal policies. All fees will be itemized separate from premium in our quotes. Insureds are under no obligation to purchase insurance proposed by us including a fee and insurance carriers are under no obligation to bind any insurance proposed in our Quotes. The fees we charge are not required by state law or the insurance carrier.

RT Specialty is a division of RSG Specialty, LLC. RSG Specialty, LLC is a Delaware limited liability company and a subsidiary of Ryan Specialty, LLC. In California: RSG Specialty Insurance Services, LLC (License # 0G97516).



RT Specialty
5680 Greenwood Plaza Blvd
Greenwood Village, CO 80111
Kevin Moogan
303-974-9179

Insurance Proposal

Subjectivities

- Signed and completed Acord Application or equivalent
- Due Diligence Forms (if required by state - Non-Admitted Only)
- Signed TRIA form if insured is accepting or rejecting terrorism coverage
- This quote is subject to receiving currently valued, acceptable loss runs for the last 5 policy terms prior to binding.
- A written request to bind coverage is required prior to binding

The Subjectivities outlined above are required prior to binding. Please forward all requested information with your bind request. No coverage is considered bound until confirmed in writing and all subjectivities have been addressed.

Remarks

This quote is subject to the following:

- 1) Receipt of a current completed, signed, and dated application.
- 2) Receipt of 3-5 years currently valued loss runs is preferred. If that is not possible, a no known loss letter signed by the insured will suffice.
- 3) An inspection report is required within 45 days of binding for all casualty risks with premiums of \$2,500 or greater. Additionally, inspections are always required for: all habitational risks (apartments, condos, HOAs); all contractors (jobsite inspection if possible); all social service risks; all bars, restaurants, and nightclubs.
- 4) A signed copy of the Terrorism disclosure, MKL Terr 4, is required to bind.

Please see attached company documents for complete terms and conditions



December 29, 2022

Kevin Moogan
RT Specialty, LLC
5660 Greenwood Plaza Blvd. #500
Greenwood Village, CO 80111
kevin.moogan@rtspecialty.com

Quote Summary

Based on the information provided, we are pleased to offer the following quote with Evanston Insurance Company. Evanston Insurance Company is a surplus lines insurer currently rated A XV by A.M. Best.

These terms are valid for thirty days from the date on this letter. Our quotation may differ from the terms requested in the submission. Please review our quotation carefully.

Named insured: Basis LLC , DBA Azul
Mailing Address: 421 Brach Drive
Grand Junction, CO 81507
Transaction number: 5393279

Company: Evanston Insurance Company
Term quoted: 12/29/2022 to 12/29/2023 (These dates may be amended at time of binding.)

Premium Summary

General liability	\$515
Total Premium without TRIA	\$515
Total amount due	\$515.00

This quote is subject to the following:

- Receipt of a current completed, signed, and dated application.
- Receipt of 3-5 years currently valued loss runs is preferred. If that is not possible, a no known loss letter signed by the insured will suffice.
- An inspection report is required within 45 days of binding for all casualty risks with premiums of \$2,500 or greater. Additionally, inspections are always required for: all habitational risks (apartments, condos,



Basis, LLC

CONFIDENTIAL

Basis LLC
Transaction #: 5393279

HOAs); all contractors (jobsite inspection if possible); all social service risks; all bars, restaurants, and nightclubs.

- A signed copy of the Terrorism disclosure, MKL Terr 4, is required to bind.

Binding may be restricted at the Company's discretion for specified areas due to a pending or active catastrophe pursuant to the Company's underwriting guidelines.

**General Liability Coverage****Limits of Insurance**

General Aggregate Limit	\$2,000,000
Products/Completed Operations Aggregate Limit	Excluded
Personal/Advertising Limit	Excluded
Each Occurrence Limit	\$1,000,000
Damage to Premises Rented to You Limit	\$100,000
Medical Expense Limit (Any one person)	\$5,000

Deductible None

Location schedule

Loc	State - Territory	Address
1	CO - 502	421 Brach Drive, Grand Junction, CO 81507

Classification and premium

Loc	Class Code	Description	Rating Basis	Exposure	Rate	Premium
1	61224	Buildings or Premises - office premises primarily occupied by employees of the insured (For-Profit)	Per 1,000 Square Feet of Area	6,600	77.99	\$515

Additional Coverages

Coverage	Limit	Qty.	Premium
Additional Insured - Managers or Lessors of Premises	n/a	n/a	Included

Terrorism

The Terrorism Risk Insurance Act (TRIA), as amended, requires insurance companies to offer limited terrorism coverage. TRIA coverage will cost 3% of the GL premium, subject to a \$150 minimum.

If purchased, the CG 21 73 Exclusion of Certified Acts of Terrorism will be removed from your policy and the CG 21 70 Cap on Losses from Certified Acts of Terrorism will be added.

Basis, LLC



CONFIDENTIAL

Basis LLC
Transaction #: 5393279

Total General Liability Premium (25% minimum earned) \$515 minimum and deposit



Excess liability indication

Excess Limit	Premium (excluding Terrorism)
\$1,000,000	\$500
\$2,000,000	\$1,000
\$3,000,000	\$1,500
\$4,000,000	\$2,000
\$5,000,000	\$2,500

*The indicated premiums **do not include** any applicable taxes and fees. Coverage for TRIA is additional.

Company: Evanston Insurance Company
Term: 12/29/2022 to 12/29/2023

Governing Class: ISO Code: 61224
Description: Buildings or Premises - office premises primarily occupied by employees of the insured (For-Profit)
Premium base: Area
Underlying GL premium: \$515
Primary state: CO

- This quote does not include underlying auto liability.
- Underlying Employers liability (EL) can be included at no additional charge.
- Please note excess terms will exclude pollution coverage.

This is a premium indication only and may be subject to change. An excess transaction will need to be created and quoted for formal terms and conditions.



Forms and Endorsements

<u>MJIL 1000 08 10</u>	Policy Jacket (Evanston)
<u>MPIL 1007 01 20</u>	Privacy Notice
<u>MPIL 1041 02 20</u>	How To Report A Claim
<u>MPIL 1083 04 15</u>	U.S. Treasury Department's Office Of Foreign Assets Control (OFAC) Advisory Notice To Policyholders
<u>MDIL 1000 08 11</u>	Common Policy Declaration <i>Form of Business: Limited Liability Corporation</i>
<u>MDIL 1001 08 11</u>	Forms Schedule
<u>IL 00 17 11 98</u>	Common Policy Conditions
<u>IL 00 21 09 08</u>	Nuclear Energy Liability Exclusion Endorsement
<u>MEIL 1200 02 20</u>	Service Of Suit
<u>MEIL 1225 10 11</u>	Change - Civil Union
<u>MIL 1214 09 17</u>	Trade Or Economic Sanctions
<u>MDGL 1008 08 11</u>	Commercial General Liability Coverage Part Declarations
<u>CG 00 01 04 13</u>	Commercial General Liability Coverage Form
<u>CG 20 11 04 13</u>	Additional Insured - Managers Or Lessors Of Premises
<u>CG 21 04 11 85</u>	Exclusion-Products-Completed Operations Hazard
<u>CG 21 36 03 05</u>	New Entities Exclusion
<u>CG 21 38 11 85</u>	Personal and Advertising Injury Exclusion
<u>CG 21 39 10 93</u>	Contractual Liability Limitation
<u>CG 21 44 04 17</u>	Limitation of Coverage to Designated Premises, Project or Operation
<u>CG 21 47 12 07</u>	Employment - Related Practices Exclusion
<u>CG 21 49 09 99</u>	Total Pollution Exclusion Endorsement
<u>CG 21 73 01 15</u>	Exclusion Of Certified Acts Of Terrorism
<u>MEGL 0001 08 20</u>	Combination General Endorsement
<u>MEGL 0008 04 20</u>	Exclusion - Continuous or Progressive Injury or Damage
<u>MEGL 0126 05 16</u>	Amendment Of Liquor Liability Exclusion
<u>MEGL 1636 10 19</u>	Exclusion - Employer's Liability And Bodily Injury To Contractors Or Subcontractors In Designated States
<u>MEGL 2322 05 21</u>	Exclusion - Communicable Disease
<u>MGL 1319 01 16</u>	Exclusion - Unmanned Aircraft
<u>MGL 1356 10 20</u>	Exclusion - Cyber Incident, Data Compromise, And Violation Of Statutes Related To Personal Data



EVANSTON INSURANCE COMPANY
POLICYHOLDER DISCLOSURE
NOTICE OF TERRORISM INSURANCE COVERAGE

Date: December 29, 2022
Policyholder/Applicant Name: Basis LLC
Policy Number (if applicable):

You are hereby notified that under the Terrorism Risk Insurance Act, as amended, you have a right to purchase insurance coverage for losses resulting from acts of terrorism, as defined in Section 102(1) of the Act. The term "act of terrorism" means any act that is certified by the Secretary of the Treasury, in consultation with the Secretary of Homeland Security, and the Attorney General of the United States to be an act of terrorism; to be a violent act or an act that is dangerous to human life, property, or infrastructure; to have resulted in damage within the United States, or outside the United States in the case of certain air carriers or vessels or the premises of a United States mission; and to have been committed by an individual or individuals as part of an effort to coerce the civilian population of the United States or to influence the policy or affect the conduct of the United States Government by coercion.

YOU SHOULD KNOW THAT WHERE COVERAGE IS PROVIDED BY THIS POLICY FOR LOSSES RESULTING FROM CERTIFIED ACTS OF TERRORISM, SUCH LOSSES MAY BE PARTIALLY REIMBURSED BY THE UNITED STATES GOVERNMENT UNDER A FORMULA ESTABLISHED BY FEDERAL LAW. HOWEVER, YOUR POLICY MAY CONTAIN OTHER EXCLUSIONS WHICH MIGHT AFFECT YOUR COVERAGE, SUCH AS AN EXCLUSION FOR NUCLEAR EVENTS. UNDER THE FORMULA, THE UNITED STATES GOVERNMENT GENERALLY REIMBURSES 85% THROUGH 2015; 84% BEGINNING ON JANUARY 1, 2016; 83% BEGINNING ON JANUARY 1, 2017; 82% BEGINNING ON JANUARY 1, 2018; 81% BEGINNING ON JANUARY 1, 2019 AND 80% BEGINNING ON JANUARY 1, 2020 OF COVERED TERRORISM LOSSES EXCEEDING THE STATUTORILY ESTABLISHED DEDUCTIBLE PAID BY THE INSURANCE COMPANY PROVIDING THE COVERAGE. THE PREMIUM CHARGED FOR THIS COVERAGE IS PROVIDED BELOW AND DOES NOT INCLUDE ANY CHARGES FOR THE PORTION OF LOSS THAT MAY BE COVERED BY THE FEDERAL GOVERNMENT UNDER THE ACT.

YOU SHOULD ALSO KNOW THAT THE TERRORISM RISK INSURANCE ACT, AS AMENDED, CONTAINS A \$100 BILLION CAP THAT LIMITS U.S. GOVERNMENT REIMBURSEMENT AS WELL AS INSURERS' LIABILITY FOR LOSSES RESULTING FROM CERTIFIED ACTS OF TERRORISM WHEN THE AMOUNT OF SUCH LOSSES IN ANY ONE CALENDAR YEAR EXCEEDS \$100 BILLION. IF THE AGGREGATE INSURED LOSSES FOR ALL INSURERS EXCEED \$100 BILLION, YOUR COVERAGE MAY BE REDUCED.

SELECTION OR REJECTION OF TERRORISM INSURANCE COVERAGE
PLEASE "X" ONE OF THE BOXES BELOW AND TAKE THE ACTION INDICATED.

Table with 2 rows and 2 columns. Row 1: [] | I hereby elect to purchase terrorism coverage for a prospective premium of \$150.00. Row 2: [] | I hereby decline to purchase terrorism coverage for certified acts of terrorism. I understand that I will have no coverage for losses resulting from certified acts of terrorism.

Policyholder/Applicant Signature

Print Name

Date



We are pleased to introduce you to Stetson Insurance Funding, LLC ("Stetson") an affiliate of Ryan Specialty Group that operates its premium finance business. Stetson will be providing an automated premium finance agreement for your clients' commercial insurance risks placed through RT Specialty.

Stetson has teamed up with FIRST Insurance Funding ("FIRST"), the largest premium finance company in North America. Under this collaboration, FIRST will be the lender, as listed on the premium finance agreement, and the loan will be serviced by FIRST. Stetson will be your main point of contact throughout the life of the loan and provide ongoing support to your agency.

EASY SET UP FOR AGENTS TO OBTAIN FINANCING:

1. Receive an automated premium finance agreement with eligible commercial insurance risks placed through RT Specialty.
2. Make changes to the premium finance agreement by:
 - Visiting our website at www.stetsonfunding.com
 - Emailing us at quotes@stetsonfunding.com
 - Calling us at 1-866-856-1112
3. Down payment to be collected by the agent from the insured in good funds and sent to the General Agent or Carrier.
4. Return the signed premium finance agreement to agreements@stetsonfunding.com.
5. Stetson will finalize the loan and have funding issued for the amount financed.

We look forward to exceeding your premium financing expectations.



COLORADO
Department of
Regulatory Agencies
Division of Insurance

PRODUCING AGENT (RETAIL PRODUCER OR SURPLUS LINES BROKER) DILIGENT EFFORT AFFIDAVIT
(§§ 10-5-103, 10-5-103.5, C.R.S., & Section 6 of Regulation 2-4-1)

As a surplus lines broker, I have determined, or if the insurance was produced by a retail producer, I have relied upon the retail producer to determine that the full amount of insurance required was not procurable, after diligent effort had been made to do so, from among at least three (3) admitted insurers authorized to and actually transacting that line of business in this state.

Name of Producing Agent (Retail Producer or Surplus Lines Broker)
declares he/she is the holder of a current Colorado Producer License Number
at (Name of Colorado Licensed Insurance Agency)

Has sought to obtain (Type of Coverage & Description of Risk)

For Named Insured Basis LLC Azul for a New or Renewal

Policy Number APP154068168 Effective Date 12/29/2022 to 12/29/2023

from the following three admitted insurers currently transacting this line of business in this state:
Please enter complete names of three (3) Colorado Admitted Insurers that declined to write this policy.

- (1) NAIC# Reason
(2) NAIC# Reason
(3) NAIC# Reason

The policy listed above has been produced by me, the above-named Retail Producer or Surplus Lines Broker, and my signature herein is evidence that the insurance is eligible for export (to be placed in the Non-Admitted Surplus Lines Market through a Colorado Surplus Lines Broker) under §10-5-103, C.R.S.

Signature of above-named Producing Agent Printed or Typed Name Date

This affidavit must be completed and signed by the Producing Agent (Retail Producer or Surplus Lines Broker), and Brokers placing the insurance shall keep a full and true record in the Surplus Lines Broker's office. The record shall at all times be open to examination by the commissioner. Please do not submit the affidavit to the Colorado Division of Insurance. Email questions to:
dora_coloradoinsurancesurpluslinestax@state.co.us





7501 E. Lowry Blvd.
 Denver, CO 80230-7006
 303.361.4000 / 800.873.7242
 Pinnacol.com

Insurance Quote

December 29, 2022
 Application ID: 9466846
 LCM: Allegiance

Basis LLC
 421 Brach Dr
 Grand Junction, CO 81507-2757

Six & Geving, a Higginbotham Compan
 3630 Sinton Road
 Ste 200
 Colorado Springs, CO 80907
 (720) 962-0930

The premium estimate provided expires 30 days from issuance. After expiration of the premium estimate, please contact Pinnacol Assurance for an updated estimate. Quote subject to change based on underwriter analysis and review of all information including classification, payroll, and verification of prior loss data.

Coverage Information for 9466846

QUOTED

Location: Basis LLC
 421 Brach Dr
 Grand Junction, CO 81507-2757

Period: 01/15/2023 - 01/01/2024

Class	RT	Description	Emp	Payroll	Rate	Prem Charge
804505	EM	Store-drug-retail	4.00	\$192,329	.638400	\$1,228
804505	MB	Store-drug-retail	1.00	\$67,507	.638400	\$431
		Name Dan Ramsay				
881005	MB	Clerical office employees NOC	1.00	\$67,507	.100800	\$68
		Name Nicholas Easley				
881005	MB	Clerical office employees NOC	1.00	\$67,507	.100800	\$68
		Name Kate Ramsay				
881005	MB	Clerical office employees NOC	1.00	\$67,507	.100800	\$68
		Name Alanna Spees				
881005	MB	Clerical office employees NOC	1.00	\$67,507	.100800	\$68
		Name Oliver Spees				
Total for Basis LLC				\$529,864		\$1,931

Description	Period	Adjustment	Amount
Ratable Manual Premium	01/15/2023 - 01/01/2024		\$1,931
Increased Limits (1,000,000/1,000,000/1,000,000)	01/15/2023 - 01/01/2024	1.011	\$21
Increased Limits Minimum Premium	01/15/2023 - 01/01/2024		\$94
Designated Provider Discount	01/15/2023 - 01/01/2024	.975	\$51-
Pinnacol Edge Discount	01/15/2023 - 01/01/2024	.900	\$200-
Annual Policy Fee	01/15/2023 - 01/01/2024		\$160
Terrorism Insurance Coverage	01/15/2023 - 01/01/2024		\$26
Catastrophe Insurance Coverage	01/15/2023 - 01/01/2024		\$53
Net Estimated Annual Premium	01/15/2023 - 01/01/2024		\$2,034

Policyholder Disclosure Notice of Terrorism and Catastrophe Insurance Coverage

Coverage for acts of terrorism is included in your policy. Under your existing coverage, any losses resulting from certified acts of terrorism would be partially reimbursed by the United States Government. Beginning January 1, 2016:

1. Insured Losses would be partially reimbursed by the United States Government. If the aggregate industry Insured Losses occurring in any calendar year exceed \$200,000,000, the United States Government would pay 80% of our Insured Losses that exceed our Insurer Deductible.
2. Notwithstanding item 1 above, the United States Government will not make any payment under the Act for any portion of Insured Losses that exceed \$100,000,000,000.
3. The premium charge for the coverage your policy provides for Insured Losses is included in the amount shown in Item 4 of the Information Page or in the Schedule below.

Premium for terrorism is calculated on the basis of total payroll. The total Colorado payroll is divided by \$100 and multiplied by the approved terrorism rate, \$0.005 per \$100 of payroll. The calculation is expressed as (Colorado payroll/\$100 X Approved Terrorism Rate = Premium). This premium is not subject to any other modification including, but not limited to, premium discount, experience rating, schedule rating, or retrospective rating.

Additionally, all workers' compensation carriers are required to charge premium to cover large losses. Premium for Catastrophe (other than Certified Acts of Terrorism) is calculated on the basis of total payroll. The total Colorado payroll is divided by \$100 and multiplied by the approved Catastrophe (other than Certified Acts of Terrorism) rate, \$0.01 per \$100 of payroll. The calculation is expressed as (Colorado payroll/ \$100 X Catastrophe (other than Certified Acts of Terrorism) Value = Premium). This premium is not subject to any other modifications including, but not limited to, premium discount, experience rating, schedule rating, or retrospective rating.

Policy period dates on this quotation are for pricing purposes. This document does **not** imply insurance coverage.

Make Check or Money Order Payable to: Pinnacol Assurance

Basis LLC
421 Brach Dr
Grand Junction, CO 81507-2757

Amount Enclosed \$ _____

Check Number _____

Application # 9466846

Pinnacol Assurance
PO Box 561434
Denver, CO 80256-1434

Amount Due \$510.00
Quote Issue Date 12/29/2022
Quote Expiration Date 01/29/2023

Basis, LLC

HOWARD FAMILY, INC. AUTHORIZATION LETTER

29 Dec 2022
City of Grand Junction
City Clerk
250 N 5th St.
Grand Junction, CO 81501

Re: Business Signature Authorization

This letter is being provided in response to the request from the City of Grand Junction to provide evidence that Hayden Scott Howard is authorized to sign binding contracts including, but not limited to buying, selling, and leasing real property on behalf of Howard Family, Inc. Hayden Scott Howard is the President and sole stockholder of Howard Family Inc. Office address 2606 Partridge Ct, Grand Junction, CO. 81506 . Business records and files are stored in accordance with the business record requirements specified for the Federal, and State statutes.

As sole owner of the Howard Family, Inc., I hereby certify that Hayden Scott Howard, the registered Agent, and President of Howard Family, Inc., is duly authorized to sign binding contracts on behalf of Howard Family, Inc.. This authorization has been in place since the formation of the business (1 December 1989), and is hereby being formally recognized as of 29 Dec 2022.

Signature

Print Name: Hayden Scott Howard

Title: *President*

OFFICE OF THE SECRETARY OF STATE
OF THE STATE OF COLORADO

CERTIFICATE OF FACT OF GOOD STANDING

I, Jena Griswold, as the Secretary of State of the State of Colorado, hereby certify that, according to the records of this office,

HOWARD FAMILY, INC.

is a
Corporation

formed or registered on 12/01/1989 under the law of Colorado, has complied with all applicable requirements of this office, and is in good standing with this office. This entity has been assigned entity identification number 19891109367.

This certificate reflects facts established or disclosed by documents delivered to this office on paper through 12/28/2022 that have been posted, and by documents delivered to this office electronically through 12/30/2022 @ 07:25:09.

I have affixed hereto the Great Seal of the State of Colorado and duly generated, executed, and issued this official certificate at Denver, Colorado on 12/30/2022 @ 07:25:09 in accordance with applicable law. This certificate is assigned Confirmation Number 14570492.



Jena Griswold

Secretary of State of the State of Colorado

*****End of Certificate*****
Note: A certificate issued electronically from the Colorado Secretary of State's website is fully and immediately valid and effective. However, in an effort to ensure the accuracy and validity of a certificate obtained electronically, you may be required to verify the validity of a certificate on the Secretary of State's website, <https://www.colorado.gov/electronic-services/secretary-of-state>, entering the certificate's confirmation number displayed on the certificate and following the instructions displayed. Confirming the validity of a certificate is highly optional and is not necessary to the valid and effective issuance of a certificate. For more information, visit our website, <https://www.colorado.gov/electronic-services/markmarks-trade-names> and select "Frequently Asked Questions."



For this record...
 View history and documents
 Get a certificate of good standing
 File a form
 Subscribe to email notification
 Unsubscribe from email notification
 Subscribe to text notification
 Unsubscribe from text notification

Business Name
 Business Information
 Business Search

FAQ, Glossary and Information

Summary

Details			
Name	HOWARD FAMILY, INC		
Status	Good Standing	Formation date	12/01/1989
ID number	19891120367	Form	Corporation
Periodic report month	December	Jurisdiction	Colorado
Principal office street address	2000 FARTRIDGE CT, GRAND JUNCTION, CO 81505, US		
Principal office mailing address	2000 FARTRIDGE CT, GRAND JUNCTION, CO 81505, US		

Registered Agent	
Name	HAYDEN Scott HOWARD
Street address	2500 FARTRIDGE CT, GRAND JUNCTION, CO 81508, US
Mailing address	2000 FARTRIDGE CT, GRAND JUNCTION, CO 81505, US

- [View history and documents](#)
- [Get a certificate of good standing](#)
- [Get certified copies of documents](#)
- [File a form](#)
- [Get an secure business alert](#)
- [Subscribe to email notification](#)
- [Unsubscribe from email notification](#)
- [Subscribe to text notification](#)
- [Unsubscribe from text notification](#)

5/21

Basis, LLC

Attachment 8

BASIS, LLC AUTHORIZATION LETTER

30 Dec 2022
City of Grand Junction
City Clerk
250 N 5th St.
Grand Junction, CO 81501

Re: Business Signature Authorization

This letter is being provided in response to the request from the City of Grand Junction to provide evidence that Oliver Spees is authorized to sign binding contracts including, but not limited to buying, selling, and leasing real property on behalf of Basis, LLC,. Any, and all business documents signed by Mr. Spees are discussed and reviewed with co-owners to ensure the terms of these agreements are mutually agreed upon by all owners. Copies of the business files finalized by Mr. Spees are provided to other all owners for their record. Business records and files are stored in accordance with the business record requirements specified for the Federal, and State statutes.

As owners of Basis, LLC, we hereby certify that Oliver Spees, the CFO of Basis, LLC, is duly authorized to sign biding contracts on behalf of Basis, LLC. This authorization has been in place since the formation of the business (11 May 2021), but is being formally recognized as of 30 Dec 2022.

Signature: 
Print Name: Alanna Spees
Title: Chief Compliance Officer

DocuSigned by:
Signature: *Oliver W Spees*
Print Name: Oliver Spees
Title: Chief Financial Officer

DocuSigned by:
Signature: *Kate Ramsay*
Print Name: Kate Ramsay
Title: Chief Executive Officer

DocuSigned by:
Signature: *Daniel Ramsay*
Print Name: Daniel Ramsay
Title: Chief Operating Officer

DocuSigned by:
Signature: *Mc Easley*
Print Name: Nicholas Easley
Title: Chief Cannabis Officer

DocuSigned by:
Signature: *Hayden Howard*
Print Name: Hayden Howard
Title: Community Liasion

Additional Personnel Questionnaire

Requirement: The applicant must provide a City of Grand Junction's GJCBL Addendum to DR 8557, for all owners of >10%.

Response: Basis, LLC has provided a City of Grand Junction's GJCBL Addendum to DR 8557, for all of Basis, LLC owners of >10%.

Table of Contents:

Page #2-13: Completed City of Grand Junction's GJCBL Addendum to DR 8557 for Alanna Spees, completed and notarized on 19 May 2022.

Page #14-25: Completed City of Grand Junction's GJCBL Addendum to DR 8557 for Oliver Spees, completed and notarized on 19 May 2022.

Page #26-37: Completed City of Grand Junction's GJCBL Addendum to DR 8557 for Kate Ramsay, completed and notarized on 20 May 2022.

Page #38-49: Completed City of Grand Junction's GJCBL Addendum to DR 8557 for Daniel Ramsay, completed and notarized on 19 May 2022.

Page #50-64: Completed City of Grand Junction's GJCBL Addendum to DR 8557 for Nicholas Easley, completed and notarized on 6 June 2022.

City of Grand Junction Addendum to DR 8557 – Natural Person Suitability Application Form
 Basis, LLC (d.b.a. Azul)

(Owner Information) Cannabis Business Entity Name: _____

The City of Grand Junction requires additional, more stringent criteria for determining the acceptability as a licensee.
 Please answer the following questions in addition to similar questions in the state suitability application.

Applicant's Name (Last, First) Spees, Alanna	Home Address [REDACTED] Grand Junction, CO 81507	Date of Birth (mm/dd/yyyy) [REDACTED]
Email Address alanna@azuldispensary.com	Phone Number(s) [REDACTED]	% Ownership 11.875
Social Security Number [REDACTED]	Driver's License Number [REDACTED]	Driver's License State Colorado
<p>Within the 5 years immediately preceding this application, have you been convicted of any misdemeanor, petty offense or local ordinance related to a drug or controlled substance offense?</p> <p>___ Yes <input checked="" type="checkbox"/> No <u>AMS</u> Initials</p>		
<p>Within the 5 years immediately preceding this application, have you been convicted of any non-drug related felony?</p> <p>___ Yes <input checked="" type="checkbox"/> No <u>AMS</u> Initials</p>		
<p>At any time, have you been convicted of a drug or controlled substance felony?</p> <p>___ Yes <input checked="" type="checkbox"/> No <u>AMS</u> Initials</p>		
<p>Within the 5 years immediately preceding this application, have you been released from incarceration or court-ordered supervision, including a deferred sentence, for a conviction of any felony or crime that would be a felony under Colorado law?</p> <p>___ Yes <input checked="" type="checkbox"/> No <u>AMS</u> Initials</p>		
<p>At any time, have you been convicted of any crime of which fraud or intent to defraud was an element of the offense?</p> <p>___ Yes <input checked="" type="checkbox"/> No <u>AMS</u> Initials</p>		
<p>IF YOU ANSWERED YES TO ANY OF THE ABOVE, COMPLETE ATTACHED CRIMINAL HISTORY SUPPLEMENTAL SHEET</p>		
<p>Have you ever had a professional or occupational license denied, suspended or revoked?</p> <p>___ Yes <input checked="" type="checkbox"/> No <u>AMS</u> Initials</p>		
<p>Have you ever had a business or sales tax license denied, suspended or revoked?</p> <p>___ Yes <input checked="" type="checkbox"/> No <u>AMS</u> Initials</p>		
<p>Have you ever surrendered, been denied, or had any type of cannabis related license or permit placed on an administrative hold, suspended or revoked?</p> <p>___ Yes <input checked="" type="checkbox"/> No <u>AMS</u> Initials</p>		
<p>Have you ever been denied any type of cannabis related business license?</p> <p>___ Yes <input checked="" type="checkbox"/> No <u>AMS</u> Initials</p>		
<p>Have you ever had a business temporarily or permanently closed for failure to comply with any tax, health, building, fire, zoning or safety law?</p> <p>___ Yes <input checked="" type="checkbox"/> No <u>AMS</u> Initials</p>		
<p>Have you ever had any administrative, civil or criminal finding of delinquency for failure to file or failure to pay state or local sales or use taxes or any other taxes?</p> <p>___ Yes <input checked="" type="checkbox"/> No <u>AMS</u> Initials</p>		
<p>IF YOU ANSWERED YES TO ANY OF THE ABOVE, COMPLETE ATTACHED LICENSE DISCIPLINE HISTORY SUPPLEMENTAL SHEET</p>		

<p>Have you ever been arrested, served with a criminal summons, charged with, or convicted of any crime or offense in any manner in this or any other state?</p> <ul style="list-style-type: none"> You must include all arrests, charges and convictions regardless of the outcome, even if the charges were dismissed or you were found not guilty. You must include all arrests, charges and convictions regardless of the class of the crime (felonies, misdemeanors and/or petty offenses). You must include all serious traffic offenses, including DUI, DWAI, reckless driving, leaving the scene of an accident, driving under suspension, revocation or denial, or any other offense which resulted in you being taken into custody or served with a summons into Court. <p>NOTICE: Do not rely upon your understanding that an arrest or charge is "not supposed to be on my record." A criminal record was not cleared, erased, sealed or expunged unless you were given, and have in your possession, a written order from a Judge directing that action.</p> <p>IF YOU ANSWERED YES ABOVE, COMPLETE ATTACHED CRIMINAL HISTORY SUPPLEMENTAL SHEET</p>	<p>___ Yes <input checked="" type="checkbox"/> No <u>AMS</u> Initials</p>
<p>Have you (as an individual, as a member of a partnership or other form of domestic or foreign business entity, or as an owner, director, or officer of a corporation) ever been a party to a lawsuit (other than divorces) either as a plaintiff or defendant, complainant or respondent, or in any other fashion, in this or any other state? This includes all civil litigation, regardless of the type of lawsuit or the court of jurisdiction. List all cases without exception, including bankruptcies and cases in Small Claims Courts.</p> <p>IF YOU ANSWERED YES ABOVE, COMPLETE ATTACHED CIVIL LITIGATION HISTORY SUPPLEMENTAL SHEET</p>	<p>___ Yes <input checked="" type="checkbox"/> No <u>AMS</u> Initials</p>

For each offense for which you were arrested or charged, **YOU MUST OBTAIN OFFICIAL DOCUMENTATION FROM THE COURT WHERE YOU APPEARED, SHOWING THE FINAL DISPOSITION (OUTCOME) OF YOUR CASE.** If you received a deferred judgment, a deferred sentence or probation, your documentation must include the date that you were discharged or released from probation or other supervision.

On the attached license data history supplemental sheet, list all locations where you have had a professional, occupational, business or sales tax license, where you have owned and/or operated a business and the name of your business(es).

If you were in the Armed Forces, please complete the attached Military history supplemental sheet.

I attest that all information I have provided on this Addendum and supplemental documents is true and accurate to the best of my knowledge and acknowledge any omissions and/or falsifications may result in denial or revocation of a regulated cannabis license.

 (Signature) | 05 / 18 / 2022
 (Date)

INVESTIGATION AUTHORIZATION / AUTHORIZATION TO RELEASE INFORMATION

I, Alanna Mieko Spees, hereby authorize the City of Grand Junction, the City of Grand Junction Licensing Authority and the City of Grand Junction Police Department (hereafter, the Investigatory Agencies) to conduct a complete investigation into my personal background, using whatever legal means they deem appropriate. I hereby authorize any person or entity contacted by the Investigatory Agencies to provide any and all such information deemed necessary by the Investigatory Agencies. I hereby waive any rights of confidentiality in this regard. I understand that by signing this authorization, a financial record check may be performed. I authorize any financial institution to surrender to the Investigatory Agencies a complete and accurate record of such transactions that may have occurred with that institution, including, but not limited to, internal banking memoranda, past and present loan applications, financial statements and any other documents relating to my personal or business financial records in whatever form and wherever located. I authorize the release of this type of information, even though such information may be designated as "confidential" or "nonpublic" under the provisions of state or federal laws.

I understand that by signing this authorization a criminal history check will be performed. I authorize the Investigatory Agencies to obtain and use from any source, any information concerning me contained in any type of criminal history record files, wherever located. I understand that the criminal history record files contain records of arrests which may have resulted in a disposition other than a finding of guilt. I understand that the information may contain listings of charges that resulted in suspended imposition of sentence, even though I successfully completed the conditions of said sentence and was discharged pursuant to law. I authorize the release of this type of information, even though this record may be designated as "confidential" or "nonpublic" under the provisions of state or federal laws.

The Investigatory Agencies reserve the right to investigate all relevant information and facts to their satisfaction. I understand that the Investigatory Agencies may conduct a complete and comprehensive investigation to determine the accuracy of all information gathered. However, the City of Grand Junction, Investigatory Agencies, and other agents or employees of the City of Grand Junction shall not be held liable for the receipt, use or dissemination of inaccurate information. I, on behalf of the applicant, its legal representatives, and assigns, hereby release, waive, discharge and agree to hold harmless, and otherwise waive liability as to the City of Grand Junction, Investigatory Agencies, and other agents or employees of the City of Grand Junction for any damages resulting from any use, disclosure, or publication in any manner, other than a willfully unlawful disclosure or publication, of any material or information acquired during inquiries, investigations, or hearings, and hereby authorize the lawful use, disclosure, or publication of this material or information. Any information contained within my application, contained within any financial or personnel record, or otherwise found, obtained, or maintained by the Investigatory Agencies, shall be accessible to Law Enforcement agents of this or any other state or the government of the United States.

PRINT FULL LEGAL NAME OF OWNER CLEARLY BELOW:			
Applicant's Legal Business Name Basis, LLC		Trade Name (DBA) Azul	
Applicant's Last Name (Please Print) Spees	Applicant's First Name Alanna	Applicant's Middle Name Mieko	Applicant's Date of Birth [REDACTED]
Signature (Notarized) [REDACTED]			Date 5/19/2022

State of <u>Colorado</u>	County of <u>Mesa</u>
Subscribed and Sworn to before me this <u>19th</u> day of <u>May</u> , 20 <u>22</u>	

NOTARY

My Commission expires: 6/25/2024 Notary Public Toby Mason

PUBLIC



City of Grand Junction Criminal History Supplemental Sheet

Date	Charge	City	County	State	Disposition/Outcome
N/A	N/A	N/A	N/A	N/A	N/A
Details: N/A					

Date	Charge	City	County	State	Disposition/Outcome
N/A	N/A	N/A	N/A	N/A	N/A
Details: N/A					

Date	Charge	City	County	State	Disposition/Outcome
N/A	N/A	N/A	N/A	N/A	N/A
Details: N/A					

Date	Charge	City	County	State	Disposition/Outcome
N/A	N/A	N/A	N/A	N/A	N/A
Details: N/A					

Date	Charge	City	County	State	Disposition/Outcome
N/A	N/A	N/A	N/A	N/A	N/A
Details: N/A					

City of Grand Junction License Data History Supplemental Sheet

Dates	Current	Type of License	City	County	State	Name of Business
01/19 to ___/___ (mm/yy) (mm/yy)		Business	Cheyenne	Laramie	WY	Climbers Crossing Real Estate, LLC

Dates	Current	Type of License	City	County	State	Name of Business
05/19 to ___/___ (mm/yy) (mm/yy)		Business	Colorado Springs	El Paso	CO	Cresthaven Wealth Design, Inc

Dates	Current	Type of License	City	County	State	Name of Business
03/19 to ___/___ (mm/yy) (mm/yy)		Business	Colorado Springs	El Paso	CO	Red Mountain Events, LLC

Dates	Type of License	City	County	State	Name of Business
___/___ to ___/___ (mm/yy) (mm/yy)	N/A	N/A	N/A	N/A	N/A

Dates	Type of License	City	County	State	Name of Business
___/___ to ___/___ (mm/yy) (mm/yy)	N/A	N/A	N/A	N/A	N/A

Dates	Type of License	City	County	State	Name of Business
___/___ to ___/___ (mm/yy) (mm/yy)	N/A	N/A	N/A	N/A	N/A

Dates	Type of License	City	County	State	Name of Business
___/___ to ___/___ (mm/yy) (mm/yy)	N/A	N/A	N/A	N/A	N/A

Dates	Type of License	City	County	State	Name of Business
___/___ to ___/___ (mm/yy) (mm/yy)	N/A	N/A	N/A	N/A	N/A

Dates	Type of License	City	County	State	Name of Business
___/___ to ___/___ (mm/yy) (mm/yy)	N/A	N/A	N/A	N/A	N/A

Dates	Type of License	City	County	State	Name of Business
___/___ to ___/___ (mm/yy) (mm/yy)	N/A	N/A	N/A	N/A	N/A

Dates	Type of License	City	County	State	Name of Business
___/___ to ___/___ (mm/yy) (mm/yy)	N/A	N/A	N/A	N/A	N/A

City of Grand Junction License Discipline History Supplemental Sheet

Date	Type of License	City	County	State	Reason for Denial/Suspension/Revocation
N/A	N/A	N/A	N/A	N/A	N/A
Details: N/A					

Date	Type of License	City	County	State	Reason for Denial/Suspension/Revocation
N/A	N/A	N/A	N/A	N/A	N/A
Details: N/A					

Date	Type of License	City	County	State	Reason for Denial/Suspension/Revocation
N/A	N/A	N/A	N/A	N/A	N/A
Details: N/A					

Date	Type of License	City	County	State	Reason for Denial/Suspension/Revocation
N/A	N/A	N/A	N/A	N/A	N/A
Details: N/A					

Date	Type of License	City	County	State	Reason for Denial/Suspension/Revocation
N/A	N/A	N/A	N/A	N/A	N/A

Details:
 N/A

City of Grand Junction Civil Litigation History Supplemental Sheet

Date	Type of Civil Action	City	County	State	Disposition/Outcome
N/A	N/A	N/A	N/A	N/A	N/A

Were you: Plaintiff Defendant Complainant Respondent Other _____
 N/A

Details:
 N/A

Date	Type of Civil Action	City	County	State	Disposition/Outcome
N/A	N/A	N/A	N/A	N/A	N/A

Were you: Plaintiff Defendant Complainant Respondent Other _____
 N/A

Details:
 N/A

Date	Type of Civil Action	City	County	State	Disposition/Outcome
N/A	N/A	N/A	N/A	N/A	N/A

Were you: Plaintiff Defendant Complainant Respondent Other _____
 N/A

Details:

N/A

City of Grand Junction Military History Supplemental Sheet

Branch of Service: _____ N/A

Dates of Service: _____ N/A

Type of Discharge: _____ N/A

Rank/Title When Discharged: _____ N/A

If you were ever involved in any type of disciplinary action while in the Military, including but not limited to, Captain's Mast, Article 15 or a Court Martial, provide the following information:

Date	Charge	Duty Station	County	State	Disposition/Outcome
N/A	N/A	N/A	N/A	N/A	N/A
Details: N/A					

Date	Charge	Duty Station	County	State	Disposition/Outcome
N/A	N/A	N/A	N/A	N/A	N/A
Details: N/A					

Date	Charge	Duty Station	County	State	Disposition/Outcome
N/A	N/A	N/A	N/A	N/A	N/A

Details: N/A

City of Grand Junction Personal Reference Sheet

Please list at least three personal references, excluding family members, that we may contact.

Name Morgan Kareus	Address [REDACTED] Grand Junction, CO 81507	Telephone Number [REDACTED]
E-Mail [REDACTED]	Relationship to You Supervisor, friend	
What Information Will This Contact Provide? Morgan has known Alanna personally for about 8 years, and professionally for about 3. Alanna has since become a volunteer at Morgans successful and growing non-profit organization, where Morgan is her mentor, teacher and direct supervisor. Morgan is able to give current and relevant insight into Alanna's integrity, work ethic, sense of importance for personal relationships and community responsibility.		

Name Jerry Ives	Address [REDACTED] Denver, CO 80206	Telephone Number [REDACTED]
E-Mail [REDACTED]	Relationship to You Professional, tenant	
What Information Will This Contact Provide? Jerry is a current tenant that is renting a home that Alanna directly owns and manages. Jerry has known Alanna for two years and works closely with her for any and all issues regarding this landlord/tenant relationship. Jerry can speak to Alanna's prompt actions to any problems or issues that arise, her professionalism, detailed organization, care and adaptability to get the job done right.		

Name Kiele Wilson	Address [REDACTED] Fruita, CO 81521	Telephone Number [REDACTED]
E-Mail [REDACTED]	Relationship to You Friend	
What Information Will This Contact Provide? Kiele and Alanna have known each other for almost 9 years. Kiele is a driven and successful local business owner and operator in the Grand Valley. During their many years of friendship, Kiele and Alanna have developed a great understanding of each other. Kiele can attest to Alanna's thoughtfulness, honesty, trustworthiness and desire to find solutions to both professional and personal challenges.		



CONFIDENTIAL

CONFIDENTIAL



City of Grand Junction Addendum to DR 8557 – Natural Person Suitability Application Form

(Owner Information) Cannabis Business Entity Name: Basis, LLC DBA Azul

The City of Grand Junction requires additional, more stringent criteria for determining the acceptability as a licensee.

Please answer the following questions in addition to similar questions in the state suitability application.

Applicant's Name (Last, First) Spees, Oliver	Home Address [REDACTED] Grand Junction, CO 81507	Date of Birth (mm/dd/yyyy) [REDACTED]
Email Address oliver@azuldispensary.com	Phone Number(s) [REDACTED]	% Ownership 11.875
Social Security Number [REDACTED]	Driver's License Number [REDACTED]	Driver's License State Colorado
<p>Within the 5 years immediately preceding this application, have you been convicted of any misdemeanor, petty offense or local ordinance related to a drug or controlled substance offense?</p> <p>Within the 5 years immediately preceding this application, have you been convicted of any non-drug related felony?</p> <p>At any time, have you been convicted of a drug or controlled substance felony?</p> <p>Within the 5 years immediately preceding this application, have you been released from incarceration or court-ordered supervision, including a deferred sentence, for a conviction of any felony or crime that would be a felony under Colorado law?</p> <p>At any time, have you been convicted of any crime of which fraud or intent to defraud was an element of the offense?</p> <p>IF YOU ANSWERED YES TO ANY OF THE ABOVE, COMPLETE ATTACHED CRIMINAL HISTORY SUPPLEMENTAL SHEET</p>		<p>___ Yes <input checked="" type="checkbox"/> No <u>OWJ</u> Initials</p> <p>___ Yes <input checked="" type="checkbox"/> No <u>OWJ</u> Initials</p> <p>___ Yes <input checked="" type="checkbox"/> No <u>OWJ</u> Initials</p> <p>___ Yes <input checked="" type="checkbox"/> No <u>OWJ</u> Initials</p> <p>___ Yes <input checked="" type="checkbox"/> No <u>OWJ</u> Initials</p>
<p>Have you ever had a professional or occupational license denied, suspended or revoked?</p> <p>Have you ever had a business or sales tax license denied, suspended or revoked?</p> <p>Have you ever surrendered, been denied, or had any type of cannabis related license or permit placed on an administrative hold, suspended or revoked?</p> <p>Have you ever been denied any type of cannabis related business license?</p> <p>Have you ever had a business temporarily or permanently closed for failure to comply with any tax, health, building, fire, zoning or safety law?</p> <p>Have you ever had any administrative, civil or criminal finding of delinquency for failure to file or failure to pay state or local sales or use taxes or any other taxes?</p> <p>IF YOU ANSWERED YES TO ANY OF THE ABOVE, COMPLETE ATTACHED LICENSE DISCIPLINE HISTORY SUPPLEMENTAL SHEET</p>		<p>___ Yes <input checked="" type="checkbox"/> No <u>OWJ</u> Initials</p> <p>___ Yes <input checked="" type="checkbox"/> No <u>OWJ</u> Initials</p> <p>___ Yes <input checked="" type="checkbox"/> No <u>OWJ</u> Initials</p> <p>___ Yes <input checked="" type="checkbox"/> No <u>OWJ</u> Initials</p> <p>___ Yes <input checked="" type="checkbox"/> No <u>OWJ</u> Initials</p> <p>___ Yes <input checked="" type="checkbox"/> No <u>OWJ</u> Initials</p>



<p>Have you ever been arrested, served with a criminal summons, charged with, or convicted of any crime or offense in any manner in this or any other state?</p> <ul style="list-style-type: none"> You must include all arrests, charges and convictions regardless of the outcome, even if the charges were dismissed or you were found not guilty. You must include all arrests, charges and convictions regardless of the class of the crime (felonies, misdemeanors and/or petty offenses). You must include all serious traffic offenses, including DUI, DWAI, reckless driving, leaving the scene of an accident, driving under suspension, revocation or denial, or any other offense which resulted in you being taken into custody or served with a summons into Court. <p>NOTICE: Do not rely upon your understanding that an arrest or charge is "not supposed to be on my record." A criminal record was not cleared, erased, sealed or expunged unless you were given, and have in your possession, a written order from a Judge directing that action.</p> <p>IF YOU ANSWERED YES ABOVE, COMPLETE ATTACHED CRIMINAL HISTORY SUPPLEMENTAL SHEET</p>	<p>___ Yes <input checked="" type="checkbox"/> No <u>OWJ</u> Initials</p>
<p>Have you (as an individual, as a member of a partnership or other form of domestic or foreign business entity, or as an owner, director, or officer of a corporation) ever been a party to a lawsuit (other than divorces) either as a plaintiff or defendant, complainant or respondent, or in any other fashion, in this or any other state? This includes all civil litigation, regardless of the type of lawsuit or the court of jurisdiction. List all cases without exception, including bankruptcies and cases in Small Claims Courts.</p> <p>IF YOU ANSWERED YES ABOVE, COMPLETE ATTACHED CIVIL LITIGATION HISTORY SUPPLEMENTAL SHEET</p>	<p>___ Yes <input checked="" type="checkbox"/> No <u>OWJ</u> Initials</p>

For each offense for which you were arrested or charged, **YOU MUST OBTAIN OFFICIAL DOCUMENTATION FROM THE COURT WHERE YOU APPEARED, SHOWING THE FINAL DISPOSITION (OUTCOME) OF YOUR CASE.** If you received a deferred judgment, a deferred sentence or probation, your documentation must include the date that you were discharged or released from probation or other supervision.

On the attached license data history supplemental sheet, list all locations where you have had a professional, occupational, business or sales tax license, where you have owned and/or operated a business and the name of your business(es).

If you were in the Armed Forces, please complete the attached Military history supplemental sheet.

I attest that all information I have provided on this Addendum and supplemental documents is true and accurate to the best of my knowledge and acknowledge any omissions and/or falsifications may result in denial or revocation of a regulated cannabis license.

 | 05 / 18 / 2022
 (Signature) (Date)

INVESTIGATION AUTHORIZATION / AUTHORIZATION TO RELEASE INFORMATION

I, Oliver William Spees, hereby authorize the City of Grand Junction, the City of Grand Junction Licensing Authority and the City of Grand Junction Police Department (hereafter, the Investigatory Agencies) to conduct a complete investigation into my personal background, using whatever legal means they deem appropriate. I hereby authorize any person or entity contacted by the Investigatory Agencies to provide any and all such information deemed necessary by the Investigatory Agencies. I hereby waive any rights of confidentiality in this regard. I understand that by signing this authorization, a financial record check may be performed. I authorize any financial institution to surrender to the Investigatory Agencies a complete and accurate record of such transactions that may have occurred with that institution, including, but not limited to, internal banking memoranda, past and present loan applications, financial statements and any other documents relating to my personal or business financial records in whatever form and wherever located. I authorize the release of this type of information, even though such information may be designated as "confidential" or "nonpublic" under the provisions of state or federal laws.

I understand that by signing this authorization a criminal history check will be performed. I authorize the Investigatory Agencies to obtain and use from any source, any information concerning me contained in any type of criminal history record files, wherever located. I understand that the criminal history record files contain records of arrests which may have resulted in a disposition other than a finding of guilt. I understand that the information may contain listings of charges that resulted in suspended imposition of sentence, even though I successfully completed the conditions of said sentence and was discharged pursuant to law. I authorize the release of this type of information, even though this record may be designated as "confidential" or "nonpublic" under the provisions of state or federal laws.

The Investigatory Agencies reserve the right to investigate all relevant information and facts to their satisfaction. I understand that the Investigatory Agencies may conduct a complete and comprehensive investigation to determine the accuracy of all information gathered. However, the City of Grand Junction, Investigatory Agencies, and other agents or employees of the City of Grand Junction shall not be held liable for the receipt, use or dissemination of inaccurate information. I, on behalf of the applicant, its legal representatives, and assigns, hereby release, waive, discharge and agree to hold harmless, and otherwise waive liability as to the City of Grand Junction, Investigatory Agencies, and other agents or employees of the City of Grand Junction for any damages resulting from any use, disclosure, or publication in any manner, other than a willfully unlawful disclosure or publication, of any material or information acquired during inquiries, investigations, or hearings, and hereby authorize the lawful use, disclosure, or publication of this material or information. Any information contained within my application, contained within any financial or personnel record, or otherwise found, obtained, or maintained by the Investigatory Agencies, shall be accessible to Law Enforcement agents of this or any other state or the government of the United States.

PRINT FULL LEGAL NAME OF OWNER CLEARLY BELOW:

Applicant's Legal Business Name Basis, LLC		Trade Name (DBA) Azul	
Applicant's Last Name (Please Print) Spees	Applicant's First Name Oliver	Applicant's Middle Name William	Applicant's Date of Birth [REDACTED]
[REDACTED]			Date 5/19/2022

State of Colorado County of Mesa
Subscribed and Sworn to before me this 19th day of May, 2022

NOTARY

My Commission expires: 6/25/2024 Notary Public Toby Mason

PUBLIC



City of Grand Junction Criminal History Supplemental Sheet

Date	Charge	City	County	State	Disposition/Outcome
N/A	N/A	N/A	N/A	N/A	N/A
Details: N/A					

Date	Charge	City	County	State	Disposition/Outcome
N/A	N/A	N/A	N/A	N/A	N/A
Details: N/A					

Date	Charge	City	County	State	Disposition/Outcome
N/A	N/A	N/A	N/A	N/A	N/A
Details: N/A					

Date	Charge	City	County	State	Disposition/Outcome
N/A	N/A	N/A	N/A	N/A	N/A
Details: N/A					

Date	Charge	City	County	State	Disposition/Outcome
N/A	N/A	N/A	N/A	N/A	N/A
Details: N/A					

City of Grand Junction License Data History Supplemental Sheet

Dates Current	Type of License	City	County	State	Name of Business
1/19 to ___/___ (mm/yy) (mm/yy)	Business	Cheyenne	Laramie	WY	Climbers Crossing Real Estate LLC

Dates Current	Type of License	City	County	State	Name of Business
5/19 to ___/___ (mm/yy) (mm/yy)	Business	Cheyenne	Laramie	WY	Cresthaven Wealth Design, Inc.

Dates Current	Type of License	City	County	State	Name of Business
4/22 to ___/___ (mm/yy) (mm/yy)	Business	Montrose	Montrose	CO	Swift Water Investments, LLC

Dates Current	Type of License	City	County	State	Name of Business
10/15 to ___/___ (mm/yy) (mm/yy)	Business	Grand Junction	Mesa	CO	Kelley & Spees Enterprises LLC

Dates	Type of License	City	County	State	Name of Business
___/___ to ___/___ (mm/yy) (mm/yy)	N/A	N/A	N/A	N/A	N/A

Dates	Type of License	City	County	State	Name of Business
___/___ to ___/___ (mm/yy) (mm/yy)	N/A	N/A	N/A	N/A	N/A

Dates	Type of License	City	County	State	Name of Business
___/___ to ___/___ (mm/yy) (mm/yy)	N/A	N/A	N/A	N/A	N/A

Dates	Type of License	City	County	State	Name of Business
___/___ to ___/___ (mm/yy) (mm/yy)	N/A	N/A	N/A	N/A	N/A

Dates	Type of License	City	County	State	Name of Business
___/___ to ___/___ (mm/yy) (mm/yy)	N/A	N/A	N/A	N/A	N/A

Dates	Type of License	City	County	State	Name of Business
___/___ to ___/___ (mm/yy) (mm/yy)	N/A	N/A	N/A	N/A	N/A

Dates	Type of License	City	County	State	Name of Business
___/___ to ___/___ (mm/yy) (mm/yy)	N/A	N/A	N/A	N/A	N/A

City of Grand Junction License Discipline History Supplemental Sheet

Date	Type of License	City	County	State	Reason for Denial/Suspension/Revocation
N/A	N/A	N/A	N/A	N/A	N/A
Details: N/A					

Date	Type of License	City	County	State	Reason for Denial/Suspension/Revocation
N/A	N/A	N/A	N/A	N/A	N/A
Details: N/A					

Date	Type of License	City	County	State	Reason for Denial/Suspension/Revocation
N/A	N/A	N/A	N/A	N/A	N/A
Details: N/A					

Date	Type of License	City	County	State	Reason for Denial/Suspension/Revocation
N/A	N/A	N/A	N/A	N / A	N/A
Details: N/A					

Date	Type of License	City	County	State	Reason for Denial/Suspension/Revocation
N/A	N/A	N/A	N/A	N/A	N/A

Details:
N/A

City of Grand Junction Civil Litigation History Supplemental Sheet

Date	Type of Civil Action	City	County	State	Disposition/Outcome
N/A	N/A	N/A	N/A	N/A	N/A

Were you: Plaintiff Defendant Complainant Respondent Other _____

Details:
N/A

Date	Type of Civil Action	City	County	State	Disposition/Outcome
N/A	N/A	N/A	N /A	N /A	N/A

Were you: Plaintiff Defendant Complainant Respondent Other _____

N /A

Details:
N/A

Date	Type of Civil Action	City	County	State	Disposition/Outcome
N/A	N/A	N/A	N/A	N/A	N/A

Were you: Plaintiff Defendant Complainant Respondent Other _____

N/A

Details:

N/A

City of Grand Junction Military History Supplemental Sheet

Branch of Service: N/A

Dates of Service: N/A

Type of Discharge: N/A

Rank/Title When Discharged: N/A

If you were ever involved in any type of disciplinary action while in the Military, including but not limited to, Captain's Mast, Article 15 or a Court Martial, provide the following information:

Date	Charge	Duty Station	County	State	Disposition/Outcome
N/A	N/A	N/A	N/A	N/A	N/A
Details: N/A					

Date	Charge	Duty Station	County	State	Disposition/Outcome
N/A	N/A	N/A	N/A	N/A	N/A
Details: N/A					

Date	Charge	Duty Station	County	State	Disposition/Outcome
N/A	N/A	N/A	N/A	N/A	N/A

Details:

N/A



City of Grand Junction Personal Reference Sheet

Please list at least three personal references, excluding family members, that we may contact.

Name Dr. Logan McDaneld	Address [REDACTED] Grand Junction, CO 81507	Telephone Number [REDACTED]
E-Mail [REDACTED]	Relationship to You Friend	
What Information Will This Contact Provide? Dr. McDaneld is Chief of Staff at Saint Marys Medical Center and is a Vascular Neurology Specialist. Logan has known Oliver personally for 8 years. He would be able to provide details on his character and ethics.		

Name Ross Kelley	Address [REDACTED] Vista, CA 92081	Telephone Number [REDACTED]
E-Mail rrkelley@fedins.com	Relationship to You Former coworker, current business partner	
What Information Will This Contact Provide? Ross and Oliver met and worked together at Federated Insurance for 3 years. They formed Kelley & Spees Enterprises LLC in 2015 and have built it into a multi-million dollar real estate investment company. Ross would be able to provide examples of Oliver's problems solving, critical thinking skills, and business management abilities.		

Name Dr. Seth Kareus	Address [REDACTED] Grand Junction, CO 81507	Telephone Number [REDACTED]
E-Mail [REDACTED]	Relationship to You Friend	
What Information Will This Contact Provide? Dr. Kareus is a board-certified neurologist at Saint Marys Medical Center. He has known Oliver personally for 8 years. Seth could attest to Oliver's positive attitude and passion. Through travels together Seth would also have insight to Oliver's interpersonal and negotiation skills.		



City of Grand Junction Addendum to DR 8557 – Natural Person Suitability Application Form

(Owner Information) Cannabis Business Entity Name: Basis, LLC, d.b.a Azul

The City of Grand Junction requires additional, more stringent criteria for determining the acceptability as a licensee. Please answer the following questions in addition to similar questions in the state suitability application.

Applicant's Name (Last, First) Ramsay, Kate	Home Address [REDACTED], Whitewater, CO 81527	Date of Birth (mm/dd/yyyy) [REDACTED]
Email Address kate@azuldispensary.com	Phone Number(s) [REDACTED]	% Ownership 23.75%
Social Security Number [REDACTED]	Driver's License Number [REDACTED]	Driver's License State Colorado
<p>Within the 5 years immediately preceding this application, have you been convicted of any misdemeanor, petty offense or local ordinance related to a drug or controlled substance offense?</p> <p>Within the 5 years immediately preceding this application, have you been convicted of any non-drug related felony?</p> <p>At any time, have you been convicted of a drug or controlled substance felony?</p> <p>Within the 5 years immediately preceding this application, have you been released from incarceration or court-ordered supervision, including a deferred sentence, for a conviction of any felony or crime that would be a felony under Colorado law?</p> <p>At any time, have you been convicted of any crime of which fraud or intent to defraud was an element of the offense?</p> <p>IF YOU ANSWERED YES TO ANY OF THE ABOVE, COMPLETE ATTACHED CRIMINAL HISTORY SUPPLEMENTAL SHEET</p>		<p><input type="checkbox"/> Yes <input checked="" type="checkbox"/> No <u>KE</u> Initials</p> <p><input type="checkbox"/> Yes <input checked="" type="checkbox"/> No <u>KE</u> Initials</p> <p><input type="checkbox"/> Yes <input checked="" type="checkbox"/> No <u>KE</u> Initials</p> <p><input type="checkbox"/> Yes <input checked="" type="checkbox"/> No <u>KE</u> Initials</p> <p><input type="checkbox"/> Yes <input checked="" type="checkbox"/> No <u>KE</u> Initials</p>
<p>Have you ever had a professional or occupational license denied, suspended or revoked?</p> <p>Have you ever had a business or sales tax license denied, suspended or revoked?</p> <p>Have you ever surrendered, been denied, or had any type of cannabis related license or permit placed on an administrative hold, suspended or revoked?</p> <p>Have you ever been denied any type of cannabis related business license?</p> <p>Have you ever had a business temporarily or permanently closed for failure to comply with any tax, health, building, fire, zoning or safety law?</p> <p>Have you ever had any administrative, civil or criminal finding of delinquency for failure to file or failure to pay state or local sales or use taxes or any other taxes?</p> <p>IF YOU ANSWERED YES TO ANY OF THE ABOVE, COMPLETE ATTACHED LICENSE DISCIPLINE HISTORY SUPPLEMENTAL SHEET</p>		<p><input type="checkbox"/> Yes <input checked="" type="checkbox"/> No <u>KE</u> Initials</p> <p><input type="checkbox"/> Yes <input checked="" type="checkbox"/> No <u>KE</u> Initials</p> <p><input type="checkbox"/> Yes <input checked="" type="checkbox"/> No <u>KE</u> Initials</p> <p><input type="checkbox"/> Yes <input checked="" type="checkbox"/> No <u>KE</u> Initials</p> <p><input type="checkbox"/> Yes <input checked="" type="checkbox"/> No <u>KE</u> Initials</p> <p><input type="checkbox"/> Yes <input checked="" type="checkbox"/> No <u>KE</u> Initials</p>

<p>Have you ever been arrested, served with a criminal summons, charged with, or convicted of any crime or offense in any manner in this or any other state?</p> <ul style="list-style-type: none"> You must include all arrests, charges and convictions regardless of the outcome, even if the charges were dismissed or you were found not guilty. You must include all arrests, charges and convictions regardless of the class of the crime (felonies, misdemeanors and/or petty offenses). You must include all serious traffic offenses, including DUI, DWAI, reckless driving, leaving the scene of an accident, driving under suspension, revocation or denial, or any other offense which resulted in you being taken into custody or served with a summons into Court. <p>NOTICE: Do not rely upon your understanding that an arrest or charge is “not supposed to be on my record.” A criminal record was not cleared, erased, sealed or expunged unless you were given, and have in your possession, a written order from a Judge directing that action.</p> <p>IF YOU ANSWERED YES ABOVE, COMPLETE ATTACHED CRIMINAL HISTORY SUPPLEMENTAL SHEET</p>	<p><input type="checkbox"/> Yes <input checked="" type="checkbox"/> No <u>KL</u> Initials</p>
<p>Have you (as an individual, as a member of a partnership or other form of domestic or foreign business entity, or as an owner, director, or officer of a corporation) ever been a party to a lawsuit (other than divorces) either as a plaintiff or defendant, complainant or respondent, or in any other fashion, in this or any other state? This includes all civil litigation, regardless of the type of lawsuit or the court of jurisdiction. List all cases without exception, including bankruptcies and cases in Small Claims Courts.</p> <p>IF YOU ANSWERED YES ABOVE, COMPLETE ATTACHED CIVIL LITIGATION HISTORY SUPPLEMENTAL SHEET</p>	<p><input checked="" type="checkbox"/> Yes <input type="checkbox"/> No <u>KL</u> Initials</p>

For each offense for which you were arrested or charged, **YOU MUST OBTAIN OFFICIAL DOCUMENTATION FROM THE COURT WHERE YOU APPEARED, SHOWING THE FINAL DISPOSITION (OUTCOME) OF YOUR CASE.** If you received a deferred judgment, a deferred sentence or probation, your documentation must include the date that you were discharged or released from probation or other supervision.

On the attached license data history supplemental sheet, list all locations where you have had a professional, occupational, business or sales tax license, where you have owned and/or operated a business and the name of your business(es).

If you were in the Armed Forces, please complete the attached Military history supplemental sheet.

I attest that all information I have provided on this Addendum and supplemental documents is true and accurate to the best of my knowledge and acknowledge any omissions and/or falsifications may result in denial or revocation of a regulated cannabis license.

 _____ | 05 / 17 / 2022
 (Signature) (Date)



INVESTIGATION AUTHORIZATION / AUTHORIZATION TO RELEASE INFORMATION

I, Kate Heather Ramsay, hereby authorize the City of Grand Junction, the City of Grand Junction Licensing Authority and the City of Grand Junction Police Department (hereafter, the Investigatory Agencies) to conduct a complete investigation into my personal background, using whatever legal means they deem appropriate. I hereby authorize any person or entity contacted by the Investigatory Agencies to provide any and all such information deemed necessary by the Investigatory Agencies. I hereby waive any rights of confidentiality in this regard. I understand that by signing this authorization, a financial record check may be performed. I authorize any financial institution to surrender to the Investigatory Agencies a complete and accurate record of such transactions that may have occurred with that institution, including, but not limited to, internal banking memoranda, past and present loan applications, financial statements and any other documents relating to my personal or business financial records in whatever form and wherever located. I authorize the release of this type of information, even though such information may be designated as "confidential" or "nonpublic" under the provisions of state or federal laws.

I understand that by signing this authorization a criminal history check will be performed. I authorize the Investigatory Agencies to obtain and use from any source, any information concerning me contained in any type of criminal history record files, wherever located. I understand that the criminal history record files contain records of arrests which may have resulted in a disposition other than a finding of guilt. I understand that the information may contain listings of charges that resulted in suspended imposition of sentence, even though I successfully completed the conditions of said sentence and was discharged pursuant to law. I authorize the release of this type of information, even though this record may be designated as "confidential" or "nonpublic" under the provisions of state or federal laws.

The Investigatory Agencies reserve the right to investigate all relevant information and facts to their satisfaction. I understand that the Investigatory Agencies may conduct a complete and comprehensive investigation to determine the accuracy of all information gathered. However, the City of Grand Junction, Investigatory Agencies, and other agents or employees of the City of Grand Junction shall not be held liable for the receipt, use or dissemination of inaccurate information. I, on behalf of the applicant, its legal representatives, and assigns, hereby release, waive, discharge and agree to hold harmless, and otherwise waive liability as to the City of Grand Junction, Investigatory Agencies, and other agents or employees of the City of Grand Junction for any damages resulting from any use, disclosure, or publication in any manner, other than a willfully unlawful disclosure or publication, of any material or information acquired during inquiries, investigations, or hearings, and hereby authorize the lawful use, disclosure, or publication of this material or information. Any information contained within my application, contained within any financial or personnel record, or otherwise found, obtained, or maintained by the Investigatory Agencies, shall be accessible to Law Enforcement agents of this or any other state or the government of the United States.

PRINT FULL LEGAL NAME OF OWNER CLEARLY BELOW:
Applicant's Legal Business Name: Basis, LLC; Trade Name (DBA): Azul; Applicant's Last Name (Please Print): Ramsay; Applicant's First Name: Kate; Applicant's Middle Name: Heather; Applicant's Date of Birth: [Redacted]; Signature (Notarized): [Redacted]; Date: 05/20/2022

State of Texas County of Collin
Subscribed and Sworn to before me this 20th day of May, 2022

NOTARY

My Commission expires: 08/18/2025 Notary Public Please see below

PUBLIC

JURAT

State/Commonwealth of TEXAS)
)
 City County of Collin)

On 05/20/2022, before me, Brock Repec
Date Notary Name

the foregoing instrument was subscribed and sworn (or affirmed) before me by:

Kate Heather Ramsay
Name of Affiant(s)

- Personally known to me -- OR --
- Proved to me on the basis of the oath of _____ -- OR --
Name of Credible Witness
- Proved to me on the basis of satisfactory evidence: driver license
Type of ID Presented

WITNESS my hand and official seal.

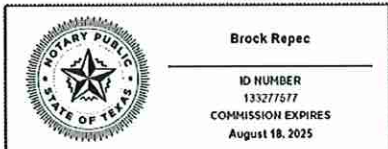

Notary Public Signature: Brock Repec

Notary Name: Brock Repec

Notary Commission Number: 133277577

Notary Commission Expires: 08/18/2025

Notarized online using audio-video communication

DESCRIPTION OF ATTACHED DOCUMENT

Title or Type of Document: natural person application form

Document Date: 05/20/2022

Number of Pages (including notarial certificate): 12

City of Grand Junction Criminal History Supplemental Sheet

Date	Charge	City	County	State	Disposition/Outcome
N/A	N/A	N/A	N/A	N/A	N/A
Details: N/A					

Date	Charge	City	County	State	Disposition/Outcome
N/A	N/A	N/A	N/A	N/A	N/A
Details: N/A					

Date	Charge	City	County	State	Disposition/Outcome
N/A	N/A	N/A	N/A	N/A	N/A
Details: N/A					

Date	Charge	City	County	State	Disposition/Outcome
N/A	N/A	N/A	N/A	N/A	N/A
Details: N/A					

Date	Charge	City	County	State	Disposition/Outcome
N/A	N/A	N/A	N/A	N/A	N/A
Details: N/A					

City of Grand Junction License Data History Supplemental Sheet

Dates	Type of License	City	County	State	Name of Business
07/15 to 09/21 (mm/yy) (mm/yy)	Sales tax	Grand Junction	Mesa	CO	Natural Order Supply, LLC

Dates	Type of License	City	County	State	Name of Business
04/14 to 11/21 (mm/yy) (mm/yy)	Sales tax	Grand Junction	Mesa	CO	Colorado Green Cards, LLC

Dates	Type of License	City	County	State	Name of Business
__/__/__ to __/__/__ (mm/yy) (mm/yy)	N/A	N/A	N/A	N/A	N/A

Dates	Type of License	City	County	State	Name of Business
__/__/__ to __/__/__ (mm/yy) (mm/yy)	N/A	N/A	N/A	N/A	N/A

Dates	Type of License	City	County	State	Name of Business
__/__/__ to __/__/__ (mm/yy) (mm/yy)	N/A	N/A	N/A	N/A	N/A

Dates	Type of License	City	County	State	Name of Business
__/__/__ to __/__/__ (mm/yy) (mm/yy)	N/A	N/A	N/A	N/A	N/A

Dates	Type of License	City	County	State	Name of Business
__/__/__ to __/__/__ (mm/yy) (mm/yy)	N/A	N/A	N/A	N/A	N/A

Dates	Type of License	City	County	State	Name of Business
__/__/__ to __/__/__ (mm/yy) (mm/yy)	N/A	N/A	N/A	N/A	N/A

Dates	Type of License	City	County	State	Name of Business
__/__/__ to __/__/__ (mm/yy) (mm/yy)	N/A	N/A	N/A	N/A	N/A

Dates	Type of License	City	County	State	Name of Business
__/__/__ to __/__/__ (mm/yy) (mm/yy)	N/A	N/A	N/A	N/A	N/A

Dates	Type of License	City	County	State	Name of Business
__/__/__ to __/__/__ (mm/yy) (mm/yy)	N/A	N/A	N/A	N/A	N/A

City of Grand Junction License Discipline History Supplemental Sheet

Date	Type of License	City	County	State	Reason for Denial/Suspension/Revocation
N/A	N/A	N/A	N/A	N/A	N/A
Details: N/A					

Date	Type of License	City	County	State	Reason for Denial/Suspension/Revocation
N/A	N/A	N/A	N/A	N/A	N/A
Details: N/A					

Date	Type of License	City	County	State	Reason for Denial/Suspension/Revocation
N/A	N/A	N/A	N/A	N/A	N/A
Details: N/A					

Date	Type of License	City	County	State	Reason for Denial/Suspension/Revocation
N/A	N/A	N/A	N/A	N/A	N/A
Details: N/A					

Date	Type of License	City	County	State	Reason for Denial/Suspension/Revocation
N/A	NA	N/A	N/A	N/A	N/A

Details: N/A

City of Grand Junction Civil Litigation History Supplemental Sheet

Date	Type of Civil Action	City	County	State	Disposition/Outcome
3/11/22	Contract Dispute	Grand Junction	Mesa	CO	Settled

Were you: Plaintiff Defendant Complainant Respondent Other _____

Details:
 Case Number 2021CV20258
 Location: District Court, County of Mesa, State of Colorado
 Wells Fargo vs. Kate Heather Ramsay
 Settled personal credit card debt with Wells Fargo accrued during the closure of business during the pandemic.

Date	Type of Civil Action	City	County	State	Disposition/Outcome
5/25/22	Contract dispute	Grand Junction	Mesa	CO	Settled

Were you: Plaintiff Defendant Complainant Respondent Other _____

Details:
 Case Number: 2022C030485
 Location: County Court, Mesa County, State of Colorado
 Bank of America Vs. Kate Heather Ramsay
 Settled personal credit card debt with the Bank of America accrued during closure of business during the pandemic.

Date	Type of Civil Action	City	County	State	Disposition/Outcome
N/A	N/A	N/A	N/A	N/A	N/A

Were you: Plaintiff Defendant Complainant Respondent Other _____
 N/A

Details: N/A

City of Grand Junction Military History Supplemental Sheet

Branch of Service: N/A

Dates of Service: N/A

Type of Discharge: N/A

Rank/Title When Discharged: N/A

If you were ever involved in any type of disciplinary action while in the Military, including but not limited to, Captain's Mast, Article 15 or a Court Martial, provide the following information:

Date	Charge	Duty Station	County	State	Disposition/Outcome
N/A	N/A	N/A	N/A	N/A	N/A
Details: N/A					

Date	Charge	Duty Station	County	State	Disposition/Outcome
N/A	N/A	N/A	N/A	N/A	N/A
Details: N/A					

Date	Charge	Duty Station	County	State	Disposition/Outcome
N/A	N/A	N/A	N/A	N/A	N/A

Details: N/A

City of Grand Junction Personal Reference Sheet

Please list at least three personal references, excluding family members, that we may contact.

Name Elaine Heath	Address [REDACTED] Grand Junction, CO 81507	Telephone Number [REDACTED]
E-Mail [REDACTED]	Relationship to You Collaborator on nonprofit work	
What Information Will This Contact Provide? Elaine has collaborated with Kate over the last year on the Save-A-Life Jacket Program via her involvement with the One RiverFront Committee. Laney has helped introduce Kate into the various organizations that have worked jointly to accomplish various governmental and private sector goals through their work together.		

Name Elizabeth Fortushnik	Address [REDACTED] Grand Junction, CO 81507	Telephone Number [REDACTED]
E-Mail elizabeth@gjsup.com	Relationship to You Former coworker at HRL Compliance Solutions Friend, Grand Valley River Fest Cohost	
What Information Will This Contact Provide? Elizabeth worked with Kate during her job as an environmental compliance consultant for numerous years and can speak to her ability to manage compliance driven industry requirements. The two have also collaborated on events such as the Grand Valley River Fest that took place on 14 May 22. They are also friends and have had many family adventures with their kids and husbands.		

Name Gabriel Wilson	Address [REDACTED] Grand Junction, CO 81503	Telephone Number [REDACTED]
E-Mail [REDACTED]	Relationship to You Former Employee	
What Information Will This Contact Provide? Gabe worked for Kate's business, Natural Order Supply, LLC for 2 years and can attest to her administrative professionalism and knowledge of the licit cannabis market through the business's extensive work within the hemp and cannabis industry via sales of cultivation supplies. He can speak to her knowledge as an HR manager and her focus on compliance driving mangement.		

City of Grand Junction Addendum to DR 8557 – Natural Person Suitability Application Form

(Owner Information) Cannabis Business Entity Name: Basis, LLC (d.b.a. Azul)

The City of Grand Junction requires additional, more stringent criteria for determining the acceptability as a licensee. Please answer the following questions in addition to similar questions in the state suitability application.

Applicant's Name (Last, First) Ramsay, Daniel	Home Address [REDACTED] Whitewater, CO 81527	Date of Birth (mm/dd/yyyy) [REDACTED]
Email Address dan@azuldispensary.com	Phone Number(s) [REDACTED]	% Ownership 23.75
Social Security Number [REDACTED]	Driver's License Number [REDACTED]	Driver's License State Colorado
<p>Within the 5 years immediately preceding this application, have you been convicted of any misdemeanor, petty offense or local ordinance related to a drug or controlled substance offense?</p> <p>Within the 5 years immediately preceding this application, have you been convicted of any non-drug related felony?</p> <p>At any time, have you been convicted of a drug or controlled substance felony?</p> <p>Within the 5 years immediately preceding this application, have you been released from incarceration or court-ordered supervision, including a deferred sentence, for a conviction of any felony or crime that would be a felony under Colorado law?</p> <p>At any time, have you been convicted of any crime of which fraud or intent to defraud was an element of the offense?</p> <p>IF YOU ANSWERED YES TO ANY OF THE ABOVE, COMPLETE ATTACHED CRIMINAL HISTORY SUPPLEMENTAL SHEET</p>		<p>___ Yes <input checked="" type="checkbox"/> No <u>DF</u> Initials</p> <p>___ Yes <input checked="" type="checkbox"/> No <u>DF</u> Initials</p> <p>___ Yes <input checked="" type="checkbox"/> No <u>DF</u> Initials</p> <p>___ Yes <input checked="" type="checkbox"/> No <u>DF</u> Initials</p> <p>___ Yes <input checked="" type="checkbox"/> No <u>DF</u> Initials</p>
<p>Have you ever had a professional or occupational license denied, suspended or revoked?</p> <p>Have you ever had a business or sales tax license denied, suspended or revoked?</p> <p>Have you ever surrendered, been denied, or had any type of cannabis related license or permit placed on an administrative hold, suspended or revoked?</p> <p>Have you ever been denied any type of cannabis related business license?</p> <p>Have you ever had a business temporarily or permanently closed for failure to comply with any tax, health, building, fire, zoning or safety law?</p> <p>Have you ever had any administrative, civil or criminal finding of delinquency for failure to file or failure to pay state or local sales or use taxes or any other taxes?</p> <p>IF YOU ANSWERED YES TO ANY OF THE ABOVE, COMPLETE ATTACHED LICENSE DISCIPLINE HISTORY SUPPLEMENTAL SHEET</p>		<p>___ Yes <input checked="" type="checkbox"/> No <u>DF</u> Initials</p> <p>___ Yes <input checked="" type="checkbox"/> No <u>DF</u> Initials</p> <p>___ Yes <input checked="" type="checkbox"/> No <u>DF</u> Initials</p> <p>___ Yes <input checked="" type="checkbox"/> No <u>DF</u> Initials</p> <p>___ Yes <input checked="" type="checkbox"/> No <u>DF</u> Initials</p> <p>___ Yes <input checked="" type="checkbox"/> No <u>DF</u> Initials</p>

<p>Have you ever been arrested, served with a criminal summons, charged with, or convicted of any crime or offense in any manner in this or any other state?</p> <ul style="list-style-type: none"> You must include all arrests, charges and convictions regardless of the outcome, even if the charges were dismissed or you were found not guilty. You must include all arrests, charges and convictions regardless of the class of the crime (felonies, misdemeanors and/or petty offenses). You must include all serious traffic offenses, including DUI, DWAI, reckless driving, leaving the scene of an accident, driving under suspension, revocation or denial, or any other offense which resulted in you being taken into custody or served with a summons into Court. <p>NOTICE: Do not rely upon your understanding that an arrest or charge is "not supposed to be on my record." A criminal record was not cleared, erased, sealed or expunged unless you were given, and have in your possession, a written order from a Judge directing that action.</p> <p>IF YOU ANSWERED YES ABOVE, COMPLETE ATTACHED CRIMINAL HISTORY SUPPLEMENTAL SHEET</p>	<p>Yes <input type="checkbox"/> No <input checked="" type="checkbox"/> Initials <u>DF</u></p>
<p>Have you (as an individual, as a member of a partnership or other form of domestic or foreign business entity, or as an owner, director, or officer of a corporation) ever been a party to a lawsuit (other than divorces) either as a plaintiff or defendant, complainant or respondent, or in any other fashion, in this or any other state? This includes all civil litigation, regardless of the type of lawsuit or the court of jurisdiction. List all cases without exception, including bankruptcies and cases in Small Claims Courts.</p> <p>IF YOU ANSWERED YES ABOVE, COMPLETE ATTACHED CIVIL LITIGATION HISTORY SUPPLEMENTAL SHEET</p>	<p>Yes <input type="checkbox"/> No <input checked="" type="checkbox"/> Initials <u>DF</u></p>

For each offense for which you were arrested or charged, **YOU MUST OBTAIN OFFICIAL DOCUMENTATION FROM THE COURT WHERE YOU APPEARED, SHOWING THE FINAL DISPOSITION (OUTCOME) OF YOUR CASE.** If you received a deferred judgment, a deferred sentence or probation, your documentation must include the date that you were discharged or released from probation or other supervision.

On the attached license data history supplemental sheet, list all locations where you have had a professional, occupational, business or sales tax license, where you have owned and/or operated a business and the name of your business(es).

If you were in the Armed Forces, please complete the attached Military history supplemental sheet.

I attest that all information I have provided on this Addendum and supplemental documents is true and accurate to the best of my knowledge and acknowledge any omissions and/or falsifications may result in denial or revocation of a regulated cannabis license.



 (Signature)

05 / 18 / 2022

 (Date)



INVESTIGATION AUTHORIZATION / AUTHORIZATION TO RELEASE INFORMATION

I, Daniel Steven Ramsay, hereby authorize the City of Grand Junction, the City of Grand Junction Licensing Authority and the City of Grand Junction Police Department (hereafter, the Investigatory Agencies) to conduct a complete investigation into my personal background, using whatever legal means they deem appropriate. I hereby authorize any person or entity contacted by the Investigatory Agencies to provide any and all such information deemed necessary by the Investigatory Agencies. I hereby waive any rights of confidentiality in this regard. I understand that by signing this authorization, a financial record check may be performed. I authorize any financial institution to surrender to the Investigatory Agencies a complete and accurate record of such transactions that may have occurred with that institution, including, but not limited to, internal banking memoranda, past and present loan applications, financial statements and any other documents relating to my personal or business financial records in whatever form and wherever located. I authorize the release of this type of information, even though such information may be designated as "confidential" or "nonpublic" under the provisions of state or federal laws.

I understand that by signing this authorization a criminal history check will be performed. I authorize the Investigatory Agencies to obtain and use from any source, any information concerning me contained in any type of criminal history record files, wherever located. I understand that the criminal history record files contain records of arrests which may have resulted in a disposition other than a finding of guilt. I understand that the information may contain listings of charges that resulted in suspended imposition of sentence, even though I successfully completed the conditions of said sentence and was discharged pursuant to law. I authorize the release of this type of information, even though this record may be designated as "confidential" or "nonpublic" under the provisions of state or federal laws.

The Investigatory Agencies reserve the right to investigate all relevant information and facts to their satisfaction. I understand that the Investigatory Agencies may conduct a complete and comprehensive investigation to determine the accuracy of all information gathered. However, the City of Grand Junction, Investigatory Agencies, and other agents or employees of the City of Grand Junction shall not be held liable for the receipt, use or dissemination of inaccurate information. I, on behalf of the applicant, its legal representatives, and assigns, hereby release, waive, discharge and agree to hold harmless, and otherwise waive liability as to the City of Grand Junction, Investigatory Agencies, and other agents or employees of the City of Grand Junction for any damages resulting from any use, disclosure, or publication in any manner, other than a willfully unlawful disclosure or publication, of any material or information acquired during inquiries, investigations, or hearings, and hereby authorize the lawful use, disclosure, or publication of this material or information. Any information contained within my application, contained within any financial or personnel record, or otherwise found, obtained, or maintained by the Investigatory Agencies, shall be accessible to Law Enforcement agents of this or any other state or the government of the United States.

PRINT FULL LEGAL NAME OF OWNER CLEARLY BELOW:			
Applicant's Legal Business Name Basis, LLC		Trade Name (DBA) Azul	
Applicant's Last Name (Please Print) Ramsay	Applicant's First Name Daniel	Applicant's Middle Name Steven	Applicant's Date of Birth [REDACTED]
Signature (Notarized) [REDACTED]			Date 05/19/2022

State of <u>Florida</u>	County of <u>Broward</u>
Subscribed and Sworn to before me this <u>19th</u> day of <u>May</u> , 20 <u>22</u> by <u>Daniel Steven Ramsay</u> .	

NOTARY

My Commission expires: 11/09/2024 Notary Public Rosemonde Harrigan
ID Type: DRIVER LICENSE Rosemonde Harrigan HH 61641
Notarized online using audio-video communication

PUBLIC

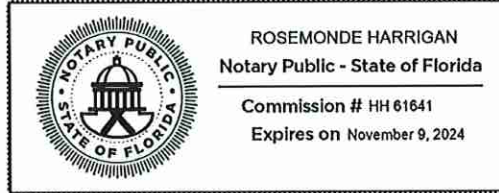

City of Grand Junction Criminal History Supplemental Sheet

Date	Charge	City	County	State	Disposition/Outcome
N/A	N/A	N/A	N/A	N/A	N/A
Details: N/A					

Date	Charge	City	County	State	Disposition/Outcome
N/A	N/A	N/A	N/A	N/A	N/A
Details: N/A					

Date	Charge	City	County	State	Disposition/Outcome
N/A	N/A	N/A	N/A	N/A	N/A
Details: N/A					

Date	Charge	City	County	State	Disposition/Outcome
N/A	N/A	N/A	N/A	N/A	N/A
Details: N/A					

Date	Charge	City	County	State	Disposition/Outcome
N/A	N/A	N/A	N/A	N/A	N/A
Details: N/A					

City of Grand Junction License Data History Supplemental Sheet

Dates	Type of License	City	County	State	Name of Business
07/15 to 09/21 (mm/yy) (mm/yy)	Sales tax	Grand Junction	Mesa	CO	Natural Order Supply, LLC

Dates	Type of License	City	County	State	Name of Business
__/__/__ to __/__/__ (mm/yy) (mm/yy)	N/A	N/A	N/A	N/A	N/A

Dates	Type of License	City	County	State	Name of Business
__/__/__ to __/__/__ (mm/yy) (mm/yy)	N/A	N/A	N/A	N/A	N/A

Dates	Type of License	City	County	State	Name of Business
__/__/__ to __/__/__ (mm/yy) (mm/yy)	N/A	N/A	N/A	N/A	N/A

Dates	Type of License	City	County	State	Name of Business
__/__/__ to __/__/__ (mm/yy) (mm/yy)	N/A	N/A	N/A	N/A	N/A

Dates	Type of License	City	County	State	Name of Business
__/__/__ to __/__/__ (mm/yy) (mm/yy)	N/A	N/A	N/A	N/A	N/A

Dates	Type of License	City	County	State	Name of Business
__/__/__ to __/__/__ (mm/yy) (mm/yy)	N/A	N/A	N/A	N/A	N/A

Dates	Type of License	City	County	State	Name of Business
__/__/__ to __/__/__ (mm/yy) (mm/yy)	N/A	N/A	N/A	N/A	N/A

Dates	Type of License	City	County	State	Name of Business
__/__/__ to __/__/__ (mm/yy) (mm/yy)	N/A	N/A	N/A	N/A	N/A

Dates	Type of License	City	County	State	Name of Business
__/__/__ to __/__/__ (mm/yy) (mm/yy)	N/A	N/A	N/A	N/A	N/A

Dates	Type of License	City	County	State	Name of Business
__/__/__ to __/__/__ (mm/yy) (mm/yy)	N/A	N/A	N/A	N/A	N/A

City of Grand Junction License Discipline History Supplemental Sheet

Date	Type of License	City	County	State	Reason for Denial/Suspension/Revocation
N/A	N/A	N/A	N/A	N/A	N/A
Details: N/A					

Date	Type of License	City	County	State	Reason for Denial/Suspension/Revocation
N/A	N/A	N/A	N/A	N/A	N/A
Details: N/A					

Date	Type of License	City	County	State	Reason for Denial/Suspension/Revocation
N/A	N/A	N/A	N/A	N/A	N/A
Details: N/A					

Date	Type of License	City	County	State	Reason for Denial/Suspension/Revocation
N/A	N/A	N/A	N/A	N / A	N/A
Details: N/A					

Date	Type of License	City	County	State	Reason for Denial/Suspension/Revocation
N/A	N/A	N/A	N/A	N/A	N/A

Details:
 N/A

City of Grand Junction Civil Litigation History Supplemental Sheet

Date	Type of Civil Action	City	County	State	Disposition/Outcome
N/A	N/A	N/A	N/A	N/A	N/A

Were you: Plaintiff Defendant Complainant Respondent Other _____

Details:
 N/A

Date	Type of Civil Action	City	County	State	Disposition/Outcome
N/A	N/A	N/A	N / A	N / A	N/A

Were you: Plaintiff Defendant Complainant Respondent Other _____

N / A

Details:
 N/A

Date	Type of Civil Action	City	County	State	Disposition/Outcome
N/A	N/A	N/A	N/A	N/A	N/A

Were you: Plaintiff Defendant Complainant Respondent Other _____

N/A

Details:

N/A

City of Grand Junction Military History Supplemental Sheet

Branch of Service: N/A

Dates of Service: N/A

Type of Discharge: N/A

Rank/Title When Discharged: N/A

If you were ever involved in any type of disciplinary action while in the Military, including but not limited to, Captain's Mast, Article 15 or a Court Martial, provide the following information:

Date	Charge	Duty Station	County	State	Disposition/Outcome
N/A	N/A	N/A	N/A	N/A	N/A
Details: N/A					

Date	Charge	Duty Station	County	State	Disposition/Outcome
N/A	N/A	N/A	N/A	N/A	N/A
Details: N/A					

Date	Charge	Duty Station	County	State	Disposition/Outcome
N/A	N/A	N/A	N/A	N/A	N/A

Details:

N/A

City of Grand Junction Personal Reference Sheet

Please list at least three personal references, excluding family members, that we may contact.

Name	[REDACTED] Grand Junction, CO 81501	Telephone Number	[REDACTED]
E-Mail	Relationship to You		
Andrea.bolton@d51schools.org	Friend, former coworker		
What Information Will This Contact Provide?			
Andrea has known Dan professionally and personally for 20 years. She is able to provide details on his character, work ethic and management abilities. They worked together as raft guides in Colorado during college and continued their professional collaborate as teachers for D51. Andrea is able to provide feedback on Dan's passion and diligence for the projects he works on.			

Name	Address	Telephone Number	
Jamie Cox	[REDACTED] Palisade, Colorado 81526	1 [REDACTED]	
E-Mail	Relationship to You		
jaime@softgelrx.com	Current coworker, former client		
What Information Will This Contact Provide?			
Jamie was a commercial client of Dan's for 5 years while he was CEO of Natural Order Supply, LLC. She will be able to provide details on his business management abilities and understanding of the licit cannabis space. Jamie works with Dan currently and can provide information on his leadership and adaptability.			

Name	Address	Telephone Number	
Rick Kenegy	[REDACTED] Grand Junction, CO USA 81507	[REDACTED]	
E-Mail	Relationship to You		
[REDACTED]	Former client, GroFresh 365		
What Information Will This Contact Provide?			
Rick Kenegy was a client of Dan's when he owned Natural Order Supply. They worked together to optimize Rick's commercial cultivation projects which ranged from cultivation of hemp, to commercial food production. Rick is able to attest to Dan's understanding of supply chain, his professionalism and ability to find solutions for his clients and business.			

City of Grand Junction Addendum to DR 8557 – Natural Person Suitability Application Form

(Owner Information) Cannabis Business Entity Name: Basis, LLC (d.b.a. Azul)

The City of Grand Junction requires additional, more stringent criteria for determining the acceptability as a licensee. Please answer the following questions in addition to similar questions in the state suitability application.

Applicant's Name (Last, First) Easley, Nicholas	Home Address [REDACTED] Denver, CO 80204	Date of Birth (mm/dd/yyyy) [REDACTED]
Email Address nic@azuldispensary.com	Phone Number(s) [REDACTED]	% Ownership 23.75%
Social Security Number [REDACTED]	Driver's License Number [REDACTED]	Driver's License State Colorado
<p>Within the 5 years immediately preceding this application, have you been convicted of any misdemeanor, petty offense or local ordinance related to a drug or controlled substance offense?</p> <p>Within the 5 years immediately preceding this application, have you been convicted of any non-drug related felony?</p> <p>At any time, have you been convicted of a drug or controlled substance felony?</p> <p>Within the 5 years immediately preceding this application, have you been released from incarceration or court-ordered supervision, including a deferred sentence, for a conviction of any felony or crime that would be a felony under Colorado law?</p> <p>At any time, have you been convicted of any crime of which fraud or intent to defraud was an element of the offense?</p> <p>IF YOU ANSWERED YES TO ANY OF THE ABOVE, COMPLETE ATTACHED CRIMINAL HISTORY SUPPLEMENTAL SHEET</p>		<p><input type="checkbox"/> Yes <input checked="" type="checkbox"/> No <u>NE</u> Initials</p> <p><input type="checkbox"/> Yes <input checked="" type="checkbox"/> No <u>NE</u> Initials</p> <p><input type="checkbox"/> Yes <input checked="" type="checkbox"/> No <u>NE</u> Initials</p> <p><input type="checkbox"/> Yes <input checked="" type="checkbox"/> No <u>NE</u> Initials</p> <p><input type="checkbox"/> Yes <input checked="" type="checkbox"/> No <u>NE</u> Initials</p>
<p>Have you ever had a professional or occupational license denied, suspended or revoked?</p> <p>Have you ever had a business or sales tax license denied, suspended or revoked?</p> <p>Have you ever surrendered, been denied, or had any type of cannabis related license or permit placed on an administrative hold, suspended or revoked?</p> <p>Have you ever been denied any type of cannabis related business license?</p> <p>Have you ever had a business temporarily or permanently closed for failure to comply with any tax, health, building, fire, zoning or safety law?</p> <p>Have you ever had any administrative, civil or criminal finding of delinquency for failure to file or failure to pay state or local sales or use taxes or any other taxes?</p> <p>IF YOU ANSWERED YES TO ANY OF THE ABOVE, COMPLETE ATTACHED LICENSE DISCIPLINE HISTORY SUPPLEMENTAL SHEET</p>		<p><input type="checkbox"/> Yes <input checked="" type="checkbox"/> No <u>NE</u> Initials</p> <p><input type="checkbox"/> Yes <input checked="" type="checkbox"/> No <u>NE</u> Initials</p> <p><input type="checkbox"/> Yes <input checked="" type="checkbox"/> No <u>NE</u> Initials</p> <p><input type="checkbox"/> Yes <input checked="" type="checkbox"/> No <u>NE</u> Initials</p> <p><input type="checkbox"/> Yes <input checked="" type="checkbox"/> No <u>NE</u> Initials</p> <p><input type="checkbox"/> Yes <input checked="" type="checkbox"/> No <u>NE</u> Initials</p>

<p>Have you ever been arrested, served with a criminal summons, charged with, or convicted of any crime or offense in any manner in this or any other state?</p> <ul style="list-style-type: none"> You must include all arrests, charges and convictions regardless of the outcome, even if the charges were dismissed or you were found not guilty. You must include all arrests, charges and convictions regardless of the class of the crime (felonies, misdemeanors and/or petty offenses). You must include all serious traffic offenses, including DUI, DWAI, reckless driving, leaving the scene of an accident, driving under suspension, revocation or denial, or any other offense which resulted in you being taken into custody or served with a summons into Court. <p>NOTICE: Do not rely upon your understanding that an arrest or charge is "not supposed to be on my record." A criminal record was not cleared, erased, sealed or expunged unless you were given, and have in your possession, a written order from a Judge directing that action.</p> <p>IF YOU ANSWERED YES ABOVE, COMPLETE ATTACHED CRIMINAL HISTORY SUPPLEMENTAL SHEET</p>	<p><input checked="" type="checkbox"/> Yes <input type="checkbox"/> No <u>NE</u> Initials</p>
<p>Have you (as an individual, as a member of a partnership or other form of domestic or foreign business entity, or as an owner, director, or officer of a corporation) ever been a party to a lawsuit (other than divorces) either as a plaintiff or defendant, complainant or respondent, or in any other fashion, in this or any other state? This includes all civil litigation, regardless of the type of lawsuit or the court of jurisdiction. List all cases without exception, including bankruptcies and cases in Small Claims Courts.</p> <p>IF YOU ANSWERED YES ABOVE, COMPLETE ATTACHED CIVIL LITIGATION HISTORY SUPPLEMENTAL SHEET</p>	<p><input checked="" type="checkbox"/> Yes <input type="checkbox"/> No <u>NE</u> Initials</p>

For each offense for which you were arrested or charged, **YOU MUST OBTAIN OFFICIAL DOCUMENTATION FROM THE COURT WHERE YOU APPEARED, SHOWING THE FINAL DISPOSITION (OUTCOME) OF YOUR CASE.** If you received a deferred judgment, a deferred sentence or probation, your documentation must include the date that you were discharged or released from probation or other supervision.

On the attached license data history supplemental sheet, list all locations where you have had a professional, occupational, business or sales tax license, where you have owned and/or operated a business and the name of your business(es).

If you were in the Armed Forces, please complete the attached Military history supplemental sheet.

I attest that all information I have provided on this Addendum and supplemental documents is true and accurate to the best of my knowledge and acknowledge any omissions and/or falsifications may result in denial or revocation of a regulated cannabis license.

 _____ | 05 / 18 / 2022
 (Signature) (Date)

INVESTIGATION AUTHORIZATION / AUTHORIZATION TO RELEASE INFORMATION

I, Nicholas Todd Easley, hereby authorize the City of Grand Junction, the City of Grand Junction Licensing Authority and the City of Grand Junction Police Department (hereafter, the Investigatory Agencies) to conduct a complete investigation into my personal background, using whatever legal means they deem appropriate. I hereby authorize any person or entity contacted by the Investigatory Agencies to provide any and all such information deemed necessary by the Investigatory Agencies. I hereby waive any rights of confidentiality in this regard. I understand that by signing this authorization, a financial record check may be performed. I authorize any financial institution to surrender to the Investigatory Agencies a complete and accurate record of such transactions that may have occurred with that institution, including, but not limited to, internal banking memoranda, past and present loan applications, financial statements and any other documents relating to my personal or business financial records in whatever form and wherever located. I authorize the release of this type of information, even though such information may be designated as "confidential" or "nonpublic" under the provisions of state or federal laws.

I understand that by signing this authorization a criminal history check will be performed. I authorize the Investigatory Agencies to obtain and use from any source, any information concerning me contained in any type of criminal history record files, wherever located. I understand that the criminal history record files contain records of arrests which may have resulted in a disposition other than a finding of guilt. I understand that the information may contain listings of charges that resulted in suspended imposition of sentence, even though I successfully completed the conditions of said sentence and was discharged pursuant to law. I authorize the release of this type of information, even though this record may be designated as "confidential" or "nonpublic" under the provisions of state or federal laws.

The Investigatory Agencies reserve the right to investigate all relevant information and facts to their satisfaction. I understand that the Investigatory Agencies may conduct a complete and comprehensive investigation to determine the accuracy of all information gathered. However, the City of Grand Junction, Investigatory Agencies, and other agents or employees of the City of Grand Junction shall not be held liable for the receipt, use or dissemination of inaccurate information. I, on behalf of the applicant, its legal representatives, and assigns, hereby release, waive, discharge and agree to hold harmless, and otherwise waive liability as to the City of Grand Junction, Investigatory Agencies, and other agents or employees of the City of Grand Junction for any damages resulting from any use, disclosure, or publication in any manner, other than a willfully unlawful disclosure or publication, of any material or information acquired during inquiries, investigations, or hearings, and hereby authorize the lawful use, disclosure, or publication of this material or information. Any information contained within my application, contained within any financial or personnel record, or otherwise found, obtained, or maintained by the Investigatory Agencies, shall be accessible to Law Enforcement agents of this or any other state or the government of the United States.

PRINT FULL LEGAL NAME OF OWNER CLEARLY BELOW:			
Applicant's Legal Business Name Basis, LLC		Trade Name (DBA) Azul	
Applicant's Last Name (Please Print) Easley	Applicant's First Name Nicholas	Applicant's Middle Name Todd	Applicant's Date of Birth [REDACTED]
Signature (Notarized) [REDACTED]			Date 06/06/2022

State of <u>Texas</u>	County of <u>Brazoria</u>
Subscribed and Sworn to before me this <u>6th</u> day of <u>June</u> , 20 <u>22</u>	

State/Commonwealth of TEXAS)
)
 City County of Brazoria)

On 06/06/2022, before me, Rosa Marie Weido,
Date *Notary Name*

the foregoing instrument was subscribed and sworn (or affirmed) before me by:

Nicholas Todd Fasley
Name of Affiant(s)

- Personally known to me -- OR --
- Proved to me on the basis of the oath of _____ -- OR --
Name of Credible Witness
- Proved to me on the basis of satisfactory evidence: driver_license
Type of ID Presented

WITNESS my hand and official seal.

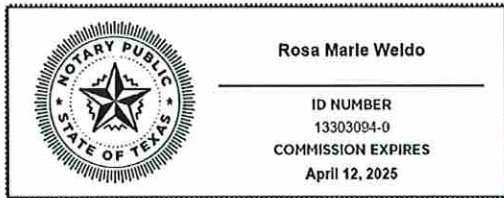

Notary Public Signature: Rosa Marie Weido

Notary Name: Rosa Marie Weido

Notary Commission Number: 13303094-0

Notary Commission Expires: 04/12/2025

Notarized online using audio-video communication

DESCRIPTION OF ATTACHED DOCUMENT

Title or Type of Document: _____

Document Date: 06/06/2022

Number of Pages (including notarial certificate): 16

City of Grand Junction Criminal History Supplemental Sheet

Date	Charge	City	County	State	Disposition/Outcome
3/18/05	Public Intoxication	N/A	Comal County	TX	Dismissed
Details: Docket# JP-4 (SO #474392): The \$300 Surety Bond was paid and 4 hours of public service were served Case Number: 42005.2209 See the attached files for the official court paperwork.					

Date	Charge	City	County	State	Disposition/Outcome
N/A	N/A	N/A	N/A	N/A	N/A
Details: N/A					

Date	Charge	City	County	State	Disposition/Outcome
N/A	N/A	N/A	N/A	N/A	N/A
Details: N/A					

Date	Charge	City	County	State	Disposition/Outcome
N/A	N/A	N/A	N/A	N/A	N/A
Details: N/A					

Date	Charge	City	County	State	Disposition/Outcome
N/A	N/A	N/A	N/A	N/A	N/A
Details: N/A					

City of Grand Junction License Data History Supplemental Sheet

Dates	Current	Type of License	City	County	State	Name of Business
04/15 to ___/___	(mm/yy) (mm/yy)	Business	Denver	Denver	CO	3C Consulting, LLC

Dates	Current	Type of License	City	County	State	Name of Business
06/18 to ___/___	(mm/yy) (mm/yy)	Business	Denver	Denver	CO	Multiverse Ancillary Holdings, LLC

Dates	Current	Type of License	City	County	State	Name of Business
09/18 to ___/___	(mm/yy) (mm/yy)	Business	Denver	Denver	CO	Multiverse Direct Holdings, LLC

Dates	Current	Type of License	City	County	State	Name of Business
09/18 to ___/___	(mm/yy) (mm/yy)	Business	Denver	Denver	CO	Multiverse Fund A, LP

Dates	Current	Type of License	City	County	State	Name of Business
09/18 to ___/___	(mm/yy) (mm/yy)	Business	Denver	Denver	CO	Multiverse Fund M, LP

Dates	Current	Type of License	City	County	State	Name of Business
09/18 to ___/___	(mm/yy) (mm/yy)	Business	Denver	Denver	CO	Multiverse Fund R, LP

Dates	current	Type of License	City	County	State	Name of Business
10/17 to ___/___	(mm/yy) (mm/yy)	Cultivation and export	Skals	Denmark	N/A	Cantiva Aps

Dates	current	Type of License	City	County	State	Name of Business
08/18 to ___/___	(mm/yy) (mm/yy)	medical/adult-use	Santa Barabara	Santa Barbara	CA	Coastal Delivery Services LLC

Dates	current	Type of License	City	County	State	Name of Business
04/18 to ___/___	(mm/yy) (mm/yy)	medical/adult-use	Santa Barabara	Santa Barbara	CA	Coastal Dispensary LLC

Dates	current	Type of License	City	County	State	Name of Business
04/18 to ___/___	(mm/yy) (mm/yy)	medical/adult-use	Lompoc	Santa Barbara	CA	Coastal Dispensary LLC

Dates	current	Type of License	City	County	State	Name of Business
04/18 to ___/___	(mm/yy) (mm/yy)	medical/adult-use	Santa Barabara	Santa Barbara	CA	Coastal Distribution, LLC

City of Grand Junction License Discipline History Supplemental Sheet

Date	Type of License	City	County	State	Reason for Denial/Suspension/Revocation
N/A	N/A	N/A	N/A	N/A	N/A
Details: N/A					

Date	Type of License	City	County	State	Reason for Denial/Suspension/Revocation
N/A	N/A	N/A	N/A	N/A	N/A
Details: N/A					

Date	Type of License	City	County	State	Reason for Denial/Suspension/Revocation
N/A	N/A	N/A	N /A	N/A	N/A
Details: N/A					

Date	Type of License	City	County	State	Reason for Denial/Suspension/Revocation
N/A	N/A	N/A	N/A	N/A	N/A
Details: N/A					

Date	Type of License	City	County	State	Reason for Denial/Suspension/Revocation
N/A	N/A	N/A	N/A	N/A	N/A

Details: N/A

City of Grand Junction Civil Litigation History Supplemental Sheet

Date	Type of Civil Action	City	County	State	Disposition/Outcome
07/17/20	Contractual	N/A	Union	NJ	Dismissed due to improper venue
Were you: <input type="checkbox"/> Plaintiff <input checked="" type="checkbox"/> Defendant <input type="checkbox"/> Complainant <input type="checkbox"/> Respondent <input type="checkbox"/> Other _____					
Details: Case No. UNN-L-46-20, Superior Court of New Jersey, Law Division, Union County, Cedar Green, LLC v. 3C Consulting LLC. Dismissed for improper venue. Cedar Green, LLC was a client of 3C Consulting, they failed to pay the contractual amount owed for services.					

Date	Type of Civil Action	City	County	State	Disposition/Outcome
2/23/22	Contractual	Boulder	Boulder	CO	Awaiting Ruling
Were you: <input checked="" type="checkbox"/> Plaintiff <input type="checkbox"/> Defendant <input type="checkbox"/> Complainant <input type="checkbox"/> Respondent <input type="checkbox"/> Other _____					
Details: Case No. 20CV30941, District Court, Boulder County, Colorado, Cedar Green, LLC v. 3C Consulting LLC. All claims against me and my business were dismissed. Trial occurred in April 2022 on counterclaims; awaiting ruling.					

Date	Type of Civil Action	City	County	State	Disposition/Outcome
2/9/22	Contractual	Denver	Denver	CO	Won
Were you: <input checked="" type="checkbox"/> Plaintiff <input type="checkbox"/> Defendant <input type="checkbox"/> Complainant <input type="checkbox"/> Respondent <input type="checkbox"/> Other _____					
Case No. 21CV31508, District Court, City and County of Denver, Colorado, Kim v. 3C Consulting LLC.					

Details:

Sean Kim was a 3C client, she failed to make payment on the contractual fee owed to 3C for work completed.

City of Grand Junction Military History Supplemental Sheet

Branch of Service: United States Air Force

Dates of Service: 6 Aug 2002 - 2 Aug 2006

Type of Discharge: Honorable Discharge

Rank/Title When Discharged: E-4, Senior Airman

If you were ever involved in any type of disciplinary action while in the Military, including but not limited to, Captain's Mast, Article 15 or a Court Martial, provide the following information:

Date	Charge	Duty Station	County	State	Disposition/Outcome
N/A	N/A	N/A	N/A	N/A	N/A
Details: N/A					

Date	Charge	Duty Station	County	State	Disposition/Outcome
N/A	N/A	N/A	N/A	N/A	N/A
Details: N/A					

Date	Charge	Duty Station	County	State	Disposition/Outcome
N/A	N/A	N/A	N/A	N/A	N/A

Details:

N/A

City of Grand Junction Personal Reference Sheet

Please list at least three personal references, excluding family members, that we may contact.

Name	Address	Telephone Number
Jonathan Rubin	[REDACTED] Stamford, CT 06905	[REDACTED]
E-Mail	Relationship to You	
jonathan@newleafcap.com	Business Partner	
What Information Will This Contact Provide?		
Jonathan has known me since 2015. I was an initial co-founder with his business Cannabis Benchmarks and he has seen me grow companies in the US and abroad and how I tirelessly work to ensure success.		

Name	Address	Telephone Number
Joe Bob Merritt	[REDACTED] Gunnison CO 81230	[REDACTED]
E-Mail	Relationship to You	
[REDACTED]	Personal Friend	
What Information Will This Contact Provide?		
Joe Bob has know me for over 15 years and has seen me create and grow businesses as well as me helping our local community.		

Name	Address	Telephone Number
Debbie Churgai	[REDACTED] Washington, DC 20006	[REDACTED]
E-Mail	Relationship to You	
debbie@safeaccessnow.org	Fellow Americans for Safe Access (ASA) Board of Directors Member	
What Information Will This Contact Provide?		
Debbie has known me since 2016. Debbie is the Executive Director of ASA, a medical cannabis advocacy non-profit that has been around for over 20 years. Debbie has worked with me on numerous campaigns, meetings, and fundraising campaigns to help improve the lives of medical patients worldwide.		



CONFIDENTIAL

CONFIDENTIAL

Jail Records Search Detail

Skip to Main Content Logout My Account Search Menu New Jail Search Refine Search Back

Help

Booking #: 266097
Facility: Main Jail

Comal County Sheriffs Office
Booked: 03/18/2005

Released: 03/18/2005

Name: EASLEY, NICHOLAS TODD
Alias: NICK
SO #: 474392
DOB: [REDACTED]
Address: SAN ANTONIO, TX 78227

Desc: White Male 6' 3" 200 lbs
Hair: Brown
Eyes: Brown



Warrant #	Charge	Issuing Auth	Offense Date	Bond/Type	Fine/Crt Costs	Disposition
COMPLAINT	PUBLIC INTOXICATION	JP-4	03/18/2005	300.00 Surety Bond		Surety Bond

Bond Records Search Detail

Skip to Main Content Logout My Account Search Menu New Bond Search Refine Search Back

Help

Bond #: 223308
Posted: 03/18/2005

300.00 Surety Bond
Status: Released 04/15/2005

AAA BAIL BONDS II

2970 W. SAN ANTONIO ST.
NEW BRAUNFELS, TX 78130

300.00



Name **EASLEY, NICHOLAS TODD**
Alias **NICK**
SO # **474392**
DOB [REDACTED]

Address **SAN ANTONIO, TX 78227**
Desc **White Male 6' 3" 200 lbs**
Hair **Brown**
Eyes **Brown**

Book # **266097**
Arresting Agency **Comal County Sheriffs Office**

Booked **03/18/2005**
Released **03/18/2005**

Facility **Main Jail**

Code	Offense	Offense Date	Bond Amt
99999999	PUBLIC INTOXICATION	03/18/2005	300.00

Additional Personnel Questionnaire Addendum for Inclusion

Response: On 25 May 2022, after communicating with various Courts and records offices, both the Comal County Records Office and the New Braunfels Municipal Court stated that the court records for Nicholas Easley regarding a Public Intoxication charge on or about 18 March 2005, were not present in their database. Upon further discussion with both offices, it became clear that the court documents would most likely not be present in their database based on the offense being a Class C Misdemeanor, the least serious of all crimes charged in the state of Texas, and the offense occurring in 2005.

Texas Penal Code § 49.02(c), a subsection of the state's Public Intoxication charge, states that, "Except as provided by Subsection (e), an offense under this section is a Class C misdemeanor. Subsection (e) described above is only applicable when the accused is below the age of 21. Per Texas Penal Code § 12.23, an individual adjudged guilty of a Class C misdemeanor shall be punished by a fine not to exceed \$500.

Based on the information above and the lack of court documents, the only forms that our company was able to obtain are the jail and bond records, both of which are public information. These forms will be attached and included as a part of the City of Grand Junction Additional Personnel Questionnaire. They include applicable information about the case number, incident date, bond amount, Nicholas Easley's picture and personal information, and the city/county the incident occurred.

AREA #	USE	RESTRICTION	PHYSICAL BARRIER	INTRUSION DETECTION	ACCESS		NOTES	WHO HAS ACCESS
					AUTHENTICATION	SCHEDULE		
0	EXTERNAL PARKING, GENERAL PUBLIC ACCESS	UNRESTRICTED GENERAL ACCESS	NON-SOLID WALLS, METAL DOORS, EXPOS. FINISH	NON-SOLID WALLS, METAL DOORS, EXPOS. FINISH	NON-SOLID WALLS, METAL DOORS, EXPOS. FINISH	NON-SOLID WALLS, METAL DOORS, EXPOS. FINISH	VEHICULAR LICENSE PLATE VISIBLE RECORDED	SECURITY & VISITED VISITORS
1	CLEARING SUPPLIER, YARD/FINE ROADS	CONTROLLED ACCESS	INTERIOR/EXTERIOR WALLS, METAL DOORS	NON-SOLID WALLS, METAL DOORS, EXPOS. FINISH	PROXIMITY CARD READER ALWAYS CLOSED AND LOCKED	NON-SOLID WALLS, METAL DOORS, EXPOS. FINISH	EMPLOYEES & ESCORTED CONTRACTORS	EMPLOYEES & ESCORTED VISITORS
2	CONCILIATION OFFICE	CONTROLLED ACCESS	INTERIOR/EXTERIOR WALLS, METAL DOORS	NON-SOLID WALLS, METAL DOORS, EXPOS. FINISH	PROXIMITY CARD READER ALWAYS CLOSED AND LOCKED	NON-SOLID WALLS, METAL DOORS, EXPOS. FINISH	EMPLOYEES & ESCORTED CONTRACTORS	EMPLOYEES & ESCORTED VISITORS
3	DISPATCH/FLOOR DISPLAYS	CONTROLLED ACCESS	INTERIOR/EXTERIOR WALLS, METAL DOORS	NON-SOLID WALLS, METAL DOORS, EXPOS. FINISH	PROXIMITY CARD READER ALWAYS CLOSED AND LOCKED	NON-SOLID WALLS, METAL DOORS, EXPOS. FINISH	EMPLOYEES & ESCORTED CONTRACTORS	EMPLOYEES & ESCORTED VISITORS
4	RECEPTION	CONTROLLED ACCESS	INTERIOR/EXTERIOR WALLS, METAL DOORS	NON-SOLID WALLS, METAL DOORS, EXPOS. FINISH	PROXIMITY CARD READER ALWAYS CLOSED AND LOCKED	NON-SOLID WALLS, METAL DOORS, EXPOS. FINISH	EMPLOYEES & ESCORTED CONTRACTORS	EMPLOYEES & ESCORTED VISITORS
5	RECEPTION	CONTROLLED ACCESS	INTERIOR/EXTERIOR WALLS, METAL DOORS	NON-SOLID WALLS, METAL DOORS, EXPOS. FINISH	PROXIMITY CARD READER ALWAYS CLOSED AND LOCKED	NON-SOLID WALLS, METAL DOORS, EXPOS. FINISH	EMPLOYEES & ESCORTED CONTRACTORS	EMPLOYEES & ESCORTED VISITORS
6	RECEPTION	CONTROLLED ACCESS	INTERIOR/EXTERIOR WALLS, METAL DOORS	NON-SOLID WALLS, METAL DOORS, EXPOS. FINISH	PROXIMITY CARD READER ALWAYS CLOSED AND LOCKED	NON-SOLID WALLS, METAL DOORS, EXPOS. FINISH	EMPLOYEES & ESCORTED CONTRACTORS	EMPLOYEES & ESCORTED VISITORS
7	RECEPTION	CONTROLLED ACCESS	INTERIOR/EXTERIOR WALLS, METAL DOORS	NON-SOLID WALLS, METAL DOORS, EXPOS. FINISH	PROXIMITY CARD READER ALWAYS CLOSED AND LOCKED	NON-SOLID WALLS, METAL DOORS, EXPOS. FINISH	EMPLOYEES & ESCORTED CONTRACTORS	EMPLOYEES & ESCORTED VISITORS
8	MANAGER OFFICE	CONTROLLED ACCESS	INTERIOR/EXTERIOR WALLS, METAL DOORS	NON-SOLID WALLS, METAL DOORS, EXPOS. FINISH	PROXIMITY CARD READER ALWAYS CLOSED AND LOCKED	NON-SOLID WALLS, METAL DOORS, EXPOS. FINISH	EMPLOYEES & ESCORTED CONTRACTORS	EMPLOYEES & ESCORTED VISITORS
9	MANAGER OFFICE	CONTROLLED ACCESS	INTERIOR/EXTERIOR WALLS, METAL DOORS	NON-SOLID WALLS, METAL DOORS, EXPOS. FINISH	PROXIMITY CARD READER ALWAYS CLOSED AND LOCKED	NON-SOLID WALLS, METAL DOORS, EXPOS. FINISH	EMPLOYEES & ESCORTED CONTRACTORS	EMPLOYEES & ESCORTED VISITORS
10	SECURITY OFFICE	CONTROLLED ACCESS	INTERIOR/EXTERIOR WALLS, METAL DOORS	NON-SOLID WALLS, METAL DOORS, EXPOS. FINISH	PROXIMITY CARD READER ALWAYS CLOSED AND LOCKED	NON-SOLID WALLS, METAL DOORS, EXPOS. FINISH	EMPLOYEES & ESCORTED CONTRACTORS	EMPLOYEES & ESCORTED VISITORS
11	VAULT, SAIT	CONTROLLED ACCESS	INTERIOR/EXTERIOR WALLS, METAL DOORS	NON-SOLID WALLS, METAL DOORS, EXPOS. FINISH	PROXIMITY CARD READER ALWAYS CLOSED AND LOCKED	NON-SOLID WALLS, METAL DOORS, EXPOS. FINISH	EMPLOYEES & ESCORTED CONTRACTORS	EMPLOYEES & ESCORTED VISITORS
12	FUTURE EXPANSION AREA	RESTRICTED ACCESS	INTERIOR/EXTERIOR WALLS, METAL DOORS	NON-SOLID WALLS, METAL DOORS, EXPOS. FINISH	PROXIMITY CARD READER ALWAYS CLOSED AND LOCKED	NON-SOLID WALLS, METAL DOORS, EXPOS. FINISH	EMPLOYEES & ESCORTED CONTRACTORS	EMPLOYEES & ESCORTED VISITORS

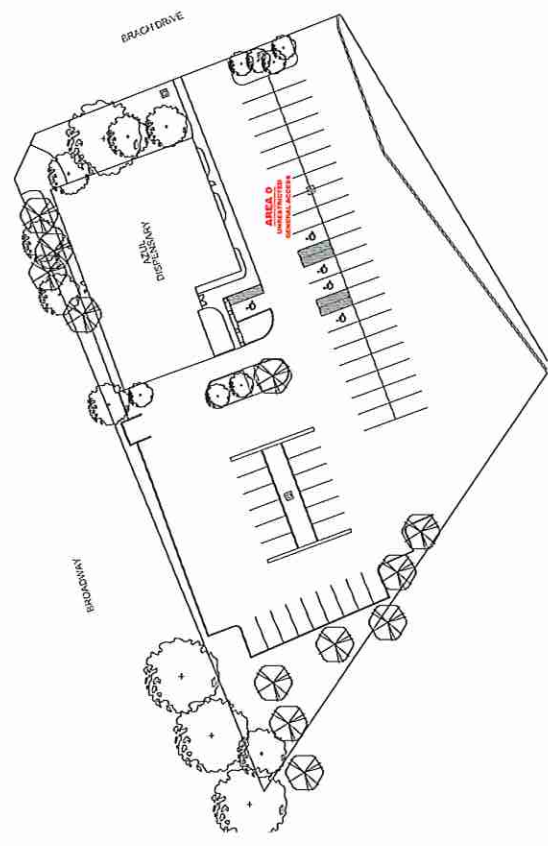
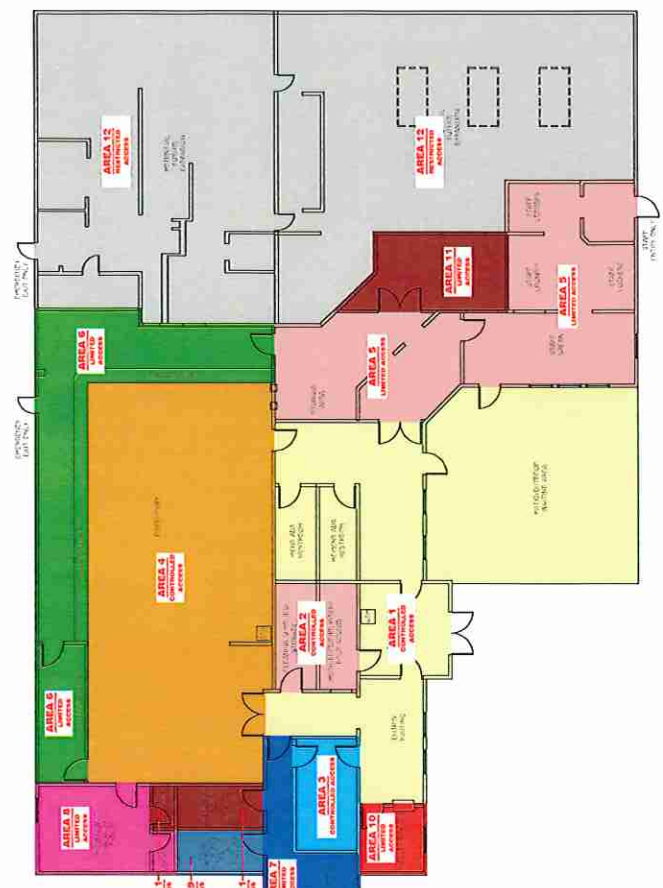

GENERAL NOTES:

1. ALL VISITORS (NON-EMPLOYEES) MUST BE ESCORTED WHILE ON PREMISES.
2. ALL EMPLOYEES SHALL HAVE BARCODED ACCESS CARDS LISTING LOCATION NAME & LICENSE NUMBER. EMPLOYEE NAME AND 2" X 2" COLOR PHOTO.
3. ALL ENTRY AND EXIT DOORS, AND DOORS FACILITATING A CHANGE IN ACCESS LEVEL, SHALL USE A COMMERCIAL GRADE, NON-RESIDENTIAL DOOR LOCK.

DATE	REVISION	DESCRIPTION	APPROVED BY	DATE



SITE ACCESS AREAS

AZUL DISPENSARY
 421 BRUCH DRIVE
 GRAND JUNCTION, COLORADO 81507

DATE: 6/22/2022
 DRAWN BY: [Name]
 CHECKED BY: [Name]
 PROJECT: SECURITY & FIRE ALARM
 SHEET: SS-01

EXHIBIT II

