

NOTE:

- REFER TO SHEET NOTES FOR SURFACE PREPARATION OF STEEL AND CONCRETE SURFACES AND FOR APPLICATION OF THE PRIMER AND MASTIC.

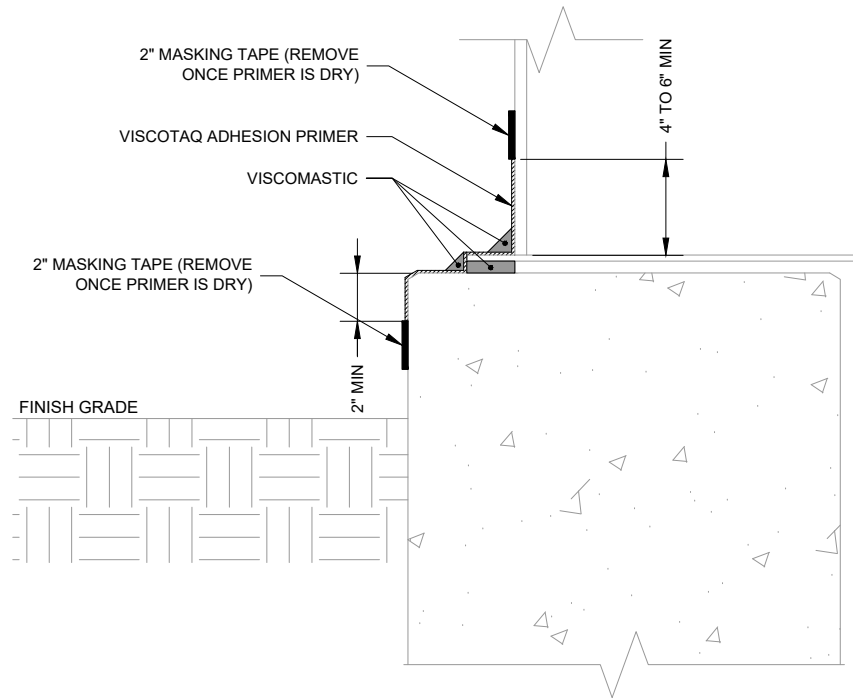

1 GAP FILLER AND ADHESION PRIMER
SCALE: NTS

NOTE:

- REFER TO SHEET NOTES FOR APPLICATION, INSTALLATION, AND TOP COAT REQUIREMENTS.

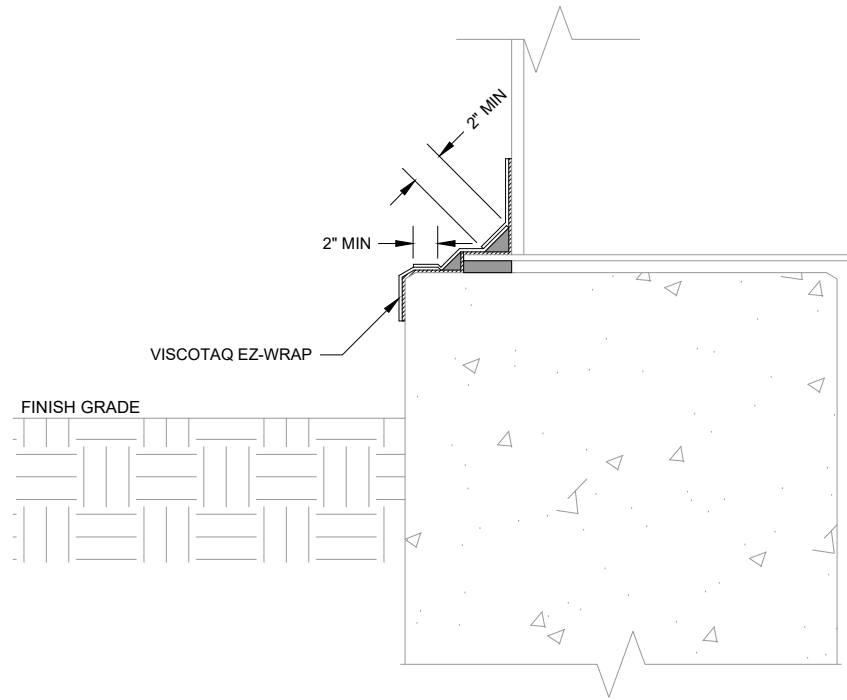

2 VISCOTAQ EZ-WRAP SYSTEM
SCALE: NTS

JOINT REPAIR SURFACE PREPARATION NOTES:

- THE SURFACE AREA TO BE COATED SHALL BE INSPECTED PRIOR TO COATING; KNOWN DEFECTS SHALL BE DOCUMENTED AND PHOTOGRAPHED PRIOR TO APPLICATION.
- ANY EXISTING DAMAGED COATING SHALL BE REMOVED BEFORE OR AS PART OF THE SURFACE PREPARATION PROCESS.
- CLEAN UNDERNEATH THE TANK TO A DEPTH $\geq 2"$. IF A "FELT BASE" IS PRESENT UNDER THE TANK, REMOVE THE FELT WHERE THE VISCOTAQ VISCOSEALANT IS TO BE APPLIED.
- THE SURFACE OF THE TANK WHERE THE VISCOTAQ IS TO BE APPLIED SHALL BE CLEANED TO A MINIMUM OF ST 3/SSPC-SP3 (POWER TOOL CLEANED).
- THE CONCRETE RINGWALL SHALL BE EXPOSED A MINIMUM OF 6" BELOW THE TOP OF CONCRETE. ELEVEN MEASUREMENTS WERE TAKEN FROM THE TOP OF CONCRETE RINGWALL TO FINISH GRADE AROUND THE TANK PERIMETER. THE MEASUREMENTS RANGED FROM A MINIMUM OF 0.75 INCHES TO A MAXIMUM OF 8.5 INCHES. HAND EXCAVATION WILL BE REQUIRED TO EXPOSE THE CONCRETE RINGWALL. RE-ESTABLISH GRADE FOLLOWING COMPLETION AND FULL CURE OF THE REPAIR.
- MECHANICALLY ABRADE CONCRETE TO ICRI CSP-2 TO CSP-3 PROFILE.
- POWER WASH THE APPLICATION AREA TO REMOVE ANY LOOSE PARTICLES.
- CLEAN ALL SURFACES TO BE COATED TO SOLVENT CLEAN SSPC-SP1 USING AN OIL-FREE SOLVENT (ACETONE, DENATURED ALCOHOL, AND ISOPROPYL ALCOHOL) TO REMOVE ALL MUD, MILL LACQUER, WAX, TAR, OIL, GREASE, OR OTHER FOREIGN MATERIALS. NOTE: INDUSTRIAL-GRADE CITRUS-BASED (D-LIMONENE) PRODUCTS ARE NOT APPROVED FOR USE AS AN OIL-FREE SOLVENT.
- DRY THE AREA WHERE VISCOTAQ IS TO BE APPLIED THOROUGHLY.
- CLEANED AREAS SHALL HAVE A PROTECTIVE COATING APPLIED BEFORE THE END OF THE SHIFT. IF A CLEANED SURFACE IS NOT COATED, IT SHALL BE RE-CLEANED ON THE NEXT SHIFT.

APPLICATION OF DENSO VISCOTAQ SYSTEM FOR TANK CHIME SEALING:

- MEASURE AND MASK TOP AND BOTTOM WITH 2" MASKING TAPE TO MARK AREAS WHERE THE VISCOTAQ ADHESION PROMOTER WILL BE APPLIED. THE BOTTOM MASKING STRIP SHALL START AT APPROXIMATELY 2" BELOW THE BASE FLOOR PLATE JUST BELOW THE CHIME AND CONCRETE BASE. THE TOP STRIP OF MASKING TAPE SHALL BE APPLIED APPROXIMATELY 4" TO 6" UP THE TANK WALL.
- APPLY A THIN UNIFORM COAT OF VISCOTAQ ADHESION PROMOTER TO ALL SURFACES WITHIN THE MASKED AREA AND ALLOW IT TO TACK DRY. CARE SHALL BE TAKEN NOT TO CONTAMINATE THE SUBSTRATE OUTSIDE OF THE MASKING TAPE LIMITS. THE ADHESION PROMOTER SHALL BE APPLIED PRIOR TO ALL OTHER VISCOTAQ PRODUCTS. ONCE THE ADHESION PROMOTER HAS DRIED, REMOVE THE TOP AND BOTTOM STRIPS OF MASKING TAPE.
- VISCOMASTIC SHALL BE USED TO SEAL ALL GAPS AND CRACKS. APPLY THE APPROPRIATE AMOUNT OF MASTIC BY HAND TO A DEPTH OF APPROXIMATELY 1" INTO THE GAP BETWEEN THE BASE OF THE TANK AND THE RING WALL. THE GAP BETWEEN THE STEEL CHIME (BASE OF THE TANK) AND THE CONCRETE RINGWALL WAS MEASURED AT ELEVEN LOCATIONS AROUND THE TANK PERIMETER. THE GAP RANGED FROM 0.313 INCHES TO A MAXIMUM OF 3.125 INCHES, WITH AN AVERAGE OF 0.78 INCHES.
- FILL ALL SMALL VOIDS AND CRACKS AND PROFILE THE 90° TANK BASE ANGLE BY MOLDING THE VISCOMASTIC TO CREATE A 45° ANGLE TOWARD THE CONCRETE BASE. IF THE BASE HAS A STEPPED PROFILE, APPLY VISCOMASTIC AT A 45° ANGLE TOWARD THE GROUND TO CREATE A SMOOTH PROFILE FOR WRAPPING WITH THE EZ-WRAP.
- VISCOTAQ EZ WRAP IS APPLIED BY REMOVING THE RELEASE LINER AND PLACING THE ADHESIVE SIDE ONTO THE SURFACE TO BE PROTECTED.
- THE FIRST STRIP OF VISCOTAQ EZ WRAP SHALL START AT THE BOTTOM OF THE CONCRETE BASE, CAREFULLY ALIGNING THE EZ WRAP WITH THE OUTER EDGE OF THE ADHESION PROMOTER, INSTALLING FROM THE BOTTOM UP TO PROVIDE A WEATHERBOARD EFFECT.
- SUBSEQUENT STRIPS OF EZ WRAP SHALL BE OVERLAPPED A MINIMUM OF 2" AND EXTEND OVER THE MASTIC ONTO THE RING WALL AND APPROXIMATELY 4" TO 6" UP THE TANK WALL, CAREFULLY ALIGNING WITH THE ADHESION PROMOTER.
- WHEN CONNECTING ROLLS, THE EZ-WRAP SHALL BE OVERLAPPED A MINIMUM OF 1".
- THE VISCOTAQ EZ WRAP SHALL BE GENTLY SMOOTHED BY HAND AND WITH A STEEL ROLLER TO ENSURE THERE ARE NO WRINKLES, FOLDS, OR ENTRAPPED AIR. IF REQUIRED, A HEAT GUN AND PRESSURE MAY BE USED TO ENSURE THE SEALING COMPOUND IS FULLY IMPREGNATED INTO THE POLYESTER BACKING OF THE VISCOTAQ EZ WRAP.
- BRUSH APPLY ARCHCO 15 IN TWO COATS CONSISTING OF APPROXIMATELY 10 TO 12 MILS WET FILM THICKNESS PER COAT. RECOAT TIME FOR ARCHCO 15 IS APPROXIMATELY 1 TO 2 HOURS AT 77°F. ALL EZ-WRAP SHALL BE TOPCOATED; CARE SHALL BE TAKEN NOT TO EXTEND BEYOND THE TOP AND BOTTOM EDGES OF THE EZ-WRAP.
- ENSURE THAT THE ENTIRE SURFACE TO BE PROTECTED IS COVERED WITH NO GAPS OR AIR POCKETS. ENSURE THAT THE CORRECT OVERLAP IS ACHIEVED.

ABBREVIATIONS:

CSP	CONCRETE SURFACE PREPARATION
ICRI	INTERNATIONAL CONCRETE REPAIR INSTITUTE
SP	SURFACE PREPARATION
SSPC	SOCIETY OF PROTECTIVE COATINGS



WESTERN WATER SOLUTIONS, LLC
PO BOX 3741
BASALT, COLORADO 81621

Prepared For
CITY OF GRAND JUNCTION
244 N 7TH STREET
GRAND JUNCTION, COLORADO 81503

Client
CITY OF GRAND JUNCTION
244 N 7TH STREET
GRAND JUNCTION, COLORADO 81503

Project
**WATER TREATMENT
PLANT SOUTH TANK
RECOATING PROJECT**

No.	Revision/Issue	Date

Project No.:	2026-COGJ-WTP S TANK
Drawn By:	TAW
Checked By:	WWS
Drawing Date:	02.05.2026

Sheet Title
**TANK CHIME JOINT
SEALANT REPAIR**

Sheet No.
S002

Sheet of Sheet