

CRW877TH

TYPE OF RECORD: PERMANENT

CATEGORY OF RECORD: EASEMENT

NAME OF AGENCY OR CONTRACTOR: GEORGE A. CRAWFORD AND DAVID ROBERTS

STREET ADDRESS/PARCEL NAME/SUBDIVISION/PROJECT: MAP DEDICATING RIGHT-OF-WAY FOR SOUTH 7TH STREET

CITY DEPARTMENT: PUBLIC WORKS

YEAR: 1887

EXPIRATION DATE: NONE

DESTRUCTION DATE: NONE

CRAWFORD'S ADDITION
Grand Junction Colo.
Scale 132 ft to 1 inch

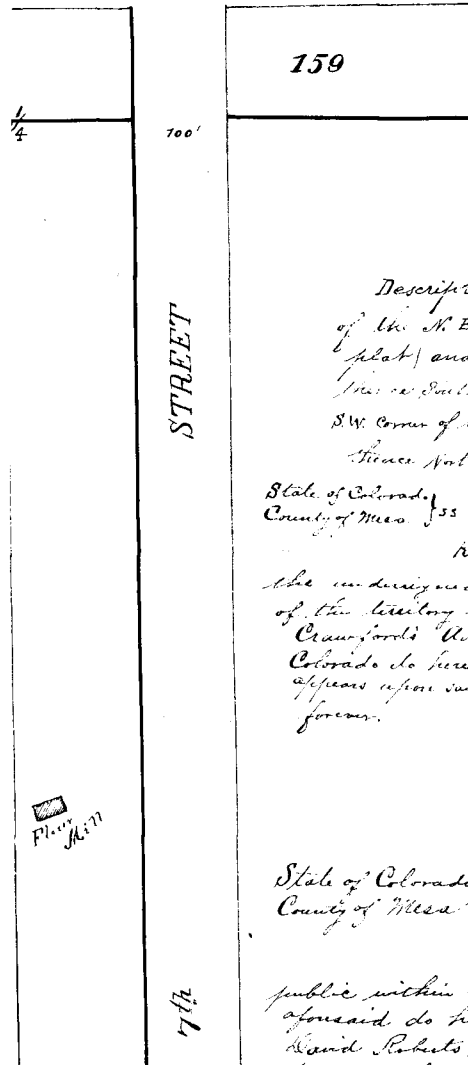

Description - Commencing at the S.W. Corner of the N.E. 1/4 of Sec 23 T 18 R 17W (marked 1/4 on plat) and running thence east 232 feet thence thence South 7320 feet thence West 232 feet to the S.W. Corner of the N.W. 1/4 of the N.E. 1/4 Sec 23 (marked 1/4 on plat) thence North 1320 feet to place of beginning

State of Colorado }
County of Mesa } ss

Know all Men by these presents; That we the undersigned owners of more than two thirds of the area of the territory included within the annexed plat of Crawford's Addition to the Town of Grand Junction Colorado do hereby dedicate all streets and alleys therein as appears upon said plat, to the use of the public forever.

George A. Crawford
David Roberts

State of Colorado }
County of Mesa } ss

I J. Clayton Nichols a notary public within and for said county of Mesa in the State of said do hereby certify that George A. Crawford and David Roberts who are personally known to me to be the