

UTE95FL8

TYPE OF RECORD: PERMANENT

CATEGORY OF RECORD: CONTRACT

NAME OF AGENCY OR CONTRACTOR: UTE WATER CONSERVANCY DISTRICT

STREET ADDRESS/PARCEL NAME/SUBDIVISION/PROJECT: EIGHTH ADDENDUM TO
FIRELINE CONTRACT FOR REDLAND PARKWAY

CITY DEPARTMENT: PUBLIC WORKS

YEAR: 1995

EXPIRATION DATE: NONE

DESTRUCTION DATE: NONE

FIRELINE UPGRADE
PROJECT ADDENDUM VIII

Pursuant to paragraph 1.f. of the City/Ute AGREEMENT dated August 17, 1995 the attached schematic drawing and following information is submitted for review this 3rd day of August 1995, as "PROJECT ADDENDUM VIII".

BASIC CONDITION :

1. The benefitting property is divided into 3 parcels by the road right-of-way of the Redlands Parkway and its access ramps, but is under the single ownership of Clifton L. Mays, who has requested this fireline upgrade.
2. Approximately 1,300 feet of 12" water main will be required from a point just east of Leach Creek to a point on the west side of the west access to Redlands Parkway, along River Road..
3. No more than four (4) new fire hydrants will be necessary.

SPECIAL CONDITIONS:

1. An underground crossing of Leach Creek will be constructed following reduced flow at the end of the irrigation season.

ESTIMATED COSTS:

Leach Creek crossing	\$12,000.00
1,300 lineal feet of 12" C900 @ \$45/ft, installed	58,500.00
4 fire hydrant assemblies @ \$1,500.00	6,000.00
12% Administrative & Overhead	9,180.00
PRELIMINARY ESTIMATED TOTAL	<u>\$85,680.00</u>
1/3 City, 1/3 Ute, 1/3 Property Owner	\$28,560.00

SCHEDULING:

1. Construction plans & specifications developed and reviewed, early September.
2. Advertisement for Bids, mid-September.
3. Bid opening and award of contract, early October.
4. Notice to proceed and construction, November.

IN WITNESS WHEREOF, the parties have entered into and approved this PROJECT ADDENDUM as of the dates set forth below.

Approved this 9th day of AUGUST, 1995, by the Board of Directors of Ute Water Conservancy District.



President of the Board

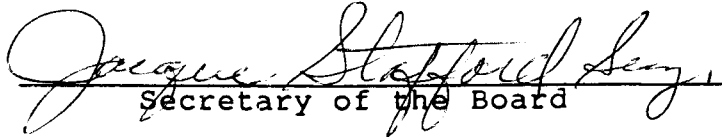

Secretary of the Board

(Seal)

Approved this 20th day of September, 1995, by the City Council of the City of Grand Junction, Colorado.



President of the Council

(Seal)

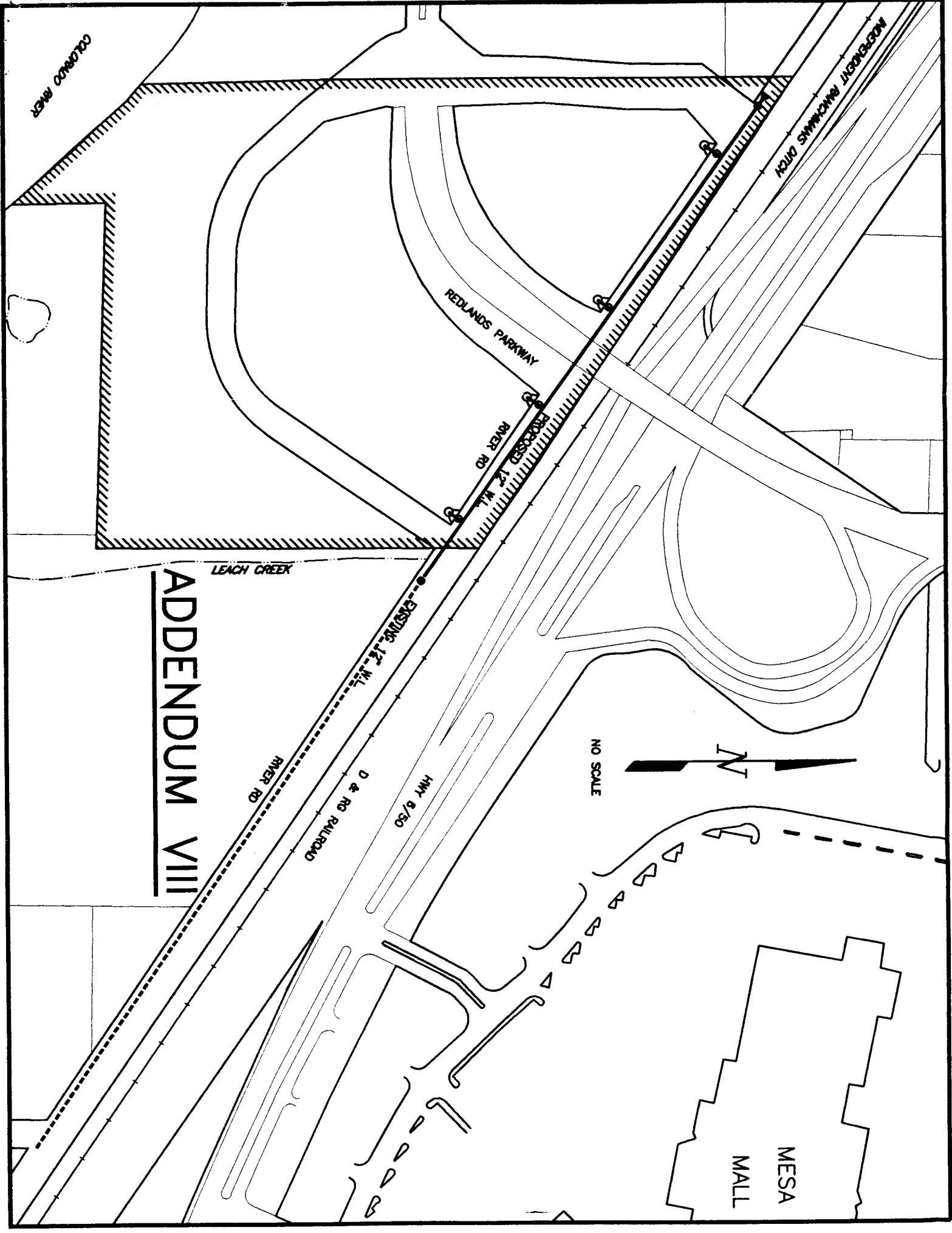

COLORADO MESA

ADJACENT RANCHLANDS DITCH

REDLANDS PARKWAY

RIVER RD

PROPOSED 1/2 MILE RIVER RD

LEACH CREEK

ADDENDUM VIII

RIVER RD

D & RQ RAILROAD

HWY 8/50

NO SCALE



MESA MALL