

UTE96A12

TYPE OF RECORD: PERMANENT

CATEGORY OF RECORD: CONTRACT

NAME OF AGENCY OR CONTRACTOR: UTE WATER CONSERVANCY DISTRICT

STREET ADDRESS/PARCEL NAME/SUBDIVISION/PROJECT: 12TH ADDENDUM TO FIRLINE
CONTRACT FOR SOUTH SHOULDER OF RIVER ROAD FROM THE WEST REDLANDS PARKWAY
ACCESS TO 23 ROAD

CITY DEPARTMENT: PUBLIC WORKS

YEAR: 1996

EXPIRATION DATE: NONE

DESTRUCTION DATE: NONE

FIRELINE UPGRADE

PROJECT ADDENDUM XII

Pursuant to paragraph 1.f. of the City/Ute AGREEMENT dated August 17, 1993, the attached schematic drawing and following information is submitted for review this 29th day of May, 1996, as "PROJECT ADDENDUM XII".

BASIC CONDITIONS:

1. This project will consist of installing 5,236 lineal feet of 12-inch water main along the south shoulder of River Road from the West Redlands Parkway Access to 23 Road. This water main will provide fire protection to 14 commercial properties fronting River Road and fire flow access to 13 properties south of River Road all within the River Road Annexation.
2. Fire hydrants will be installed along River Road at locations best suited for existing structures. Fire hydrants will not be installed at vacant land parcels.

SPECIAL CONDITIONS:

1. Ute water will participate in the 1/3 cost share for the 12-inch water main from the West Redlands Parkway Access to 23 Road.
2. The cost of fire hydrants benefiting existing structures will be assessed at 100% to the property owners where development or structures exist. Fire hydrants will not be installed at vacant land.

ESTIMATED COSTS:

From West Parkway Access to 23 Road:
5,236 lineal feet of 12" C-900 @ \$22.88/ft.\$119,799.68
(not including fire hydrants)
12% Engineering and Administration..... 14,375.96
Total = \$134,175.64

COST SHARE SUMMARY:

From West Parkway Access to 23 Road:
1/3 Ute Water.....\$ 44,725.21
1/3 City 44,725.21
1/3 Property Owners 44,725.21

Total Acreage = 198.47

Property Owners approximate cost share per acre = \$ 225.35

SCHEDULING:

1. Project has been advertized and bids were received on May 9, 1996. M. A. Concrete Construction was the low bidder at \$259,460.40 for 8,806 lineal feet of 12" water line which includes the entire reach from the Parkway Access to Railhead Subdivision. The bid also included price to install 29 fire hydrants at \$58,000.00. Sixteen (16) of these fire hydrants will be deleted from the contract (if executed).
2. Award of construction contract is pending approval of this AGREEMENT by the City.

IN WITNESS WHEREOF, the parties have entered into and approved this PROJECT ADDENDUM as of the dates set forth below.

Approved this 29th day of May, 1996, by the Board of Directors of Ute Water Conservancy District.

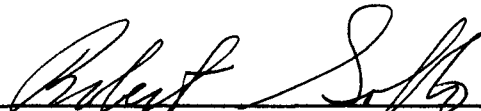

President of the Board

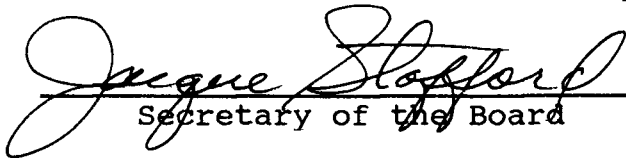

Secretary of the Board

(Seal)

Approved this 5th day of June, 1996,
by the City Council of the City of Grand Junction, Colorado.

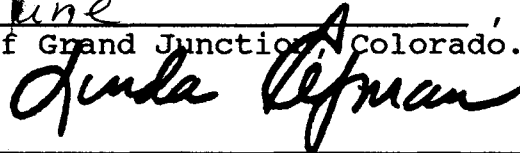

President of the Council



RIVER ROAD ANNEXATION CURRENT LAND USE

RIVER ROAD ANNEXATION PROPOSED BOUNDARY
 CITY LIMITS

*FIRELINE UPGRADE AREA
ADDENDUM XII*

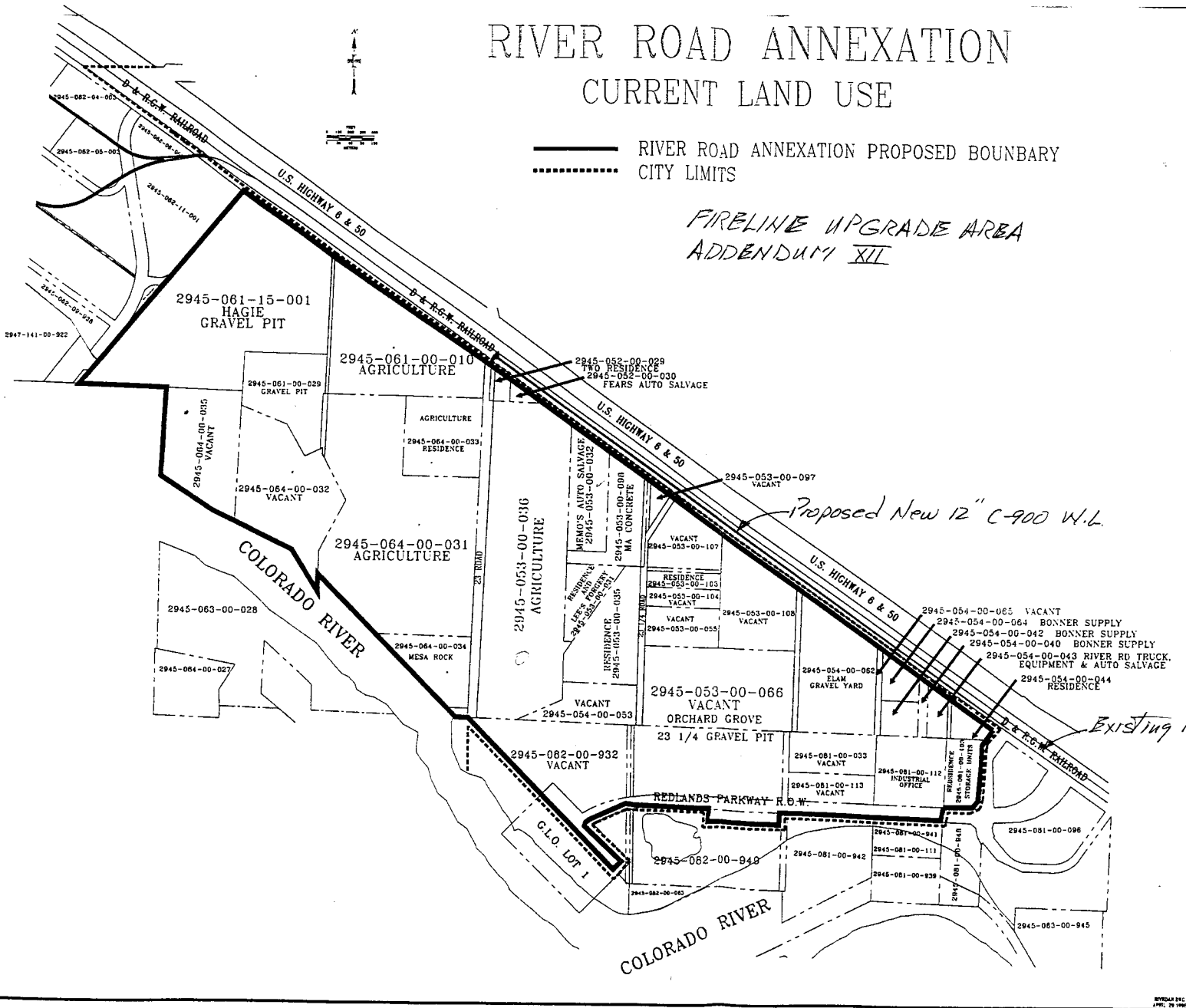

FIRELINE UPGRADE

PROJECT ADDENDUM XII

Pursuant to paragraph 1.f. of the City/Ute AGREEMENT dated August 17, 1993, the attached schematic drawing and following information is submitted for review this 23rd day of May, 1996, as "PROJECT ADDENDUM XII".

BASIC CONDITIONS:

1. This project will consist of installing 8,806 lineal feet of 12-inch water main along the south shoulder of River Road from the west Redlands Parkway Access to just east of Railroad Boulevard. This water main will provide fire protection to 16 commercial properties fronting River Road and fire flow access to 19 properties south of River Road all within the River Road Annexation.
2. Fire hydrants will be installed along River Road at locations best suited for existing structures. Fire hydrants will not be installed at vacant land parcels.

SPECIAL CONDITIONS:

1. Ute water will participate in the 1/3 cost share for the 12-inch water main from the West Redlands Parkway Access to 23 Road. Ute Water will not participate in a 1/3 cost share from 23 Road to Railhead Boulevard.
2. City of Grand Junction will pay 2/3 of the cost for the 12-inch main from 23 Road to Railroad Boulevard.
3. The cost of fire hydrants benefiting existing structures will be assessed at 100% to the property owners where development or structures exist. Fire hydrants will not be installed at vacant land.

ESTIMATED COSTS:

Reach #1- From West Parkway Access to 23 Road:	
5,180 lineal feet of 12" C-900 @ \$22.88/ft.	\$118,518.40
(not including fire hydrants)	
12% Engineering and Administration.....	<u>14,222.21</u>
Total for Reach #1 =	\$132,740.61
Reach #2- From 23 Road to Railroad Boulevard:	
3,626 lineal feet of 12" C-900 @ \$22.88/ft.	\$ 82,962.88
(not including fire hydrants)	
12% Engineering and Administration.....	<u>9,955.55</u>
Total for Reach #2 =	\$ 92,918.43

COST SHARE SUMMARY:

Reach #1- From West Parkway Access to 23 Road:

1/3 Ute Water.....	\$ 44,246.87
1/3 City	44,246.87
1/3 Property Owners	44,246.87

Reach #2- From 23 Road to Railroad Boulevard:

2/3 City	\$ 61,945.62
1/3 Property Owners	30,972.81

Total Property Owners Cost Share Reach #1 + Reach #2 =\$75,219.68
Total Acreage = 363.68

Property Owners approximate cost share per acre = \$ 206.83

SCHEDULING:

1. Project has been advertized and bids were received on May 9, 1996. M. A. Concrete Construction was the low bidder at \$259,460.40 which includes price to install 29 fire hydrants at \$58,000.00. Sixteen (16) of these fire hydrants will be deleted from the contract (if executed).
2. Award of construction contract is pending approval of this AGREEMENT by the City.

IN WITNESS WHEREOF, the parties have entered into and approved this PROJECT ADDENDUM as of the dates set forth below.

Approved this 23rd day of May, 1996, by the Board of Directors of Ute Water Conservancy District.

Robert Sells
President of the Board

Jacqueline Stafford Long
Secretary of the Board

(Seal)

Approved this 19th day of June, 1996, by the City Council of the City of Grand Junction, Colorado.

Junda Corman
President of the Council



RIVER ROAD ANNEXATION CURRENT LAND USE

———— RIVER ROAD ANNEXATION PROPOSED BOUNDARY
- - - - - CITY LIMITS

*FIRELINE UPGRADE AREA
ADDENDUM XII*

