

RESOLUTION NO. 16-11

A RESOLUTION AUTHORIZING THE LEASE OF SIDEWALK RIGHT-OF-WAY TO  
ROCKSLIDE BREWPUB, INC.

**Recitals:**

The City has negotiated an agreement for Rockslide Brewpub, Inc. to lease a portion of the sidewalk right-of-way located in front of 401 Main Street from the City for use as outdoor dining; and

The City Council deems it necessary and appropriate that the City lease said property to Rockslide Brewpub, Incorporated.

**NOW, THEREFORE, BE IT RESOLVED BY THE CITY COUNCIL OF THE CITY OF GRAND  
JUNCTION, COLORADO:**

The City Manager is hereby authorized and directed to sign the Lease Agreement leasing the city-owned sidewalk right-of-way for a period of twelve months at \$667 per year, to Rockslide Brewpub, Incorporated.

PASSED and ADOPTED this 4<sup>th</sup> day of April, 2011.



\_\_\_\_\_  
President of the Council

Attest:

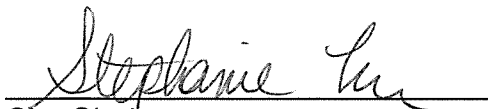
  
\_\_\_\_\_  
City Clerk

## OUTDOOR DINING LEASE AGREEMENT

THIS LEASE AGREEMENT ("Agreement") is made and entered into as of April 4, 2011, by and between THE CITY OF GRAND JUNCTION, COLORADO, a municipal corporation, as Lessor, hereinafter City and, Rockslide Brewpub, Inc., as Lessee, hereinafter Lessee.

### RECITALS:

The City by Ordinance No. 3650 and subsequently amended by Ordinance No. 4120 established a Sidewalk Restaurant commercial activity permit for restaurants in the Downtown Shopping Park (DSP) on Main Street, Seventh Street and Colorado Avenue.

In accordance with that authority the City Council and the Downtown Development Authority (DDA) desire to make certain areas of the sidewalk in the DSP available by lease to approximate land owners and/or lessees that want to make use of a portion of the sidewalk in the DSP for restaurant and/or alcohol service.

NOW THEREFORE, in consideration of the mutual covenants, terms and conditions contained herein, it is agreed as follows:

1. The City does hereby lease to Lessee approximately 667 square feet of the sidewalk in the DSP located in front of 401 Main Street, hereinafter the Leased Area; specifically the Leased Area is that portion of the sidewalk immediately across the sidewalk from the Lessee's business. The Leased Area is depicted on the attached Exhibit A.
2. The City does hereby grant an easement across the abutting sidewalk for the purpose of transporting alcohol beverages and providing food service. Such easement runs concurrent with said lease and terminates when said lease terminates.
3. The term of this lease shall be for a period of one year beginning on April 4, 2011, and terminating on August 18, 2012. Rent shall be calculated at \$1.00 per square foot per year. As rent for the Leased Area, Lessee agrees to pay the City the total sum of \$889.36, which sum shall be payable in advance on or before April 4, 2011, at the offices of the City Clerk, Grand Junction City Hall, 250 North 5<sup>th</sup> Street, Grand Junction, Colorado 81501.

If the rent payment is not paid in full when due, a Lease shall not issue.

4. Lessee agrees to use the Leased Area for the sole purpose of selling and dispensing food and/or beverages to the public. The Leased Area shall be open to the public, weather permitting, during the Lessee's normal business hours but in no event shall food and/or beverage service be extended beyond 12:00 midnight. Food shall be available to be served in the Leased Area during all

hours that it is open to the public and in accordance with the Lessee's liquor license.

5. Lessee further agrees to use the Leased Area for no purpose prohibited by the laws of the United States, the State of Colorado or ordinances of the City of Grand Junction. Further, Lessee agrees to comply with all reasonable recommendations by DDA relating to the use of the Leased Area. Prior to alcohol service the Lessee shall modify its liquor licensed premises as required by the laws of the State and City. **Inclusion of the licensed premises in the licensed liquor service area, in accordance with Colorado law, is a precondition to exercise the authority allowed for by this lease.**
6. Lessee shall remove any improvements, enclosures, furniture, fixtures, equipment or structures installed by it or at its direction on the Leased Area promptly upon expiration of this Lease. Failure to remove the same within ten (10) days of expiration shall result in ownership thereof transferring to the DDA.
7. Lessee agrees to keep the Leased Area in good repair and free from all litter, dirt and debris and in a clean and sanitary condition; to neither permit nor suffer any disorderly conduct or nuisance whatsoever, which would annoy or damage other persons or property by any alteration to the Leased Area or by any injury of accident occurring thereon. Further, Lessee does, by execution of this Lease, indemnify and hold harmless the City of Grand Junction and the DDA and its employees, elected and appointed officials, against any and all claims for damages or personal injuries arising from the use of the Leased Area. Lessee agrees to furnish certificate(s) of insurance as proof that it has secured and paid for a policy of public liability insurance covering all public risks related to the leasing, use, occupancy, maintenance and operation of the Leased Area. Insurance shall be procured from a company authorized to do business in the State of Colorado and be satisfactory to the City. The amount of insurance, without co-insurance clauses, shall not be less than the maximum liability that can be imposed upon the City under the laws of the State, as amended. Lessee shall name the City and the DDA as named insureds on all insurance policies and such policies shall include a provision that written notice of any non-renewal, cancellation or material change in a policy by the insurer shall be delivered to the City no less than ten (10) days in advance of the effective date.
8. All construction, improvements, furniture, fixtures and/or equipment on the Leased Area shall comply with the following:
  - a. Not be wider than the street frontage of the business nor extend to the extent that pedestrian traffic is impeded.
  - b. No portion of the Lessee's furniture, fixtures or equipment shall extend beyond the boundaries of the Leased Area; this shall be construed to include perimeter enclosures, planters, shade structure(s), umbrellas while

closed or open and any other fixtures, furniture or equipment placed or utilized by the Lessee.

- c. The perimeter enclosure shall be angled at forty-five (45) degrees with a minimum of four (4) feet in length on the diagonal(s) with the exception that if the Lessee obtains written consent from the adjacent business, a ninety (90) degree angle will be permitted on the side(s) for which the Lessee has obtained such written consent.
- d. The perimeter of the Leased Area is primarily enclosed by brick planter walls; any gap in this wall shall be closed by a black wrought-iron fence (perimeter enclosure) as approved by DDA, no less than thirty (30) inches in height. Openings in the fence shall not be less than 44 inches wide. If there is a gate which is not self-closing and bi-directional it must swing inward to prevent obstruction of the sidewalk.
- e. No cooking shall be located on the Leased Area.
- f. Lessee may place furniture, fixtures and equipment in the Leased Area so long as the same are not allowed to encroach into the public right of way or otherwise to endanger any passerby or patron and are secured to resist wind.
- g. The Lessee shall allow its fixtures and perimeter fencing to remain in place at its own discretion and liability and shall accept and retain full responsibility and liability for any damage to such fixtures and perimeter fencing caused thereby.
- h. Neither electric (alternating current) nor gaslights are allowed on the Leased Area. Candles and battery powered lights are allowed.
- i. Between and including the dates of November 1 - March 1 the Lessee shall remove and store separate and away from the Leased Area all fixtures and furnishings including but not limited to umbrellas, chairs, tables, signs and food/beverage preparation and service equipment.
- j. On and after March 1, 2012 the Lessee shall not allow signage, including but not limited to banners, on the Leased Area. Similarly signage shall be disallowed on furniture, which includes but is not limited to, chairs, benches, tables, umbrellas, planters and the perimeter fence of the Leased Area. Menu signs shall be allowed in accordance with provisions of the City of Grand Junction sign code and subject to review by the DDA.
- k. At those locations where Lessee uses public trash and/or recycling receptacles for refuse generated from Leased Area, the Lessee shall periodically empty those receptacles. For those locations which regularly use public receptacles the Lessee may request that the DDA provide trash

bags/container liners for the Lessee's use in the public containers in accordance with the terms of this paragraph.

9. The leased premises and improvements, additions and fixtures, furniture and equipment thereon shall be maintained and managed by Lessee.
10. Lessee agrees to permit agents of the City and/or the DDA to enter upon the premises at any time to inspect the same and make any necessary repairs or alterations to the sidewalks, utilities, meters or other public facilities as the City may deem necessary or proper for the safety, improvement, maintenance or preservation thereof.

Lessee further agrees that if the City shall determine to make changes or improvements to the DSP, which may affect any improvements placed by the Lessee, that the Lessee, by execution of this Agreement, hereby waives any and all right to make any claim for damages to the improvements (or to its leasehold interest) and agrees to remove any structures necessary during such construction periods. The City agrees to rebate all rents in the event it undertakes major structural changes during a lease period.

11. The City by this demise hereby conveys no rights or interest in the public way except the right to the uses on such terms and conditions as are above described and retains all title thereto.
12. Lessee agrees not to sublet any portion of the Leased Area, not to assign this lease without the prior written consent of the City being first obtained.
13. Lessee hereby affirms that Lessee is the owner and/or lessee of the abutting property and agrees that on sale or other transfer of such ownership interest, Lessee will so notify the City of the transfer in interest and all right and interest under this Lease shall terminate.
14. Lessee agrees to surrender and deliver up the possession of the Leased Area promptly upon the expiration of this Lease or upon five (5) days' written notice in the case of the termination of this Lease by City by reason of a breach in any provisions hereof.
15. If legal action is taken by either party hereto to enforce any of the provisions of this Lease, the prevailing party in any legal action shall be entitled to recover from the other party all of its cost, including reasonable attorney's fees.
16. It is further agreed that no assent, expressed or implied, to any breach of any one or more of the covenants or agreements herein shall be deemed or taken to be a waiver of any succeeding or any other breach.
17. Lessee agrees to comply with all laws, ordinances, rules and regulations that may pertain or apply to the Leased Area and its use. In performing under the Lease,

Lessee shall not discriminate against any worker, employee or job applicant, or any member of the public because of race, color, creed, religion, ancestry, national origin, sex, age, marital status, physical handicap, status or sexual orientation, family responsibility or political affiliation, or otherwise commit an unfair employment practice.

18. Lessee and City agree that all correspondence concerning the Lease shall be in writing and either hand delivered or mailed by first class certified mail to the following parties:

City Manager  
City of Grand Junction  
250 North 5<sup>th</sup> Street  
Grand Junction, CO 81501

Lessee:  
Rockslide Brewpub, Inc.  
401 Main Street  
Grand Junction, CO 81501

CITY OF GRAND JUNCTION

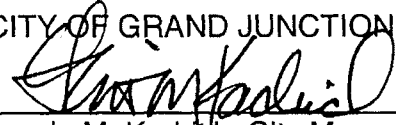

Laurie M. Kadrach, City Manager

LESSEE



Business Owner

EXHIBIT A

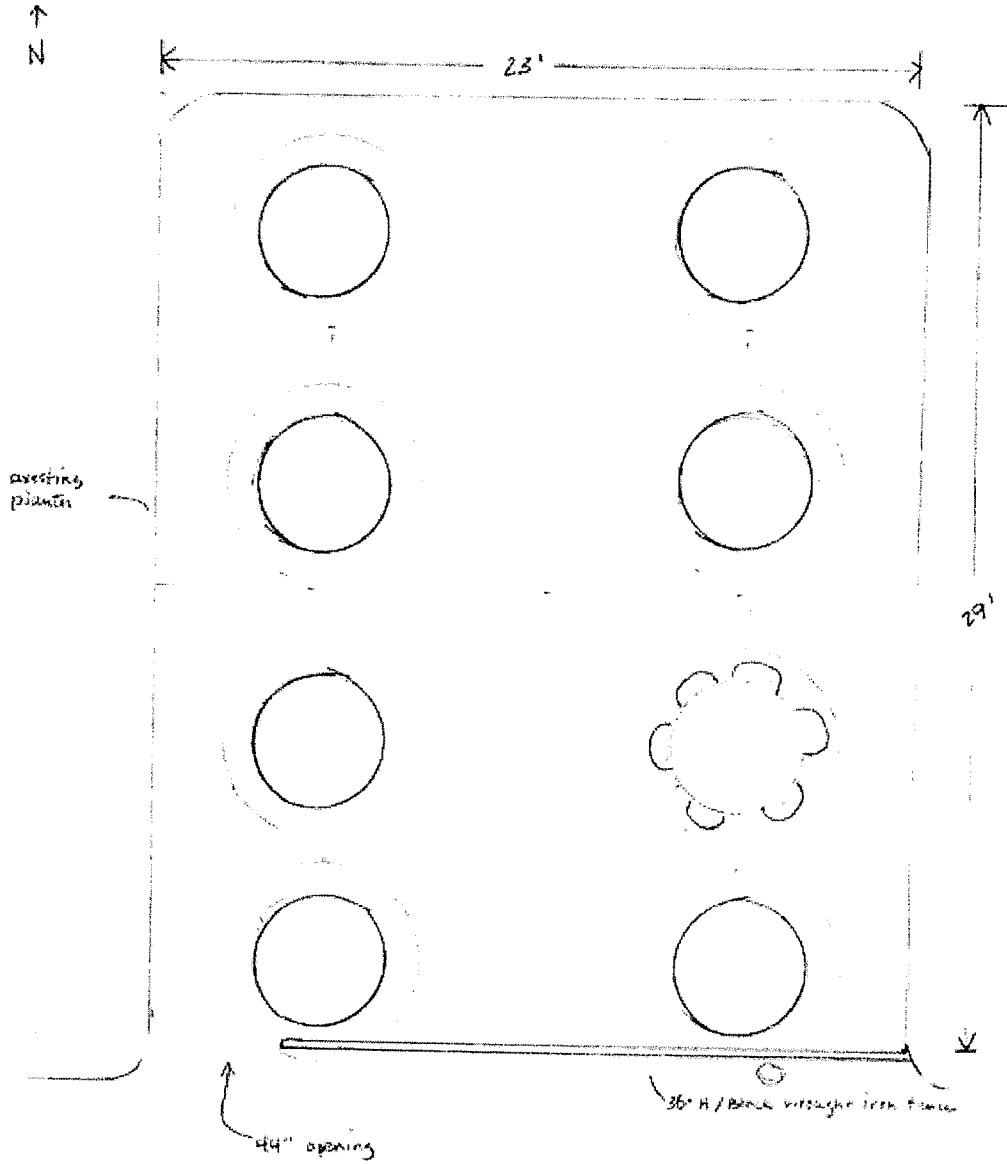

8 X 48' tables  
6 chairs 2x  
48 chairs  
667 sq ft