

CITY OF GRAND JUNCTION

BOARD OF ADJUSTMENT

MINUTES

The City Board of Adjustment of Grand Junction was called to order at 8:05 A.M., in the City Council Chambers on August 28, 1975, by Chairman, Warren Lowe, with the following members present: Blaine Ford, Cecil Hobbs, and Warren Lowe.

Also present were: Richard Hollinger, Chief Building Inspector; and Mr. and Mrs. Cecil Rorex.

The minutes were read by Richard Hollinger and approved by the Board as read. There were no additions to the agenda.

1. Request a 2 foot side yard vaiance from 5 feet to 3 feet for a 2 foot fire place stack to be attached to the west end of a house.

Richard Hollinger: There doesn't seem to be any objections from the neighbors. There is no hazard that I can see and the encroachment on light and air is very minimal.

Blaine Ford made a motion to approve the request for a variance and Cecil Hobbs seconded the motion. The motion was passed.

The meeting was adjourned at 8:15 A.M.

FEE \$~~10.00~~
\$7.00

PETITION FOR VARIANCE

~~MESA COUNTY~~ GRAND JUNCTION

Petitioner: Cecil Rorex

Address: 1335 Mesa

Phone: 243-9543

I, the undersigned, hereby petition for a variance located at 1335 Mesa Ave. to be reviewed by GRAND JUNCTION the ~~Mesa County~~ Board of Adjustment for the following purpose:

2' fire place stack, attached to West end of house
Variance 5' to 3'

Legal description Lot 11 Blk 1 Prospect Park Etc N+ S
10' there of

Legal description of proposed variance:

2' fire place stack to be attached west end of house

Other information required:

- ~~1. Names and addresses of all property owners within 500 feet of subject property, attached on separate sheet.~~
- ~~2. For all conditional and special uses requiring Board of Adjustment approval, a fee of \$75.00 shall be charged to cover advertising and processing costs.~~
- ~~3. Plot plan showing location of property and nature of variance; also a county assessor's map of the area.~~

Cecil Rorex
signature of petitioner

date: _____ receipt #: _____

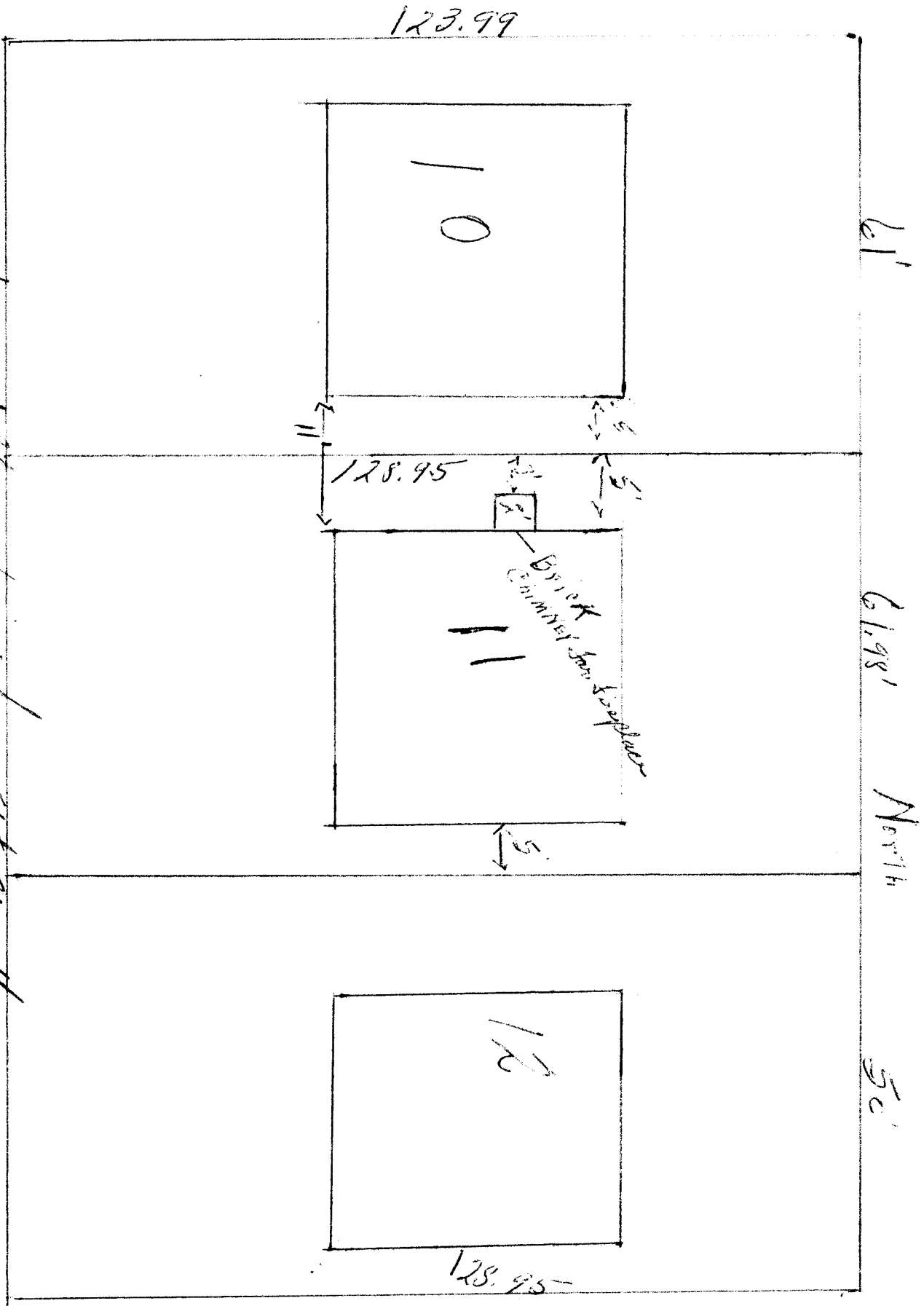

We would like a variance from 5' to 3' on the west end of our house to build a fireplace chimney.