



SIGN PERMIT

Community Development Department
250 North 5th Street
Grand Junction, CO 81501
(970) 244-1430

AC

Permit No. N/A
Date Submitted 3-26-02
FEE \$ 25.00
Tax Schedule 2945-091-01-018
Zone C-2

BUSINESS NAME ALL SPORTS VENTURES
STREET ADDRESS 587 25 ROAD
PROPERTY OWNER DAVE MIDNAUGH
OWNER ADDRESS SAME

CONTRACTOR Buo's SIGNS
LICENSE NO. 2020157
ADDRESS 1055 UTE AVE
TELEPHONE NO. 245-7700

- 1. FLUSH WALL 2 Square Feet per Linear Foot of Building Facade
- Face Change Only (2,3 & 4):
- 2. ROOF 2 Square Feet per Linear Foot of Building Facade
- 3. FREE-STANDING 2 Traffic Lanes - 0.75 Square Feet x Street Frontage
4 or more Traffic Lanes - 1.5 Square Feet x Street Frontage
- 4. PROJECTING 0.5 Square Feet per each Linear Foot of Building Facade

Existing Externally or Internally Illuminated - No Change in Electrical Service Non-Illuminated

(1 - 4) Area of Proposed Sign 16 Square Feet
(1,2,4) Building Facade 125 Linear Feet
(1 - 4) Street Frontage 150 Linear Feet
(2,3,4) Height to Top of Sign 16 Feet Clearance to Grade 12 Feet

Existing Signage/Type:	
FLUSH WALL (1)	47 Sq. Ft.
FREESTANDING (1)	48 Sq. Ft.
	Sq. Ft.
Total Existing:	95 Sq. Ft.

● FOR OFFICE USE ONLY ●	
Signage Allowed on Parcel:	
Building	250 Sq. Ft.
Free-Standing	112.5 Sq. Ft.
Total Allowed:	250 Sq. Ft.

COMMENTS: _____

NOTE: No sign may exceed 300 square feet. A separate sign permit is required for each sign. Attach a sketch of proposed and existing signage including types, dimensions, lettering, abutting streets, alleys, easements, property lines, and locations. Roof signs shall be manufactured such that no guy wires, braces or supports shall be visible.

[Signature] 3-26-02 C. Tays Johnson 3/29/02
Applicant's Signature Date Community Development Approval Date

(White: Community Development)

(Canary: Applicant)

(Pink: Code Enforcement)

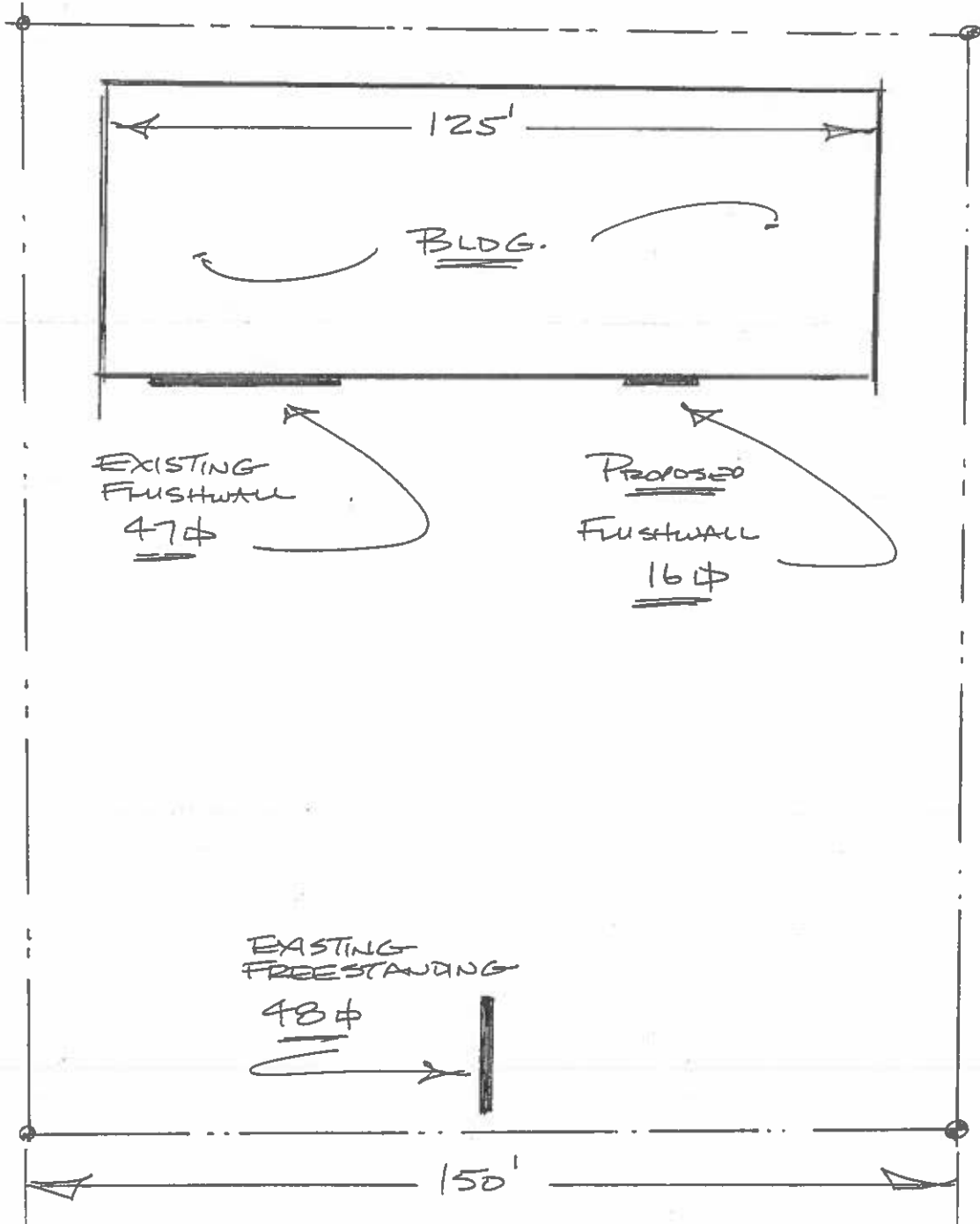

25 ROAD

4'-0"

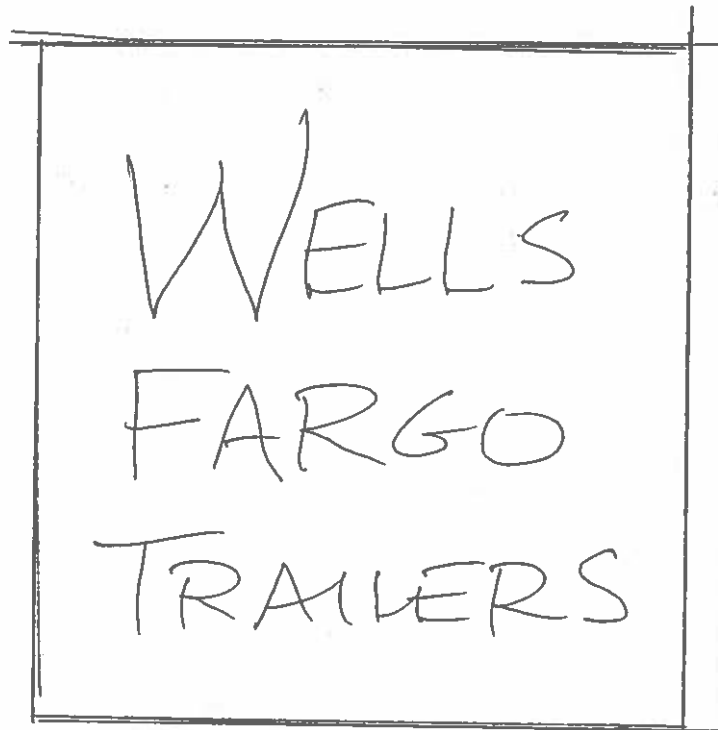

4'-0"

ELEVATION