



# SIGN CLEARANCE

*AE*

Community Development Department  
250 North 5th Street  
Grand Junction, CO 81501  
(970) 244-1430

Clearance No. \_\_\_\_\_  
Date Submitted 2/6/02  
FEE \$ 25.00  
Tax Schedule 2945-102-00-159  
Zone C-2

BUSINESS NAME The Foreign Aid  
STREET ADDRESS 1574 25 Road  
PROPERTY OWNER Myrl and Georgia Rumsby  
OWNER ADDRESS 1935 Broadway G.J.

CONTRACTOR CW04  
LICENSE NO. 2020262  
ADDRESS P.O. Box 2906  
TELEPHONE NO. 242-5248

- 1. FLUSH WALL 2 Square Feet per Linear Foot of Building Facade
- 2. ROOF 2 Square Feet per Linear Foot of Building Facade
- 3. FREE-STANDING 2 Traffic Lanes - 0.75 Square Feet x Street Frontage  
4 or more Traffic Lanes - 1.5 Square Feet x Street Frontage
- 4. PROJECTING 0.5 Square Feet per each Linear Foot of Building Facade
- 5. OFF-PREMISE See #3 Spacing Requirements; Not > 300 Square Feet or < 15 Square Feet

Externally Illuminated       Internally Illuminated       Non-Illuminated

- (1 - 5) Area of Proposed Sign 88' Square Feet
- (1,2,4) Building Facade 35 Linear Feet
- (1 - 4) Street Frontage 200' Linear Feet
- (2,4,5) Height to Top of Sign \_\_\_\_\_ Feet Clearance to Grade \_\_\_\_\_ Feet
- (5) Distance from all Existing Off-Premise Signs within 600 Feet \_\_\_\_\_ Feet

Existing Signage/Type:	
4' x 12' Wall Sign	48 Sq. Ft.
8' x 8' Pole Sign	64 Sq. Ft.
3' x 8' " "	24 Sq. Ft.
Total Existing:	136 Sq. Ft.

● FOR OFFICE USE ONLY ●	
Signage Allowed on Parcel:	
Building	70 Sq. Ft.
Free-Standing	150 Sq. Ft.
Total Allowed:	150 Sq. Ft.

COMMENTS: \_\_\_\_\_

NOTE: No sign may exceed 300 square feet. A separate sign clearance is required for each sign. Attach a sketch of proposed and existing signage including types, dimensions, lettering, abutting streets, alleys, easements, property lines, and locations. **A SEPARATE PERMIT FROM THE BUILDING DEPARTMENT IS REQUIRED.**

[Signature] Applicant's Signature      2/6/02 Date      Ronnie Edwards Community Development Approval      3/22/02 Date

(White: Community Development)      (Canary: Applicant)      (Pink: Building Dept)      (Goldenrod: Code Enforcement)

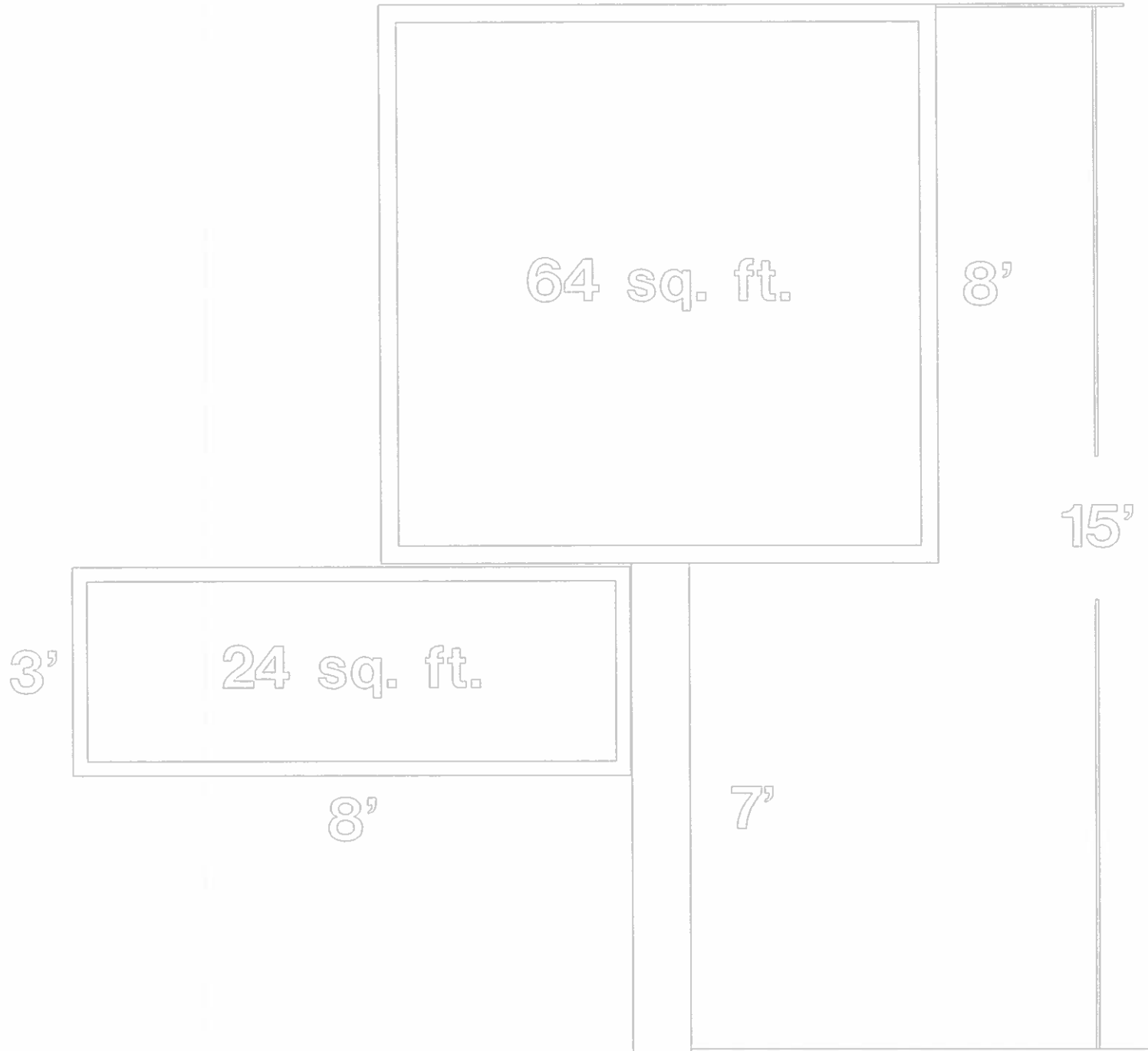

8'

64 sq. ft.

8'

15'

3'

24 sq. ft.

8'

7'





