



# SIGN CLEARANCE

Community Development Department  
250 North 5<sup>th</sup> Street  
Grand Junction CO 81501  
(970) 244-1430

Clearance No. \_\_\_\_\_  
Date Submitted 10-1-02  
Fee \$ 25.00  
Zone C-2

TAX SCHEDULE 2945-232-01-007 CONTRACTOR Bud's Signs  
BUSINESS NAME Rocky Mountain Archery & Paintball LICENSE NO. 2020157  
STREET ADDRESS 404 Noland Ave. ADDRESS 1055 ute  
PROPERTY OWNER \_\_\_\_\_ TELEPHONE NO. 245-7700  
OWNER ADDRESS \_\_\_\_\_ CONTACT PERSON ERIC

- 1. FLUSH WALL 2 Square Feet per Linear Foot of Building Facade
- 2. ROOF 2 Square Feet per Linear Foot of Building Facade
- 3. FREE-STANDING 2 Traffic Lanes - 0.75 Square Feet x Street Frontage  
4 or more Traffic Lanes - 1.5 Square Feet x Street Frontage
- 4. PROJECTING 0.5 Square Feet per each Linear Foot of Building Facade
- 5. OFF-PREMISE See #3 Spacing Requirements; Not > 300 Square Feet or < 15 Square Feet

Externally Illuminated       Internally Illuminated       Non-Illuminated

(1 - 5) Area of Proposed Sign: 32 Square Feet  
(1,2,4) Building Façade: 90 Linear Feet  
(1 - 4) Street Frontage: 190 Linear Feet 190  
(2 - 5) Height to Top of Sign: 12 Feet      Clearance to Grade: 8 Feet  
(5) Distance from all Existing Off-Premise Signs within 600 Feet: \_\_\_\_\_ Feet

### EXISTING SIGNAGE/TYPE:

<u>Flush Wall</u>	<u>32</u>	Sq. Ft.
<u>Flush Wall</u>	<u>32</u>	Sq. Ft.
<u>Flush Wall</u>	<u>32</u>	Sq. Ft.
Total Existing:	<u>96</u>	Sq. Ft.

### ● FOR OFFICE USE ONLY ●

Signage Allowed on Parcel: Noland

Building	<u>180</u>	Sq. Ft.
Free-Standing	<u>14250</u>	Sq. Ft.
Total Allowed:	<u>14430</u>	Sq. Ft.

### COMMENTS:

**NOTE:** No sign may exceed 300 square feet. A separate sign clearance is required for each sign. Attach a sketch, to scale, of proposed and existing signage including types, dimensions and lettering. Attach a plot plan, to scale, showing: abutting streets, alleys, easements, driveways, encroachments, property lines, distances from existing buildings to proposed signs and required setbacks. A SEPARATE PERMIT FROM THE BUILDING DEPARTMENT IS ALSO REQUIRED.

I hereby attest that the information on this form and the attached sketches are true and accurate.

Eric Berritt  
Applicant's Signature

Date

Gayleen Henderson  
Community Development Approval

10-4-02  
Date

(White: Community Development)

(Canary: Applicant)

(Pink: Building Dept)

(Goldenrod: Code Enforcement)

# 1000's SIGNS and Neon

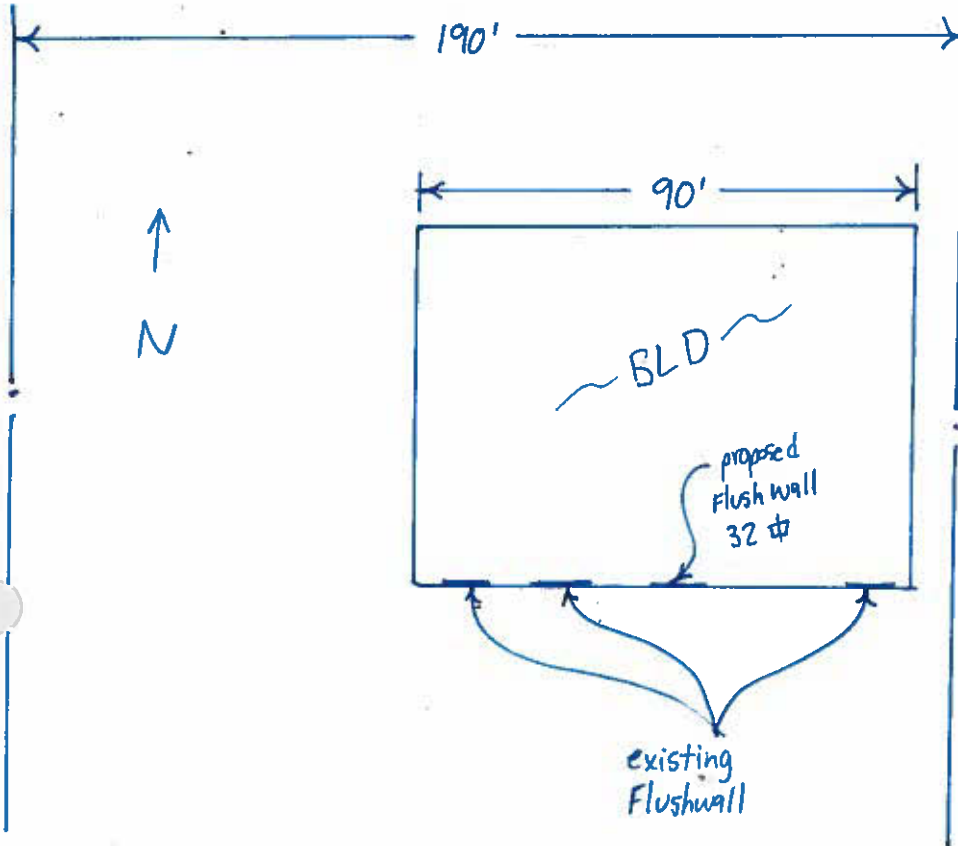

Noland Ave.

add 6 splats using fluorescent colors



**PAINTBALL**



add  
line

**ARCHERY**

**SEASON STARTS**

**SATURDAY**