



SIGN PERMIT

AK

Community Development Department
250 North 5th Street
Grand Junction, CO 81501
(970) 244-1430

Permit No. N/A
Date Submitted 3/22/02
FEE \$ 25.00
Tax Schedule 2945-123-23-012
Zone C-1

BUSINESS NAME FMR EAST REST.
STREET ADDRESS 1530 NORTH AVE
PROPERTY OWNER RAY QUINN
OWNER ADDRESS 1530 NORTH AVE

CONTRACTOR SIGNS FIRST
LICENSE NO. _____
ADDRESS 950 NORTH AVE
TELEPHONE NO. 256-1877

- 1. FLUSH WALL 2 Square Feet per Linear Foot of Building Facade
- Face Change Only (2,3 & 4):
- 2. ROOF 2 Square Feet per Linear Foot of Building Facade
- 3. FREE-STANDING 2 Traffic Lanes - 0.75 Square Feet x Street Frontage
4 or more Traffic Lanes - 1.5 Square Feet x Street Frontage
- 4. PROJECTING 0.5 Square Feet per each Linear Foot of Building Facade

Existing Externally or Internally Illuminated - No Change in Electrical Service Non-Illuminated

(1 - 4) Area of Proposed Sign 44 Square Feet
(1,2,4) Building Facade R Linear Feet North Ave 152' 15th St 152'
(1 - 4) Street Frontage 222 Linear Feet North Ave 222 15th St 265'
(2,3,4) Height to Top of Sign 20'6" Feet Clearance to Grade 15'6" Feet

Existing Signage/Type:		
F/S	North Ave	175 Sq. Ft.
F/S	15th	50 Sq. Ft.
		Sq. Ft.
Total Existing:		<u>50</u> Sq. Ft.

● FOR OFFICE USE ONLY ●	
Signage Allowed on Parcel:	<u>15th St</u>
Building	<u>304</u> Sq. Ft.
Free-Standing	<u>198.75</u> Sq. Ft.
Total Allowed:	<u>304</u> Sq. Ft.

COMMENTS: TAKE OUT "POLYNESIAN COCKTAILS" SIGN AND PUT IN MARQUEE / CHANGABLE LETTER PANEL ON EXISTING FREE STANDING SIGN

NOTE: No sign may exceed 300 square feet. A separate sign permit is required for each sign. Attach a sketch of proposed and existing signage including types, dimensions, lettering, abutting streets, alleys, easements, property lines, and locations. Roof signs shall be manufactured such that no guy wires, braces or supports shall be visible.

Applicant's Signature [Signature] Date _____ Community Development Approval C. Taysen Date 3/26/02

(White: Community Development) (Canary: Applicant) (Pink: Code Enforcement)

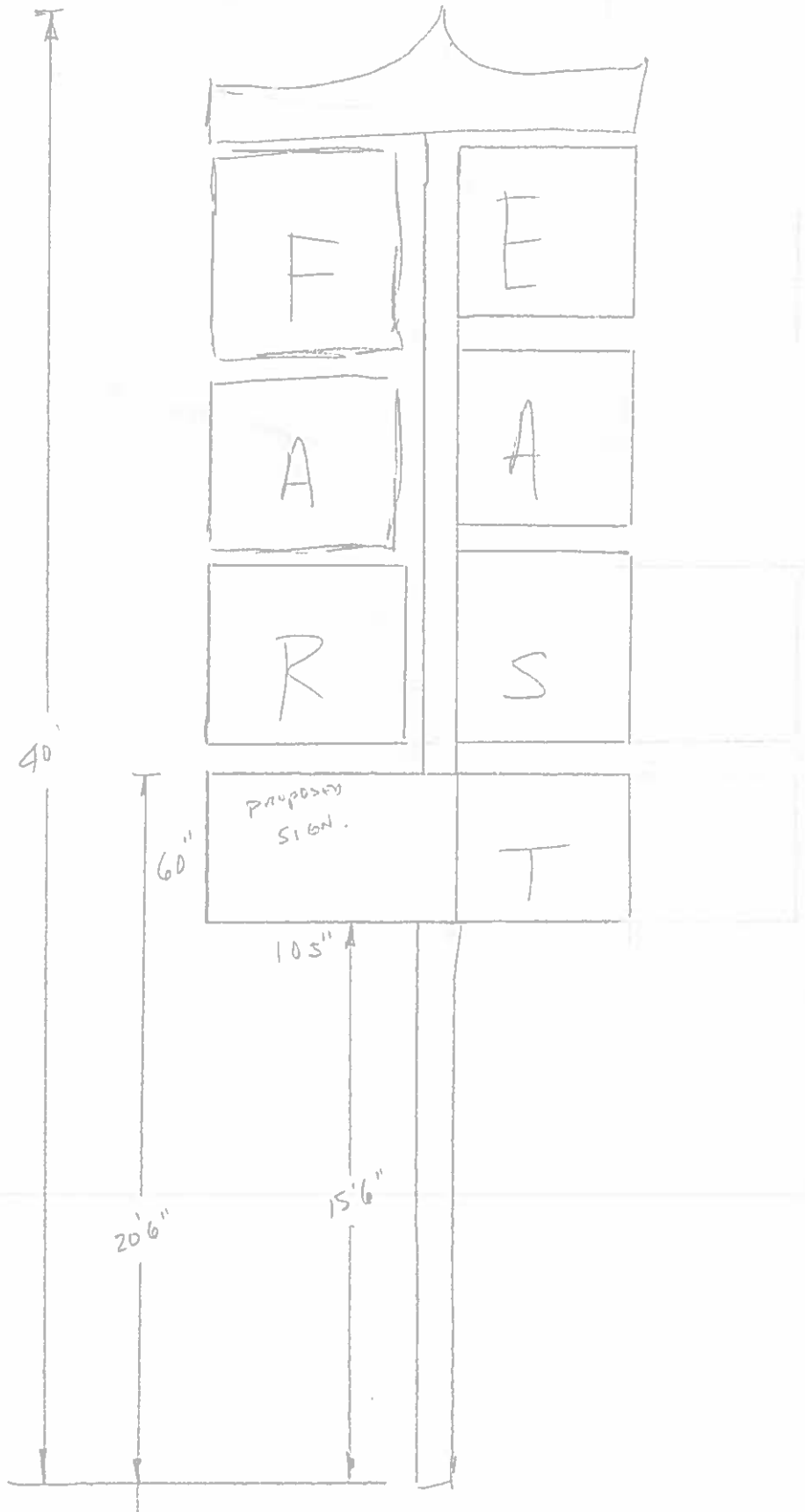

North
View

