

OAHP1403
Rev. 9/98

COLORADO CULTURAL RESOURCE SURVEY

Architectural Inventory Form

1 of 4

Official eligibility determination
(OAHP use only)

Date _____ Initials _____
 Determined Eligible- NR
 Determined Not Eligible- NR
 Determined Eligible- SR
 Determined Not Eligible- SR
 Need Data
 Contributes to eligible NR District
 Noncontributing to eligible NR District

I. Identification

1. Resource number: 5ME.14751
2. Temporary resource number: 535.CED
3. County: Mesa
4. City: Grand Junction
5. Historic building name: n/a
6. Current building name: n/a
7. Building address: 535 Cedar Ave.
8. Owner name and address: Birl W Worley
535 Cedar Ave Grand Junction, CO 81501-7427

II. Geographic Information

9. P.M. Ute Principal Meridian Township 1 South Range 1 West
NW 1/4 of NE 1/4 of SE 1/4 of NW 1/4 of section 11
10. UTM reference
Zone 1 2 ; 7 1 0 7 0 7 mE 4 3 2 9 2 8 0 mN
11. USGS quad name: Grand Junction Quadrangle
Year: 1962 rev. 1973 Map scale: 7.5' X 15' *Attach photo copy of appropriate map section.*
12. Lot(s): 7 Block: 5
Addition: Bookcliff Park Year of Addition: 1946
13. Boundary Description and Justification: Legal description of the site is: Lot 7 Blk 5
Bookcliff Park
Assessors Office Parcel ID # 2945-112-03-007
This description was chosen as the most specific and customary description of the site.

III. Architectural Description

14. Building plan (footprint, shape): L-Shaped Plan
15. Dimensions in feet: Length 40' x Width 55'
16. Number of stories: 1
17. Primary external wall material(s) (enter no more than two): Brick
18. Roof configuration: (enter no more than one): Side Gabled Roof
19. Primary external roof material (enter no more than one): Asphalt Roof
20. Special features (enter all that apply): Carport

Resource Number: 5ME.14751
Temporary Resource Number: 535.CED

Architectural Inventory Form
(page 2 of 4)

21. General architectural description: This is a simple primarily rectangular wood frame house with an addition on the rear. The main ridge line runs generally east/west and the principal façade faces north. The main entry sits on the right side of the main wall. A very large picture window is centered on the wall to the left between the door and a double hung window further to the left. A pair of double hungs sit on the far corner. The carport sits on the right side of the main form with a slightly lower side gable roof. The edge of the side gable is supported by three pipe columns and an additional carport space sits under a shed roof addition on the west side. The addition extends off the rear of the west side. A series of concrete steps run to a landing at the entry door and a planter extends the landing height to the left under the large window.
22. Architectural style/building type: Ranch Type
23. Landscaping or special setting features: Two street trees front the property and several large shrubs are located at the perimeter of the house. The driveway runs along the west side, otherwise the yard is predominantly lawn.
24. Associated buildings, features, or objects: none

IV. Architectural History

25. Date of Construction: Estimate: 1953 Actual: _____
Source of information: Mesa County Assessors Office
26. Architect: unknown
Source of information: _____
27. Builder/Contractor: unknown
Source of information: _____
28. Original owner: John D. Strobell, Jr.
Source of information: 1955 Polk Directory
29. Construction history (include description and dates of major additions, alterations, or demolitions): Addition on rear, addition of shed roof carport, window alterations; dates unknown.
30. Original location Moved _____ Date of move(s): _____

V. Historical Associations

31. Original use(s): Domestic, Single Dwelling
32. Intermediate use(s): _____
33. Current use(s): Domestic, Single Dwelling
34. Site type(s): Residential Neighborhood

Resource Number: 5ME.14751
Temporary Resource Number: 535.CED

Architectural Inventory Form
(page 3 of 4)

35. Historical background: Frank D. Strobell, Jr., is shown as owner in the directories of 1955 through 1957. This building is part of Bookcliff Park developed in 1946. The owners were Gertrude B. Smith, Claude D. Smith, later the U. S. Bank of Grand Junction, and Thomas L. Brownson, Mabel L. Brownson, Bruce Brownson and Mary F. Brownson.
36. Sources of information: Mesa County Assessors Office; Museum of Western Colorado Archives; Polk Directories 1955, 1956, 1957

VI. Significance

37. Local landmark designation: Yes No Date of designation: _____
Designating authority: _____

38. Applicable National Register Criteria:

- A. Associated with events that have made a significant contribution to the broad pattern of our history;
- B. Associated with the lives of persons significant in our past;
- C. Embodies the distinctive characteristics of a type, period, or method of construction, or represents the work of a master, or that possess high artistic values, or represents a significant and distinguishable entity whose components may lack individual distinction; or
- D. Has yielded, or may be likely to yield, information important in history or prehistory.
- Qualifies under Criteria Considerations A through G (see Manual)
- Does not meet any of the above National Register criteria

39. Area(s) of significance: Architecture, Community Development and Planning

40. Period of significance: 1953; 1943 to 1957 Uranium Boom

41. Level of significance: National State Local

42. Statement of significance: The development in this area is a direct result of the nation's involvement in WWII and the drive for the development of nuclear weapons. The discovery of significant sources of Uranium in the region initiated development in Grand Junction that supported both the mining of the materials and the administration of programs related to the development of weapons. The building types, materials and neighborhood layout are all indicative of the national trends which were driven by the proliferation of the automobile and the enormous demand for single family homes. House designs departed from the romantic and revival styles that were prevalent in the earlier part of the 20th century and took on a California inspired design that was characterized by simple horizontally proportioned forms. Houses were typically mass produced on previously undeveloped tracts of land at the periphery of earlier development. These groups of houses were typically based on one or two plan types

Resource Number: 5ME.14751
Temporary Resource Number: 535.CED

Architectural Inventory Form
(page 4 of 4)

with a limited number of roof and exterior finish variations, further reinforcing the characteristics of mass production. In this particular subdivision there are examples of both repetitive house types and more high style individualized houses. The curvilinear street layout is characteristic of national planning trends and is unusual in this community, where new development tended to extend the existing street grid.

43. Assessment of historic physical integrity related to significance: Alterations have had a moderate impact on the integrity. The house continues to contribute to the character of the neighborhood.

VII. National Register Eligibility Assessment

44. National Register eligibility field assessment:

Eligible Not Eligible Need Data

45. Is there National Register district potential? Yes No

Discuss: The Bookcliff Park Subdivision lies on the periphery of the historic city center and was originally established by single group of investors. The sites were built out to accommodate the rapid growth associated with the Uranium Boom over a short period of time. The architectural styles present in the area represent a significant concentration and continuity of dwellings and a subtle transition of styles over the building period. Few intrusions have been made into the original neighborhood and it retains a high level of integrity.

If there is National Register district potential, is this building: Contributing
Noncontributing

46. If the building is in existing National Register district, is it: Contributing
Noncontributing

VIII. Recording Information

47. Photograph numbers: Roll # 8 Frame # 1 see also digital image 535.CED
Negatives filed at: City of Grand Junction Planning Dept.
48. Report title: Grand Junction Phase 3 Survey 49. Date(s): March 2005
50. Recorder(s): Suzannah Reid, Patrick Duffield and Lydia Herron
51. Organization: Reid Architects, Inc.
52. Address: PO Box 1303 Aspen, Colorado 81612
53. Phone number(s): 970 920 9225

NOTE: Please attach a sketch map, a photocopy of the USGS quad. map indicating resource location, and photographs.

Colorado Historical Society - Office of Archaeology & Historic Preservation
1300 Broadway, Denver, CO 80203 (303) 866-3395

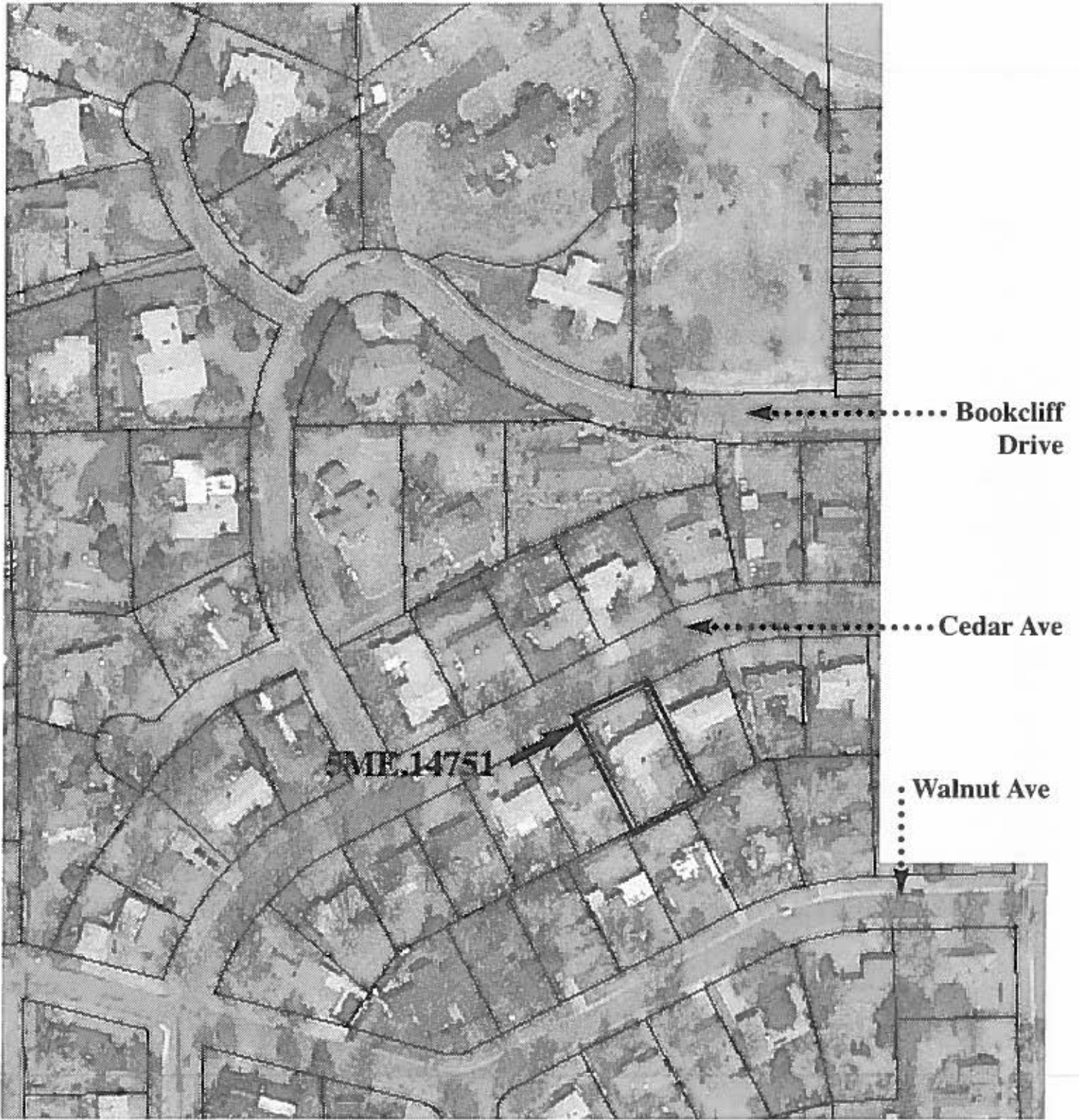

535 Cedar Ave.



North

Grand Junction, Colorado
image from 2002 aerial map

City of Grand Junction • Phase Three Survey
2004

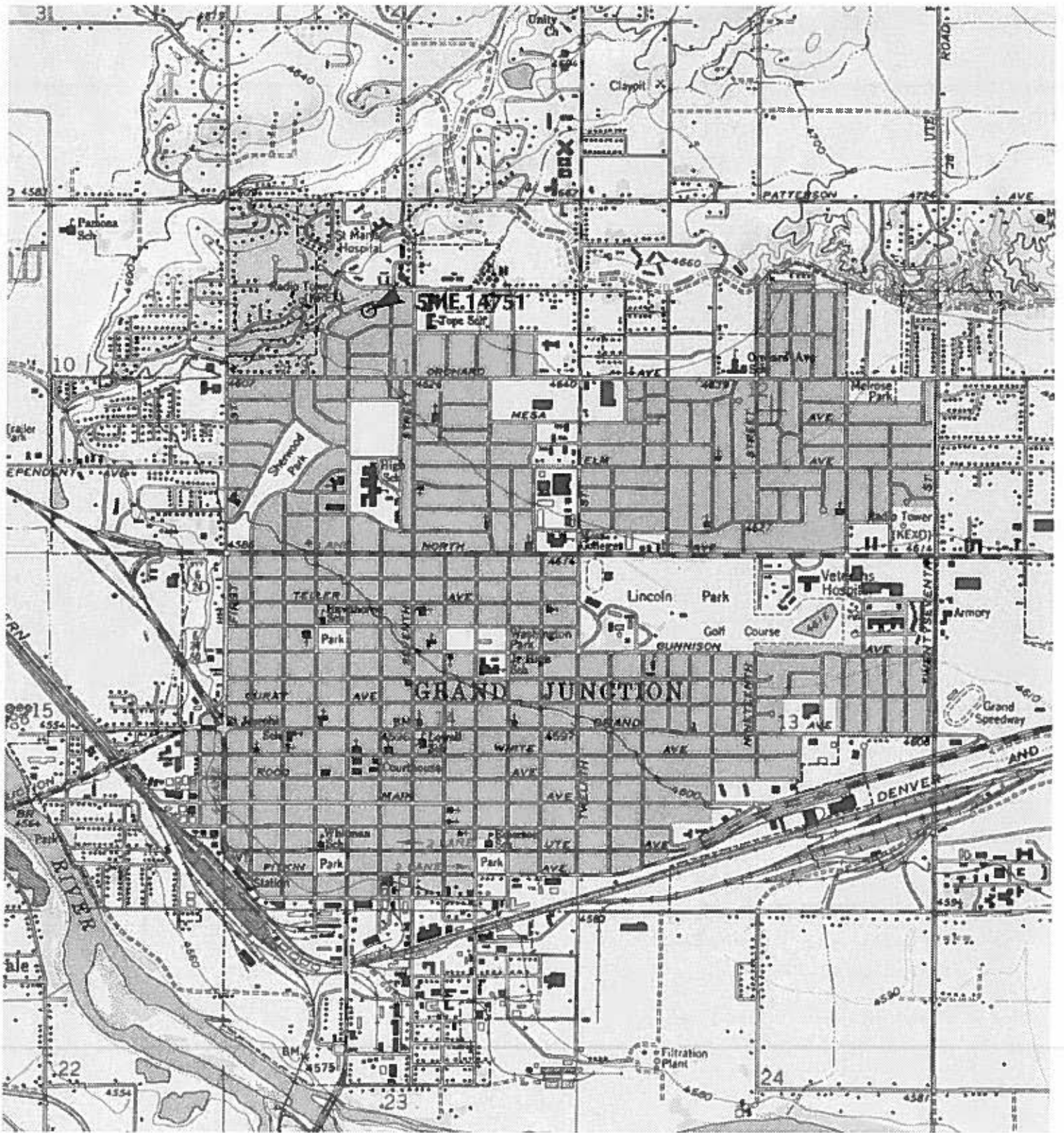

TN MN
11 1/4°

0 5 1 MILE
0 1000 FEET 0 500 1000 METERS
Map created with TOPOID ©2003 National Geographic (www.nationalgeographic.com/topo)

GRAND JUNCTION, COLORADO
Phase Three Historic Survey
2004



5ME.14751

535 Cedar Ave.

Roll # 8 Frame # 1

Looking southeast

Grand Junction, Mesa County, CO

WHF BA010A1X0N NNN- 1 5881 002926

003

sharp

57862

5ME.14751

535 Cedar Ave.

Digital Frame # 535.CED

Looking southeast

Grand Junction, Mesa County, CO

f. A1356, 05/02/05

BBP0966, 535CE_80_0024