

OAHP1403  
Rev. 9/98

COLORADO CULTURAL RESOURCE SURVEY

# Architectural Inventory Form

1 of 4

Official eligibility determination  
(OAHP use only)

Date \_\_\_\_\_ Initials \_\_\_\_\_

- Determined Eligible- NR  
 Determined Not Eligible- NR  
 Determined Eligible- SR  
 Determined Not Eligible- SR  
 Need Data  
 Contributes to eligible NR District  
 Noncontributing to eligible NR District

## I. Identification

1. Resource number: 5ME.14733
2. Temporary resource number: 2001.SEV
3. County: Mesa
4. City: Grand Junction
5. Historic building name: n/a
6. Current building name: n/a
7. Building address: 2001 N. 7th Street
8. Owner name and address: Travis B Lancaster  
2001 N 7th St Grand Junction, CO 81501-7419

## II. Geographic Information

9. P.M. Ute Principal Meridian Township 1 South Range 1 West  
SW 1/4 of SW 1/4 of SW 1/4 of NE 1/4 of section 11
10. UTM reference  
Zone 1 2 ; 7 1 0 9 2 7 mE 4 3 2 9 1 0 4 mN
11. USGS quad name: Grand Junction Quadrangle  
Year: 1962 rev. 1973 Map scale: 7.5' X 15' *Attach photo copy of appropriate map section.*
12. Lot(s): 15 Block: 8  
Addition: Bookcliff Park Year of Addition: 1946
13. Boundary Description and Justification: Legal description of the site is: Lot 15 Blk 8  
Bookcliff Park  
Assessors Office Parcel ID # 2945-111-05-006  
This description was chosen as the most specific and customary description of the site.

## III. Architectural Description

14. Building plan (footprint, shape): Rectangular Plan
15. Dimensions in feet: Length 27' x Width 46'
16. Number of stories: 1
17. Primary external wall material(s) (enter no more than two): Asphalt Siding
18. Roof configuration: (enter no more than one): Side Gabled Roof
19. Primary external roof material (enter no more than one): Asphalt Roof
20. Special features (enter all that apply): Attached Garage, Chimney

Resource Number: 5ME.14733  
Temporary Resource Number: 2001.SEV

**Architectural Inventory Form**  
(page 2 of 4)

21. General architectural description: This is a very simple wood frame, side gabled house. The ridge runs north/south and the main façade faces east. The north end of the house has a single car garage door on the end, which shares a shallow recessed area with the main entry door to its left. The roof line remains constant over the recess, creating a slightly deeper overhang at the doors. On the center of the main wall sits a large picture window that is flanked by double hungs. A single double hung is centered on the remaining wall to the south. A low pitched shed roof addition extends off the rear. And the sides have minimal openings. The double hung windows have a single horizontal muntin in each sash. The gable ends have vertical siding above the eave line and a low brick chimney is located on the rear slope of the roof.
22. Architectural style/building type: Ranch Type
23. Landscaping or special setting features: The house has several shrubs along the perimeter and some large trees in close proximity. The driveway runs to the garage on the north side; otherwise the yard is predominantly lawn.
24. Associated buildings, features, or objects: none seen

**IV. Architectural History**

25. Date of Construction: Estimate: 1950 Actual: \_\_\_\_\_  
Source of information: Mesa County Assessors Office
26. Architect: unknown  
Source of information: \_\_\_\_\_
27. Builder/Contractor: unknown  
Source of information: \_\_\_\_\_
28. Original owner: Harold H. Hill  
Source of information: 1951 Polk Directory
29. Construction history (include description and dates of major additions, alterations, or demolitions): Siding replaced, additions on rear; dates unknown.
30. Original location  Moved \_\_\_\_\_ Date of move(s): \_\_\_\_\_

**V. Historical Associations**

31. Original use(s): Domestic, Single Dwelling
32. Intermediate use(s): \_\_\_\_\_
33. Current use(s): Domestic, Single Dwelling
34. Site type(s): Residential Neighborhood

Resource Number: 5ME.14733  
Temporary Resource Number: 2001.SEV

**Architectural Inventory Form**  
(page 3 of 4)

35. Historical background: Harold H. Hill is shown as owner in the 1951 directory. Welsey J. Williams is shown as owner in the directories of 1955 through 1957. This building is part of Bookcliff Park developed in 1946. The owners were Gertrude B. Smith, Claude D. Smith, later the U. S. Bank of Grand Junction, and Thomas L. Brownson, Mabel L. Brownson, Bruce Brownson and Mary F. Brownson.
36. Sources of information: Mesa County Assessors Office; Museum of Western Colorado Archives; Polk Directories 1951, 1955, 1956, 1957

**VI. Significance**

37. Local landmark designation: Yes  No  Date of designation: \_\_\_\_\_  
Designating authority: \_\_\_\_\_

38. Applicable National Register Criteria:

- A. Associated with events that have made a significant contribution to the broad pattern of our history;
- B. Associated with the lives of persons significant in our past;
- C. Embodies the distinctive characteristics of a type, period, or method of construction, or represents the work of a master, or that possess high artistic values, or represents a significant and distinguishable entity whose components may lack individual distinction; or
- D. Has yielded, or may be likely to yield, information important in history or prehistory.
- Qualifies under Criteria Considerations A through G (see Manual)
- Does not meet any of the above National Register criteria

39. Area(s) of significance: Architecture, Community Development and Planning

40. Period of significance: 1950; 1943 to 1957 Uranium Boom

41. Level of significance: National  State  Local

42. Statement of significance: The development in this area is a direct result of the nation's involvement in WWII and the drive for the development of nuclear weapons. The discovery of significant sources of Uranium in the region initiated development in Grand Junction that supported both the mining of the materials and the administration of programs related to the development of weapons. The building types, materials and neighborhood layout are all indicative of the national trends which were driven by the proliferation of the automobile and the enormous demand for single family homes. House designs departed from the romantic and revival styles that were prevalent in the earlier part of the 20th century and took on a California inspired design that was characterized by simple horizontally proportioned forms. Houses were typically mass produced on previously undeveloped tracts of land at the periphery of earlier

Resource Number: 5ME.14733  
Temporary Resource Number: 2001.SEV

**Architectural Inventory Form**  
(page 4 of 4)

development. These groups of houses were typically based on one or two plan types with a limited number of roof and exterior finish variations, further reinforcing the characteristics of mass production. In this particular subdivision there are examples of both repetitive house types and more high style individualized houses. The curvilinear street layout is characteristic of national planning trends and is unusual in this community, where new development tended to extend the existing street grid.

43. Assessment of historic physical integrity related to significance: Alterations have had a minor impact on the integrity. The house continues to contribute to the character of the neighborhood.

**VII. National Register Eligibility Assessment**

44. National Register eligibility field assessment:

Eligible  Not Eligible  Need Data

45. Is there National Register district potential? Yes  No

Discuss: The Bookcliff Park Subdivision lies on the periphery of the historic city center and was originally established by single group of investors. The sites were built out to accommodate the rapid growth associated with the Uranium Boom over a short period of time. The architectural styles present in the area represent a significant concentration and continuity of dwellings and a subtle transition of styles over the building period. Few intrusions have been made into the original neighborhood and it retains a high level of integrity.

If there is National Register district potential, is this building: Contributing

Noncontributing

46. If the building is in existing National Register district, is it: Contributing

Noncontributing

**VIII. Recording Information**

47. Photograph numbers: Roll # 10 Frame # 5

Negatives filed at: City of Grand Junction Planning Dept.

48. Report title: Grand Junction Phase 3 Survey 49. Date(s): March 2005

50. Recorder(s): Suzannah Reid, Patrick Duffield and Lydia Herron

51. Organization: Reid Architects, Inc.

52. Address: PO Box 1303 Aspen, Colorado 81612

53. Phone number(s): 970 920 9225

*NOTE: Please attach a sketch map, a photocopy of the USGS quad. map indicating resource location, and photographs.*

Colorado Historical Society - Office of Archaeology & Historic Preservation

1300 Broadway, Denver, CO 80203 (303) 866-3395



TN \* MN  
11 1/2°



Map created with TOPO!® ©2003 National Geographic ([www.nationalgeographic.com/topo](http://www.nationalgeographic.com/topo))

# GRAND JUNCTION, COLORADO

*Phase Three Historic Survey*

2004

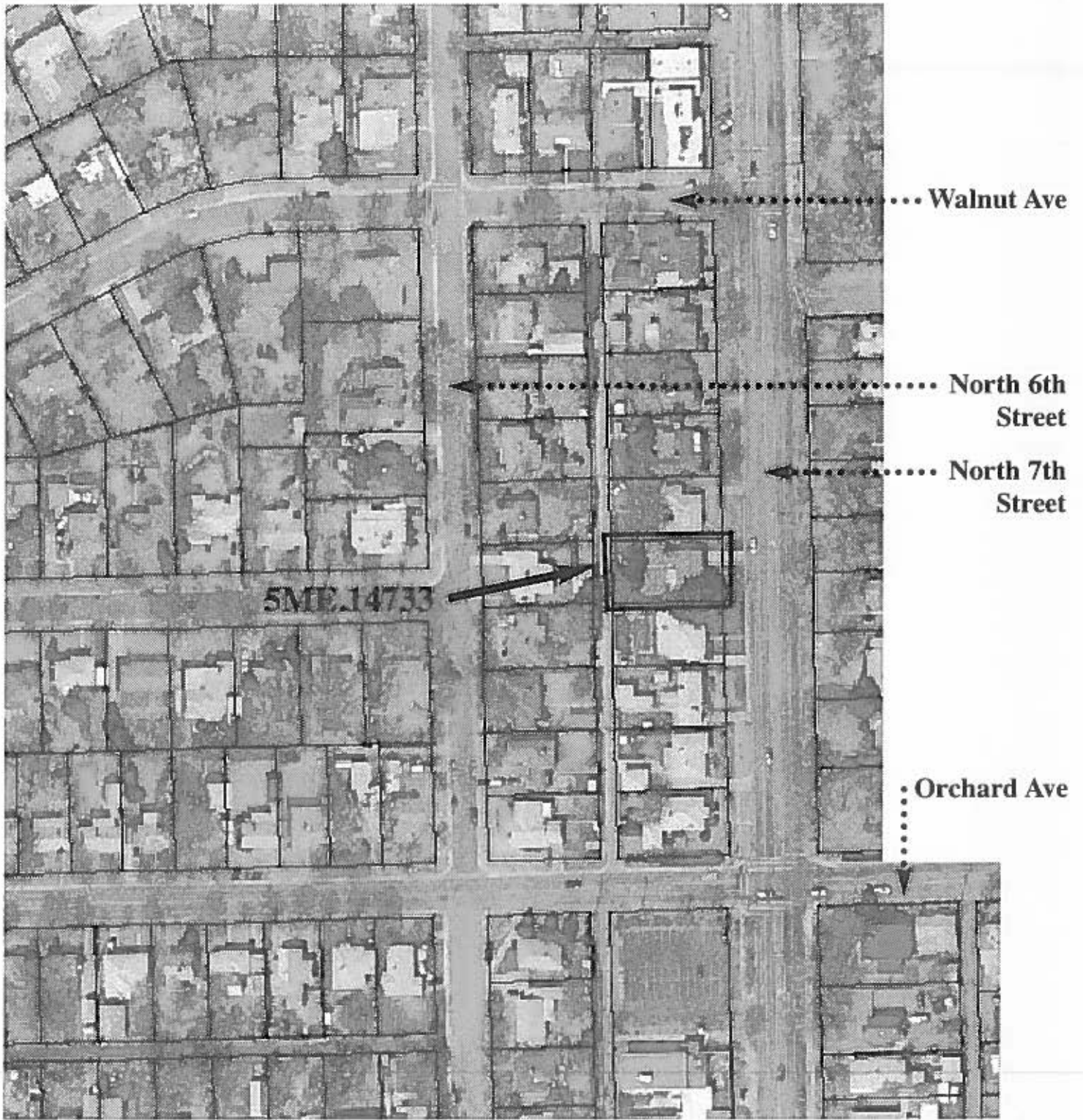

# 2001 N. 7th Street



North

Grand Junction, Colorado  
*image from 2002 aerial map*

City of Grand Junction • Phase Three Survey  
2004

5ME.14733

2001 N. 7th Street

Roll # 10 Frame # 5

Looking southwest

Grand Junction, Mesa County, CO

WHF BA010A1X0N NNN 0 5649 002912

006

share

54620

