

COLORADO CULTURAL RESOURCE SURVEY

**Architectural Inventory
Form**

1 of 4

Official eligibility determination
(OAHP use only)

Date _____ Initials _____

- Determined Eligible- NR
- Determined Not Eligible- NR
- Determined Eligible- SR
- Determined Not Eligible- SR
- Need Data
- Contributes to eligible NR District
- Noncontributing to eligible NR District

I. Identification

1. Resource number: 5ME.14770
2. Temporary resource number: 546.ORB
3. County: Mesa
4. City: Grand Junction
5. Historic building name: n/a
6. Current building name: n/a
7. Building address: 546 Orchard Ave.
8. Owner name and address: Stacey L Robinson
546 Orchard Ave Grand Junction, CO 81501-2162

II. Geographic Information

9. P.M. Ute Principal Meridian Township 1 South Range 1 West
SW 1/4 of SE 1/4 of SE 1/4 of NW 1/4 of section 11
10. UTM reference
Zone 1 2 ; 7 1 0 7 6 0 mE 4 3 2 9 0 1 5 mN
11. USGS quad name: Grand Junction Quadrangle
Year: 1962 rev.1973 Map scale: 7.5' X 15' *Attach photo copy of appropriate map section.*
12. Lot(s): 13 Block: 7
Addition: Bookcliff Park Year of Addition: 1946
13. Boundary Description and Justification: Legal description of the site is: Lot 13 Blk 7
Bookcliff Park
Assessors Office Parcel ID # 2945-112-06-013
This description was chosen as the most specific and customary description of the site.

III. Architectural Description

14. Building plan (footprint, shape): Rectangular Plan
15. Dimensions in feet: Length 27' x Width 27'
16. Number of stories: 1
17. Primary external wall material(s) (enter no more than two): Wood Shingle
18. Roof configuration: (enter no more than one): Hipped Roof
19. Primary external roof material (enter no more than one): Asphalt Roof
20. Special features (enter all that apply): Car port

Resource Number: 5ME.14770
Temporary Resource Number: 546.ORB

Architectural Inventory Form
(page 2 of 4)

21. General architectural description: This is a simple wood frame house with a low pitched hipped roof. The main hipped roof form has a short ridge that runs east/west and the principal façade faces south. A lower hipped roof form projects from the west side and runs over half the width of the façade. A small double hung window sits on the face of the projecting volume, centered between the west corner and a deep recess at the right. The main entry is set in the narrow recess and the main wall plane continues for a short distance on the far side of the door. A large picture window is located on the wall of the main volume. The picture unit is flanked by narrow double hungs to each side. The flat roofed carport extends off the east side, continuing the eave line of the main hipped roof. The flat roof is supported by four thin columns on the east side. Two double hungs sit on the east wall near the center below the carport roof. The west wall has two double hungs evenly spaced along the length of the wall. A shed roof extends off the rear of the house.
22. Architectural style/building type: Ranch Type
23. Landscaping or special setting features: Two large street trees sit along the front of the lot and the driveway runs to the carport on the east. Several shrubs run along the property line, otherwise the yard is predominantly lawn.
24. Associated buildings, features, or objects: A large front gable garage is located at the rear of the carport.

IV. Architectural History

25. Date of Construction: Estimate: 1950 Actual: _____
Source of information: Mesa County Assessors Office
26. Architect: unknown
Source of information: _____
27. Builder/Contractor: unknown
Source of information: _____
28. Original owner: Willard P. Taylor
Source of information: 1951 Polk Directory
29. Construction history (include description and dates of major additions, alterations, or demolitions): Siding replaced, possible window replacement, possible addition on rear; dates unknown.
30. Original location Moved _____ Date of move(s): _____

V. Historical Associations

31. Original use(s): Domestic, Single Dwelling
32. Intermediate use(s): _____
33. Current use(s): Domestic, Single Dwelling

Resource Number: 5ME.14770
Temporary Resource Number: 546.ORB

Architectural Inventory Form
(page 3 of 4)

34. Site type(s): Residential Neighborhood
35. Historical background: Willard P. Taylor is shown as owner in the directories of 1951 through 1957. This building is part of Bookcliff Park developed in 1946. The owners were Gertrude B. Smith, Claude D. Smith, later the U. S. Bank of Grand Junction, and Thomas L. Brownson, Mabel L. Brownson, Bruce Brownson and Mary F. Brownson.
36. Sources of information: Mesa County Assessors Office; Museum of Western Colorado Archives; Polk Directories 1951, 1955, 1956, 1957

VI. Significance

37. Local landmark designation: Yes No Date of designation: _____
Designating authority: _____

38. Applicable National Register Criteria:

- A. Associated with events that have made a significant contribution to the broad pattern of our history;
- B. Associated with the lives of persons significant in our past;
- C. Embodies the distinctive characteristics of a type, period, or method of construction, or represents the work of a master, or that possess high artistic values, or represents a significant and distinguishable entity whose components may lack individual distinction; or
- D. Has yielded, or may be likely to yield, information important in history or prehistory.
- Qualifies under Criteria Considerations A through G (see Manual)
- Does not meet any of the above National Register criteria

39. Area(s) of significance: Architecture, Community Development and Planning

40. Period of significance: 1950; 1943 to 1957 Uranium Boom

41. Level of significance: National State Local

42. Statement of significance: The development in this area is a direct result of the nation's involvement in WWII and the drive for the development of nuclear weapons. The discovery of significant sources of Uranium in the region initiated development in Grand Junction that supported both the mining of the materials and the administration of programs related to the development of weapons. The building types, materials and neighborhood layout are all indicative of the national trends which were driven by the proliferation of the automobile and the enormous demand for single family homes. House designs departed from the romantic and revival styles that were prevalent in the earlier part of the 20th century and took on a California inspired design that was characterized by simple horizontally proportioned forms. Houses were typically mass produced on previously undeveloped tracts of land at the periphery of earlier

Resource Number: 5ME.14770
Temporary Resource Number: 546.ORB

Architectural Inventory Form
(page 4 of 4)

development. These groups of houses were typically based on one or two plan types with a limited number of roof and exterior finish variations, further reinforcing the characteristics of mass production. In this particular subdivision there are examples of both repetitive house types and more high style individualized houses. The curvilinear street layout is characteristic of national planning trends and is unusual in this community, where new development tended to extend the existing street grid.

43. Assessment of historic physical integrity related to significance: Alterations have somewhat impacted the integrity of the house. Siding and window replacement are in keeping with the original character. The house continues to contribute to the character of the neighborhood.

VII. National Register Eligibility Assessment

44. National Register eligibility field assessment:

Eligible Not Eligible Need Data

45. Is there National Register district potential? Yes No

Discuss: The Bookcliff Park Subdivision lies on the periphery of the historic city center and was originally established by single group of investors. The sites were built out to accommodate the rapid growth associated with the Uranium Boom over a short period of time. The architectural styles present in the area represent a significant concentration and continuity of dwellings and a subtle transition of styles over the building period. Few intrusions have been made into the original neighborhood and it retains a high level of integrity.

If there is National Register district potential, is this building: Contributing
Noncontributing

46. If the building is in existing National Register district, is it: Contributing
Noncontributing

VIII. Recording Information

47. Photograph numbers: Roll # 10 Frame # 24

Negatives filed at: City of Grand Junction Planning Dept.

48. Report title: Grand Junction Phase 3 Survey 49. Date(s): March 2005

50. Recorder(s): Suzannah Reid, Patrick Duffield and Lydia Herron

51. Organization: Reid Architects, Inc.

52. Address: PO Box 1303 Aspen, Colorado 81612

53. Phone number(s): 970 920 9225

NOTE: Please attach a sketch map, a photocopy of the USGS quad. map indicating resource location, and photographs.

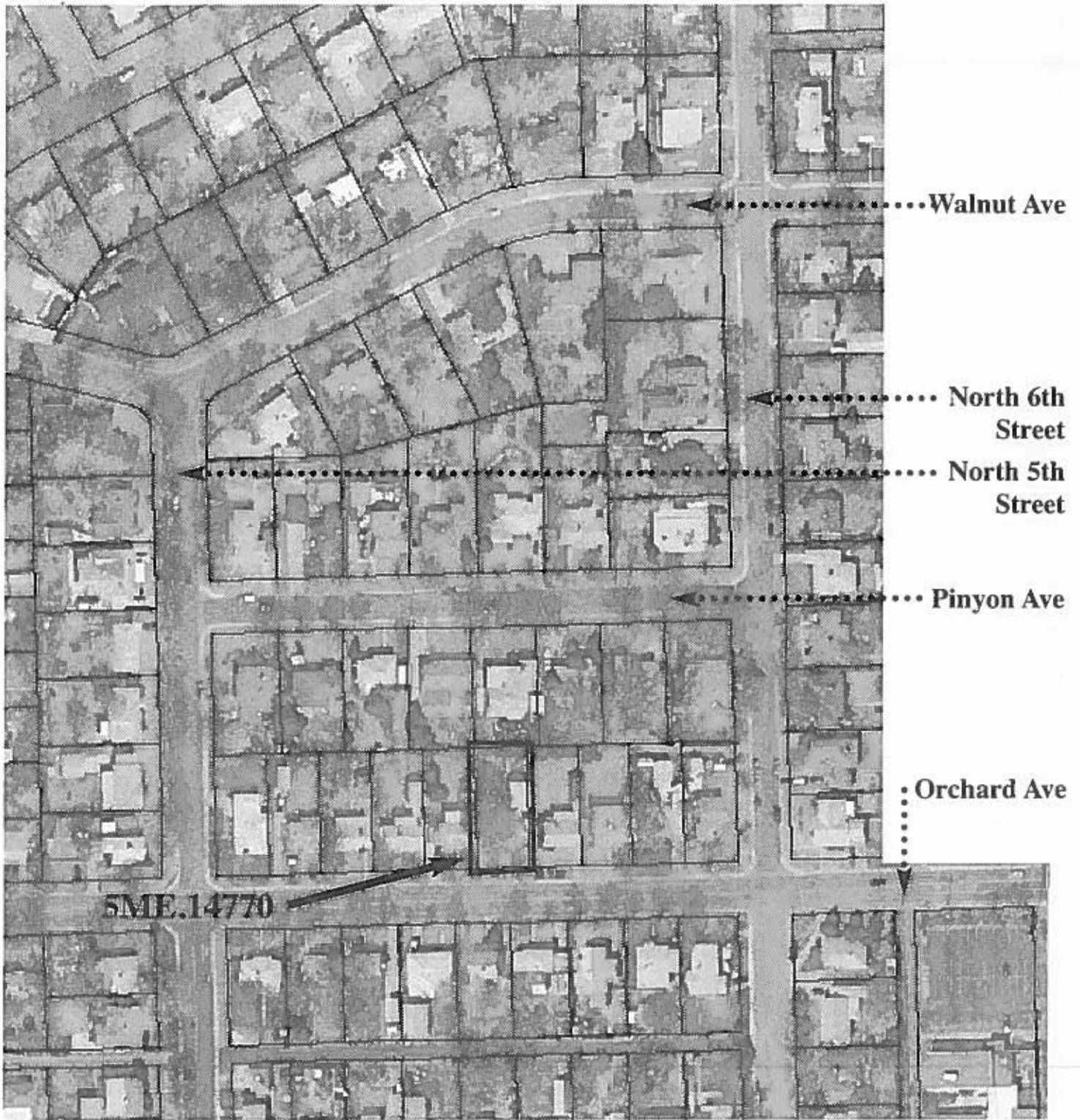

546 Orchard Ave.



North

Grand Junction, Colorado
image from 2002 aerial map

City of Grand Junction • Phase Three Survey
2004

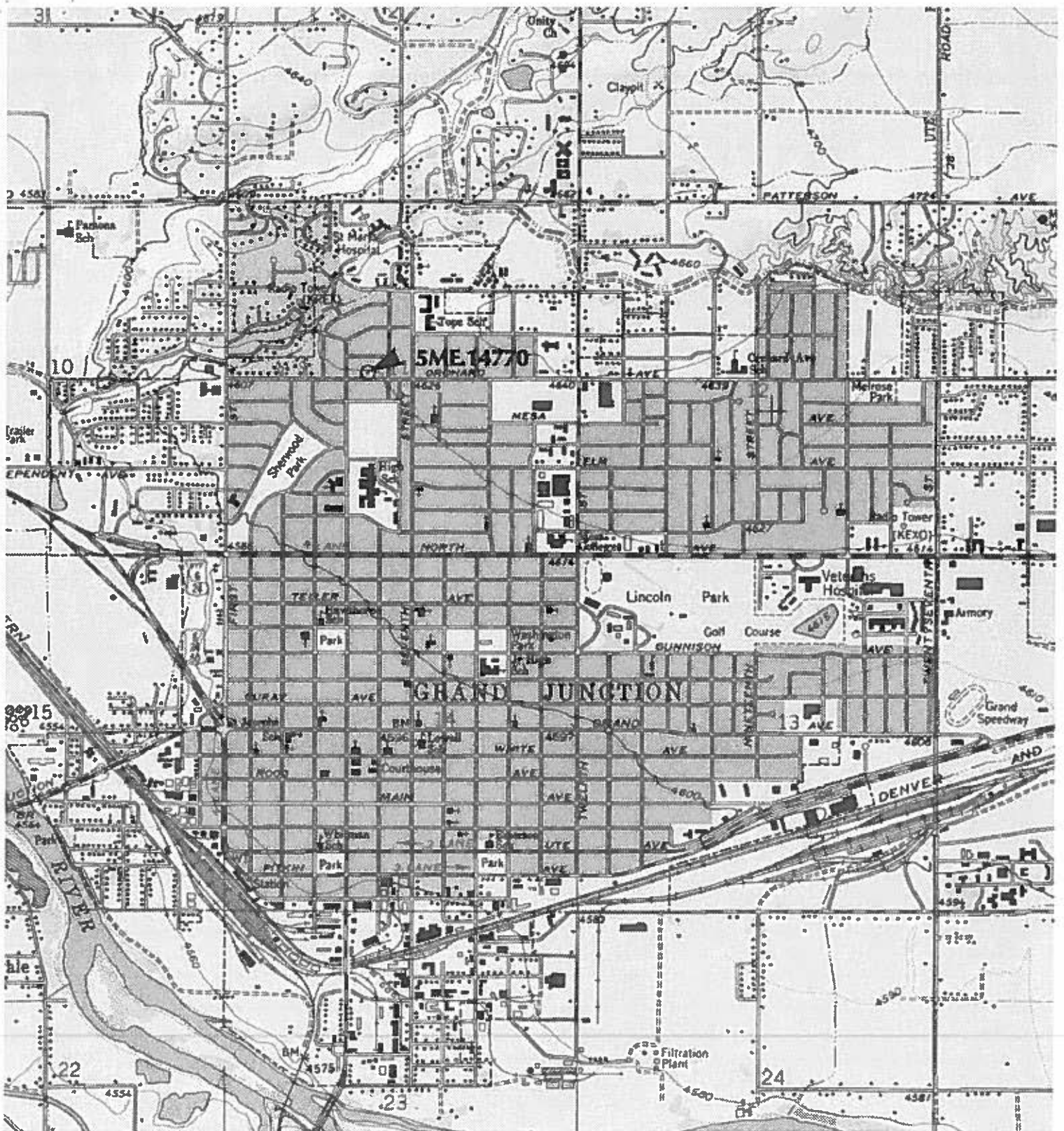

TN \uparrow MN
11 1/2°



Map created with TOPO!® ©2003 National Geographic (www.nationalgeographic.com/topo)

GRAND JUNCTION, COLORADO

Phase Three Historic Survey

2004



5ME.14770

546 Orchard Ave.

Roll # 10 Frame # 24

Looking southeast

Grand Junction, Mesa County, CO

WHF BA010A1X0N NNN+ 1 5649 002912

025

sharp

54639