

Architectural Inventory Form

Official eligibility determination (OAHP use only)

Date _____ Initials _____

- Determined Eligible- NR
- Determined Not Eligible- NR
- Determined Eligible- SR
- Determined Not Eligible- SR
- Need Data
- Contributes to eligible NR District
- Noncontributing to eligible NR District

I. Identification

1. Resource number: 5ME.14713
2. Temporary resource number: 2035.FOR
3. County: Mesa
4. City: Grand Junction
5. Historic building name: n/a
6. Current building name: n/a
7. Building address: 2035 N. 4th Street
8. Owner name and address: Lori A Engle
2035 N 4th St Grand Junction, CO 81501-7403

II. Geographic Information

9. P.M. Ute Principal Meridian Township 1 South Range 1 West
NW 1/4 of SW 1/4 of SE 1/4 of NW 1/4 of section 11
10. UTM reference
Zone 1 2 ; 7 1 0 5 2 9 mE 4 3 2 9 1 5 6 mN
11. USGS quad name: Grand Junction Quadrangle
Year: 1962 rev.1973 Map scale: 7.5' X 15' *Attach photo copy of appropriate map section.*
12. Lot(s): 2 Block: 3
Addition: Bookcliff Park Year of Addition: 1946
13. Boundary Description and Justification: Legal description of the site is: Lot 2 Blk 3
Bookcliff Park
Assessors Office Parcel ID # 2945-112-09-002
This description was chosen as the most specific and customary description of the site.

III. Architectural Description

14. Building plan (footprint, shape): Rectangular Plan
15. Dimensions in feet: Length 33' x Width 44'
16. Number of stories: 1
17. Primary external wall material(s) (enter no more than two): Aluminum
18. Roof configuration: (enter no more than one): Side Gabled Roof
19. Primary external roof material (enter no more than one): Asphalt Roof
20. Special features (enter all that apply): none

Resource Number: 5ME.14713
Temporary Resource Number: 2035.FOR

Architectural Inventory Form
(page 2 of 4)

21. General architectural description: This is a simple rectangular wood frame house with additions. The ridge runs north/south and the principal façade faces east. The roof has a moderate overhang on all sides, and an extended overhang for a portion of the main façade. The extension begins at the right of the entry door, which is off center to the right on the main wall. The extension continues over the principal window to the south end of the house. The wall under the extended overhang has a brick veneer surface. The principal window has a large picture unit in the center and a vertically proportioned casement unit on either side. A pair of double hungs are centered on the remaining wall to the north. The south wall has a pair of double hungs near the front and a low pitched shed addition that extends beyond the rear wall of the house to the west. The house sits on a concrete foundation with basement windows at the perimeter. A set of concrete steps front the entry door.
22. Architectural style/building type: Ranch Type
23. Landscaping or special setting features: A gravel parking area is located on the south and a couple of street trees sit on the front, otherwise the yard is predominantly lawn.
24. Associated buildings, features, or objects: none

IV. Architectural History

25. Date of Construction: Estimate: 1952 Actual: _____
Source of information: Mesa County Assessors Office
26. Architect: unknown
Source of information: _____
27. Builder/Contractor: unknown
Source of information: _____
28. Original owner: unknown
Source of information: _____
29. Construction history (include description and dates of major additions, alterations, or demolitions): Shed roof addition, possible window alterations, siding alterations; dates unknown.
30. Original location Moved Date of move(s): _____

V. Historical Associations

31. Original use(s): Domestic, Single Dwelling
32. Intermediate use(s): _____
33. Current use(s): Domestic, Single Dwelling
34. Site type(s): Residential Neighborhood

Resource Number: 5ME.14713
Temporary Resource Number: 2035.FOR

Architectural Inventory Form
(page 3 of 4)

35. Historical background: Wesley K. Carhartt is shown as owner in the directories of 1955 through 1957. 1955 is the first instance of this address in the available directories. This building is part of Bookcliff Park developed in 1946. The owners were Gertrude B. Smith, Claude D. Smith later the U. S. Bank of Grand Junction, and Thomas L. Brownson, Mabel L. Brownson, Bruce Brownson and Mary F. Brownson.
36. Sources of information: Mesa County Assessors Office; Museum of Western Colorado Archives; Polk Directories 1955, 1956, 1957

VI. Significance

37. Local landmark designation: Yes No Date of designation: _____
Designating authority: _____
38. Applicable National Register Criteria:
 A. Associated with events that have made a significant contribution to the broad pattern of our history;
 B. Associated with the lives of persons significant in our past;
 C. Embodies the distinctive characteristics of a type, period, or method of construction, or represents the work of a master, or that possess high artistic values, or represents a significant and distinguishable entity whose components may lack individual distinction; or
 D. Has yielded, or may be likely to yield, information important in history or prehistory.
 Qualifies under Criteria Considerations A through G (see Manual)
 Does not meet any of the above National Register criteria
39. Area(s) of significance: Architecture, Community Development and Planning
40. Period of significance: 1952; 1943 to 1957 Uranium Boom
41. Level of significance: National State Local
42. Statement of significance: The development in this area is a direct result of the nation's involvement in WWII and the drive for the development of nuclear weapons. The discovery of significant sources of Uranium in the region initiated development in Grand Junction that supported both the mining of the materials and the administration of programs related to the development of weapons. The building types, materials and neighborhood layout are all indicative of the national trends which were driven by the proliferation of the automobile and the enormous demand for single family homes. House designs departed from the romantic and revival styles that were prevalent in the earlier part of the 20th century and took on a California inspired design that was characterized by simple horizontally proportioned forms. Houses were typically mass produced on previously undeveloped tracts of land at the periphery of earlier

Resource Number: 5ME.14713
Temporary Resource Number: 2035.FOR

Architectural Inventory Form
(page 4 of 4)

development. These groups of houses were typically based on one or two plan types with a limited number of roof and exterior finish variations, further reinforcing the characteristics of mass production. In this particular subdivision there are examples of both repetitive house types and more high style individualized houses. The curvilinear street layout is characteristic of national planning trends and is unusual in this community, where new development tended to extend the existing street grid.

43. Assessment of historic physical integrity related to significance: Alterations have somewhat impacted the integrity of the house. The small addition to the side has a minor impact on the integrity and the siding alterations are consistent with the original character. The house continues to contribute to the character of the neighborhood.

VII. National Register Eligibility Assessment

44. National Register eligibility field assessment:

Eligible Not Eligible Need Data

45. Is there National Register district potential? Yes No

Discuss: The Bookcliff Park Subdivision lies on the periphery of the historic city center and was originally established by single group of investors. The sites were built out to accommodate the rapid growth associated with the Uranium Boom over a short period of time. The architectural styles present in the area represent a significant concentration and continuity of dwellings and a subtle transition of styles over the building period. Few intrusions have been made into the original neighborhood and it retains a high level of integrity.

If there is National Register district potential, is this building: Contributing
Noncontributing

46. If the building is in existing National Register district, is it: Contributing
Noncontributing

VIII. Recording Information

47. Photograph numbers: Roll # 6 Frame # 36

Negatives filed at: City of Grand Junction Planning Dept.

48. Report title: Grand Junction Phase 3 Survey 49. Date(s): March 2005

50. Recorder(s): Suzannah Reid, Patrick Duffield and Lydia Herron

51. Organization: Reid Architects, Inc.

52. Address: PO Box 1303 Aspen, Colorado 81612

53. Phone number(s): 970 920 9225

NOTE: Please attach a sketch map, a photocopy of the USGS quad. map indicating resource location, and photographs.

Colorado Historical Society - Office of Archaeology & Historic Preservation
1300 Broadway, Denver, CO 80203 (303) 866-3395

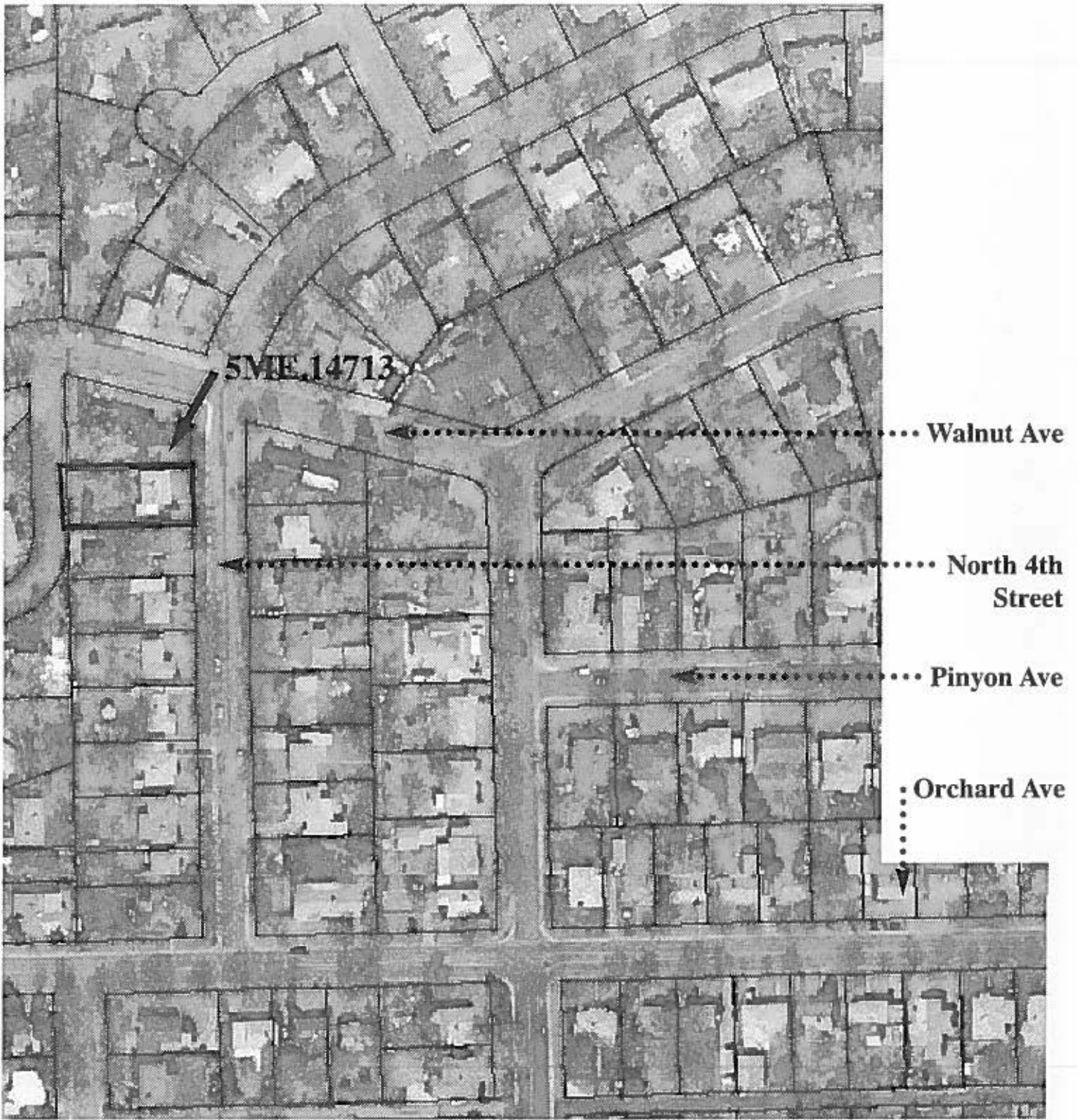

2035 N. 4th Street



North

Grand Junction, Colorado
image from 2002 aerial map

City of Grand Junction • Phase Three Survey
2004

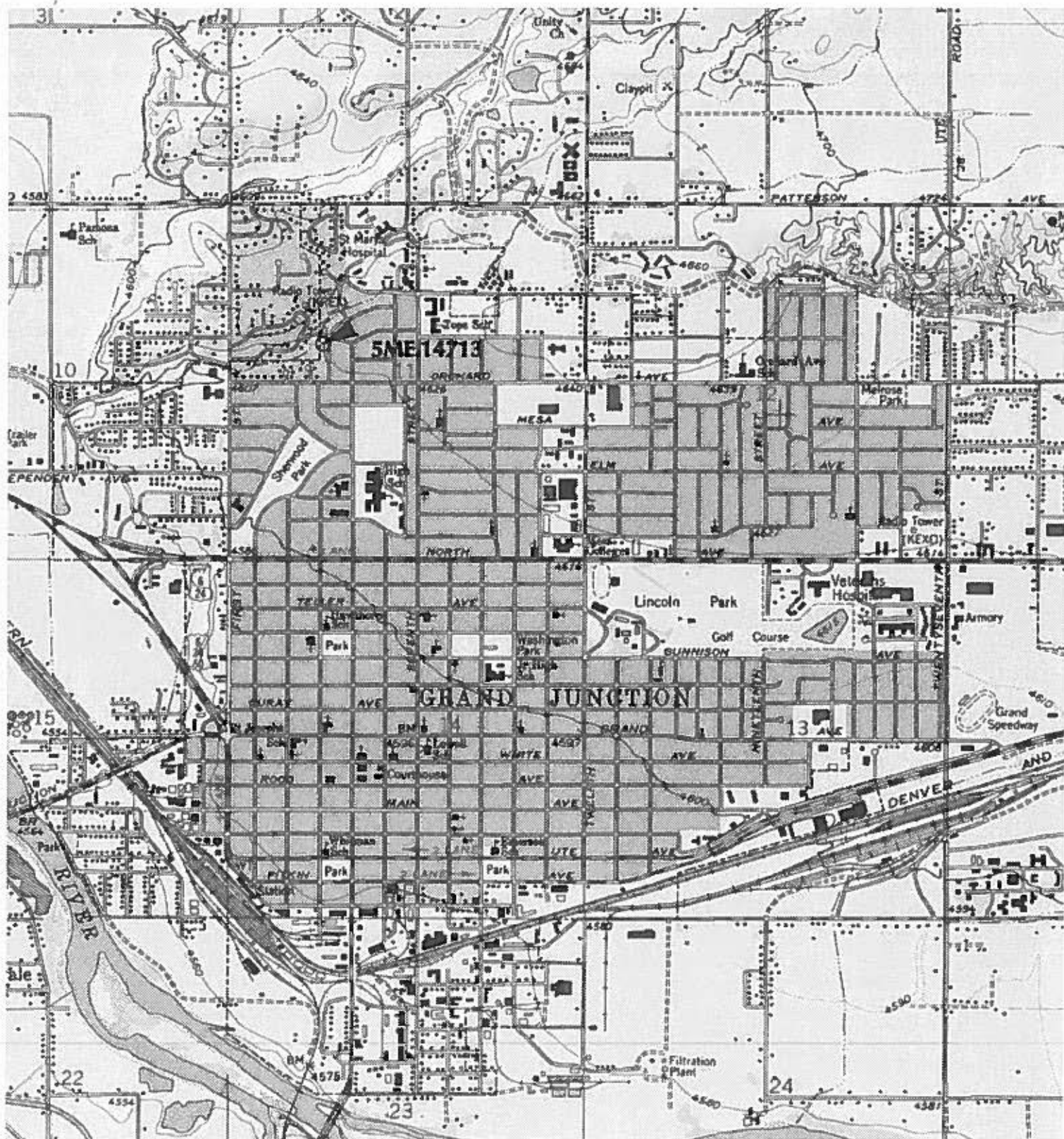

TN * MN
11 1/2"

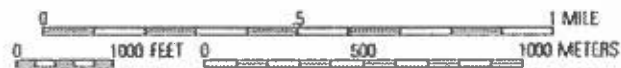

Map created with TOPO!® ©2003 National Geographic (www.nationalgeographic.com/topo)

GRAND JUNCTION, COLORADO

Phase Three Historic Survey

2004



5ME.14713

2035 N. 4th Street

Roll # 6 Frame # 36

Looking west

Grand Junction, Mesa County, CO

WHF BA010A1X0N NNN 0 5651 002914

037

sharp

54713