

COLORADO HISTORICAL SOCIETY
Office of Archaeology and Historic Preservation
1300 Broadway Denver, Colorado 80203

HISTORIC BUILDING INVENTORY RECORD

project name: Grand Junction Downtown Survey

county: Mesa city: Grand Junction

state ID no. SME 7105 temporary no.

current building name: Tompkins Cycles/Crystal Books & Gifts

address: 301/307 Main, Grand Junction, CO 81501

owner: Wilhelmetta Cortese, 1106 A West 36, Hays, KS 67601

township: 1S range: 1W section: 14, NW 1/4, SW 1/4

historic name:

USGS quad name: Grand Jct., CO 1962 N3900-W10830 X 7.5' 15'

district name:

block: 119 lot(s) 1, 2 addition: City

yr. of addition

film roll by: Marty Alexandroff no.

negative nos. 6943-4, 5854-23

location of negatives: City of Grand Junction

date of construction: _____ estimate 1905 actual

source: 1981 Historic Survey of City

use: commercial present commercial historic

condition: _____ excellent X good _____ fair _____ deteriorating

extent of alterations: _____ minor _____ moderate X major

describe: recessed entry with brick support posts; changed to two separate businesses; new facade including display windows, new windows on second level, signage, and painted brick

style: Commercial

stories: 2

X original moved date(s) of move: _____

materials: Brick (painted)

square footage: 12,500

National Register Eligibility:

Individual: yes X no

Contributing to district: yes X no

local landmark designation: _____ name _____ date _____

associated buildings? yes type: _____

if inventoried, list ID nos. _____

architectural description: Two story, commercial brick building with recessed entry and large display windows and brick kickplate. Separate glass door entrances to two separate businesses. Clerestory has been stuccoed and painted and displays signage. The second level has four large horizontal windows. The west side of the building has been stuccoed with decorative painted posts partially up the wall.

architect: unknown
source: _____

original owner: unknown
source: _____

builder/contractor: unknown
source: _____

theme(s): Plateau Country/commerical

construction history: (description, names, dates, etc. relating to major additions or alterations to original structure)
recessed entry with brick support posts; changed to two separate businesses; new facade including display windows, new windows on second level, signage, and painted brick--dates unknown

historic background (discuss important persons and events associated with this structure)

This structure is located within the original platted area of Grand Junction and was representative of the early 1900 town building.

significance: (check appropriate categories and briefly justify below)

architectural significance:
 represents the work of a master

historic significance:
 associated with significant persons

___ possesses high artistic values

___ associated with significant events or patterns

___ represents a type, period or method of construction

___ contributes to an historic district

statement of significance:

Building does not retain its integrity and, therefore, does not meet Nat'l. Register criteria

Non-contributing; alterations are not reversible

references (be specific)

1981 Historic Survey of City

Mesa County Assessor's Records

surveyed by: Marty Alexandroff
date: July, 1994

affiliation: Winter & Company

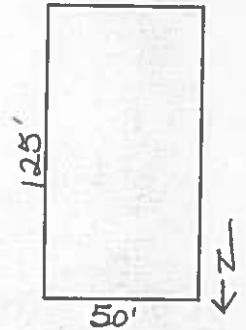



EXPOS

AVE

HOA

Works & Galler

TONY'S CYCLE SPORTS



301 Main Street

Most Current Google View

July 2012