

CITY OF GRAND JUNCTION, COLORADO

MEMORANDUM

Reply Requested

Yes No

Date

April 27, 1983

To: ~~(XXXX)~~ Harley Seybold
Dick Hollinger

From: ~~(XX)~~ Steve Johnson SJ

RE: Sewer Clearances Required Prior Issuance
of Building Permits.

I received a request to provide Dick Hollinger with a map of all areas in which sewer clearances are required prior to issuance of building permits.

The attached map indicates the current 201 Service Area boundary. All areas inside this map except for

- 1) Clifton Sanitation Districts 1 and 2;
- 2) Panarama Improvement District;
- 3) Tiara Rado; and
- 4) Monument Meadows

require such sewer clearances.

Prior to connection to the Persigo WWTP within the next year, the latter three areas will be required to pay plant investment fees (as is occurring now in the Bluffs). After billing for the PIF's has been commenced, all future building in those areas will require sewer clearance.

In case of doubt about the necessity of sewer clearance, inquiry should be made at this department before building permits are issued.

APPROVED: James E. Patterson, Jr.
James E. Patterson, Jr.

Attachment

4/27/83
SMK 2

*
*
*
*

GRAND JUNCTION FACILITIES PLAN

LEGEND

- GRAND JUNCTION CITY LIMITS
- - - - GRAND JUNCTION FACILITY PLANNING AREA BOUNDARY
- ===== SELECTED ALTERNATE CLIFTON AREA (ALT. 2)
- ===== REDLANDS- GRAND JUNCTION (ALT. 1)
- - - - SECTION 201 BOUNDARY EXPANSIONS

FIGURE 16

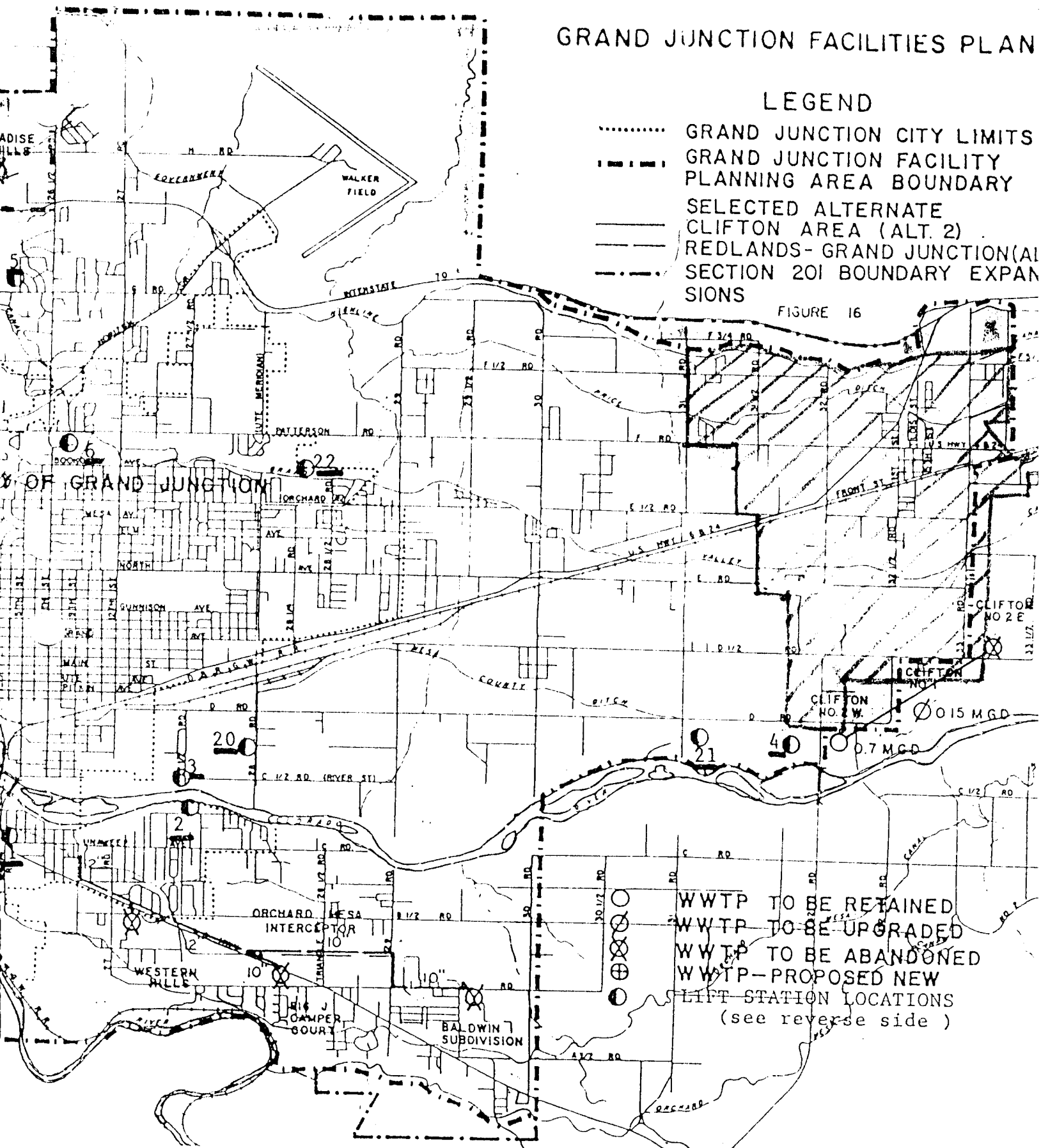

○ WWTP TO BE RETAINED
 ⊗ WWTP TO BE UPGRADED
 ⊕ WWTP TO BE ABANDONED
 ⊙ WWTP - PROPOSED NEW
 ○ LIFT STATION LOCATIONS
 (see reverse side)

43-B

Grand Junction

FIGURE 16

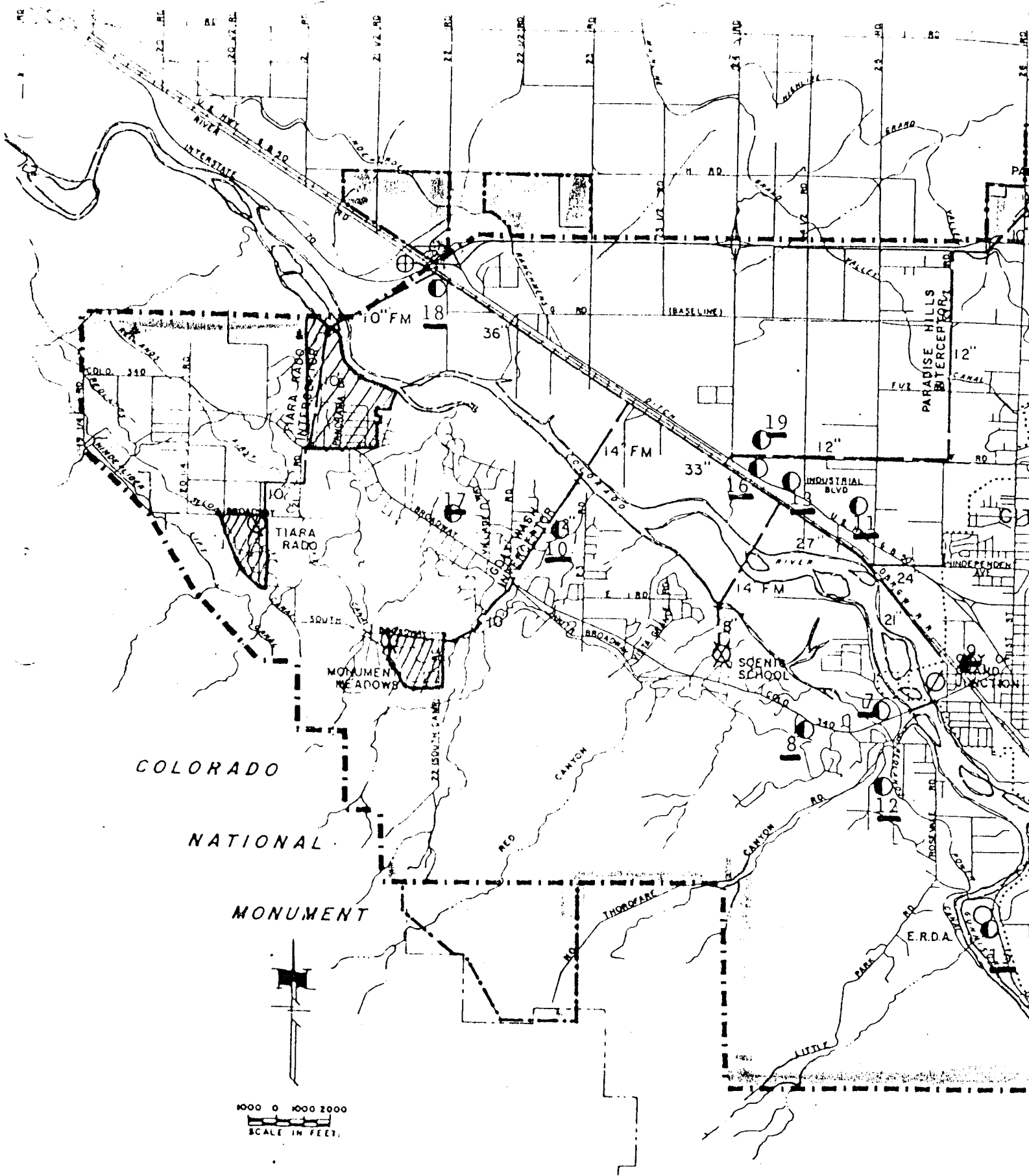

1000 0 1000 2000
SCALE IN FEET.

ATTACHMENT