

COLORADO HISTORICAL SOCIETY
Office of Archaeology and Historic Preservation
1300 Broadway Denver, Colorado 80203

HISTORIC BUILDING INVENTORY RECORD

project name: Grand Junction Downtown Survey
county: Mesa city: Grand Junction
state ID no. 5ME 7174 temporary no.
current building name: Drive Train Institute Machine Shop
address: 545 Colorado, Grand Junction, CO 81501
owner: Helmuth Hinger, 545 Colorado, Grand Junction 81501-2605
township: 1S range: 1W section: 14, SE 1/4 SW 1/4
historic name:
USGS quad name: Grand Junction, CO 1962 X 7.5' 15'
district name:
block: 126 lot(s) 11, 12, 13, 14 addition: City
yr. of addition
film roll by: Marty Alexandroff no.
negative nos. 6835-20
location of negatives: City of Grand Junction
date of construction: _____ estimate 1906 actual
source: 1981 Historic Survey of City
use: commercial present commercial historic
condition: _____ excellent _____ good X fair _____ deteriorating
extent of alterations: _____ minor X moderate _____ major
describe: glass block has replaced transom windows; a garage door replaces part of one storefront.
style: Vernacular storefront; Commercial
stories: 1
X original _____ moved date(s) of move:

materials: brick

square footage: 3000/3565

National Register Eligibility:

Individual: yes no

Contributing to district: yes no

local landmark designation: _____ name _____ date _____

associated buildings? yes type: _____

if inventoried, list ID nos.

architectural description: Two, original one story commercial buildings remain on these lots. One has been painted with a recessed door, display windows and glass tile in the clerestory. This is 545. The building to its right has a display window with wood trim and originally clerestory. A wood door with covered transom and large wood garage doors with glass windows and signage. The entry door and brick kickplate may be original. These buildings are used as the machine and service shops for the Drive Train Institute.

architect: unknown

source:

original owner: unknown

source:

builder/contractor: unknown

source:

theme(s): Plateau Country/commercial

construction history: (description, names, dates, etc. relating to major additions or alterations to original structure)
display windows, garage door, recessed entry, painted brick--
dates unknown

historic background (discuss important persons and events associated with this structure)

This structure is located within the original platted area of Grand Junction and was representative of early 1900s town building.

significance: (check appropriate categories and briefly justify below)

architectural significance:
 represents the work of a master

historic significance:
 associated with significant persons

___ possesses high artistic values

X associated with significant events or patterns

X represents a type, period or method of construction

X contributes to an historic district

statement of significance:

Contributing; This building could be restored. This structure is located within the original platted area of Grand Junction and is representative of the early 1900s town building.

references (be specific)

1981 Historic Survey of City
Mesa County Assessor's Records

surveyed by: Marty Alexandroff
date: July, 1994

affiliation: Winter & Company

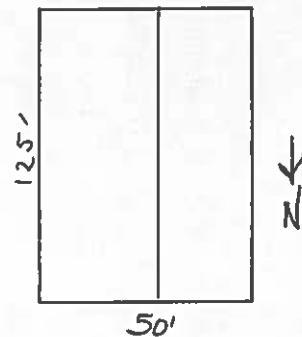



545 Colorado Avenue
Current Google Street View
July 2012