

COLORADO HISTORICAL SOCIETY
Office of Archaeology and Historic Preservation
1300 Broadway Denver, CO 80203

SITE NO.: 5ME7636

HISTORIC BUILDING INVENTORY

Eligible for National Register yes no
date _____ initials _____
Criteria A B C D
Contributes to a potential National Register district
 yes no district name: _____

COUNTY: Mesa

CITY: Grand Junction

Eligible for State Register yes no
date _____ initials _____
Criteria a b c d e
Areas of significance: _____

HISTORIC BUILDING NAME: The House at 105 Lilac Lane

Period of significance _____
Needs data date _____ initials _____

CURRENT BUILDING NAME: Dunne Residence

LOCAL LANDMARK DESIGNATION: yes no

ADDRESS: 105 Lilac Lane, Grand Junction, CO 81505-7021

Date of designation: N/A
Designating authority: N/A

P.M.: UTE township: 1S range: 1W
NE ¼ of SE ¼ of SE ¼ of NE ¼ of section 10

OWNER NAME & ADDRESS: Nora W. Dunne, 105 Lilac Lane, Grand Junction, CO 81505-7021

UTM REFERENCE-12
Easting: 710090
Northing: 4328950

USGS QUAD NAME: Grand Junction

Year: 1962; photorevised 1973 7.5' 15'

STYLE: English/Norman

Block:
Lot(s): Beg 16' S of NE cor S2 SE4 NE4 1S 1W sec10
W215'+
Addition:
Year of addition:

BUILDING TYPE:

original location moved
Date of moves(s):

MATERIALS: Concrete Foundation; Wood Frame; Shake Siding; Asphalt Shingle Roof

HISTORIC USE: Domestic
PRESENT USE: Domestic

STORIES: 1

SQUARE FOOTAGE: 1180

DATE OF CONSTRUCTION- estimate: 1938 actual:
Source of information: Tax Assessor's Records

PLAN SHAPE:

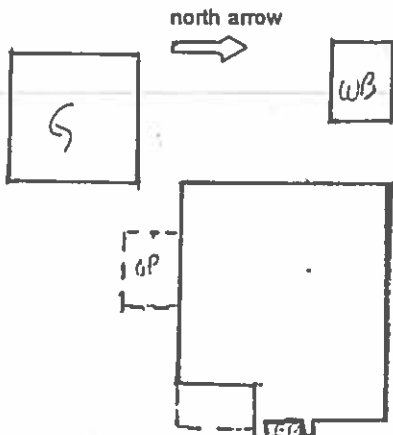

ARCHITECT: Unknown

Source of information:

BUILDER/CONTRACTOR: Unknown

Source of information:

ORIGINAL OWNER: Mary Ladd Wakefield

Source of information: Tract Books

ASSOCIATED BUILDINGS- yes no

Type: Garage

ARCHITECTURAL DESCRIPTION: One and a half story with cross gables. Flagstone stoop under small entry wing at center of facade. Entry gable has a lower, flared cat-slide eave on the south. Arched front door is paneled, with one light. Screen door. Adjacent to the south side of facade is a sunporch, glazed with large single lights. Windows are paired double hung wood sash, six-over-six and paired casements, eight lights each. Several louvered shutters. Medium gray shake siding with gray stucco and decorative half-timbered gables. Door and window surrounds, half-timbering, cornices, screen door frames and sun porch columns are white. Light gray composition shingle roof with brick chimney on the east slope.

White picket fence around large lawn with ash and fir trees. Evergreens across house facade. Large elms along road frontage. Thicket of many types of trees on south end of property.

Garage at rear with side gable, asbestos shingling, false half-timbering and original garage doors.

PHOTOGRAPHS (include photographs showing each side of building and any associated buildings)

Film roll no.: 10

Negative no.: 19

Photographer: Carolyn Howard

Location of negatives: City Of Grand Junction

CONSTRUCTION HISTORY (include description and dates of major additions, alterations, or demolitions): In 1987, the open front porch was changed to a finished enclosed porch. Another open porch was built on the side of the house.

HISTORICAL BACKGROUND (discuss important persons and events associated with this building): Purchased by Charles E. and Mary Wakefield in 1938. Mr. Wakefield, who was a well known grocer, also owned a home across the street at 104 Lilac Lane. It is unclear in which home they actually resided. He died in 1940 and she is listed with each until 1946.

INFORMATION SOURCES (be specific): Appraisal Card, Ownership Card, Lot and Block Books, Grand Junction City Directories.

SIGNIFICANCE (check appropriate categories)

Architectural significance:

represents the work of a master

possess high artistic value

represents a type, period, or method of construction

Historical significance:

associated with significant person(s)

associated with significant event

associated with a pattern of events

contributes to an historic district

National Register eligibility:

Individual yes no

Criteria: A B C D

Area(s) of significance: Architecture

Contributes to a potential district:

yes no

District name:

THEME(S):

Period of significance: 1938

STATEMENT OF SIGNIFICANCE (briefly justify the significance checked above): An English/Norman style house with decorative half-timber gables and a small entry wing with picturesque design. Although not eligible for the National Register, this house may contribute to a local register

INVENTORY COMPLETED BY: Museum Group Staff

DATE: 2/14/96

AFFILIATION: Museum of Western Colorado

PHONE: (970) 241-9117

ADDRESS: PO Box 20000-5020, Grand Junction, Colorado 81502-5020

PROJECT NAME: Grand Junction Historic Resources Survey, Phase 2



105 Lilac Lane
Grand Junction, Mesa Co, CO
2945-101-00-028
5ME7636

