

COLORADO HISTORICAL SOCIETY
 Office of Archaeology and Historic Preservation
 1300 Broadway Denver, CO 80203

HISTORIC BUILDING INVENTORY

SITE NO.: 5ME7888

Eligible for National Register yes no
 date _____ initials _____
 Criteria A B C D
 Contributes to a potential National Register district
 yes no district name: _____

Eligible for State Register yes no
 date _____ initials _____
 Criteria a b c d e
 Areas of significance: _____

Period of significance _____
 Needs data date _____ initials _____

LOCAL LANDMARK DESIGNATION: yes no

Date of designation: N/A
 Designating authority: N/A

P.M.: UTE township: 1S range:1W
 SE ¼ of NE ¼ of SE¼ of NE¼ of section 14

UTM REFERENCE-12
 Easting: 711910
 Northing: 4327480

USGS QUAD NAME: Grand Junction

Year: 1962; photorevised 1973 7.5' 15'

Block: 45
 Lot(s): 18
 Addition:
 Year of addition:

original location moved

Date of moves(s):

HISTORIC USE: Domestic

PRESENT USE: Domestic

DATE OF CONSTRUCTION- estimate: 1914 actual:
 Source of Information: Tax Assessor's Records

ARCHITECT: Unknown

Source of information:

BUILDER/CONTRACTOR: Unknown

Source of information:

ORIGINAL OWNER: Ed Mallon

Source of information: Lot and Block Books

ASSOCIATED BUILDINGS- yes no

Type: Garage

COUNTY: Mesa

CITY: Grand Junction

HISTORIC BUILDING NAME: Mallon, Ed, House

CURRENT BUILDING NAME:

ADDRESS: 619 N. 12th St., Grand Junction, CO 81501-3343

OWNER NAME & ADDRESS: W.B. Swisher, 1640 O Road, Loma, CO 81524-9414

STYLE: Bungalow

BUILDING TYPE:

MATERIALS: Concrete Foundation - Wood Frame - Prep Roll Roof

STORIES: 1

SQUARE FOOTAGE: 791

PLAN SHAPE:

north arrow

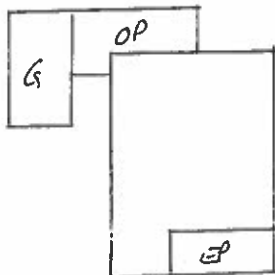

ARCHITECTURAL DESCRIPTION: One story with side gable. Battered foundation skirted with brown cedar shingles. Wood steps, with shingled wood piers, lead up to sunporch/entry integral in north half of facade. Siding on porch half-wall and on columns. Glazed with very large single lights, and two are one-over-one, metal sash. Paneled front door has an oval light. Windows are double hung wood sash, six-over-one and wood casements with eight lights. On north elevation are pairs of small single light casements with window screens. White narrow lapped siding and white trim. Gray composition roof with knee braces under eaves and narrow bargeboards. Shed roof dormer on east slope has louvers on facade. Brick chimney on west slope.

House is situated at rear of lot, facing side street. Landscaped with lawn and lilacs. Large lawn to the south has chain link fence. Elm and ash trees in parking area by large lawn.

One car garage attached to south elevation with shed roof, white simple drop siding, and white, simple drop siding swinging doors.

PHOTOGRAPHS (include photographs showing each side of building and any associated buildings)

Film roll no.: 20
Negative no.: 8

Photographer: Carolyn Howard
Location of negatives: City Of Grand Junction

CONSTRUCTION HISTORY (include description and dates of major additions, alterations, or demolitions): Additional construction or modifications not noted on Assessor's Records.

HISTORICAL BACKGROUND (discuss important persons and events associated with this building): The first owners/occupants of the house were Katherine and George Mallon, a railroader, ca. 1912-1918. Merle and Carl A. Dewey, foreman for CD Smith, were the owners/occupants ca. 1919-1922. Othella and Robert Elliott, a salesman for the Grand Junction Electric Gas and Manufacturing Company, were the owners/occupants ca. 1923-1924. It was home of owners Charles and Blanche Beck, a welder for the Denver and Rio Grande Railway, ca. 1925-1935. Following Becks, the house served as a short-term rental through 1949. Occupants included a railroader and an instructor at Mesa College.

INFORMATION SOURCES (be specific): Plat map, Appraisal Card, Lot and Block Books, Grand Junction City Directories, 1981 Historic Survey of Grand Junction.

SIGNIFICANCE (check appropriate categories)

Architectural significance:
 represents the work of a master
 possess high artistic value
 represents a type, period, or method of construction

Historical significance:
 associated with significant person(s)
 associated with significant event
 associated with a pattern of events
 contributes to an historic district

National Register eligibility:
 Individual yes no
 Criteria: A B C D
 Area(s) of significance: Architecture

Contributes to a potential district:
 yes no
 District name:

THEME(S):

Period of significance: 1914

STATEMENT OF SIGNIFICANCE (briefly justify the significance checked above): A Bungalow which has maintained its original appearance. This is a corner house, situated at the rear of the lot. Although not eligible for the National Register, this house may contribute to a local register.

INVENTORY COMPLETED BY: Museum Group Staff

DATE: 3/29/96

AFFILIATION: Museum of Western Colorado

PHONE: (970) 241-9117

ADDRESS: PO Box 20000-5020, Grand Junction, Colorado 81502-5020

PROJECT NAME: Grand Junction Historic Resources Survey, Phase 2



619 N. 12th St., Grand Junction, Mesa Co, CO

2945-141-30-018

1/29/1996

Roll 20 Frame 08 View E Dir NW

5ME7888



619 N. 12th St., Grand Junction, Mesa Co, CO
2945-141-30-018 1/29/1996
Roll 20 Frame 08 View E Dir NW
5ME7888