

COLORADO HISTORICAL SOCIETY  
Office of Archaeology and Historic Preservation  
1300 Broadway Denver, CO 80203

HISTORIC BUILDING INVENTORY

SITE NO.: 5ME8209

Eligible for National Register  yes  no  
date \_\_\_\_\_ initials \_\_\_\_\_  
Criteria  A  B  C  D  
Contributes to a potential National Register district  
 yes  no district name: \_\_\_\_\_

Eligible for State Register  yes  no  
date \_\_\_\_\_ initials \_\_\_\_\_  
Criteria  a  b  c  d  e  
Areas of significance: \_\_\_\_\_

COUNTY: Mesa

CITY: Grand Junction

Period of significance \_\_\_\_\_  
Needs data  date \_\_\_\_\_ initials \_\_\_\_\_

HISTORIC BUILDING NAME: Bullock, Chauncey, House

CURRENT BUILDING NAME: Martinez Residence

LOCAL LANDMARK DESIGNATION:  yes  no

Date of designation: N/A  
Designating authority: N/A

ADDRESS: 842 White Ave., Grand Junction, CO 81501-3443

P.M.: UTE township: 1S range:1W  
NE ¼ of NE ¼ of NW¼ of SE¼ of section 14

OWNER NAME & ADDRESS: Edward R. Martinez, 842 White Ave., Grand Junction, CO 81501-3443

UTM REFERENCE-12  
Easting: 711290  
Northing: 4327130

USGS QUAD NAME: Grand Junction

Year: 1962; photorevised 1973  7.5'  15'

STYLE: Classic Cottage

Block: 85  
Lot(s): 21 and 22  
Addition:  
Year of addition:

BUILDING TYPE:

original location  moved  
Date of moves(s):

MATERIALS: Concrete Foundation - Wood Frame - Asphalt Shingle Roof

HISTORIC USE: Domestic  
PRESENT USE: Domestic

STORIES: 1.5

SQUARE FOOTAGE: 700

DATE OF CONSTRUCTION- estimate: 1904 actual:  
Source of information: Tax Assessor's Records

PLAN SHAPE:

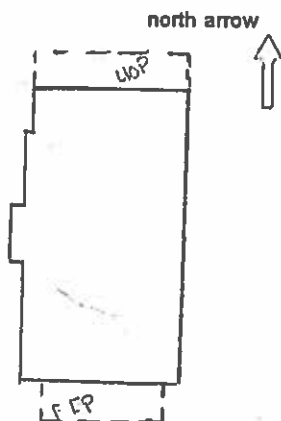

ARCHITECT: Unknown

Source of information:

BUILDER/CONTRACTOR: Unknown

Source of information:

ORIGINAL OWNER: L.H. Breeze

Source of information: Lot and Block Books

ASSOCIATED BUILDINGS-  yes  no

Type: Garage

**ARCHITECTURAL DESCRIPTION:** One story with flared hip roof. Foundation covered with wide wood planks painted beige. Concrete steps with pipe railing lead up to sunporch/entry with hip roof which extends across facade. Ribbed balustrade in front of flush siding on porch half wall. Four Doric half columns with pedestals and two responds. Porch glazed with large fixed panes with wooden frames and has flush wooden door with large oval light and two narrow side lights. Principal door is wood panel with large light. Double hung wood sash windows around the house with storms. Projecting bay on west elevation. Shed roof wing across rear. Beige simple drop siding. Porch balustrade, fascia and window surrounds are painted blue. Fishscale shingles painted variations of blue surround porch door and side lights. Brown composition shingle roof. Brick chimneys on hip roof ridge and north slope. Hip roof dormer on facade has paired windows.

Landscaped with lawn. Two large trees in front yard.

Garage with front gable, brown composition shingle roof, and beige wide aluminum siding has been converted to living quarters. Garage door replaced with flush wooden door with oval light, transom and two narrow side lights.

**PHOTOGRAPHS (Include photographs showing each side of building and any associated buildings)**

Film roll no.: 32  
Negative no.: 11

Photographer: Carolyn Howard  
Location of negatives: City Of Grand Junction

**CONSTRUCTION HISTORY (include description and dates of major additions, alterations, or demolitions):** Storm windows. Finished enclosed porch added, 1990. Garage converted to photo studio. Additional construction or modifications not noted in Assessor's records.

**HISTORICAL BACKGROUND (discuss important persons and events associated with this building):** The first occupants in this house, ca. 1905, were Daisy and Louis Breeze, the County Assessor. After her husband's death in 1905, Daisy Lucas Breeze continued to occupy the house, at times using it as a boarding house through ca. 1918. Florence and Chauncey Bullock, a U.S. postal carrier, owned/resided in the house ca. 1921-1946.

**INFORMATION SOURCES (be specific):** Plat Map, Appraisal Card, Lot and Block Books, Grand Junction City Directories, 1981 Historic Survey of Grand Junction, Obituary Index, Grand Junction Daily Sentinel Newspaper, 16 Oct 1905, p1.

**SIGNIFICANCE (check appropriate categories)**

**Architectural significance:**  
 represents the work of a master  
 possess high artistic value  
 represents a type, period, or method of construction

**National Register eligibility:**  
Individual  yes  no  
Criteria:  A  B  C  D  
Area(s) of significance: Architecture

Period of significance: 1904

**Historical significance:**  
 associated with significant person(s)  
 associated with significant event  
 associated with a pattern of events  
 contributes to an historic district

**Contributes to a potential district:**  
yes no  
District name:

**THEME(S):**

**STATEMENT OF SIGNIFICANCE (briefly justify the significance checked above):** Porch glazing is fairly well done, although the surrounds are hectic. Otherwise, the house is unmodified. Although not eligible for the National Register, this house may contribute to a local register.

**INVENTORY COMPLETED BY:** Museum Group Staff

**DATE:** 3/29/96

**AFFILIATION:** Museum of Western Colorado

**PHONE:** (970) 241-9117

**ADDRESS:** PO Box 20000-5020, Grand Junction, Colorado 81502-5020

**PROJECT NAME:** Grand Junction Historic Resources Survey, Phase 2



842 White Ave. (front), Grand Junction, Mesa Co, CO

2945-144-04-012

02/29/1996

Roll 32 Frame 11 View S Dir N/NW

5ME 8209



842 White Ave. (front), Grand Junction, Mesa Co, CO  
2945-144-04-012 02/29/1996  
Roll 32 Frame 11 View S Dir N/NW  
SME 8209