

COLORADO HISTORICAL SOCIETY
 Office of Archaeology and Historic Preservation
 1300 Broadway Denver, CO 80203

HISTORIC BUILDING INVENTORY

SITE NO.: 5ME8233

Eligible for National Register yes no
 date _____ initials _____
 Criteria A B C D
 Contributes to a potential National Register district
 yes no district name: _____

COUNTY: Mesa

CITY: Grand Junction

Eligible for State Register yes no
 date _____ initials _____
 Criteria a b c d e
 Areas of significance: _____

HISTORIC BUILDING NAME: Price, Floyd, House

Period of significance _____
 Needs data date _____ initials _____

CURRENT BUILDING NAME:

LOCAL LANDMARK DESIGNATION: yes no

ADDRESS: 552 Teller Ave., Grand Junction, CO 81501-2624

Date of designation: N/A
 Designating authority: N/A

P.M.: UTE township: 1S range:1W
 NW 1/4 of SE 1/4 of NE 1/4 of NW 1/4 of section 14

OWNER NAME & ADDRESS: Van Faith, PO Box 1564, Grand Junction, CO 81501-1564

UTM REFERENCE-12
 Easting: 710825
 Northing: 4327820

USGS QUAD NAME: Grand Junction

Year: 1962; photorevised 1973 7.5' 15'

STYLE: Classic Cottage

Block: 16
 Lot(s): 19 and 20
 Addition:
 Year of addition:

BUILDING TYPE:

original location moved

Date of moves(s):

MATERIALS: Concrete Block Foundation - Wood Frame - Asphalt Shingle Roof

HISTORIC USE: Domestic

PRESENT USE: Domestic

STORIES: 1

SQUARE FOOTAGE: 1154

DATE OF CONSTRUCTION- estimate: 1907 actual:
 Source of information: Tax Assessor's Records

PLAN SHAPE:

 north arrow

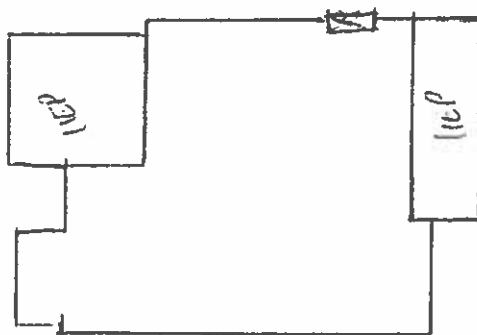

ARCHITECT: Unknown

Source of information:

BUILDER/CONTRACTOR: Unknown

Source of information:

ORIGINAL OWNER: William E. Graham

Source of information: Lot and Block Books

ASSOCIATED BUILDINGS- yes no

Type:

ARCHITECTURAL DESCRIPTION: One story, hip roof with deck. Concrete steps lead up to sunporch with hip roof extending across east three-quarters of facade. Concrete foundation is exposed except at porch where it is covered with wood planks. Simple drop siding on half-wall. Glazing is ribbons of large single lights. Two full height squared porch posts on corners. Aluminum screen door. Glazed porch door divided with large light surrounded by smaller lights. Main door is paneled and has three vertical lights. Large double hung sash and narrow fixed pane window divided with four lights on porch end wall. Additional windows are double hung sash, one-over-one. On west facade and west elevation are new single light windows with vinyl frames. Snap in muntins simulate eight lights. Simple drop wood siding is white. Corner boards, porch posts, window frames and surrounds, fascia, raking cornice and diamond shingles of gables are white. Brown composition shingle roof with boxed eaves. Short gabled wing on west facade with kick, and cross gable on east facade with kick. Both have louvered wood ventilators. Brick chimney in flat peak and full height brick fireplace chimney on east elevation. Landscaped lawn with small trees and shrub in front yard. Backyard enclosed by wood fence. One car garage, front gable roof with brown composition roll roofing, and white drop siding. Door sealed with flush panels.

PHOTOGRAPHS (include photographs showing each side of building and any associated buildings)

Film roll no.: 28
Negative no.: 1

Photographer: Carolyn Howard
Location of negatives: City Of Grand Junction

CONSTRUCTION HISTORY (include description and dates of major additions, alterations, or demolitions): Windows on west side of facade and west elevation. Porch glazing. Additional construction or modifications not noted in Assessor's records.

HISTORICAL BACKGROUND (discuss important persons and events associated with this building): William E. Graham, cashier for the Grand Junction Electric, Gas and Manufacturing, was the original owner/occupant of the house ca. 1907-1910. James H. Rankin was the absentee owner ca. 1914-1918. Rebecca and Floyd Price, Fremont Paint, were the owners/occupants ca. 1919-1943. Elsie and John Reardon, a railroad engineer, were the owners/occupants ca. 1945 to at least 1951.

INFORMATION SOURCES (be specific): Plat Map, Appraisal Card, Lot and Block Books, Grand Junction City Directories.

SIGNIFICANCE (check appropriate categories)

Architectural significance:
 represents the work of a master
 possess high artistic value
 represents a type, period, or method of construction

Historical significance:
 associated with significant person(s)
 associated with significant event
 associated with a pattern of events
 contributes to an historic district

National Register eligibility:
 Individual yes no
 Criteria: A B C D
 Area(s) of significance: Architecture

Contributes to a potential district:
 yes no
 District name:

Period of significance: 1907

THEME(S):

STATEMENT OF SIGNIFICANCE (briefly justify the significance checked above): A wide house with a wide porch and two cross gables on the facade. Although not eligible for the National Register, this house may contribute to a local register.

INVENTORY COMPLETED BY: Museum Group Staff

DATE: 3/29/96

AFFILIATION: Museum of Western Colorado

PHONE: (970) 241-9117

ADDRESS: PO Box 20000-5020, Grand Junction, Colorado 81502-5020

PROJECT NAME: Grand Junction Historic Resources Survey, Phase 2



552 Teller Ave. , Grand Junction, Mesa Co, CO

2945-142-08-009

02/06/1996

Roll 28 Frame 1 View S Dir NE



552 Teller Ave. , Grand Junction, Mesa Co, CO
2945-142-08-009 02/06/1996
Roll 28 Frame 1 View S Dir NE
SME 8233