

COLORADO HISTORICAL SOCIETY
Office of Archaeology and Historic Preservation
1300 Broadway Denver, CO 80203

HISTORIC BUILDING INVENTORY

SITE NO.: 5ME8252

Eligible for National Register yes no
date _____ initials _____
Criteria A B C D
Contributes to a potential National Register district
 yes no district name: _____

Eligible for State Register yes no
date _____ initials _____
Criteria a b c d e
Areas of significance: _____

COUNTY: Mesa

CITY: Grand Junction

Period of significance _____
Needs data date _____ initials _____

HISTORIC BUILDING NAME: Brisnahan, Jason, House

CURRENT BUILDING NAME:

LOCAL LANDMARK DESIGNATION: yes no

ADDRESS: 424 Ouray Ave., Grand Junction, CO 81501-2536

Date of designation: N/A
Designating authority: N/A

P.M.: UTE township: 1S range:1W
NW 1/4 of SW 1/4 of SE 1/4 of NW 1/4 of section 14

OWNER NAME & ADDRESS: Troy B. Carter, 450 N. 16th St., Grand Junction, CO 81501-4424

UTM REFERENCE-12
Easting: 710640
Northing: 4327380

USGS QUAD NAME: Grand Junction

Year: 1962; photorevised 1973 7.5' 15'

STYLE: Edwardian

Block: 59
Lot(s): 26 and 27
Addition:
Year of addition:

BUILDING TYPE:

original location moved
Date of moves(s):

MATERIALS: Mud Sill Foundation - Wood Frame - Asphalt Shingle Roof

HISTORIC USE: Domestic
PRESENT USE: Domestic

STORIES: 2

SQUARE FOOTAGE: 1733

DATE OF CONSTRUCTION- estimate: 1904 actual:
Source of information: Tax Assessor's Records

PLAN SHAPE:



north arrow

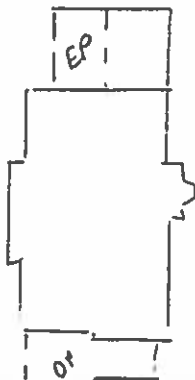

ARCHITECT: Unknown
Source of information:

BUILDER/CONTRACTOR: Unknown
Source of information:

ORIGINAL OWNER: E.A. Lyons
Source of information: Lot and Block Books

ASSOCIATED BUILDINGS- yes no
Type: Storage Shed

ARCHITECTURAL DESCRIPTION: Two story with cross gables. Mud sill foundation. Concrete steps lead up to porch with hip roof extending across west three-quarters of facade. Siding on half-wall. Three columns across porch are sided. The heads of the two openings on the porch facade have diagonal braces with board and batten enclosures. Pedimented cross gable on west porch over entry. Paneled door has a full light. Windows of house are mainly double hung wood sash, one-over-one. On first floor facade and on west elevation are transom windows with leaded, diamond panes in upper sash. Small window with an oval light on west elevation. Cutaway bay on east elevation has a flat roof. Pale yellow wood shingle siding. Door and window surrounds, string courses and cornices are buff. Gray composition shingle roof with boxed eaves. Gables have return cornices. The wing on the east facade has a west slope that is a catslide. Brick chimney on west slope.

Landscaped with lawn and evergreens along driveway. Large locust and sycamore trees on west of the graveled drive.
Small storage building at rear with side gable, gray composition shingle roof, weathered simple drop siding, and flush door.

PHOTOGRAPHS (include photographs showing each side of building and any associated buildings)

Film roll no.: 24
Negative no.: 11

Photographer: Carolyn Howard
Location of negatives: City Of Grand Junction

CONSTRUCTION HISTORY (include description and dates of major additions, alterations, or demolitions): Siding. Additional construction or modifications not noted in Assessor's records.

HISTORICAL BACKGROUND (discuss important persons and events associated with this building): Ellen A. Lyons, Lyons and Sons Drygoods, was the first owner/occupant ca. 1904-1906. It was owned by the J.A. Lyons Estate ca. 1907-1908. Ada and W.A. Bailey, an engineer, were the owners/occupants ca. 1913-1921. Mary A. Beebee was the absentee owner ca. 1922- 1934. Margaret and Ames Brisnahan, a foreman for the Denver and Rio Grande Railroad, were the tenants ca. 1924-1935. Owners/occupants Eleanor Leo and Ava B. Maxson, furnished rooms ca. 1936-1938. Nellie Miller, the owner/occupant ca. 1939-1948, continued to operate a boarding house.

INFORMATION SOURCES (be specific): Plat Map, Appraisal Card, Lot and Block Books, Grand Junction City Directories.

SIGNIFICANCE (check appropriate categories)

Architectural significance:

- represents the work of a master
 possess high artistic value
 represents a type, period, or method of construction

Historical significance:

- associated with significant person(s)
 associated with significant event
 associated with a pattern of events
 contributes to an historic district

National Register eligibility:

- Individual yes no
Criteria: A B C D
Area(s) of significance: Architecture

Contributes to a potential district:

- yes no
District name:

Period of significance: 1904

THEME(S):

STATEMENT OF SIGNIFICANCE (briefly justify the significance checked above): This house is original including the fenestration and porch. The siding of large shingles is from the 1940s or 1950s. The siding, and porch braces, appear to have been chosen to harmonize with the apartment houses to the west. Although not eligible for the National Register, this house may contribute to a local register.

INVENTORY COMPLETED BY: Museum Group Staff

DATE: 3/29/96

AFFILIATION: Museum of Western Colorado

PHONE: (970) 241-9117

ADDRESS: PO Box 20000-5020, Grand Junction, Colorado 81502-5020

PROJECT NAME: Grand Junction Historic Resources Survey, Phase 2





424 Ouray Ave., Grand Junction, Mesa Co, CO
2945-142-33-015 02/05/1996
Roll 24 Frame 11 View S Dir NW
SME 8252

424 Ouray Ave., Grand Junction, Mesa Co, CO

2945-142-33-015

02/05/1996

Roll 24 Frame 11 View S Dir NW

SME8252