

COLORADO HISTORICAL SOCIETY
 Office of Archaeology and Historic Preservation
 1300 Broadway Denver, CO 80203

HISTORIC BUILDING INVENTORY

SITE NO.: 5ME8269

Eligible for National Register yes no
 date _____ initials _____
 Criteria A B C D
 Contributes to a potential National Register district
 yes no district name: _____

COUNTY: Mesa

CITY: Grand Junction

Eligible for State Register yes no
 date _____ initials _____
 Criteria a b c d e
 Areas of significance: _____

HISTORIC BUILDING NAME: Eubanks, Paul, House

Period of significance _____
 Needs data ___ date _____ initials _____

CURRENT BUILDING NAME: Carpenter Residence

LOCAL LANDMARK DESIGNATION: [] yes [X] no

ADDRESS: 425 Gunnison Ave., Grand Junction, CO 81501-2527

Date of designation: N/A
 Designating authority: N/A

P.M.: UTE township: 1S range:1W
 SW ¼ of NW ¼ of SE¼ of NW¼ of section 14

OWNER NAME & ADDRESS: Lillie D. Carpenter, 425 Gunnison Ave., Grand Junction, CO 81501-2527

UTM REFERENCE-12
 Easting: 710645
 Northing: 4327560

USGS QUAD NAME: Grand Junction

Year: 1962; photorevised 1973 [X] 7.5' [] 15'

STYLE: Bungalow

Block: 52
 Lot(s): 7 and 8
 Addition:
 Year of addition:

BUILDING TYPE:

[X] original location [] moved

Date of moves(s):

MATERIALS: Concrete Foundation -Block Stucco Frame - Asphalt Shingle Roof

HISTORIC USE: Domestic

PRESENT USE: Domestic

STORIES: 1

SQUARE FOOTAGE: 1211

DATE OF CONSTRUCTION- estimate: 1914 actual:

Source of information: Tax Assessor's Records

PLAN SHAPE:

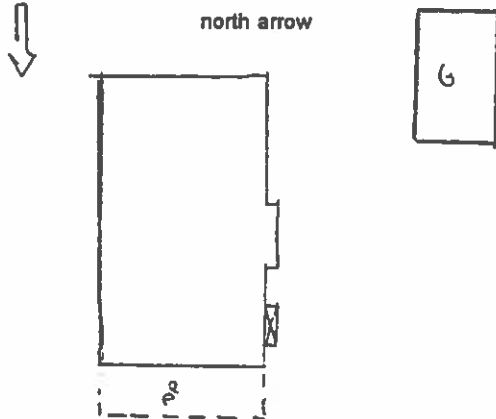

ARCHITECT: Unknown

Source of information:

BUILDER/CONTRACTOR: Unknown

Source of information:

ORIGINAL OWNER: Laura E. Sears

Source of information: Lot and Block Books

ASSOCIATED BUILDINGS- [X] yes [] no

Type: Garage

ARCHITECTURAL DESCRIPTION: One story with side gable roof. Concrete steps with wrought iron railings lead up to screened porch with shed roof extending across entire facade. Porch half-wall is covered with textured stucco. Stucco covered corner porch piers support a broad segmental arch which stretches across the porch facade. Two smaller segmental arches on each side of porch. Ribbons of metal frame porch screens. Metal screen door framed by vertical, screened lights. Glazed storm door with wrought iron grille work. Main door is flush with single light. Windows around house are double hung wood sash, five and four vertical lights over one, with metal storm windows. Projecting bay with shed roof with exposed rafter ends and knee braces below in west gable wall. Gabled dormer with exposed rafter ends and knee braces. Gable has ribbon of three small windows, four vertical light over one. White, textured stucco siding. Concrete steps, coping of porch half wall, window frames and sills are red. Red composition shingle roof with overhanging eaves and knee braces. Gable walls have kicks with exposed rafter ends. Exposed rafter ends and knee braces are white. Full height, partially inset, fireplace chimney on west gable wall penetrates through north slope.

Yard is paved with concrete next to street with four large wood barrel planters. Mature tree in front yard. Two rose bushes frame walkway leading to porch. Row of bushes along chain link fence with gate. Tall, wood lattice fence along rear of lot.

One car garage at rear of paved driveway on west lawn. Garage has front gable with knee braces, red composition shingle roof, textured white stucco siding and red garage door.

PHOTOGRAPHS (include photographs showing each side of building and any associated buildings)

Film roll no.: 26

Negative no.: 2

Photographer: Carolyn Howard

Location of negatives: City Of Grand Junction

CONSTRUCTION HISTORY (include description and dates of major additions, alterations, or demolitions): Storm door and windows. Additional construction or modifications not noted in Assessor's records.

HISTORICAL BACKGROUND (discuss important persons and events associated with this building): Laura Sears, bookkeeper for the C.D. Smith Company, was the original owner/occupant ca. 1916 through 1919. R. J. Derry was the absentee owner, ca. 1920-1923; Maud and Paul Eubanks, a railroad engineer, were the owners/occupants ca. 1924-1951.

INFORMATION SOURCES (be specific): Plat Map, Appraisal Card, Lot and Block Books, Grand Junction City Directories.

SIGNIFICANCE (check appropriate categories)

Architectural significance:

represents the work of a master

possess high artistic value

represents a type, period, or method of construction

Historical significance:

associated with significant person(s)

associated with significant event

associated with a pattern of events

contributes to an historic district

National Register eligibility:

Individual yes no

Criteria: A B C D

Area(s) of significance: Architecture

Contributes to a potential district:

yes no

District name:

THEME(s):

Period of significance: 1914

STATEMENT OF SIGNIFICANCE (briefly justify the significance checked above): An unmodified Bungalow. The stucco siding was seldom used on bungalows in this town. Although not eligible for the National Register, this house may contribute to a local register.

INVENTORY COMPLETED BY: Museum Group Staff

DATE: 3/29/96

AFFILIATION: Museum of Western Colorado

PHONE: (970) 241-9117

ADDRESS: PO Box 20000-5020, Grand Junction, Colorado 81502-5020

PROJECT NAME: Grand Junction Historic Resources Survey, Phase 2



425 Gunnison Ave., Grand Junction, Mesa Co, CO

2945-142-28-006

02/06/1996

Roll 26 Frame 2 View N Dir SW

5mEB269



425 Gunnison Ave. , Grand Junction, Mesa Co, CO
2945-142-28-006 02/06/1996
Roll 26 Frame 2 View N Dir SW
5 ME 8269