

| | | |
|---|---------------------|--|
| COLORADO HISTORICAL SOCIETY Office of Archaeology and Historic Preservation 1300 Broadway Denver, CO 80203 HISTORIC BUILDING INVENTORY | | SITE NO.: 5ME8293 |
| COUNTY: Mesa CITY: Grand Junction | | Eligible for National Register <input type="checkbox"/> yes <input type="checkbox"/> no date _____ initials _____ Criteria <input type="checkbox"/> A <input type="checkbox"/> B <input type="checkbox"/> C <input type="checkbox"/> D Contributes to a potential National Register district <input type="checkbox"/> yes <input type="checkbox"/> no district name: _____ |
| HISTORIC BUILDING NAME: Sandy, Ralph, House | | Eligible for State Register <input type="checkbox"/> yes <input type="checkbox"/> no date _____ initials _____ Criteria <input type="checkbox"/> a <input type="checkbox"/> b <input type="checkbox"/> c <input type="checkbox"/> d <input type="checkbox"/> e Areas of significance: _____ |
| CURRENT BUILDING NAME: | | Period of significance _____ Needs data <input type="checkbox"/> date _____ initials _____ |
| ADDRESS: 760 Hill Ave., Grand Junction, CO 81501-3230 | | LOCAL LANDMARK DESIGNATION: [] yes [X] no Date of designation: N/A Designating authority: N/A |
| OWNER NAME & ADDRESS: Flora Sandy, 760 Hill Ave., Grand Junction, CO 81501-3230 | | P.M.: UTE township: 1S range:1W SW ¼ of SE ¼ of NW¼ of NE¼ of section 14 |
| | | UTM REFERENCE-12 Easting: 711180 Northing: 4327700 |
| | | USGS QUAD NAME: Grand Junction Year: 1962; photorevised 1973 [X] 7.5' [] 15' |
| STYLE: Vernacular Masonry | | Block: 27 Lot(s): 20 and 21 Addition: Year of addition: |
| BUILDING TYPE: | | [X] original location [] moved Date of moves(s): |
| MATERIALS: Concrete Foundation - Block Brick - Asphalt Shingle Roof | | HISTORIC USE: Domestic PRESENT USE: Domestic |
| STORIES: 1 | SQUARE FOOTAGE: 965 | DATE OF CONSTRUCTION- estimate: 1950 actual: Source of information: Tax Assessor's Records |
| PLAN SHAPE: <div style="text-align: center;"> north arrow ↑ </div> | | ARCHITECT: Unknown Source of information: |
| | | BUILDER/CONTRACTOR: Unknown Source of information: |
| | | ORIGINAL OWNER: Ralph and Flora Sandy Source of information: Lot and Block Books |
| | | ASSOCIATED BUILDINGS- [X] yes [] no Type: Garage |

ARCHITECTURAL DESCRIPTION: One story with hip roof. Concrete foundation. Concrete steps and stoop with iron railings lead up to open porch with hip roof. Full height, 4 x 4 posts on both front corners. Wrought iron balustrades. Aluminum storm door with ornamental grille over paneled front door with fan light. Windows are double hung wood sash, one-over-one. On the east corner of facade are corner picture windows, flanked by sash windows. Windows have brick rowlock sills and lintels. All windows have storm windows with gray vinyl frames. Walls are buff/orange clay brick tile. Foundation, steps and stoop are dark brown. Window frames, porch posts, gutters and downspouts are white. Gray composition shingle roof with boxed eaves. Short wing on west facade also has hip roof. Gutters on all eaves look like fascias. Brick chimney on east slope.

Landscaped with lawn and conical trimmed evergreens flanking front steps. Forsythia and locust tree on lawn. Ash trees along parking area. Chain link fence with woven aluminum strips around back yard.

One car garage with front gable, gray composition shingle roof, yellow brick and tile walls, white clapboard in gable faces, and white metal door. Alley access.

PHOTOGRAPHS (include photographs showing each side of building and any associated buildings)

Film roll no.: 30
Negative no.: 22

Photographer: Carolyn Howard
Location of negatives: City Of Grand Junction

CONSTRUCTION HISTORY (include description and dates of major additions, alterations, or demolitions): Porch enclosed, 1985. Storm windows and door. Additional construction or modifications not noted in Assessor's records.

HISTORICAL BACKGROUND (discuss important persons and events associated with this building): Flora and Ralph Sandy, were the first owners/occupants of the house, constructed ca. 1950. Ralph was then a kitchen helper at the recently constructed Veterans Administration Medical Center.

INFORMATION SOURCES (be specific): Plat Map, Appraisal Card, Lot and Block Books, Grand Junction City Directories.

SIGNIFICANCE (check appropriate categories)

Architectural significance:

- represents the work of a master
 possess high artistic value
 represents a type, period, or method of construction

Historical significance:

- associated with significant person(s)
 associated with significant event
 associated with a pattern of events
 contributes to an historic district

National Register eligibility:

Individual yes no

Criteria: A B C D

Area(s) of significance: Architecture

Contributes to a potential district:

yes no

District name:

THEME(S):

Period of significance: 1950

STATEMENT OF SIGNIFICANCE (briefly justify the significance checked above): Vernacular houses with large, hollow core tile brick walls were occasionally built in this town in the late 1930s, through the 1950s. This example is typical and unmodified. Although not eligible for the National Register, this house may contribute to a local register.

INVENTORY COMPLETED BY: Museum Group Staff

DATE: 3/29/96

AFFILIATION: Museum of Western Colorado

PHONE: (970) 241-9117

ADDRESS: PO Box 20000-5020, Grand Junction, Colorado 81502-5020

PROJECT NAME: Grand Junction Historic Resources Survey, Phase 2



760 Hill Ave., Grand Junction, Mesa Co, CO

2945-141-14-011

02/07/1996

Roll 30 Frame 22 View S Dir N/NW

SME8293

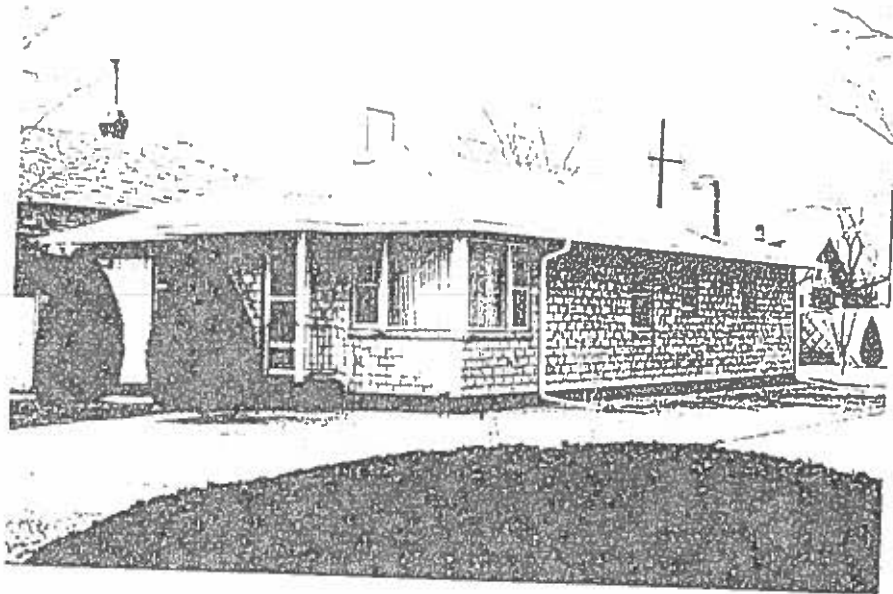

760 Hill Ave. , Grand Junction, Mesa Co, CO
2945-141-14-011 02/07/1996
Roll 30 Frame 22 View S Dir N/NW