

COLORADO HISTORICAL SOCIETY
Office of Archaeology and Historic Preservation
1300 Broadway Denver, CO 80203

HISTORIC BUILDING INVENTORY

SITE NO.: 5ME7500

Eligible for National Register yes no
date _____ initials _____
Criteria A B C D
Contributes to a potential National Register district
 yes no district name: _____

Eligible for State Register yes no
date _____ initials _____
Criteria a b c d e
Areas of significance: _____

COUNTY: Mesa

CITY: Grand Junction

HISTORIC BUILDING NAME: Edwards, G.W., House

Period of significance _____
Needs data date _____ initials _____

CURRENT BUILDING NAME: Taylor Residence

LOCAL LANDMARK DESIGNATION: yes no

ADDRESS: 1202 Grand Ave., Grand Junction, CO 81501-4510

Date of designation: N/A
Designating authority: N/A

OWNER NAME & ADDRESS: Russell Dale Taylor, 1202 Grand Ave., Grand Junction, CO 81501-4510

P.M.: UTE township: 1S range: 1W
SW ¼ of SW ¼ of SW ¼ of NW ¼ of section 13

UTM REFERENCE-12
Easting: 712420
Northing: 4327240

USGS QUAD NAME: Grand Junction

Year: 1962; photorevised 1973 7.5' 15'

STYLE: Bungalow

Block: 6
Lot(s): 31-32
Addition: Dundee Place
Year of addition: 1909

BUILDING TYPE:

original location moved

Date of moves(s): _____

MATERIALS: Concrete Foundation; Wood Frame; Asphalt Shingle Roof

HISTORIC USE: Domestic

PRESENT USE: Domestic

STORIES: 1

SQUARE FOOTAGE: 1474

DATE OF CONSTRUCTION- estimate: 1923 actual:
Source of information: Tax Assessor's Records

PLAN SHAPE:

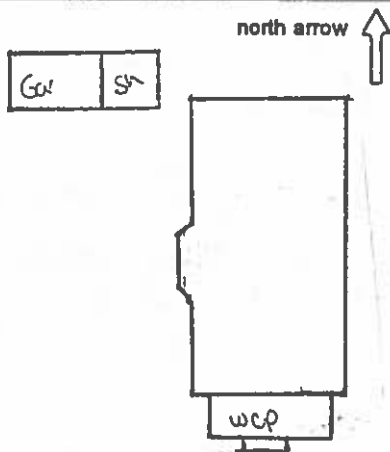

ARCHITECT: Unknown

Source of information: _____

BUILDER/CONTRACTOR: Unknown

Source of information: _____

ORIGINAL OWNER: Lillian Barry

Source of information: Lot and Block Books

ASSOCIATED BUILDINGS- yes no

Type: Garage

ARCHITECTURAL DESCRIPTION: One story with low pitched hip roof and full basement. Wood front steps with concrete piers lead to nearly full width screened front porch. Siding on half-wall. Squared half columns on porch corners. Front gable on porch has knee braces under eaves. Front door is paneled with three vertical lights. Shallow cutaway bay on west wall, has a hip roof. Windows are one-over-one, double hung wood sash. White, false bevel siding and brown trim around window and door surrounds, and bargeboards. Gray composition shingle roof with brick chimney on east slope. Landscaped with lawn and small flower bed on west. Gravel parking area with one elm west of house and one in parking. Modified garage at rear with false bevel siding, side gable roof, and sealed garage door.

PHOTOGRAPHS (include photographs showing each side of building and any associated buildings)

Film roll no.: 4
Negative no.: 6

Photographer: Carolyn Howard
Location of negatives: City Of Grand Junction

CONSTRUCTION HISTORY (include description and dates of major additions, alterations, or demolitions): Additional construction or modifications not noted in Assessor's Records.

HISTORICAL BACKGROUND (discuss important persons and events associated with this building): Residence of George W. Edwards of Edwards Motor Company, ca. 1926 to 1936. Jacob A. Sax, a conductor on the Denver and Rio Grande Western Railroad resided there from ca. 1937 to 1945. Arthur J. Jens, manager of the Forbush Company and later Mesa County Commissioner, and his wife moved in ca. 1946.

INFORMATION SOURCES (be specific): Appraisal Card, Ownership Card, Lot and Block Books, Obituary Index, Daily Sentinel Newspaper, Grand Junction City Directories, 1981 Historic Survey of Grand Junction.

SIGNIFICANCE (check appropriate categories)

Architectural significance:

- represents the work of a master
 possess high artistic value
 represents a type, period, or method of construction

Historical significance:

- associated with significant person(s)
 associated with significant event
 associated with a pattern of events
 contributes to an historic district

National Register eligibility:

- Individual yes no
Criteria: A B C D
Area(s) of significance: Architecture

Contributes to a potential district:

- yes no
District name:

THEME(S):

Period of significance: 1923

STATEMENT OF SIGNIFICANCE (briefly justify the significance checked above): This Bungalow, with an unusual exposed, high concrete foundation. Although not eligible for the National Register, this house may contribute to a local register or conservation district.

INVENTORY COMPLETED BY: Museum Group Staff

DATE: 2/14/96

AFFILIATION: Museum of Western Colorado

PHONE: (970) 241-9117

ADDRESS: PO Box 20000-5020, Grand Junction, Colorado 81502-5020

PROJECT NAME: Grand Junction Historic Resources Survey, Phase 2



1202 Grand Ave.
Grand Junction, Mesa Co, CO
2945-132-22-009
SME7500

10/05/1995
Roll 4 Frame 6
View S Dir N/NE
SME7500