

COLORADO HISTORICAL SOCIETY
 Office of Archaeology and Historic Preservation
 1300 Broadway Denver, CO 80203

SITE no.: 5ME7555

HISTORIC BUILDING INVENTORY

Eligible for National Register yes no
 date _____ initials _____
 Criteria A B C D
 Contributes to a potential National Register district
 yes no district name: _____

COUNTY: Mesa CITY: Grand Junction

Eligible for State Register yes no
 date _____ initials _____
 Criteria a b c d e
 Areas of significance: _____

HISTORIC BUILDING NAME: Cavanaugh, Jas., House

Period of significance _____
 Needs data date _____ initials _____

CURRENT BUILDING NAME: Gross Residence

LOCAL LANDMARK DESIGNATION: [] yes [X] no

ADDRESS: 1315 Rood Ave., Grand Junction, CO 81501-4524

Date of designation: N/A
 Designating authority: N/A

OWNER NAME & ADDRESS: John R. Gross, 1315 Rood Ave., Grand Junction, CO 81501-4524

P.M.: UTE township: 1S range: 1W
 NE 1/4 of SW 1/4 of NW 1/4 of SW 1/4 of section 13

UTM REFERENCE-12
 Easting: 711930
 Northing: 4328925

USGS QUAD NAME: Grand Junction
 Year: 1962; photorevised 1973 [X] 7.5' [] 15'

STYLE: Bungalow

Block: H
 Lot(s): 5-8
 Addition: Keith
 Year of addition: 1890

BUILDING TYPE:

[X] original location [] moved
 Date of moves(s): _____

MATERIALS: Concrete Foundation; Wood Frame; Asphalt Shingle Roof

HISTORIC USE: Domestic
 PRESENT USE: Domestic

STORIES: 1

SQUARE FOOTAGE: 832

DATE OF CONSTRUCTION- estimate: 1925 actual:
 Source of information: Tax Assessor's Records

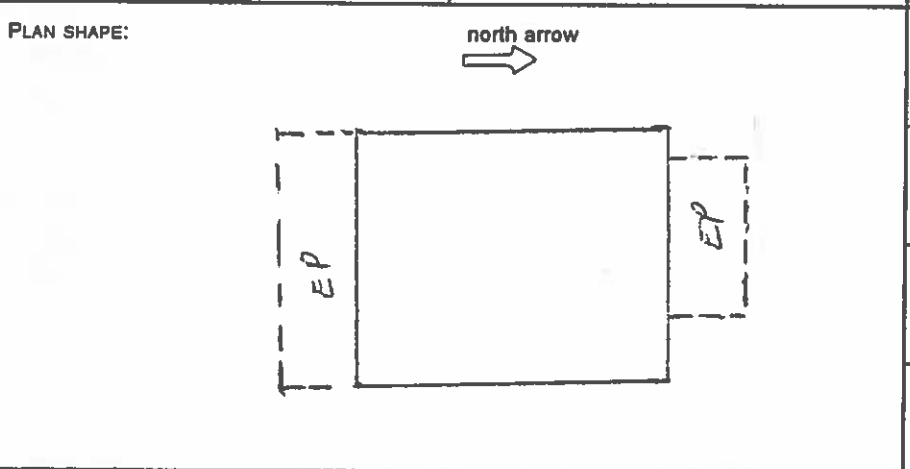

ARCHITECT: Unknown
 Source of information: _____

BUILDER/CONTRACTOR: Unknown
 Source of information: _____

ORIGINAL OWNER: Jas. Cavanaugh
 Source of information: Lot and Block Books

ASSOCIATED BUILDINGS- [] yes [X] no
 Type: _____

ARCHITECTURAL DESCRIPTION: One story with front gable and battered foundation. Concrete steps with wrought iron railings lead to front porch/sunroom with dropped gable. Siding on half-wall. Windows are double hung wood sash, one-over-one. False bevel siding with blue trim. Gray composition shingle roof with brick chimney on west slope. Bargeboards with shaped tails.
Landscaped with lawn, annual beds along front walk, and two blue ash trees in parking area.

PHOTOGRAPHS (include photographs showing each side of building and any associated buildings)

Film roll no.: 6
Negative no.: 1

Photographer: Carolyn Howard
Location of negatives: City Of Grand Junction

CONSTRUCTION HISTORY (include description and dates of major additions, alterations, or demolitions): Additional construction or modifications not noted in Assessor's Records.

HISTORICAL BACKGROUND (discuss important persons and events associated with this building): The first residents/owners of this house, constructed ca. 1925, were Josephine and James Cavanaugh, a State Highway worker. Dorothy and Harold Randall, a chemist and later a chemical company owner, resided there from only ca. 1926-1930, but continued to own it until ca. 1937. Tenants included two different public service employees, between 1930-1931; Herman Koch, secretary-treasurer of Rose Arctic Ice Cream and Bottling Company, ca. 1935; Rex E. Richards, commercial supervisor for Mountain States Telephone and Telegraph Co., ca. 1937-1940; and Harold Ragan, a bookkeeper for the Daily Sentinel, from ca. 1941-1946.

INFORMATION SOURCES (be specific): Appraisal Card, Ownership Card, Lot and Block Books, Grand Junction City Directories, 1981 Historic Survey of Grand Junction.

SIGNIFICANCE (check appropriate categories)

Architectural significance:
 represents the work of a master
 possess high artistic value
 represents a type, period, or method of construction

Historical significance:
 associated with significant person(s)
 associated with significant event
 associated with a pattern of events
 contributes to an historic district

National Register eligibility:
Individual yes no
Criteria: A B C D
Area(s) of significance: Architecture

Contributes to a potential district:
yes no
District name:

Period of significance: 1918

THEME(S):

STATEMENT OF SIGNIFICANCE (briefly justify the significance checked above): A Bungalow with traditional design and a non-traditional canvas awning over front door. Although not eligible for the National Register, this house may contribute to a local register.

INVENTORY COMPLETED BY: Museum Group Staff

DATE: 2/14/96

AFFILIATION: Museum of Western Colorado

PHONE: (970) 241-9117

ADDRESS: PO Box 20000-5020, Grand Junction, Colorado 81502-5020

PROJECT NAME: Grand Junction Historic Resources Survey, Phase 2



1315 Rood Ave.
Grand Junction, Mesa Co, CO
2945-133-11-003
5ME7555

10/05/1995
Roll 6 Frame 1
View N Dir SE
5ME7555

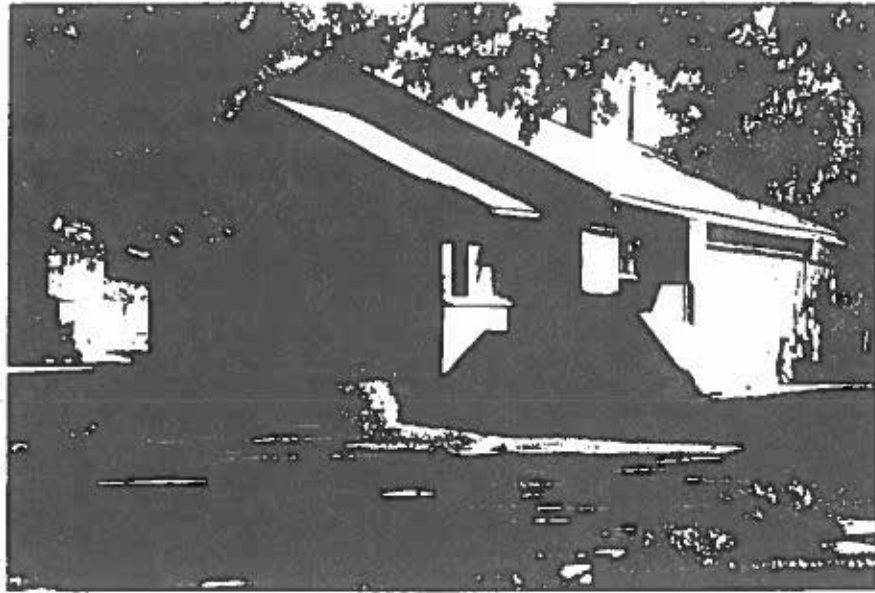

1315 Rood Ave.
Grand Junction, Mesa Co, CO
2945-133-11-003
SME7555