

**COLORADO HISTORICAL SOCIETY**  
 Office of Archaeology and Historic Preservation  
 1300 Broadway Denver, CO 80203

SITE NO.: 5ME7587

**HISTORIC BUILDING INVENTORY**

Eligible for National Register  yes  no  
 date \_\_\_\_\_ initials \_\_\_\_\_

Criteria  A  B  C  D

Contributes to a potential National Register district  
 yes  no district name: \_\_\_\_\_

Eligible for State Register  yes  no  
 date \_\_\_\_\_ initials \_\_\_\_\_

Criteria  a  b  c  d  e

Areas of significance: \_\_\_\_\_

COUNTY: Mesa

CITY: Grand Junction

Period of significance \_\_\_\_\_

Needs data  date \_\_\_\_\_ initials \_\_\_\_\_

HISTORIC BUILDING NAME: Groom, Dr. R.J., House

LOCAL LANDMARK DESIGNATION: [ ] yes [X] no

Date of designation: N/A

Designating authority: N/A

CURRENT BUILDING NAME:

ADDRESS: 1245 Chipeta Ave., Grand Junction, CO 81501-4435

P.M.: UTE township: 1S range: 1W  
 SW ¼ of NW ¼ of SW¼ of NW¼ of section 13

OWNER NAME & ADDRESS: Geoffrey G. Marsh, 1245 Chipeta Ave., Grand Junction, CO 81501-4435

UTM REFERENCE-12

Easting: 711880

Northing: 4327450

USGS QUAD NAME: Grand Junction

Year: 1962; photorevised 1973 [X] 7.5' [ ] 15'

STYLE: Colonial Revival

Block: 1

Lot(s): 11-12

Addition: Dundee Place

Year of addition: 1909

BUILDING TYPE:

[X] original location [ ] moved

Date of moves(s): \_\_\_\_\_

MATERIALS: Concrete Foundation; Wood Frame; Wood Siding; Asphalt Shingle Roof

HISTORIC USE: Domestic

PRESENT USE: Domestic

STORIES: 1

SQUARE FOOTAGE: 1186

DATE OF CONSTRUCTION- estimate: 1930 actual: \_\_\_\_\_

Source of information: Tax Assessor's Records

PLAN SHAPE:

north arrow

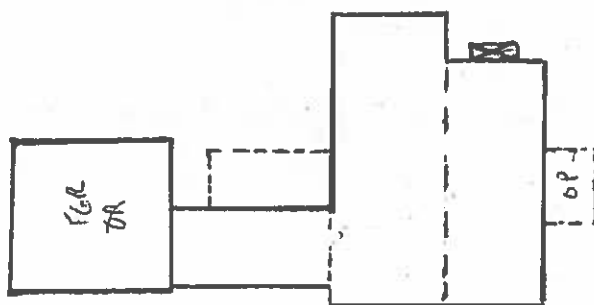

ARCHITECT: Unknown

Source of information: \_\_\_\_\_

BUILDER/CONTRACTOR: Unknown

Source of information: \_\_\_\_\_

ORIGINAL OWNER: R. H. and Henrietta Houdashelt

Source of information: Lot and Block Books

ASSOCIATED BUILDINGS- [X] yes [ ] no

Type: Garage

**ARCHITECTURAL DESCRIPTION:** One story with side gables. Concrete foundation and wide concrete front steps with wrought iron railings. Concrete front porch which has gabled portico with cornice returns. Two full length Tuscan columns with cushioned capitals and bases support the portico. White storm door has wrought iron ornamental grille. Front door is paneled. Symmetrical facade has a ribbon of three casement windows on each side with eight lights, other windows around house are double hung wood sash, six over one. White louvered shutters on facade and west elevation. Siding is grey clapboard. Storm windows. Foundation, steps and porch are dark grey. Door and windows surrounds, cornices, return cornices and columns are light grey. Grey composition shingle roof with raking cornices and cornice returns. Brick fireplace chimney on west gable wall with another brick chimney on east ridge.

Landscaped with lawn and sill high evergreens across facade with most of lower branches exposed, trimmed almost like bonsai. Maple on west lawn, ash in parking. Brown wood fence around back yard.

Two car garage is immediately behind house. Flat roof. Single wide garage door is sectioned and rolls upward. Garage and door are gray. Clapboard siding on garage looks newer than house.

**PHOTOGRAPHS (include photographs showing each side of building and any associated buildings)**

Film roll no.: 8  
Negative no.: 2

Photographer: Carolyn Howard  
Location of negatives: City Of Grand Junction

**CONSTRUCTION HISTORY (include description and dates of major additions, alterations, or demolitions):** Metal frame storm door and windows. In 1992, an open porch at the rear of the house was replaced by a finished garage.

**HISTORICAL BACKGROUND (discuss important persons and events associated with this building):** Residence of Robert Houdasheit of Cities Oil from 1931-1935. Physician Robert J. Groom made his home here from 1936-1941. By 1946, it was the residence of Loren Doyce and Ruby Harper. Mrs. Harper was a music teacher.

**INFORMATION SOURCES (be specific):** Appraisal Card, Ownership Card, Lot and Block Books, Grand Junction City Directories, 1981 Historic Survey of Grand Junction.

**SIGNIFICANCE (check appropriate categories)**

**Architectural significance:**  
 represents the work of a master  
 possess high artistic value  
 represents a type, period, or method of construction

**Historical significance:**  
 associated with significant person(s)  
 associated with significant event  
 associated with a pattern of events  
 contributes to an historic district

**National Register eligibility:**  
 Individual  yes  no  
 Criteria:  A  B  C  D  
 Area(s) of significance: Architecture; Social History

**Contributes to a potential district:**  
 yes  no  
 District name: Merchant/Professional Residential

Period of significance: 1930; 1904-1940

THEME(S):

**STATEMENT OF SIGNIFICANCE (briefly justify the significance checked above):** This symmetrical house has a Williamsburg appearance. The colonial details, such as the entry, are larger than the more austere New England examples. This house is located in the proposed Merchant/Professional Residential District. Between 1904 and 1940, the city of Grand Junction expanded to the east of the original square mile. Merchants and professionals settled into this area creating a distinctive neighborhood.

INVENTORY COMPLETED BY: Museum Group Staff

DATE: 2/14/96

AFFILIATION: Museum of Western Colorado

PHONE: (970) 241-9117

ADDRESS: PO Box 20000-5020, Grand Junction, Colorado 81502-5020

PROJECT NAME: Grand Junction Historic Resources Survey, Phase 2



1245 Chipeta Ave.  
Grand Junction, Mesa Co, CO  
2945-133-09-005  
5ME7587

11/03/1995  
Roll 8 Frame 2  
View n Dir SE  
5ME7587



1245 Chipeta Ave.  
Grand Junction, Mesa Co, CO  
2945-133-09-005  
5ME7587