

**COLORADO HISTORICAL SOCIETY**  
 Office of Archaeology and Historic Preservation  
 1300 Broadway Denver, CO 80203

**HISTORIC BUILDING INVENTORY**

SITE NO.: 5ME7620

Eligible for National Register  yes  no  
 date \_\_\_\_\_ initials \_\_\_\_\_  
 Criteria  A  B  C  D  
 Contributes to a potential National Register district  
 yes  no district name: \_\_\_\_\_

Eligible for State Register  yes  no  
 date \_\_\_\_\_ initials \_\_\_\_\_  
 Criteria  a  b  c  d  e  
 Areas of significance: \_\_\_\_\_

Period of significance \_\_\_\_\_  
 Needs data  date \_\_\_\_\_ initials \_\_\_\_\_

LOCAL LANDMARK DESIGNATION:  yes  no

Date of designation: N/A  
 Designating authority: N/A

P.M.: UTE township: 1S range:1W  
 SE 1/4 of SW 1/4 of SW 1/4 of section 24

UTM REFERENCE-12  
 Easting: 712140  
 Northing: 4324880

USGS QUAD NAME: Grand Junction

Year: 1962; photorevised 1973  7.5'  15'

Block: None  
 Lot(s): Beg 830'E +228'N of SWcorner24 1S 1W N66'  
 E125' S66' W to Beg. + part lot 5  
 Addition:  
 Year of addition:

original location  moved

Date of moves(s):

HISTORIC USE: Domestic

PRESENT USE: Domestic

DATE OF CONSTRUCTION- estimate: 1938 actual:  
 Source of information: Tax Assessor's Records

ARCHITECT: Unknown

Source of information:

BUILDER/CONTRACTOR: Unknown

Source of information:

ORIGINAL OWNER: Fred G. Olson

Source of information: Lot and Block

ASSOCIATED BUILDINGS-  yes  no

Type:

COUNTY: Mesa

CITY: Grand Junction

HISTORIC BUILDING NAME: Olson, Fred, House

CURRENT BUILDING NAME: Rushing Residence

ADDRESS: 304 Cedar St., Grand Junction, CO 81503-2014

OWNER NAME & ADDRESS: Mary M. Rushing, 304 Cedar St., Grand Junction, CO 81503-2014

STYLE: Minimal Traditional

BUILDING TYPE:

MATERIALS: Concrete Foundation; Wood Frame; Asphalt Shingle Roof

STORIES: 1

SQUARE FOOTAGE: 898

PLAN SHAPE:

north arrow

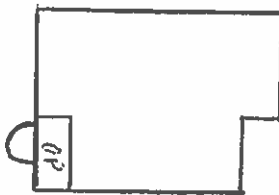
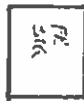

**ARCHITECTURAL DESCRIPTION:** One story with cross gables. Concrete steps in semi-circular shape lead to inset, open porch under principal roof on the south half of facade. Corner square columns are flanked by trellises with segmental arches between each trellis. Screen door over paneled front door with three vertical lights. Windows are double hung wood sash, four-over-one. Gray lapped siding with white window and door surrounds, front door, porch columns, lattice, arches, comices, and cornice returns. Green composition shingle roof. Gable on north facade slope. Brick chimney on east slope.

Pfizers along front foundation. Woodbine on south wall and on much of fence. Small oaks, crab apple, fruit trees on lawn. Chain link fence encompasses property.

Small frame storage buildings in rear of yard with same siding and roof as main house.

**PHOTOGRAPHS (include photographs showing each side of building and any associated buildings)**

Film roll no.: 9  
Negative no.: 19

Photographer: Carolyn Howard  
Location of negatives: City Of Grand Junction

**CONSTRUCTION HISTORY (include description and dates of major additions, alterations, or demolitions):** Additional construction or modifications not noted in Assessor's Records.

**HISTORICAL BACKGROUND (discuss important persons and events associated with this building):** Orchard Mesa is a triangle of desert land between the Gunnison and Colorado Rivers and the Grand Mesa. By 1890, orchards were planted by homesteaders as they settled into the area. Today, the orchards are receding under the pressure of subdivisions. Constructed ca. 1938, the property was owned by Fred G. and Emma Olson (occupation not listed). The Olsons, who had resided on Orchard Mesa since ca. 1936, may have been the first occupants. Through the early 1950s it is difficult to determine where residents lived on Orchard Mesa as numbered street addresses did not appear in the Grand Junction City Directories with any regularity. Grand Junction did not begin to annex Orchard Mesa into the City until 1968.

**INFORMATION SOURCES (be specific):** Plat Map, Appraisal Card, Ownership Card, Lot and Block Books, Grantor and Grantee Indexes, Grand Junction City Directories.

**SIGNIFICANCE (check appropriate categories)**

**Architectural significance:**  
 represents the work of a master  
 possess high artistic value  
 represents a type, period, or method of construction

**Historical significance:**  
 associated with significant person(s)  
 associated with significant event  
 associated with a pattern of events  
 contributes to an historic district

**National Register eligibility:**  
Individual  yes  no  
Criteria:  A  B  C  D  
Area(s) of significance: Architecture

**Contributes to a potential district:**  
 yes  no  
District name:

Period of significance: 1938

THEME(S):

**STATEMENT OF SIGNIFICANCE (briefly justify the significance checked above):** A Minimal Traditional style house. The porch, with columns, trellises, and segmental arches, gives the facade distinction. Although not eligible for the National Register, this house may contribute to a local register.

INVENTORY COMPLETED BY: Museum Group Staff

DATE: 2/14/96

AFFILIATION: Museum of Western Colorado

PHONE: (970) 241-9117

ADDRESS: PO Box 20000-5020, Grand Junction, Colorado 81502-5020

PROJECT NAME: Grand Junction Historic Resources Survey, Phase 2



304 Cedar St.  
Grand Junction, Mesa Co, CO  
2945-243-00-257  
5ME7620

11/01/1995  
Roll 9 Frame 19  
View W Dir N/NE  
5ME7620





304 Cedar St.  
Grand Junction, Mesa Co, CO  
2945-243-00-257  
SME7620