

COLORADO HISTORICAL SOCIETY
Office of Archaeology and Historic Preservation
1300 Broadway Denver, CO 80203

HISTORIC BUILDING INVENTORY

SITE NO.: 5ME7717

Eligible for National Register yes no
date _____ initials _____
Criteria A B C D
Contributes to a potential National Register district
 yes no district name: _____

Eligible for State Register yes no
date _____ initials _____
Criteria a b c d e
Areas of significance: _____

COUNTY: Mesa

CITY: Grand Junction

HISTORIC BUILDING NAME: Wynkoop, E.H., House

Period of significance _____
Needs data date _____ initials _____

CURRENT BUILDING NAME: Matlock Residence

LOCAL LANDMARK DESIGNATION: yes no

ADDRESS: 742 Ute Ave., Grand Junction, CO 81501-3646

Date of designation: N/A
Designating authority: N/A

OWNER NAME & ADDRESS: Blanche H. Matlock, 742 Ute Ave., Grand Junction, CO 81501-3646

P.M.: UTE township: 1S range:1W
NE 1/4 of NW 1/4 of SW 1/4 of SE 1/4 of section 14

UTM REFERENCE-12
Easting: 711175
Northing: 4326670

USGS QUAD NAME: Grand Junction

Year: 1982; photorevised 1973 7.5' 15'

STYLE: Vernacular Wood Frame

Block: 128
Lot(s): 22 - 23
Addition:
Year of addition:

BUILDING TYPE:

original location moved

Date of moves(s):

MATERIALS: Concrete Foundation; Wood Frame; Asphalt Shingle Roof

HISTORIC USE: Domestic

PRESENT USE: Domestic

STORIES: 1

SQUARE FOOTAGE: 930

DATE OF CONSTRUCTION- estimate: 1910 actual:
Source of information: Tax Assessor's Records

PLAN SHAPE:

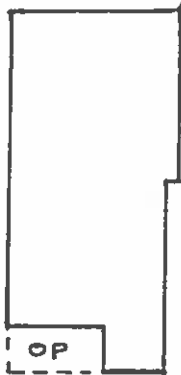

north arrow

ARCHITECT: Unknown

Source of information:

BUILDER/CONTRACTOR: Unknown

Source of information:

ORIGINAL OWNER: Dick Mills

Source of information: Lot And Block Books

ASSOCIATED BUILDINGS- yes no

Type:

ARCHITECTURAL DESCRIPTION: One story with front gable. Concrete stoop. Gabled portico over entry with knee braces. Flush front door with three diamond lights. Symmetrical facade has a pair of six light casement windows on east and west of facade. Other windows around house are casement, or double hung wood sash, one-over-one. Yellow simple drop siding. Door and window surrounds, portico bargeboards and knee braces, and front screen door are brown. Composition shingle roof with pointed bargeboard ends. Brick chimney on west slope.

Two front walks curve across lawn toward sidewalk. Large lilac on east facade. Chain link fence along east lawn has trellis with silverlace vine. Maple on west lawn, evergreens along west lawn edge. Ash tree in parking and wire fence around back yard.

Square concrete ash pit by alley.

PHOTOGRAPHS (include photographs showing each side of building and any associated buildings)

Film roll no.: 14
 Negative no.: 3

Photographer: Carolyn Howard
 Location of negatives: City Of Grand Junction

CONSTRUCTION HISTORY (Include description and dates of major additions, alterations, or demolitions): Open porch to enclosed porch, date undetermined. Paired six light wood casement windows during porch modification.

HISTORICAL BACKGROUND (discuss important persons and events associated with this building): This house has had a succession of absentee owners and tenants since its construction.

INFORMATION SOURCES (be specific): Plat Map, Appraisal Card, Lot and Block Books, Grand Junction City Directories.

SIGNIFICANCE (check appropriate categories)

Architectural significance:
 represents the work of a master
 possess high artistic value
 represents a type, period, or method of construction

Historical significance:
 associated with significant person(s)
 associated with significant event
 associated with a pattern of events
 contributes to an historic district

National Register eligibility:
 Individual yes no
 Criteria: A B C D
 Area(s) of significance: Architecture

Contributes to a potential district:
yes no
 District name:

Period of significance: 1910

THEME(S):

STATEMENT OF SIGNIFICANCE (briefly justify the significance checked above): A Vernacular Wood Frame house with a few bungalow features as seen in the portico and casement windows. Drop siding and one-over-one windows are vernacular. Although not eligible for the National Register, this house may contribute to a local register.

INVENTORY COMPLETED BY: Museum Group Staff

DATE: 2/14/96

AFFILIATION: Museum of Western Colorado

PHONE: (970) 241-9117

ADDRESS: PO Box 20000-5020, Grand Junction, Colorado 81502-5020

PROJECT NAME: Grand Junction Historic Resources Survey, Phase 2



742 Ute Ave.,
Grand Junction, Mesa Co, CO
2945-144-29-014
SME7717

11/07/1995
Roll 14 Frame 3
View S Dir N/NE
SME7717



742 Ute Ave.,
Grand Junction, Mesa Co, CO
2945-144-29-014
5ME7717