

COLORADO HISTORICAL SOCIETY
 Office of Archaeology and Historic Preservation
 1300 Broadway Denver, CO 80203

HISTORIC BUILDING INVENTORY

SITE NO.: 5ME7758

Eligible for National Register yes no
 date _____ initials _____
 Criteria A B C D
 Contributes to a potential National Register district
 yes no district name: _____

COUNTY: Mesa

CITY: Grand Junction

Eligible for State Register yes no
 date _____ initials _____
 Criteria a b c d e
 Areas of significance: _____

HISTORIC BUILDING NAME: Blaisdell, Frank, House

Period of significance _____
 Needs data _____ date _____ initials _____

CURRENT BUILDING NAME:

LOCAL LANDMARK DESIGNATION: yes no

ADDRESS: 742 Teller Ave., Grand Junction, CO 81501-3238

Date of designation: N/A
 Designating authority: N/A

OWNER NAME & ADDRESS: Dewayne Roberts, 2865 Belford Ave., Grand Junction, CO 81501-5032

P.M.: UTE township: 1S range:1W
 SE ¼ of NW ¼ of NW¼ of NE¼ of section 14

UTM REFERENCE-12
 Easting: 711120
 Northing: 4327810

USGS QUAD NAME: Grand Junction

Year: 1962; photorevised 1973 7.5' 15'

STYLE: Vernacular Wood Frame

Block: 18
 Lot(s): 24 and E24.4' of 25
 Addition:
 Year of addition:

BUILDING TYPE:

original location moved

Date of moves(s):

MATERIALS: Concrete Foundation - Wood Frame - Asphalt Shingle Roof

HISTORIC USE: Domestic

PRESENT USE: Domestic

STORIES: 2

SQUARE FOOTAGE: 792

DATE OF CONSTRUCTION- estimate: 1911 actual:
 Source of information: Tax Assessor's Records

PLAN SHAPE:

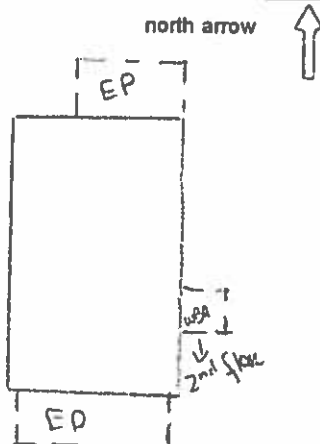

ARCHITECT: Unknown

Source of information:

BUILDER/CONTRACTOR: Unknown

Source of information:

ORIGINAL OWNER: F.E. Blaisdell

Source of information: Lot and Block

ASSOCIATED BUILDINGS- yes no

Type:

ARCHITECTURAL DESCRIPTION: Two story with front gable. Concrete block foundation. Concrete piers and steps lead up to sunporch/entry with hip roof extending across facade. Porch half-wall has siding. Four, 6 x 6 half columns are placed along porch facade. Glazing is large fixed sash windows, one-over-one. Small pedimented cross gable over porch door. French door on porch and another French door inside porch. Wood stairway on east elevation leads to upstairs apartment. Windows are double hung wood sash, one-over-one. Windows of second story facade have plank shutters. Siding is yellow asbestos shingles. Narrow door and window casings, shutters, porch posts and cornices are brown. Gray composition shingle roof with cornices.

Landscaped with lawn, large evergreens by facade, three elm trees, and lilacs. Wood fence around back yard.

PHOTOGRAPHS (include photographs showing each side of building and any associated buildings)

Film roll no.: 18
Negative no.: 9

Photographer: Carolyn Howard
Location of negatives: City Of Grand Junction

CONSTRUCTION HISTORY (include description and dates of major additions, alterations, or demolitions): In 1988, this single family residence was modified to a duplex and a wood deck added to the side of the building. Asbestos siding.

HISTORICAL BACKGROUND (discuss important persons and events associated with this building): Constructed ca. 1911, the first known occupants were Iona and Frank Blaisdell who resided in the house ca. 1916-1932. With the exception of two years, ca. 1916-1917 when it was owned by the Mesa County Building and Loan, the Blaisdells owned the house from ca. 1911-1939. The residence was either a rental or vacant from ca. 1939-1944. Reba DaLee, widow of George and a visitor for the County Department of Welfare, was the owner/occupant in 1946.

INFORMATION SOURCES (be specific): Plat Map, Appraisal Card, Lot and Block Books, Grand Junction City Directories.

SIGNIFICANCE (check appropriate categories)

Architectural significance:

- represents the work of a master
 possess high artistic value
 represents a type, period, or method of construction

Historical significance:

- associated with significant person(s)
 associated with significant event
 associated with a pattern of events
 contributes to an historic district

National Register eligibility:

Individual yes no

Criteria: A B C D

Area(s) of significance: Architecture

Contributes to a potential district:

yes no

District name:

Period of significance: 1911

THEME(s):

STATEMENT OF SIGNIFICANCE (briefly justify the significance checked above): A vernacular building with siding from the 1940s. Although not eligible for the National Register, this house may contribute to a local register.

INVENTORY COMPLETED BY: Museum Group Staff

DATE: 2/14/96

AFFILIATION: Museum of Western Colorado

PHONE: (970) 241-9117

ADDRESS: PO Box 20000-5020, Grand Junction, Colorado 81502-5020

PROJECT NAME: Grand Junction Historic Resources Survey, Phase 2



742 Teller Ave.
Grand Junction, Mesa Co, CO
2945-141-11-012
5ME7758

01/12/1996
Roll 18 Frame 09
View S Dir N/NE
5ME7758



742 Teller Ave.
Grand Junction, Mesa Co, CO
2945-141-11-012
5ME7758