

**COLORADO HISTORICAL SOCIETY**  
 Office of Archaeology and Historic Preservation  
 1300 Broadway Denver, CO 80203

**HISTORIC BUILDING INVENTORY**

SITE NO.: 5ME7761

Eligible for National Register  yes  no  
 date \_\_\_\_\_ initials \_\_\_\_\_  
 Criteria  A  B  C  D  
 Contributes to a potential National Register district  
 yes  no district name: \_\_\_\_\_

COUNTY: Mesa

CITY: Grand Junction

Eligible for State Register  yes  no  
 date \_\_\_\_\_ initials \_\_\_\_\_  
 Criteria  a  b  c  d  e  
 Areas of significance: \_\_\_\_\_

HISTORIC BUILDING NAME: Sparks, J.W., House

Period of significance \_\_\_\_\_  
 Needs data  date \_\_\_\_\_ initials \_\_\_\_\_

CURRENT BUILDING NAME: Gordon Residence

LOCAL LANDMARK DESIGNATION:  yes  no

ADDRESS: 761 Teller Ave., Grand Junction, CO 81501-3238

Date of designation: N/A  
 Designating authority: N/A

P.M.: UTE township: 1S range: 1W  
 NE 1/4 of SW 1/4 of NW 1/4 of NE 1/4 of section 14

OWNER NAME & ADDRESS: James Gordon, 761 Teller Ave., Grand Junction, CO 81501-3238

UTM REFERENCE-12  
 Easting: 711170  
 Northing: 4327770

USGS QUAD NAME: Grand Junction

Year: 1962; photorevised 1973  7.5'  15'

STYLE: Classic Cottage

Block: 27  
 Lot(s): 18 - 19  
 Addition:  
 Year of addition:

BUILDING TYPE:

original location  moved

Date of moves(s):

MATERIALS: Concrete Foundation - Wood Frame - Asphalt Single Roof

HISTORIC USE: Domestic

PRESENT USE: Domestic

STORIES: 1

SQUARE FOOTAGE: 866

DATE OF CONSTRUCTION- estimate: 1924 actual:  
 Source of information: Tax Assessor's Records

PLAN SHAPE:

north arrow

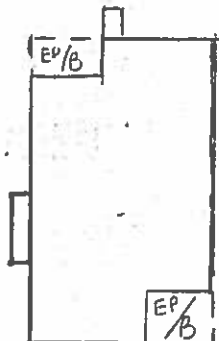

ARCHITECT: Unknown

Source of information:

BUILDER/CONTRACTOR: Unknown

Source of information:

ORIGINAL OWNER: J.W. Sparks

Source of information: Lot and Block

ASSOCIATED BUILDINGS-  yes  no

Type:

**ARCHITECTURAL DESCRIPTION:** One story with hip roof. Battered foundation. Concrete steps lead up to enclosed sunporch/entry integral in west side of facade. Porch is glazed with two single light windows with two and four light transoms atop them on facade and west elevation. Storm door. Front door inside porch is French. Windows on facade are pairs of single light casements. Windows around house are double hung wood sash, one-over-one. Projecting bay window on east elevation has a pedimented gable. Gray narrow lapped siding. Door and window surrounds, cornices and friezes are yellow. Gray composition shingle roof with boxed eaves. Hip roof dormer on north slope has three single light windows. Yellow brick chimney on ridge. Landscaped with lawn and small willow trees. Chain link fence around front lawn.

**PHOTOGRAPHS (include photographs showing each side of building and any associated buildings)**

Film roll no.: 18  
Negative no.: 7

Photographer: Carolyn Howard  
Location of negatives: City Of Grand Junction

**CONSTRUCTION HISTORY (include description and dates of major additions, alterations, or demolitions):** Storm door. Additional construction or modifications not noted in Assessor's records.

**HISTORICAL BACKGROUND (discuss important persons and events associated with this building):** From its construction in ca. 1924-1940, this residence was owned/occupied by Eva T. and James M. Sparks, Grand Valley Auto. The Sparks continued to own the house, but were using it as a rental property from ca. 1941 through 1949.

**INFORMATION SOURCES (be specific):** Plat Map, Appraisal Card, Lot and Block Books, Grand Junction City Directories.

**SIGNIFICANCE (check appropriate categories)**

**Architectural significance:**

- represents the work of a master  
 possess high artistic value  
 represents a type, period, or method of construction

**Historical significance:**

- associated with significant person(s)  
 associated with significant event  
 associated with a pattern of events  
 contributes to an historic district

**National Register eligibility:**

Individual  yes  no

Criteria:  A  B  C  D

Area(s) of significance: Architecture

**Contributes to a potential district:**

yes no  
District name:

**THEME(S):**

Period of significance: 1924

**STATEMENT OF SIGNIFICANCE (briefly justify the significance checked above):** The date of construction, 1924, is beyond range of the normal Classic Cottage period. The floorplan, roof and dormers illustrate Classic Cottage features and the siding and foundation details reflect a traditional Bungalow style. Although not eligible for the National Register, this house may contribute to a local register.

**INVENTORY COMPLETED BY:** Museum Group Staff

**DATE:** 2/14/96

**AFFILIATION:** Museum of Western Colorado

**PHONE:** (970) 241-9117

**ADDRESS:** PO Box 20000-5020, Grand Junction, Colorado 81502-5020

**PROJECT NAME:** Grand Junction Historic Resources Survey, Phase 2



761 White Ave.  
Grand Junction, Mesa Co, CO  
2945-144-08-006  
5ME7786

01/12/1996  
Roll 16 Frame 24  
View N Dir SW  
5ME7786



761 Teller Ave.  
Grand Junction, Mesa Co, CO  
2945-141-14-005  
SME7761