

COLORADO HISTORICAL SOCIETY
 Office of Archaeology and Historic Preservation
 1300 Broadway Denver, CO 80203

HISTORIC BUILDING INVENTORY

SITE NO.: 5ME7783

Eligible for National Register yes no
 date _____ initials _____
 Criteria A B C D
 Contributes to a potential National Register district
 yes no district name: _____

COUNTY: Mesa CITY: Grand Junction

Eligible for State Register yes no
 date _____ initials _____
 Criteria a b c d e
 Areas of significance: _____

HISTORIC BUILDING NAME: Vincent, Merle D., House

Period of significance _____
 Needs data date _____ initials _____

CURRENT BUILDING NAME: Salvation Army Center

LOCAL LANDMARK DESIGNATION: [] yes [X] no
 Date of designation: N/A
 Designating authority: N/A

ADDRESS: 903 Grand Ave., Grand Junction, CO 81501-3426

P.M.: UTE township: 1S range:1W
 NE ¼ of NE ¼ of NW¼ of SE¼ of section 14

OWNER NAME & ADDRESS: Salvation Army, PO Box 578, Grand Junction, CO 81502-0578

UTM REFERENCE-12
 Easting: 711360
 Northing: 4327210

USGS QUAD NAME: Grand Junction
 Year: 1962; photorevised 1973 [X] 7.5' [] 15'

STYLE: Edwardian

Block: 86
 Lot(s): 1 - 4
 Addition:
 Year of addition:

BUILDING TYPE:

[X] original location [] moved
 Date of moves(s):

MATERIALS: Concrete Block Foundation - Wood Frame - Asphalt Shingle Roof

HISTORIC USE: Domestic
 PRESENT USE: Domestic

STORIES: 2

SQUARE FOOTAGE: 1239

DATE OF CONSTRUCTION- estimate: 1904 actual:
 Source of information: Tax Assessor's Records

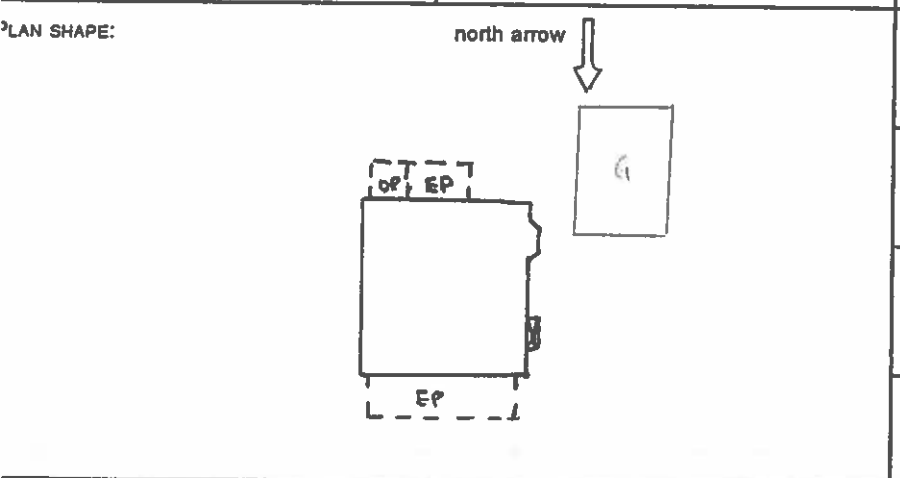

ARCHITECT: Unknown
 Source of information:

BUILDER/CONTRACTOR: Unknown
 Source of information:

ORIGINAL OWNER: Frank and Margaret Haskell
 Source of information: Lot and Block

ASSOCIATED BUILDINGS- [X] yes [] no
 Type: 2 Car Garage

ARCHITECTURAL DESCRIPTION: Two story with hip roof. Concrete block foundation. Concrete steps with pipe and wrought iron railing lead up to sunporch/entry with hip roof, extending across seven-eighths of facade. Segmental arc roof portico with knee braces over steps. French door is entry onto porch. Storm door. Porch half-wall has gray narrow lapped siding and four paneled wood piers with squared half columns. Porch glazing is fixed sash with multiple panes with metal framed storm windows. Front door inside porch is paneled with three vertical lights of beveled glass, flanked by tall single pane sidelights. Windows are double hung wood sash. First and second story windows on facade and east and west elevations are transom. The transoms have leaded panes in a lozenge pattern. South elevation has transom windows with one-over-one configuration. All siding is light gray. First floor siding is narrow lapped with a slight flare at base. Second floor siding is gray cedar shingles. The lowest courses are also flared, near a narrow string course atop the first floor siding. Two hip roof dormers on the north and west slopes also have gray flared cedar shingle walls. Two single pane lights in each dormer. Door and window surrounds, columns, friezes and cornices are medium gray. Light gray composition shingle roof. Principal roof, dormers and porch all have exposed, rounded rafter ends. Yellow brick full height fireplace chimney on the west elevation. Brick chimney on the south slope. Orange steel fire escape stairs now on west elevation. Landscaped with front lawn, a mulberry bush on east lawn, and evergreens on west facade. Chain link fence around backyard. Elm trees in gravel parking area. Two car garage at rear with side hip on gables, white simple drop siding, light gray composition roll roofing and batten swinging doors.

PHOTOGRAPHS (include photographs showing each side of building and any associated buildings)

Film roll no.: 17
 Negative no.: 11

Photographer: Carolyn Howard
 Location of negatives: City Of Grand Junction

CONSTRUCTION HISTORY (include description and dates of major additions, alterations, or demolitions): Metal fire escape, storm windows. Additional construction or modifications not noted in Assessor's records.

HISTORICAL BACKGROUND (discuss important persons and events associated with this building): This first owners/occupants of this house were Margaret and Frank Haskell, a bookkeeper, who lived there ca. 1909-1917. The most significant resident was Merle D. Vincent, an attorney who owned/resided in the house ca. 1922-1935. Vincent, Merle D. Born: 15 Dec. 1876; Died: 6 March 1958; Married: Berta Dell Chambers (1); Helen B. Russell (2); Children: Craig S., Merle D. Jr., William C., and Douglas H. In 1924, when the Ku Klux Klan was in control of the State and the City of Grand Junction governments, lawyer Merle D. Vincent, was one of the first prominent citizens to openly fight against the Klan in Western Colorado. Vincent, who lived in the house ca., 1921-1935, was elected president of the Colorado Bar Association in 1926. From 1927-1933, Vincent served as executive vice president and general manager of the Rocky Mountain Fuel Company, one of the three largest coal companies in the state. In 1928, he and Josephine Roche, the company's principal owner and president, signed an agreement with the United Mine Workers Union which was a major step in improving labor and management relationships in that industry. Vincent was appointed deputy director of the National Recovery Administration in 1934. He later became administrator in charge of the textile industry division, and subsequently served as Coordinator of Industry Studies for the NRA. He retired as Associate Director of the Office of Price Administration's Consumer Goods Division. Before moving to Grand Junction, Vincent represented Delta County in the state Legislature from 1906-1908. An early advocate of conservation, he helped formulate grazing policies relating to public lands while serving on Theodore Roosevelt's Western Conservation Commission. In 1912 he ran, but was not elected, for State Attorney General on the Progressive Ticket headed by his friend former president Theodore Roosevelt. After the Vincents, the home owners/residents from ca. 1937-1951 were Fern and George F. Colburn, a clerk for Western Auto and Nellie and Frank Colburn, an inspector. By 1949, Nellie was a widow and the only Colburn still resided in the house.

INFORMATION SOURCES (be specific): Plat Map, Appraisal Card, Lot and Block Books, Grantor/Grantee Index, Obituary Index, Grand Junction City Directories, Sanborn Fire Insurance Map, 1981 Historic Survey of Grand Junction. Museum of Western Colorado Research Library: "Hooded Empire." Grand Junction Daily Sentinel Newspaper, 7 Mar 1958, p11.

SIGNIFICANCE (check appropriate categories)

Architectural significance:
 represents the work of a master
 possess high artistic value
 represents a type, period, or method of construction

Historical significance:
 associated with significant person(s)
 associated with significant event
 associated with a pattern of events
 contributes to an historic district

National Register eligibility:
 Individual yes no
 Criteria: A B C D

Contributes to a potential district:
 yes no
 District name:

Area(s) of significance: Architecture; Industry;
 Social History

Period of significance: 1904; 1924-1935

THEME(S):

STATEMENT OF SIGNIFICANCE (briefly justify the significance checked above): A fine Edwardian style house with unusual use of siding. Porch glazing is a style favored decades ago. It is currently in use as a Salvation Army residence for men. This house should be considered for inclusion in the National Register at the statewide level as a result of its association with Merle D. Vincent, ca. 1921-1935. While living in Grand Junction, a center of Klu Klux Klan activity during the early 1920s, Vincent was one of the first notable Western Colorado leaders to openly oppose the Klan. Later, as an executive of Rocky Mountain Fuel Company, he was instrumental in forging an agreement with the United Mine Workers Union which helped end a several decade conflict between miners and the coal industry. Other mine owners in the U.S. followed their lead.

INVENTORY COMPLETED BY: Museum Group Staff	DATE: 2/14/96
AFFILIATION: Museum of Western Colorado	PHONE: (970) 241-9117
ADDRESS: PO Box 20000-5020, Grand Junction, Colorado 81502-5020	PROJECT NAME: Grand Junction Historic Resources Survey, Phase 2



903 Grand Ave.
Grand Junction, Mesa Co, CO
2945-144-03-977
5ME7783

01/12/1996
Roll 17 Frame 11
View N Dir SE
5ME7783



903 Grand Ave.
Grand Junction, Mesa Co, CO
2945-144-03-977
5ME7783