

COLORADO HISTORICAL SOCIETY
Office of Archaeology and Historic Preservation
1300 Broadway Denver, CO 80203

HISTORIC BUILDING INVENTORY

SITE NO.: 5ME7823

Eligible for National Register yes no
date _____ initials _____
Criteria A B C D
Contributes to a potential National Register district
 yes no district name: _____

Eligible for State Register yes no
date _____ initials _____
Criteria a b c d e
Areas of significance: _____

Period of significance _____
Needs data date _____ initials _____

LOCAL LANDMARK DESIGNATION: yes no

Date of designation: N/A
Designating authority: N/A

P.M.: UTE township: 1S range:1W
SW 1/4 of NE 1/4 of NE 1/4 of section 14

UTM REFERENCE-12
Easting: 711500
Northing: 4327880

USGS QUAD NAME: Grand Junction
Year: 1962; photorevised 1973 7.5' 15'

Block: 21
Lot(s): 5 and 6
Addition:
Year of addition:

original location moved

Date of moves(s):

HISTORIC USE: Domestic

PRESENT USE: Domestic

DATE OF CONSTRUCTION- estimate: 1944 actual:
Source of information: Tax Assessor's Records

ARCHITECT: Unknown
Source of information:

BUILDER/CONTRACTOR: Unknown
Source of information:

ORIGINAL OWNER: Theo Theissing
Source of information: Lot and Block

ASSOCIATED BUILDINGS- yes no
Type:

COUNTY: Mesa

CITY: Grand Junction

HISTORIC BUILDING NAME: The house at 1015 Belford Avenue

CURRENT BUILDING NAME:

ADDRESS: 1015 Belford Ave., Grand Junction, CO 81501-3134

OWNER NAME & ADDRESS: Timothy T. Shortell, 331 Holland Hills Dr., Unit 8, Basalt, CO 81621-1010

STYLE: Minimal Traditional

BUILDING TYPE:

MATERIALS: Concrete Foundation - Wood Frame - Asphalt Shingle Roof

STORIES: 1

SQUARE FOOTAGE: 787

PLAN SHAPE:

north arrow

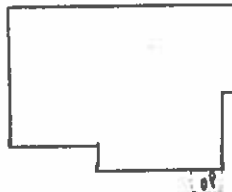

ARCHITECTURAL DESCRIPTION: One story with side gable. Concrete steps and wrought iron railings lead up to stoop under gabled portico supported by curved wall braces. Front door is paneled and has four lights. Windows are double hung wood sash with plank shutters, six-over-six and eight-over-eight. White clapboard siding. Light blue on shutters and portico braces. Dark blue window casings, portico cornice and raking cornices. Light gray composition shingle roof with eaves close to the wall with raking cornices. Side gabled wing on east elevation. Brick chimney on south slope. Landscaped with lawn, roses and spirea across facade and a sapling in the front. Wood and wire fences around backyard. Square concrete asphalt alley.

PHOTOGRAPHS (include photographs showing each side of building and any associated buildings)

Film roll no.: 34 Negative no.: 17	Photographer: Carolyn Howard Location of negatives: City Of Grand Junction
---------------------------------------	---

CONSTRUCTION HISTORY (include description and dates of major additions, alterations, or demolitions): Additional construction or modifications not noted in Assessor's Records.

HISTORICAL BACKGROUND (discuss important persons and events associated with this building): The first owner of the house, constructed ca. 1944, was Theo Theissing. Thelma and Harry Rawlings, a repairman for Mountain State and Telegraph, were the owners/occupants in ca. 1946.

INFORMATION SOURCES (be specific): Plat Map, Appraisal Card, Lot and Block Books, Grand Junction City Directories.

SIGNIFICANCE (check appropriate categories)

<p>Architectural significance: <input type="checkbox"/> represents the work of a master <input type="checkbox"/> possess high artistic value <input checked="" type="checkbox"/> represents a type, period, or method of construction</p> <p>National Register eligibility: Individual <input type="checkbox"/> yes <input checked="" type="checkbox"/> no Criteria: <input type="checkbox"/> A <input type="checkbox"/> B <input type="checkbox"/> C <input type="checkbox"/> D Area(s) of significance: Architecture</p> <p>Period of significance: 1944</p>	<p>Historical significance: <input type="checkbox"/> associated with significant person(s) <input type="checkbox"/> associated with significant event <input type="checkbox"/> associated with a pattern of events <input type="checkbox"/> contributes to an historic district</p> <p>Contributes to a potential district: <input type="checkbox"/> yes <input checked="" type="checkbox"/> no District name:</p>
--	--

THEME(S):

STATEMENT OF SIGNIFICANCE (briefly justify the significance checked above): A very neat blue and white house, the Minimal Traditional look is reminiscent of a 3/4 Cape Cod. Although not eligible for the National Register, this house may contribute to a local register.

INVENTORY COMPLETED BY: Museum Group Staff	DATE: 3/29/96
AFFILIATION: Museum of Western Colorado	PHONE: (970) 241-9117
ADDRESS: PO Box 20000-5020, Grand Junction, Colorado 81502-5020	PROJECT NAME: Grand Junction Historic Resources Survey, Phase 2



1015 Belford Ave. , Grand Junction, Mesa Co, CO

2945-141-08-003

03/08/1996

Roll 34 Frame 17 View N Dir S/SE

SME7823