

COLORADO HISTORICAL SOCIETY
 Office of Archaeology and Historic Preservation
 1300 Broadway Denver, CO 80203

HISTORIC BUILDING INVENTORY

SITE NO.: 5ME7828

Eligible for National Register yes no
 date _____ initials _____
 Criteria A B C D
 Contributes to a potential National Register district
 yes no district name: _____

Eligible for State Register yes no
 date _____ initials _____
 Criteria a b c d e
 Areas of significance: _____

COUNTY: Mesa CITY: Grand Junction

HISTORIC BUILDING NAME: McInturf, Arthur, House

Period of significance _____
 Needs data date _____ initials _____

CURRENT BUILDING NAME:

LOCAL LANDMARK DESIGNATION: yes no
 Date of designation: N/A
 Designating authority: N/A

ADDRESS: 839 Teller Ave., Grand Junction, CO 81501-3240

P.M.: UTE township: 1S range:1W
 SE ¼ of SE ¼ of NW¼ of NE¼ of section 14

OWNER NAME & ADDRESS: Peter A. Robinson, 726 Ouray Ave., Grand Junction, CO 81501-3328

UTM REFERENCE-12
 Easting: 711260
 Northing: 4327770
 USGS QUAD NAME: Grand Junction
 Year: 1962; photorevised 1973 7.5' 15'

STYLE: Bungalow

Block: 26
 Lot(s): 9 and 10
 Addition:
 Year of addition:

BUILDING TYPE:

original location moved
 Date of moves(s):

MATERIALS: Concrete Foundation - Wood Frame - Asphalt Shingle Roof

HISTORIC USE: Domestic
 PRESENT USE: Domestic

STORIES: 1

SQUARE FOOTAGE: 835

DATE OF CONSTRUCTION- estimate: 1923 actual:
 Source of information: Tax Assessor's Records

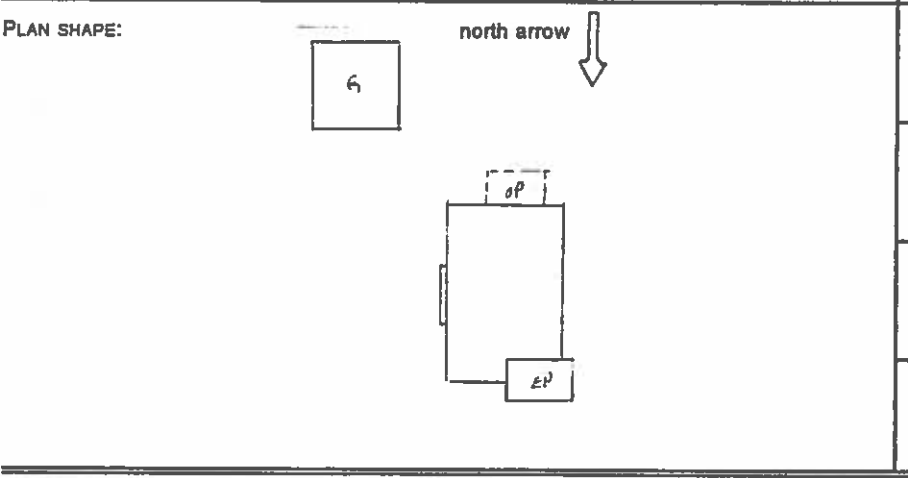

ARCHITECT: Unknown
 Source of information:

BUILDER/CONTRACTOR: Unknown
 Source of information:

ORIGINAL OWNER: Dean C. Hamilton
 Source of information: Lot and Block

ASSOCIATED BUILDINGS- yes no
 Type: 2 Car Garage

ARCHITECTURAL DESCRIPTION: One story with front gable. Battered foundation. Concrete steps with wrought iron railings lead up to gabled sunporch/entry on west half of facade. Siding on half-wall and square half length columns on front corners of porch. Porch is glazed with large lights in metal frames. Storm door. Paneled front door has three vertical lights. Windows are double hung wood sash, three, four and five vertical lights over one. Projecting bay window on east elevation has wide eave of the house as a roof. One storm window on facade. Buff narrow lapped siding. Window and door surrounds, corner boards, columns, bargeboards and knee braces are brown. Light gray composition shingle roof with knee braces under eaves and bargeboards with shaped tails. A brick chimney on east slope.

Landscaped with hedge on east lawn along driveway, and large plantings of evergreens in parking.

Two car garage at rear with front gable, gray narrow lapped siding, gray composition shingle roof, and batten swinging doors.

PHOTOGRAPHS (include photographs showing each side of building and any associated buildings)

Film roll no.: 18
 Negative no.: 2

Photographer: Carolyn Howard
 Location of negatives: City Of Grand Junction

CONSTRUCTION HISTORY (include description and dates of major additions, alterations, or demolitions): Porch glazing, storm door and window. Additional construction or modifications not noted on Assessor's Records.

HISTORICAL BACKGROUND (discuss important persons and events associated with this building): The first owners/occupants, ca. 1924-1925, were Merte and Dean C. Hamilton, Garfield Coal. Hallie and Forrest W. Daniels, a carpenter, owned and resided in the house ca. 1926-1927. Sam Anderson was the absentee landlord from ca. 1929-1949. Tenants from ca. 1928-47 included Mary and Arthur C. McInturf, district supervisor for Continental Oil, a department manager for Montgomery Wards, a carpenter, and a railroader.

INFORMATION SOURCES (be specific): Plat Map, Appraisal Card, Lot and Block Books, Grand Junction City Directories.

SIGNIFICANCE (check appropriate categories)

Architectural significance:
 represents the work of a master
 possesses high artistic value
 represents a type, period, or method of construction

Historical significance:
 associated with significant person(s)
 associated with significant event
 associated with a pattern of events
 contributes to an historic district

National Register eligibility:
 Individual yes no
 Criteria: A B C D
 Area(s) of significance: Architecture

Contributes to a potential district:
 yes no
 District name:

Period of significance: 1923

THEME(S):

STATEMENT OF SIGNIFICANCE (briefly justify the significance checked above): In a neighborhood of many Bungalows, this is one of the larger and better designed. Although not eligible for the National Register, this house may contribute to a local register.

INVENTORY COMPLETED BY: Museum Group Staff

DATE: 3/29/96

AFFILIATION: Museum of Western Colorado

PHONE: (970) 241-9117

ADDRESS: PO Box 20000-5020, Grand Junction, Colorado 81502-5020

PROJECT NAME: Grand Junction Historic Resources Survey, Phase 2



839 Teller Ave.
Grand Junction, Mesa Co, CO
2945-141-15-005
SME7828

01/12/1996
Roll 18 Frame 02
View N Dir SW
SME7828



839 Teller Ave.
Grand Junction, Mesa Co, CO
2945-141-15-005
SME7828