

COLORADO HISTORICAL SOCIETY
 Office of Archaeology and Historic Preservation
 1300 Broadway Denver, CO 80203

HISTORIC BUILDING INVENTORY

SITE NO.: 5ME7881

Eligible for National Register yes no
 date _____ initials _____
 Criteria A B C D
 Contributes to a potential National Register district
 yes no district name: _____

Eligible for State Register yes no
 date _____ initials _____
 Criteria a b c d e
 Areas of significance: _____

COUNTY: Mesa

CITY: Grand Junction

Period of significance _____
 Needs data date _____ initials _____

HISTORIC BUILDING NAME: The house at 822 Rood Avenue

CURRENT BUILDING NAME:

LOCAL LANDMARK DESIGNATION: yes no

Date of designation: N/A
 Designating authority: N/A

ADDRESS: 822 Rood Ave., Grand Junction, CO 81501-3434

P.M.: UTE township: 1S range:1W
 SW ¼ of NE ¼ of NW¼ of SE¼ of section 14

OWNER NAME & ADDRESS: Jim Fisher, 554 Court Rd., Grand Junction, CO 81501-4928

UTM REFERENCE-12
 Easting: 711245
 Northing: 4327010

USGS QUAD NAME: Grand Junction

Year: 1962; photorevised 1973 7.5' 15'

STYLE: Vernacular Wood Frame

Block: 92
 Lot(s): 27 and 28
 Addition:
 Year of addition:

BUILDING TYPE:

original location moved

Date of moves(s):

MATERIALS: Concrete Foundation - Wood Frame - Asphalt Shingle Roof

HISTORIC USE: Domestic

PRESENT USE: Domestic

STORIES: 1

SQUARE FOOTAGE: 707

DATE OF CONSTRUCTION- estimate: 1900 actual:
 Source of information: Tax Assessor's Records

PLAN SHAPE:

north arrow

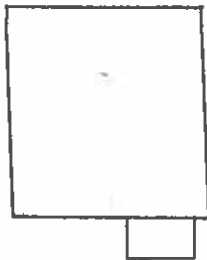

ARCHITECT: Unknown

Source of information:

BUILDER/CONTRACTOR: Unknown

Source of information:

ORIGINAL OWNER: E.A. Atwood

Source of information: Lot and Block Books

ASSOCIATED BUILDINGS- yes no

Type:

ARCHITECTURAL DESCRIPTION: One story with hip roof. Wood steps with pipe railing lead up to screen porch with shed roof extending along east half of facade. Vertical siding on porch half-wall. Four, 4 x 4 full height posts are placed along porch facade. Paneled front door. Windows are small sliding single light windows, wood or metal framed. Metal awnings on west elevation. Gray simple drop siding with gray trim. Light gray composition shingle roof with brick chimney on the north slope.

Thicket of volunteer saplings along east side of yard. Elms in west yard. Chain link fencing.

PHOTOGRAPHS (include photographs showing each side of building and any associated buildings)

Film roll no.: 22
Negative no.: 13

Photographer: Carolyn Howard
Location of negatives: City Of Grand Junction

CONSTRUCTION HISTORY (include description and dates of major additions, alterations, or demolitions): Additional construction or modifications not noted on Assessor's Records.

HISTORICAL BACKGROUND (discuss important persons and events associated with this building): This residence is difficult to track as the tax records show only one structure at the listing. This may have originally been a garage that has been since converted to a house. By 1935, "822 Road" is listed in the City Directory which may have been this residence.

INFORMATION SOURCES (be specific): Plat map, Appraisal Card, Lot and Block Books, Grand Junction City Directories, 1981 Historic Survey of Grand Junction.

SIGNIFICANCE (check appropriate categories)

Architectural significance:
 represents the work of a master
 possess high artistic value
 represents a type, period, or method of construction

Historical significance:
 associated with significant person(s)
 associated with significant event
 associated with a pattern of events
 contributes to an historic district

National Register eligibility:
Individual yes no
Criteria: A B C D
Area(s) of significance: Architecture

Contributes to a potential district:
yes no
District name:

Period of significance: 1900

THEME(S):

STATEMENT OF SIGNIFICANCE (briefly justify the significance checked above): A small rental or mother-in-law house behind the main house, typical of the type found in the older part of town. This modest one is quite original. Although not eligible for the National Register, this house may contribute to a local register.

INVENTORY COMPLETED BY: Museum Group Staff

DATE: 3/29/96

AFFILIATION: Museum of Western Colorado

PHONE: (970) 241-9117

ADDRESS: PO Box 20000-5020, Grand Junction, Colorado 81502-5020

PROJECT NAME: Grand Junction Historic Resources Survey, Phase 2



822 Rood Ave. (Rear), Grand Junction, Mesa Co, CO

2945-144-09-011

1/30/1996

Roll 22 Frame 13 View S Dir NE

5M~~8~~7881



822 Rood Ave. (Rear), Grand Junction, Mesa Co, CO
2945-144-09-011 1/30/1996
Roll 22 Frame 13 View S Dir NE
5M7881