

COLORADO HISTORICAL SOCIETY
 Office of Archaeology and Historic Preservation
 1300 Broadway Denver, CO 80203

HISTORIC BUILDING INVENTORY

SITE NO.: 5ME8195

Eligible for National Register yes no
 date _____ initials _____
 Criteria A B C D
 Contributes to a potential National Register district
 yes no district name: _____

Eligible for State Register yes no
 date _____ initials _____
 Criteria a b c d e
 Areas of significance: _____

Period of significance _____
 Needs data date _____ initials _____

COUNTY: Mesa

CITY: Grand Junction

HISTORIC BUILDING NAME: The house at 634 Teller Avenue

CURRENT BUILDING NAME:

ADDRESS: 634 Teller Ave., Grand Junction, CO 81501-2724

LOCAL LANDMARK DESIGNATION: [] yes [X] no

Date of designation: N/A
 Designating authority: N/A

P.M.: UTE township: 1S range:1W
 NE ¼ of NE ¼ of NE¼ of NW¼ of section 14

OWNER NAME & ADDRESS: Dorothy L. Brown, 639 Teller Ave., Grand Junction, CO 81501-2723

UTM REFERENCE-12
 Easting: 710945
 Northing: 4327820

USGS QUAD NAME: Grand Junction

Year: 1962; photorevised 1973 [X] 7.5' [] 15'

STYLE: Vernacular Wood Frame

Block: 17
 Lot(s): 21 and 22
 Addition:
 Year of addition:

BUILDING TYPE:

[X] original location [] moved
 Date of moves(s):

MATERIALS: Concrete Foundation - Wood Frame - Asphalt Shingle Roof

HISTORIC USE: Domestic
 PRESENT USE: Domestic

STORIES: 1

SQUARE FOOTAGE: 844

DATE OF CONSTRUCTION- estimate: 1907 actual:
 Source of information: Tax Assessor's Records

PLAN SHAPE:

north arrow

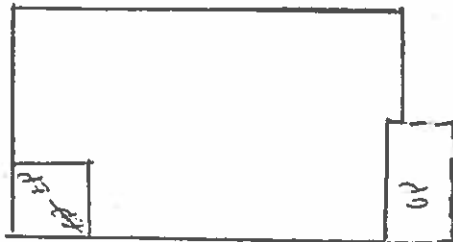
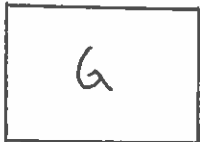

ARCHITECT: Unknown
 Source of information:

BUILDER/CONTRACTOR: Unknown
 Source of information:

ORIGINAL OWNER: Samuel Loeffler
 Source of information: Lot and Block Books

ASSOCIATED BUILDINGS- [X] yes [] no

Type: Garage

ARCHITECTURAL DESCRIPTION: One story with hip roof. Gabled short wing with kick on east side of facade. Exposed foundation consists of two rows of rusticated concrete blocks. Concrete steps lead to screened porch with shed roof on west side of facade. Simple drop siding on half-wall. Three full height, partially fluted porch columns. Metal screen door. Main door paneled with single light. Majority of windows are double hung sash, one over one, with wood frames, surrounds and metal storm windows. Large sliding windows in west and north elevations have metal frames and no surrounds. Small fixed pane window with three lights in gable. Simple drop wood siding is white. Corner boards, fascia, window frames and surrounds, columns and diamond shingles in gable are white. Green composition shingle roof, boxed eaves, and fascias.

Landscaped with lawn, shrubs and trees in variety of sizes around lot.

Single car garage with front gable roof and simple drop siding in west corner of lot.

PHOTOGRAPHS (include photographs showing each side of building and any associated buildings)

Film roll no.: 27
Negative no.: 19

Photographer: Carolyn Howard
Location of negatives: City Of Grand Junction

CONSTRUCTION HISTORY (include description and dates of major additions, alterations, or demolitions): Additional construction or modifications not noted in Assessor's records.

HISTORICAL BACKGROUND (discuss important persons and events associated with this building): The first owner of the house, constructed ca. 1907, was Samuel Loeffler. Grace and Jacob G. Morton, a laborer, were the owners/occupants ca. 1910-1914. By 1915, Grace was widowed. Mrs. A. E. Clark owned the house ca. 1916-1917, and the J. G. Morton Estate, ca. 1919. Grace M. Clark was the absentee owner of the house ca. 1920 until ca. 1946-1950 when she is living in the house as the widow of Albert. Tenants ca. 1926-1941 included a widow, a driver, a carpenter, and William F. Perkins, who was chair of the Mesa County Commissioners in 1941.

INFORMATION SOURCES (be specific): Plat Map, Appraisal Card, Lot and Block Books, Grand Junction City Directories.

SIGNIFICANCE (check appropriate categories)

Architectural significance:

- represents the work of a master
 possess high artistic value
 represents a type, period, or method of construction

Historical significance:

- associated with significant person(s)
 associated with significant event
 associated with a pattern of events
 contributes to an historic district

National Register eligibility:

Individual yes no

Criteria: A B C D

Area(s) of significance: Architecture

Contributes to a potential district:

yes no

District name:

THEME(S):

Period of significance: 1907

STATEMENT OF SIGNIFICANCE (briefly justify the significance checked above): There are six nearly identical houses on Teller, within a few blocks. This is the least modified and still has a screened porch. Although not eligible for the National Register, this house may contribute to a local register.

INVENTORY COMPLETED BY: Museum Group Staff

DATE: 3/29/96

AFFILIATION: Museum of Western Colorado

PHONE: (970) 241-9117

ADDRESS: PO Box 20000-5020, Grand Junction, Colorado 81502-5020

PROJECT NAME: Grand Junction Historic Resources Survey, Phase 2



634 Teller Ave. , Grand Junction, Mesa Co, CO

2945-142-07-006

02/06/1996

Roll 27 Frame 19 View S Dir N/NE



634 Teller Ave. , Grand Junction, Mesa Co, CO
2945-142-07-006 02/06/1996
Roll 27 Frame 19 View S Dir N/NE
SME 8195