

COLORADO HISTORICAL SOCIETY
Office of Archaeology and Historic Preservation
1300 Broadway Denver, CO 80203

HISTORIC BUILDING INVENTORY

SITE NO.: 5ME7946

Eligible for National Register yes no
date _____ initials _____
Criteria A B C D
Contributes to a potential National Register district
 yes no district name: _____

COUNTY: Mesa

CITY: Grand Junction

Eligible for State Register yes no
date _____ initials _____
Criteria a b c d e
Areas of significance: _____

HISTORIC BUILDING NAME: Reynolds, Burrell and Ella, House

Period of significance _____
Needs data date _____ initials _____

CURRENT BUILDING NAME: Glese Residence

LOCAL LANDMARK DESIGNATION: yes no

ADDRESS: 820 Hill Ave., Grand Junction, CO 81501-3232

Date of designation: N/A
Designating authority: N/A

OWNER NAME & ADDRESS: Tamra S. Glese, 820 Hill Ave., Grand Junction, CO 81501-3232

P.M.: UTE township: 1S range:1W
SW 1/4 of SE 1/4 of NW1/4 of NE1/4 of section 14

UTM REFERENCE-12
Easting: 711240
Northing: 4327720

USGS QUAD NAME: Grand Junction

Year: 1982; photorevised 1973 7.5' 15'

STYLE: Bungalow

Block: 26
Lot(s): 27 and 28
Addition:
Year of addition:

BUILDING TYPE:

original location moved
Date of moves(s):

MATERIALS: Concrete Foundation - Wood Frame - Asphalt Shingle Roof -Vinyl Siding

HISTORIC USE: Domestic
PRESENT USE: Domestic

STORIES: 1

SQUARE FOOTAGE: 1060

DATE OF CONSTRUCTION- estimate: 1921 actual:
Source of information: Tax Assessor's Records

PLAN SHAPE:

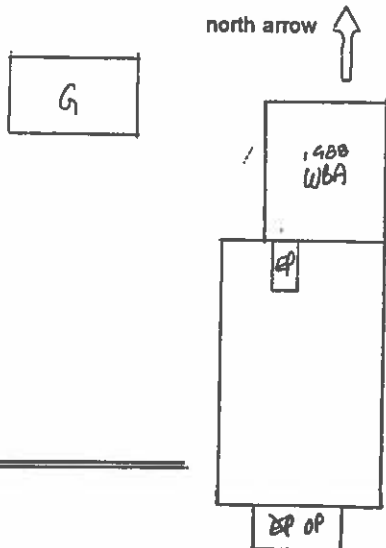

ARCHITECT: Unknown
Source of information:

BUILDER/CONTRACTOR: Unknown
Source of information:

ORIGINAL OWNER: J.W. Roessler
Source of information: Lot and Block Books

ASSOCIATED BUILDINGS- yes no

Type: Garage

ARCHITECTURAL DESCRIPTION: One story with side gable. Foundation slightly battered. Concrete steps with wrought iron railings lead up to gabled, screened porch in center half of facade. Siding on half-wall and on porch piers. Screen door. Paneled door with eight lights. Windows are double hung metal sash, one-over-one, with storm windows. Yellow lapped vinyl siding. Window surrounds, barge boards, steps are brown. Brown composition shingle roof with boxed eaves and bargeboards. Brick chimney on north slope.

Ash in east lawn, large arborvitae on east facade, and two white birches on west facade. Saplings in parking area. Wood fence around backyard. One car garage at rear with front gable, brown composition shingle roof, yellow drop siding, and metal contemporary door.

PHOTOGRAPHS (include photographs showing each side of building and any associated buildings)

Film roll no.: 19
Negative no.: 19

Photographer: Carolyn Howard
Location of negatives: City Of Grand Junction

CONSTRUCTION HISTORY (include description and dates of major additions, alterations, or demolitions): Wood deck added to rear, 1988. Roof materials changed from wood shingles to asphalt shingles, date undetermined. Metal sash windows and storm windows, vinyl siding.

HISTORICAL BACKGROUND (discuss important persons and events associated with this building): The first owner was J.W. Roessler, 1921-1922. From 1923-1951, this was the residence of owners Ella and Burrell Reynolds. After arriving in Grand Junction, Reynolds, a civil engineer and pharmacist, was a manager for Roy Lija and then proprietor of Reynolds Drug Store ca. 1926-1937. He served as Mesa County Treasurer from 1941-1961.

INFORMATION SOURCES (be specific): Plat Map, Appraisal Card, Lot and Block Books, Grand Junction City Directories, Obituary Index. Grand Junction Daily Sentinel Newspaper, 11 Sept 1961, p1.

SIGNIFICANCE (check appropriate categories)

Architectural significance:

- represents the work of a master
 possess high artistic value
 represents a type, period, or method of construction

Historical significance:

- associated with significant person(s)
 associated with significant event
 associated with a pattern of events
 contributes to an historic district

National Register eligibility:

- Individual yes no
Criteria: A B C D
Area(s) of significance: Architecture

Contributes to a potential district:

- yes no
District name:

THEME(S):

Period of significance: 1921

STATEMENT OF SIGNIFICANCE (briefly justify the significance checked above): This Bungalow has new siding and windows. However, the siding is lapped, and the windows are one-over-one, and look appropriate for the Bungalow style. Although not eligible for the National Register, this house may contribute to a local register.

INVENTORY COMPLETED BY: Museum Group Staff

DATE: 3/29/96

AFFILIATION: Museum of Western Colorado

PHONE: (970) 241-9117

ADDRESS: PO Box 20000-5020, Grand Junction, Colorado 81502-5020

PROJECT NAME: Grand Junction Historic Resources Survey, Phase 2



820 Hill Ave. , Grand Junction, Mesa Co, CO

2945-141-15-012

1/29/1996

Roll 19 Frame 19 View S Dir N/NE

5ME7946



820 Hill Ave. , Grand Junction, Mesa Co, CO
2945-141-15-012 1/29/1996
Roll 19 Frame 19 View S Dir N/NE
5ME7946