

COLORADO HISTORICAL SOCIETY
Office of Archaeology and Historic Preservation
1300 Broadway Denver, CO 80203

HISTORIC BUILDING INVENTORY

SITE NO.: 5ME8352

Eligible for National Register yes no
date _____ initials _____
Criteria A B C D
Contributes to a potential National Register district
 yes no district name: _____

COUNTY: Mesa CITY: Grand Junction

Eligible for State Register yes no
date _____ initials _____
Criteria a b c d e
Areas of significance: _____

HISTORIC BUILDING NAME: The house at 1130 Hill Avenue

Period of significance _____
Needs data date _____ initials _____

CURRENT BUILDING NAME:

LOCAL LANDMARK DESIGNATION: yes no
Date of designation: N/A
Designating authority: N/A

ADDRESS: 1130 Hill Ave., Grand Junction, CO 81501-3237

P.M.: UTE township: 1S range:1W
SE ¼ of SE ¼ of NE¼ of NE¼ of section 14

OWNER NAME & ADDRESS: Lutheran Church of Messiah of Grand Junction, 840 N. 11th St., Grand Junction, CO 81501-3218

UTM REFERENCE-12
Easting: 711660
Northing: 4327700

USGS QUAD NAME: Grand Junction
Year: 1962; photorevised 1973 7.5' 15'

STYLE: Bungalow

Block: 23
Lot(s): W2 lot 27 all 28 E13.5' lot 29
Addition:
Year of addition:

BUILDING TYPE:

original location moved
Date of moves(s):

MATERIALS: Concrete Foundation - Wood Frame - Asphalt Shingle Roof

HISTORIC USE: Domestic
PRESENT USE: Domestic

STORIES: 1

SQUARE FOOTAGE: 1020

DATE OF CONSTRUCTION- estimate: 1914 actual:
Source of information: Tax Assessor's Records

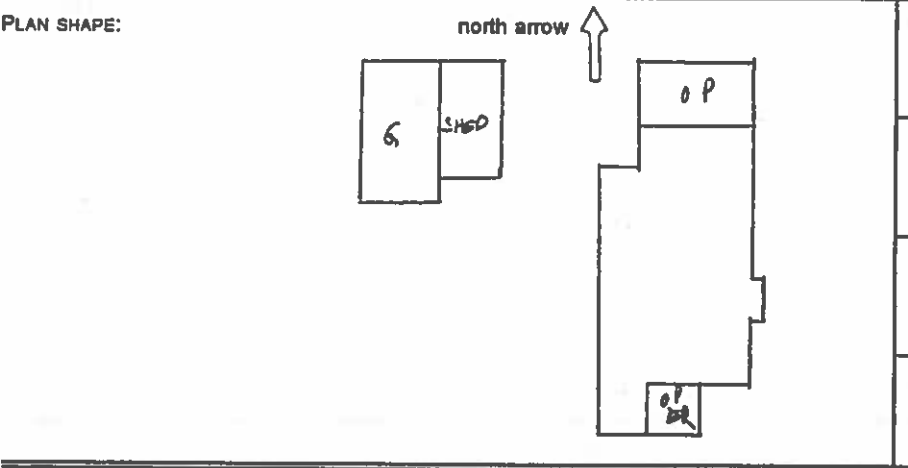

ARCHITECT: Unknown
Source of information:

BUILDER/CONTRACTOR: Unknown
Source of information:

ORIGINAL OWNER: Bessie Smith
Source of information: Lot and Block Books

ASSOCIATED BUILDINGS- yes no
Type: Garage

ARCHITECTURAL DESCRIPTION: One story with front gable. Concrete foundation. Carpeted concrete steps lead up to gabled wing on the west two thirds of the facade. Integral in the east half of the wing is a screened porch. Shingle siding on half-wall. Metal framed screen door. The west half of the front wing is a sunporch with pairs of double hung, wood sash windows, three vertical lights over one. On the west elevation is a window with fifteen over one. On the facade and east elevation is a ribbon of small, high pairs of metal framed sliding windows. Two are on the corner of the facade and three are adjacent on the east elevation. The windows of the gabled, projecting bay, and other windows on the east elevation, are single light casement windows which are replacements. Beige wood shingle siding. The two front gable faces have brown wood shingles. A wood louvered ventilator is on the porch gable. Door and window surrounds, bargeboards and knee braces are white. Gray composition shingle roof with exposed rafter ends.

Gravel yard and concrete retaining wall along the edge of yard by the sidewalk. Evergreen trees across the facade. A hedge is along the east edge of the yard.

One car garage at the rear with front gable, grey composition shingle roof, and white, wood shingle siding. A wing on the east elevation of the garage has an extended shed roof. A paneled door and full size windows suggest that it is a living space.

PHOTOGRAPHS (include photographs showing each side of building and any associated buildings)

Film roll no.: 23
Negative no.: 24

Photographer: Carolyn Howard
Location of negatives: City Of Grand Junction

CONSTRUCTION HISTORY (include description and dates of major additions, alterations, or demolitions): Front enclosed porch modified to open porch. Rear open porch is fiberglass. Window modifications.

HISTORICAL BACKGROUND (discuss important persons and events associated with this building): Grand Junction City directories are not indexed by address until 1926. This house, built in 1914, does not show up in the City Directories until 1926. Bessie Smith was the original owner, ca. 1910-1917; Lillian Boroman, the absentee owner, ca. 1918-1919; and C. W. Mayer, ca. 1920-1924. The house was still listed as unfinished in the 1926 City Directory when R. W. Berl is the absentee owner, and Margaret and Claude E. Stevens, a mechanic for Western Slope Auto, the tenants. Ida and O. C. Reed, manager of the Mesa County Credit Union, were the tenants ca. 1928; Maude and Galen B. Bare, salesman for Central Chevrolet, ca. 1930; A. Fern and Edwin J. Sisler, ca. 1931; and Eva and Rufus Hiron, livestock, ca. 1937. While Grace Milne was the absentee owner, ca. 1939-1942, the house was vacant ca. 1939. Helen and Leland H. Sheffield, Sheffield's Shoe Repair, were the owners/occupants ca. 1944 through at least 1947.

INFORMATION SOURCES (be specific): Plat Map, Appraisal Card, Lot and Block Books, Grand Junction City Directories.

SIGNIFICANCE (check appropriate categories)

Architectural significance:
 represents the work of a master
 possess high artistic value
 represents a type, period, or method of construction

Historical significance:
 associated with significant person(s)
 associated with significant event
 associated with a pattern of events
 contributes to an historic district

National Register eligibility:
 Individual yes no
 Criteria: A B C D
 Area(s) of significance: Architecture

Contributes to a potential district:
 yes no
 District name:

Period of significance: 1914

THEME(S):

STATEMENT OF SIGNIFICANCE (briefly justify the significance checked above): The house has many window changes, and these are not uniform among themselves. The shingle siding is of a style used in the 1940s-1950s. Although not eligible for the National Register, this house may contribute to a local register.

INVENTORY COMPLETED BY: Museum Group Staff

DATE: 5/31/96

AFFILIATION: Museum of Western Colorado

PHONE: (970) 241-9117

ADDRESS: PO Box 20000-5020, Grand Junction, Colorado 81502-5020

PROJECT NAME: Grand Junction Historic Resources Survey, Phase 2



1130 Hill Ave. , Grand Junction, Mesa Co, CO
2945-141-18-003 02/05/1996
Roll 23 Frame 24 View S Dir N/NE

SME8352



1130 Hill Ave. , Grand Junction, Mesa Co, CO
2945-141-18-003 02/05/1996
Roll 23 Frame 24 View S Dir N/NE
SME 8352