

COLORADO HISTORICAL SOCIETY
 Office of Archaeology and Historic Preservation
 1300 Broadway Denver, CO 80203

HISTORIC BUILDING INVENTORY

SITE NO.: 5ME8360

Eligible for National Register yes no
 date _____ initials _____
 Criteria A B C D
 Contributes to a potential National Register district
 yes no district name: _____

Eligible for State Register yes no
 date _____ initials _____
 Criteria a b c d e
 Areas of significance: _____

Period of significance _____
 Needs data date _____ initials _____

LOCAL LANDMARK DESIGNATION: yes no

Date of designation: N/A
 Designating authority: N/A

P.M.: UTE township: 1S range:1W
 SE ¼ of SW ¼ of NW¼ of NE¼ of section 14

UTM REFERENCE-12
 Easting: 711135
 Northing: 4327720

USGS QUAD NAME: Grand Junction

Year: 1962; photorevised 1973 7.5' 15'

Block: 40
 Lot(s): E2 16 all 17 W2 18
 Addition:
 Year of addition:

original location moved

Date of moves(s):

HISTORIC USE: Domestic

PRESENT USE: Domestic

DATE OF CONSTRUCTION- estimate: 1925 actual:
 Source of information: Tax Assessor's Records

ARCHITECT: Unknown

Source of information:

BUILDER/CONTRACTOR: Unknown

Source of information:

ORIGINAL OWNER: Lucille Fravert

Source of information: Lot and Block Books

ASSOCIATED BUILDINGS- yes no

Type: Garage

COUNTY: Mesa

CITY: Grand Junction

HISTORIC BUILDING NAME: Murphy, William W., House

CURRENT BUILDING NAME: Daniel Residence

ADDRESS: 747 Hill Ave., Grand Junction, CO 81501-3229

OWNER NAME & ADDRESS: Everett M. Daniel 747 Hill Ave. Grand Junction CO 81501-3229

STYLE: Bungalow

BUILDING TYPE:

MATERIALS: Concrete Foundation-Wood Frame-Aluminum Siding-Asphalt Shingle Roof

STORIES: 1

SQUARE FOOTAGE: 1300

PLAN SHAPE:

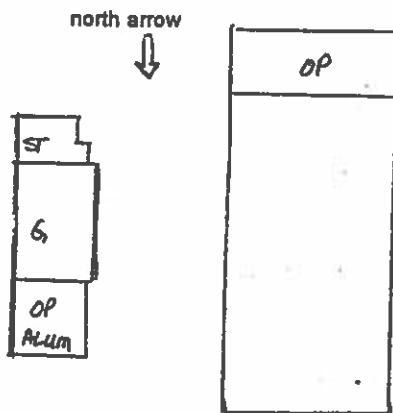

ARCHITECTURAL DESCRIPTION: One story with side gable. Battered foundation. Wide concrete steps with wrought iron railings lead up to sunporch/entry, integral under principal roof, extending across the facade. Siding on half-wall. Two wide, squared half columns are in the front corners. Two narrow, squared half columns flank the sidelights of the door. Glazing on each side is large single lights in fixed wood sashes, three-over-three. The end walls of the porch have a pair of double hung wood sash windows, one-over-one. The flush porch door has a large light and a wood frame storm door. Windows around the house are double hung, wood sash, one-over-one. Many windows have storm windows with sage green, vinyl frames. On the east elevation is projecting bay with shed roof. Siding is buff aluminum in clapboard width. The original false bevel wood siding can be seen inside the porch. Window surrounds, porch window framing, bargeboards, steps and rafter ends are russet. Other window frames, and coping of porch half-wall, are sage green. A sunburst on the dormer face is russet and green. Gray/russet composition shingle roof. Exposed rafter ends, knee braces and bargeboards. Gabled dormer on the facade has a pair of three light windows. Gable peaks have round, wood louvered ventilators. Brick chimney on the south slope.

Lawn and evergreens across the facade. A lantern with amber glass is atop a black steel post at the west foot of the stairs. Parking is partly paved with flagstones. Evergreens and saplings. High wood fence around the backyard.

One car garage at the rear with a flat roof with parapets, buff stucco, and false bevel siding and batten door. Flat roof carport on the front of the garage.

PHOTOGRAPHS (include photographs showing each side of building and any associated buildings)

Film roll no.: 23
Negative no.: 16

Photographer: Carolyn Howard
Location of negatives: City Of Grand Junction

CONSTRUCTION HISTORY (include description and dates of major additions, alterations, or demolitions): Aluminum siding, porch glazing and storm windows. Mill tailings removed, 1987. Additional construction or modifications not noted in Assessor's records.

HISTORICAL BACKGROUND (discuss important persons and events associated with this building): Lucie and Charles W. Fravert, a stockman, were the original owners/occupants ca. 1925-1927. B. H. and Clara Day were the absentee owners ca. 1930-1934. Louisa and William W. Murphy, a railroad engineer, were the owners/occupants ca. 1937-1942; and Alma F. and Victor L. Colony, Vick's Pastry Shop, the owners/occupants ca. 1944 to at least 1947.

INFORMATION SOURCES (be specific): Plat Map, Appraisal Card, Lot and Block Books, Grand Junction City Directories.

SIGNIFICANCE (check appropriate categories)

Architectural significance:
 represents the work of a master
 possess high artistic value
 represents a type, period, or method of construction

Historical significance:
 associated with significant person(s)
 associated with significant event
 associated with a pattern of events
 contributes to an historic district

National Register eligibility:
 Individual yes no
 Criteria: A B C D
 Area(s) of significance: Architecture

Contributes to a potential district:
 yes no
 District name:

Period of significance: 1925

THEME(S):

STATEMENT OF SIGNIFICANCE (briefly justify the significance checked above): This Bungalow has little modification, aside from the porch fenestration. Three large lights over three large lights on each side are unusual. Although not eligible for the National Register, this house may contribute to a local register.

INVENTORY COMPLETED BY: Museum Group Staff

DATE: 5/31/96

AFFILIATION: Museum of Western Colorado

PHONE: (970) 241-9117

ADDRESS: PO Box 20000-5020, Grand Junction, Colorado 81502-5020

PROJECT NAME: Grand Junction Historic Resources Survey, Phase 2



747 Hill Ave., Grand Junction, Mesa Co, CO
2945-141-23-005 02/05/1996
Roll 23 Frame 16 View N Dir S/SE

SKM1=8340



747 Hill Ave. , Grand Junction, Mesa Co, CO
2945-141-23-005 02/05/1996
Roll 23 Frame 16 View N Dir S/SE
SME8360