

COLORADO HISTORICAL SOCIETY
 Office of Archaeology and Historic Preservation
 1300 Broadway Denver, CO 80203

HISTORIC BUILDING INVENTORY

SITE NO.: 5ME8361

Eligible for National Register yes no
 date _____ initials _____
 Criteria A B C D
 Contributes to a potential National Register district
 yes no district name: _____

COUNTY: Mesa

CITY: Grand Junction

Eligible for State Register yes no
 date _____ initials _____
 Criteria a b c d e
 Areas of significance: _____

HISTORIC BUILDING NAME: West, Ross R., House

Period of significance _____
 Needs data _____ date _____ initials _____

CURRENT BUILDING NAME: _____

LOCAL LANDMARK DESIGNATION: [] yes [X] no

ADDRESS: 1143 Hill Ave., Grand Junction, CO 81501-3236

Date of designation: N/A
 Designating authority: N/A

OWNER NAME & ADDRESS: George A. Setter, 1128 Gunnison Ave., Grand Junction, CO 81501-3228

P.M.: UTE township: 1S range:1W
 SE ¼ of SE ¼ of NE¼ of NE¼ of section 14

UTM REFERENCE-12
 Easting: 711705
 Northing: 4327720

USGS QUAD NAME: Grand Junction

Year: 1982; photorevised 1973 [X] 7.5' [] 15'

STYLE: Bungalow

Block: 44
 Lot(s): 11 and 12
 Addition:
 Year of addition:

BUILDING TYPE:

[X] original location [] moved
 Date of moves(s):

MATERIALS: Concrete Foundation - Wood Frame - Asphalt Shingle Roof

HISTORIC USE: Domestic
 PRESENT USE: Domestic

STORIES: 1

SQUARE FOOTAGE: 984

DATE OF CONSTRUCTION- estimate: 1924 actual:
 Source of information: Tax Assessor's Records

PLAN SHAPE:

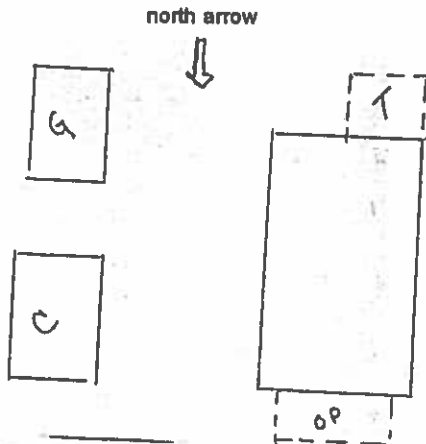

ARCHITECT: Unknown

Source of information:

BUILDER/CONTRACTOR: Unknown

Source of information:

ORIGINAL OWNER: S.E. Winterburn

Source of information: Lot and Block Books

ASSOCIATED BUILDINGS- [X] yes [] no

Type: Garage

ARCHITECTURAL DESCRIPTION: One story with pyramidal hip roof. Concrete steps, parallel to the street, lead to side entry of screened porch with front gable roof, occupying center 2/3 of facade. Porch half-wall is covered with shake shingles down to the ground level. Ribbons of thin wood frame screens with screened transoms on all three sides of porch. Wood screen porch door on west side of porch. Front door is paneled with three tall, narrow vertical lights. Windows around house are double hung wood sash, one-over-one, with metal frame storm windows. White shake shingle siding. Skirted foundation covered with white shake shingles. Porch screen frames, front door, window frames and surrounds, exposed rafters and bargeboards are dark brown. Brown corrugated metal roof with exposed rafters. Brick chimney on ridge.

Lawn with two mature trees along street. Two evergreen shrubs along porch facade. Four lilac bushes along east side yard. Mature and several young trees in backyard. East side of lot enclosed by white wood fence. Carport with squared posts and knee braces in back yard.

Single car garage in rear with front gable roof covered with metal ridge roofing. White simple drop siding.

PHOTOGRAPHS (include photographs showing each side of building and any associated buildings)

Film roll no.: 33

Negative no.: 2

Photographer: Carolyn Howard

Location of negatives: City Of Grand Junction

CONSTRUCTION HISTORY (include description and dates of major additions, alterations, or demolitions): Metal roof and shake shingle siding. Additional construction or modifications not noted in Assessor's records.

HISTORICAL BACKGROUND (discuss important persons and events associated with this building): The house was originally owned, ca. 1923, by S. E. Winterburn, a contractor. Valentine and Robert West, sales manager for Grand Junction Seed Company, were the owners/occupants, ca. 1925-1936. S. E. Winterburn was the absentee owner, ca. 1937-1939, and Louise and N. L. McVee, the renters, ca. 1937. Roy R. Masters was the absentee owner, ca. 1941-1943. Lena and John Ross, a clerk at the Lincoln Park Grocery and then sign writer, were the renters, ca. 1939-1941. Edna and Merrill Southard, U.S. Army, were the owners/occupants, ca. 1946.

INFORMATION SOURCES (be specific): Plat Map, Appraisal Card, Lot and Block Books, Grand Junction City Directories.

SIGNIFICANCE (check appropriate categories)

Architectural significance:

represents the work of a master

possess high artistic value

represents a type, period, or method of construction

Historical significance:

associated with significant person(s)

associated with significant event

associated with a pattern of events

contributes to an historic district

National Register eligibility:

Individual yes no

Criteria: A B C D

Area(s) of significance: Architecture

Contributes to a potential district:

yes no

District name:

THEME(s):

Period of significance: 1924

STATEMENT OF SIGNIFICANCE (briefly justify the significance checked above): The mass, porch and windows are authentic Bungalow style. Siding and metal roof are not appropriate.

INVENTORY COMPLETED BY: Museum Group Staff

DATE: 5/31/96

AFFILIATION: Museum of Western Colorado

PHONE: (970) 241-9117

ADDRESS: PO Box 20000-5020, Grand Junction, Colorado 81502-5020

PROJECT NAME: Grand Junction Historic Resources Survey, Phase 2



1143 Hill Ave. , Grand Junction, Mesa Co, CO

2945-141-19-006

02/29/1996

Roll 33 Frame 2 View N Dir S/SE

SME 8361



1143 Hill Ave. , Grand Junction, Mesa Co, CO
2945-141-19-006 02/29/1996
Roll 33 Frame 2 View N Dir S/SE
SME 836)