

V. SKETCH MAP: Map all features and show the boundaries of the resources. Show all major topographic features, permanent modern features, and vegetation zones as appropriate. Give names of features, streets and addresses if known. Provide scale, key and direction.

scale:
1" = 100'

key:
blue

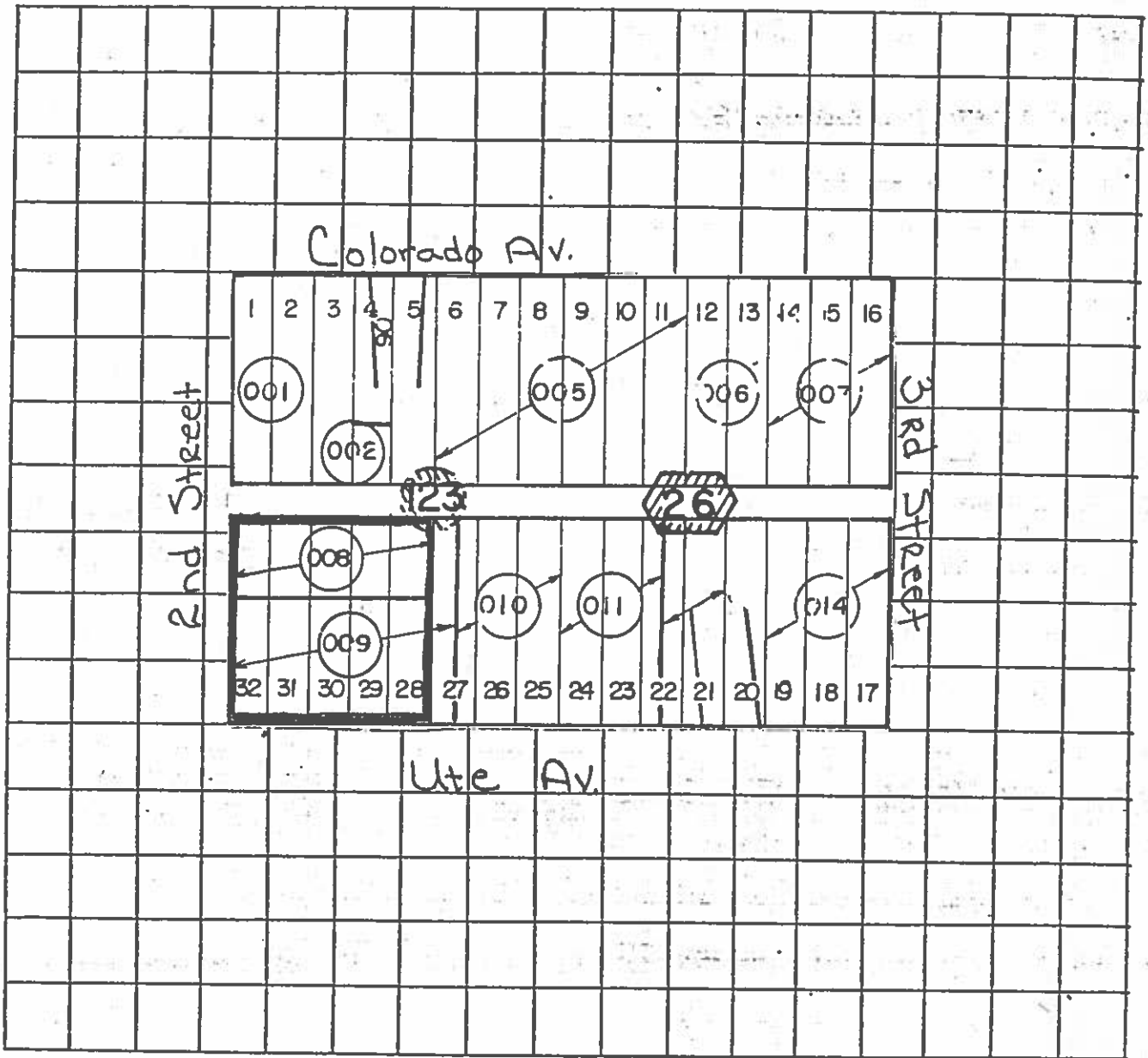

28) Location/Access: n/a

29) Boundary Description: N.50' lots 28-32 block 123, City of Grand Jct.

30) Boundary Justification: n/a

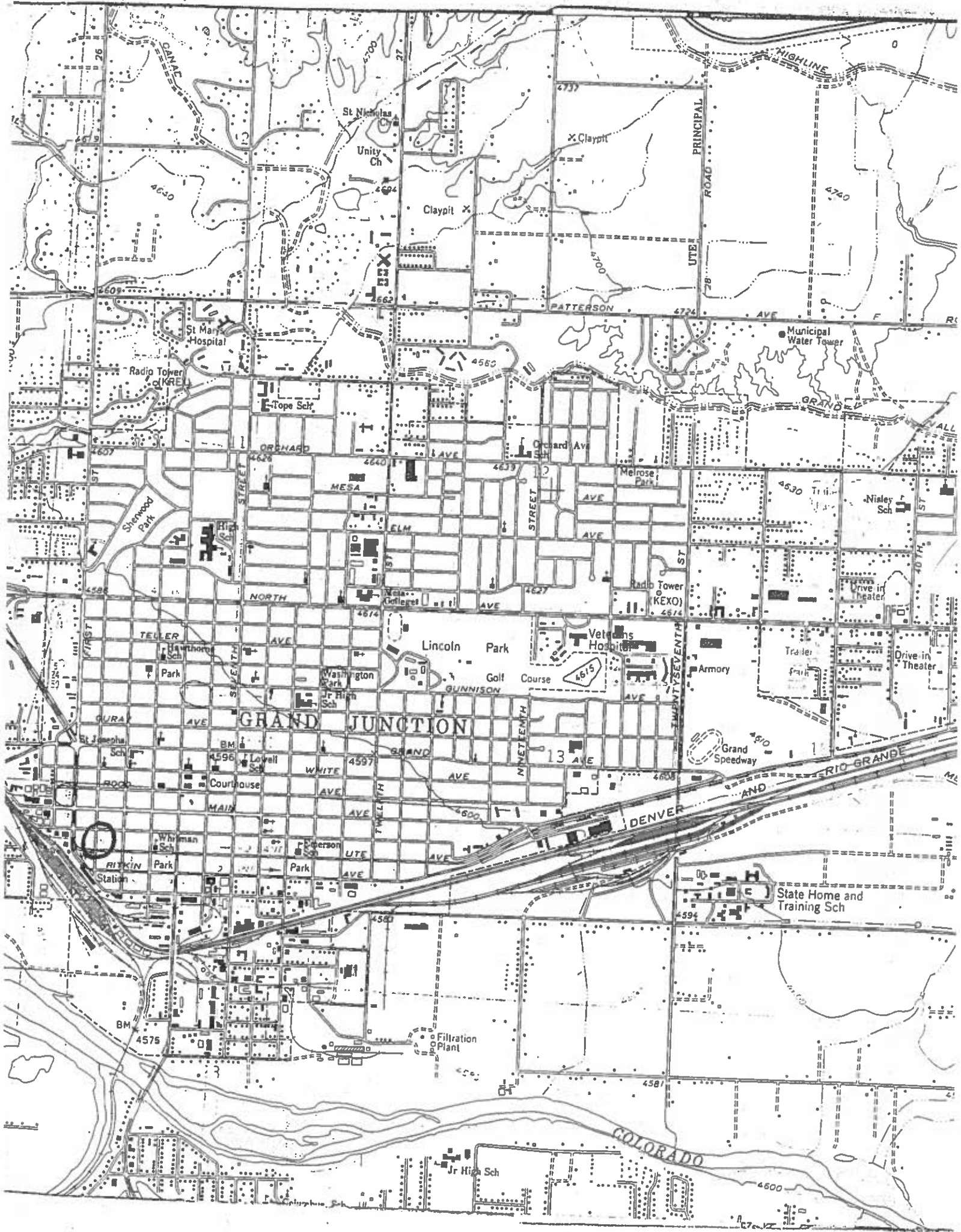



ARCHITECTURAL/HISTORICAL COMPONENT FORM

IMPORTANT: USE IN CONJUNCTION WITH THE GREEN INVENTORY RECORD FORM FOR RECORDING HISTORIC STRUCTURES AND DISTRICTS. USE SEPARATELY FOR RECORDING STRUCTURES LOCATED WITHIN DISTRICT BOUNDARIES.

- 1) Resource No. 5M4311 2) Temp No. 89 3) Name Raso Grocery
 4) Address 220 South 2nd. 5) District Name none
 I. INTEGRITY: 6) Condition: Good ___ Fair X Deteriorated ___
 7) Original Use Residential, Commercial 8) Present Use Commercial
 9) Original Site X Moved ___ Date(s) of Move: ___
 10) Unaltered ___ Altered X Explain: 1950's Remodelled storefront

- II. DESCRIPTION: 11) Building Materials Brick
 12) Construction Date 1915 13) Architect/Builder unknown
 14) Architectural Style(s) Vernacular, commercial 1910's period
 15) Special Features/Surroundings: Flat brick detail on cornice; part of a collection of commercial structures of this period.

- 16) Archaeological Potential: Yes ___ No ___ Unknown X Explain: ___

III. CULTURAL ACTIVITIES: Key the resource type (ie: house, barn, shed, school, church, etc) to the cultural activity theme and sub-theme category associated with it.

| | | | |
|---------------|------------|-------------|------------|
| 17) THEME | Commercial | Residential | Commercial |
| 18) SUB-THEME | Retail | Urban | Retail |
| 19) TYPES | Grocery | S.F, | Liquor |
| | | | |

(Attach Photographs)

Frame Number _____
Roll Number _____
Facade Orientation _____

IV. SIGNIFICANCE: Assess whether or not the resource has any historical or architectural merit by checking appropriate categories and justifying below. Include any relevant historical data.

- 20) Architectural Significance:
- Represents work of a master
 - Possesses high artistic values
 - Represents a type, period, or method of construction

- 21) Historical Significance:
- Associated with significant persons
 - Associated with significant events or patterns
 - Contributes to the significance of an historic district

This structure, built in 1915 is part of a small collection of commercial structures built between 1910 and 1920 located near the train depot. This commercial district served the Italian community who lived in the area and worked with the Denver & Rio Grande Western Railroad. This structure was built for Amore Raso, a former railroad worker who opened a grocery in it. Mr. Raso was a very prominent member of the Italian community and built a large substantial fortune for himself and his people in Real Estate. In the early 1930's he decided to move from the grocery business to the liquor business. Mr. Raso died in the mid 1950's and the building was sold in 1961. It has remained a liquor store to the present day.

22) List Any Associated Cultural Group: _____

V. REFERENCES:

Interview with Dave Sundal 14 July 1982
 City Directories
 Samborn Maps

