

COLORADO HISTORICAL SOCIETY
Office of Archaeology and Historic Preservation
1300 Broadway Denver, CO 80203

HISTORIC BUILDING INVENTORY

SITE NO.: 5ME8414

Eligible for National Register yes no
date _____ initials _____
Criteria A B C D
Contributes to a potential National Register district
 yes no district name: _____

Eligible for State Register yes no
date _____ initials _____
Criteria a b c d e
Areas of significance: _____

COUNTY: Mesa

CITY: Grand Junction

HISTORIC BUILDING NAME: Brownson, Bruce, House

Period of significance _____
Needs data date _____ initials _____

CURRENT BUILDING NAME:

LOCAL LANDMARK DESIGNATION: [] yes [X] no

ADDRESS: 945 Chipeta Ave., Grand Junction, CO 81501

Date of designation: N/A
Designating authority: N/A

P.M.: UTE township: 1S range:1W
SW ¼ of NW ¼ of SE¼ of NE¼ of section 14

OWNER NAME & ADDRESS: JAMES SCHULTZ
PO BOX 00351
GLADE PARK, CO
81523

UTM REFERENCE-12
Easting: 711425
Northing: 4327440

USGS QUAD NAME: Grand Junction

Year: 1962; photorevised 1973 [X] 7.5' [] 15'

STYLE: Bungalow

Block: 64
Lot(s): 11 and 12
Addition:
Year of addition:

BUILDING TYPE:

[X] original location [] moved
Date of moves(s):

MATERIALS: Concrete Foundation - Wood Frame - Aluminum Siding - Asphalt Shingle Roof

HISTORIC USE: Domestic
PRESENT USE: Domestic

STORIES: 1

SQUARE FOOTAGE: 1129

DATE OF CONSTRUCTION- estimate: 1911 actual:
Source of information: Tax Assessor's Records

PLAN SHAPE:

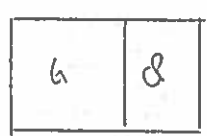

north arrow

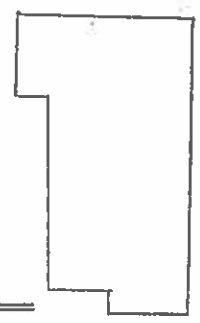

ARCHITECT: Unknown
Source of information:

BUILDER/CONTRACTOR: Unknown
Source of information:

ORIGINAL OWNER: W.J. Shellenberger
Source of information: Lot and Block Books

ASSOCIATED BUILDINGS- [X] yes [] no
Type: Garage/Shed

ARCHITECTURAL DESCRIPTION: One story hip roof with gable on hip. Concrete block foundation. Concrete steps and stoop have wrought iron railings. A shallow gabled wing on the west half of the facade has a sunporch/entry. Siding on half-wall. Large, squared half columns are on the two front corners. Glazing is three large single fixed lights, and a single light on each end. Wood framed storm door. Front door on porch is paneled and has a light. Windows around the house are double hung, wood sash, one over one, with metal frame screens. Two west windows have green canvas awnings. Siding is white clapboard width metal. Foundation, carpeted steps and window frames are green. Green composition shingle roof. On the facade is a small gable on hip, with wood louvers filling the gable face. Gable face of porch has gray board and batten siding. Flared eaves are boxed and have vergeboards.

Lawn with spirea by the west facade. A chain-link fence is around the yards. Two bushes on parking area.

One car garage with front gable roof, gray roll composition roofing, white, false bevel, wood siding, and batten garage door. Other doors and window suggest it has been remodeled for living quarters. A shed roof carport is attached to the west elevation of the garage and has 4x4 support posts. Alley access.

PHOTOGRAPHS (include photographs showing each side of building and any associated buildings)

Film roll no.: 33
Negative no.: 21

Photographer: Carolyn Howard
Location of negatives: City Of Grand Junction

CONSTRUCTION HISTORY (include description and dates of major additions, alterations, or demolitions): Siding and porch glazing. Aluminum siding. Additional construction or modifications not noted in Assessor's records.

HISTORICAL BACKGROUND (discuss important persons and events associated with this building): W. J. Shellenberger was the original owner of the house, constructed, ca. 1910. Mary and Bruce Brownson, chief of the Grand Junction Health and Parks Department, were the owners/occupants, ca. 1924-1945. Bertha and Walter R. (Dick) Lloyd, a stockman, were the occupants through 1951.

INFORMATION SOURCES (be specific): Plat Map, Appraisal Card, Lot and Block Books, Grand Junction City Directories. Obituary Index. Grand Junction Historical Survey, 1981. Museum of Western Colorado Research Library: "Who's Who in Colorado, 1938."

SIGNIFICANCE (check appropriate categories)

Architectural significance:
 represents the work of a master
 possess high artistic value
 represents a type, period, or method of construction

Historical significance:
 associated with significant person(s)
 associated with significant event
 associated with a pattern of events
 contributes to an historic district

National Register eligibility:

Individual yes no
Criteria: A B C D

Area(s) of significance: Architecture

Contributes to a potential district:

yes no

District name:

THEME(S):

Period of significance: 1911

STATEMENT OF SIGNIFICANCE (briefly justify the significance checked above): The gable on the hip roof, filled with a ventilator is unusual. The new siding is too wide to be appropriate for a bungalow. Although not eligible for the National Register, this house may contribute to a local register.

INVENTORY COMPLETED BY: Museum Group Staff

DATE: 5/31/96

AFFILIATION: Museum of Western Colorado

PHONE: (970) 241-9117

ADDRESS: PO Box 20000-5020, Grand Junction, Colorado 81502-5020

PROJECT NAME: Grand Junction Historic Resources Survey, Phase 2



945 Chipeta Ave. , Grand Junction, Mesa Co, CO

2945-141-33-006

02/29/1996

Roll 33 Frame 21 View N Dir SE

5ME 8414



945 Chipeta Ave., Grand Junction, Mesa Co, CO
2945-141-33-006 02/29/1996
Roll 33 Frame 21 View N Dir SE
SME 8414