

COLORADO HISTORICAL SOCIETY
Office of Archaeology and Historic Preservation
1300 Broadway Denver, CO 80203

HISTORIC BUILDING INVENTORY

SITE NO.: 5ME8416

Eligible for National Register yes no
date _____ initials _____
Criteria A B C D
Contributes to a potential National Register district
 yes no district name: _____

Eligible for State Register yes no
date _____ initials _____
Criteria a b c d e
Areas of significance: _____

COUNTY: Mesa

CITY: Grand Junction

Period of significance _____
Needs data date _____ initials _____

HISTORIC BUILDING NAME: The house at 815 Chipeta Avenue

CURRENT BUILDING NAME: Howe Residence

LOCAL LANDMARK DESIGNATION: [] yes [] no

Date of designation: N/A
Designating authority: N/A

ADDRESS: 815 Chipeta Ave., Grand Junction, CO 81501-3347

P.M.: UTE township: 1S range:1W
NW ¼ of SE ¼ of SW¼ of NE¼ of section 14

OWNER NAME & ADDRESS: Cindi S. Howe, 815 Chipeta Ave., Grand Junction, CO 81501-3347

UTM REFERENCE-12
Easting: 711220
Northing: 4327440

USGS QUAD NAME: Grand Junction

Year: 1962; photorevised 1973 [] 7.5' [] 15'

STYLE: Vernacular Wood Frame

Block: 63
Lot(s): 3 and 4
Addition:
Year of addition:

BUILDING TYPE:

[] original location [] moved
Date of moves(s):

MATERIALS: Concrete Foundation - Wood Frame - Vinyl Siding - Asphalt Shingle Roof

HISTORIC USE: Domestic
PRESENT USE: Domestic

STORIES: 1

SQUARE FOOTAGE: 1100

DATE OF CONSTRUCTION- estimate: 1910 actual:
Source of information: Tax Assessor's Records

PLAN SHAPE:

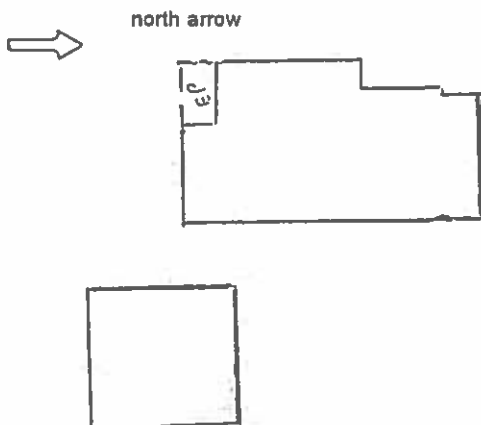

ARCHITECT: Unknown
Source of information:

BUILDER/CONTRACTOR: Unknown
Source of information:

ORIGINAL OWNER: Ora Reames
Source of information: Lot and Block Books

ASSOCIATED BUILDINGS- [] yes [] no
Type: 2 Car Garage

ARCHITECTURAL DESCRIPTION: Two story with front gable. Concrete block foundation. Concrete steps and stoop have a wrought iron railing. Hip roof wraparound porch across the facade and half the east elevation, is now enclosed. Siding on half-wall and piers. On the facade are two large single lights, each flanked by metal frame single light sliding windows. On east and west ends of the porch are pairs of metal frame sliders. Storm door has a sidelight. Front door inside the porch is flush. Other windows on the first floor are double hung, wood sash, one-over-one. Windows on the new second floor are pairs of single lights in metal frames. Storm windows have vinyl frames. Siding is grained, buff vinyl clapboards, slightly flared near the base. Door and window surrounds, corner boards, string course, frieze and cornices are olive, with a russet stripe on frieze and cornice. Gray composition shingle roof. Gabled wing on facade has a louvered metal ventilator.

Lawn with evergreens across the porch facade. Large fir on the west lawn. Blue ash trees on parking area. White picket fence around the backyard. Two car garage at rear with front gable, gray composition shingle roof, vertical yellow wood siding, and paneled metal doors.

PHOTOGRAPHS (include photographs showing each side of building and any associated buildings)

Film roll no.: 34

Negative no.: 1

Photographer: Carolyn Howard

Location of negatives: City Of Grand Junction

CONSTRUCTION HISTORY (include description and dates of major additions, alterations, or demolitions): Second story addition, siding, porch glazing, storm door and windows.

HISTORICAL BACKGROUND (discuss important persons and events associated with this building): Ora Reams, a meatcutter for Cassells and Company, was the original owner/occupant, ca. 1910. He is listed only in the 1909 City Directories as living in the house. Florence and Robert Raines, a foreman with the Denver and Rio Grande Railway, were the owners/occupants, ca. 1920-1924. Dorothy and Howard DeMarais (sp?), a salesman, were the owners/occupants, ca. 1925-1929. F. R. and Clara Ward were the absentee owners, ca. 1930-1946. Jason and Mabel McKay, a clerk with Railway Express, were the renters, ca. 1931-1935, Bruce and Elizabeth Angus, a postal clerk, ca. 1939-1942, and Dwight and Lillian Fisher, a driver with Sinclair Refinery, ca. 1946.

INFORMATION SOURCES (be specific): Plat Map, Appraisal Card, Lot and Block Books, Grand Junction City Directories, Grand Junction Historic Resource Survey, 1981.

SIGNIFICANCE (check appropriate categories)

Architectural significance:

represents the work of a master

possess high artistic value

represents a type, period, or method of construction

Historical significance:

associated with significant person(s)

associated with significant event

associated with a pattern of events

contributes to an historic district

National Register eligibility:

Individual yes no

Criteria: A B C D

Area(s) of significance: Architecture

Contributes to a potential district:

yes no

District name:

THEME(S):

Period of significance: 1910

STATEMENT OF SIGNIFICANCE (briefly justify the significance checked above): This 1900 house was originally a one story Queen Anne with a wraparound porch. It now has a second story with metal frame windows, modern siding and reflects no particular style. Although not eligible for the National Register, this house may contribute to a local register.

INVENTORY COMPLETED BY: Museum Group Staff

DATE: 5/31/96

AFFILIATION: Museum of Western Colorado

PHONE: (970) 241-9117

ADDRESS: PO Box 20000-5020, Grand Junction, Colorado 81502-5020

PROJECT NAME: Grand Junction Historic Resources Survey, Phase 2





815 Chipeta Ave., Grand Junction, Mesa Co, CO
2945-141-34-003 02/29/1996
Roll 34 Frame 1 View N Dir SW
SME 8416