

COLORADO HISTORICAL SOCIETY
 Office of Archaeology and Historic Preservation
 1300 Broadway Denver, CO 80203

HISTORIC BUILDING INVENTORY

SITE NO.: 5ME8418

Eligible for National Register yes no
 date _____ initials _____
 Criteria A B C D
 Contributes to a potential National Register district
 yes no district name: _____

Eligible for State Register yes no
 date _____ initials _____
 Criteria a b c d e
 Areas of significance: _____

COUNTY: Mesa

CITY: Grand Junction

Period of significance _____
 Needs data date _____ initials _____

HISTORIC BUILDING NAME: McClintock, Frank and Fannie, House

CURRENT BUILDING NAME: Hardy Residence

LOCAL LANDMARK DESIGNATION: yes no

Date of designation: N/A
 Designating authority: N/A

ADDRESS: 802 Ouray Ave., Grand Junction, CO 81501-3328

P.M.: UTE township: 1S range:1W
 NW ¼ of SE ¼ of SW¼ of NE¼ of section 14

OWNER NAME & ADDRESS: Charles D. Hardy, 802 Ouray Ave., Grand Junction, CO 81501-3328

UTM REFERENCE-12
 Easting: 711025
 Northing: 4327380

USGS QUAD NAME: Grand Junction

Year: 1962; photorevised 1973 7.5' 15'

STYLE: Craftsman

Block: 63
 Lot(s): 31 - 32
 Addition:
 Year of addition:

BUILDING TYPE:

original location moved
 Date of moves(s):

MATERIALS: Concrete Foundation - Wood Frame - Asphalt Shingle Roof

HISTORIC USE: Domestic
 PRESENT USE: Domestic

STORIES: 2

SQUARE FOOTAGE: 1032

DATE OF CONSTRUCTION- estimate: 1909 actual:
 Source of information: Tax Assessor's Records

PLAN SHAPE:

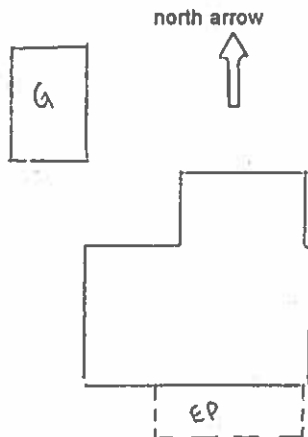

ARCHITECT: Unknown

Source of information:

BUILDER/CONTRACTOR: Unknown

Source of information:

ORIGINAL OWNER: Frank and Fannie McClintock

Source of information: Lot and Block Books

ASSOCIATED BUILDINGS- yes no

Type: Garage

ARCHITECTURAL DESCRIPTION: One and a half story with side gables. Concrete flared foundation. Concrete steps and piers, with wrought iron railings, lead up to sunporch/entry with shed roof extending across the east two thirds of the facade. Board and batten siding of unfinished wood on half-wall. Squared, half columns are on the porch front corners. Porch glazing is ribbons of wood casement windows, with a transom of three over one. The wood porch door has the same glazing. Windows around the house are varied. Many windows are pairs of wood casements, twenty-four small lights in each casement. Replacement windows are pairs of single light casements, in brown vinyl frames. Rear elevation windows are double hung, wood sash, one-over-one. Hip roof projecting bay is on the west elevation. Siding is buff lapped vinyl. Door and window surrounds, bargeboards, foundation, steps and corner boards are brown. Brown composition shingle roof. Eaves are boxed with bargeboards. A gabled wall dormer on the east and west. Between them, in the center of the facade, is a shed roof wall dormer. Porch roof has a pedimented cross gable on the west half, over the entry. The gable face siding is board and batten. On the east side of the north elevation is a gabled two story wing. Brick chimney with metal cap on the north slope. On the east elevation is a new full height chimney, skirted with unfinished board and batten wood.

Lawn with large arborvitae flanking the steps. Many trees and spirea are on the lawn. Ash, elm, poplar and pine trees on parking area. A high, wood fence is around the backyard.

One car garage at rear with front gable, gray composition shingle roof, buff false bevel, wood siding, and batten door.

PHOTOGRAPHS (include photographs showing each side of building and any associated buildings)

Film roll no.: 34

Negative no.: 4

Photographer: Carolyn Howard

Location of negatives: City Of Grand Junction

CONSTRUCTION HISTORY (include description and dates of major additions, alterations, or demolitions): Siding. Siding on porch, new chimney on east elevation and vinyl frame windows. Re-roofed in 1985.

HISTORICAL BACKGROUND (discuss important persons and events associated with this building): Fannie and Frank McClintock, were the absentee owners, ca. 1909-1921, and the first occupants, ca. 1922. H. Burton and Eva Ennor, a stockman, were the owners/occupants, ca. 1926-1941. Andrew and Lillian Jarvis were owners/occupants, ca. 1946.

INFORMATION SOURCES (be specific): Plat Map, Appraisal Card, Lot and Block Books, Grand Junction City Directories. Grand Junction Historic Resource Survey, 1981.

SIGNIFICANCE (check appropriate categories)

Architectural significance:

represents the work of a master

possess high artistic value

represents a type, period, or method of construction

Historical significance:

associated with significant person(s)

associated with significant event

associated with a pattern of events

contributes to an historic district

National Register eligibility:

Individual yes no

Criteria: A B C D

Area(s) of significance: Architecture

Contributes to a potential district:

yes no

District name:

THEME(S):

Period of significance: 1909

STATEMENT OF SIGNIFICANCE (briefly justify the significance checked above): This house still has certain Craftsman details, despite remodeling. Although not eligible for the National Register, this house may contribute to a local register.

INVENTORY COMPLETED BY: Museum Group Staff

DATE: 5/31/96

AFFILIATION: Museum of Western Colorado

PHONE: (970) 241-9117

ADDRESS: PO Box 20000-5020, Grand Junction, Colorado 81502-5020

PROJECT NAME: Grand Junction Historic Resources Survey, Phase 2



802 Ouray Ave., Grand Junction, Mesa Co, CO

2945-141-34-010 02/29/1996

Roll 34 Frame 4 View S Dir N/NE

SmE 8418



802 Ouray Ave., Grand Junction, Mesa Co, CO
2945-141-34-010 02/29/1996
Roll 34 Frame 4 View S Dir N/NE
5ME8418