

**COLORADO HISTORICAL SOCIETY**  
 Office of Archaeology and Historic Preservation  
 1300 Broadway Denver, CO 80203

**HISTORIC BUILDING INVENTORY**

SITE NO.: 5ME8419

Eligible for National Register  yes  no  
 date \_\_\_\_\_ initials \_\_\_\_\_

Criteria  A  B  C  D

Contributes to a potential National Register district  
 yes  no district name: \_\_\_\_\_

Eligible for State Register  yes  no  
 date \_\_\_\_\_ initials \_\_\_\_\_

Criteria  a  b  c  d  e

Areas of significance: \_\_\_\_\_

Period of significance \_\_\_\_\_  
 Needs data  date \_\_\_\_\_ initials \_\_\_\_\_

LOCAL LANDMARK DESIGNATION:  yes  no

Date of designation: N/A  
 Designating authority: N/A

P.M.: UTE township: 1S range: 1W  
 NW 1/4 of SE 1/4 of SW 1/4 of NE 1/4 of section 14

UTM REFERENCE-12  
 Easting: 711220  
 Northing: 4327380

USGS QUAD NAME: Grand Junction

Year: 1962; photorevised 1973  7.5'  15'

Block: 63  
 Lot(s): 29 and 30  
 Addition:  
 Year of addition:

original location  moved

Date of moves(s): \_\_\_\_\_

HISTORIC USE: Domestic

PRESENT USE: Domestic

COUNTY: Mesa

CITY: Grand Junction

HISTORIC BUILDING NAME: Schultz, Naomi and William, House

CURRENT BUILDING NAME:

ADDRESS: 810 Ouray Ave., Grand Junction, CO 81501

OWNER NAME & ADDRESS: William F. Schultz, Jr., 1409 Mesa Ave., Grand Junction, CO 81501-7633

STYLE: Bungalow

BUILDING TYPE:

MATERIALS: Concrete Pier Foundation - Wood Frame - Asphalt Shingle Roof

STORIES: 1

SQUARE FOOTAGE: 1124

DATE OF CONSTRUCTION- estimate: 1922 actual:  
 Source of information: Tax Assessor's Records

PLAN SHAPE:

north arrow

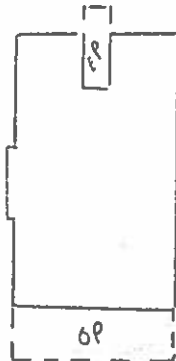

ARCHITECT: Unknown

Source of information:

BUILDER/CONTRACTOR: Unknown

Source of information:

ORIGINAL OWNER: R.T. Hogan

Source of information: Lot and Block Books

ASSOCIATED BUILDINGS-  yes  no

Type: Garage

**ARCHITECTURAL DESCRIPTION:** One story with side gable roof. The foundation is skirted with siding. Wood steps lead up to full width, open porch extending across facade under the principal roof. Siding on half-wall. Four, full height red brick piers are across the porch facade. Door is paneled with three vertical lights and with a metal frame storm door. Windows are double hung, wood sash, one-over-one. Two, one-over-one, transom windows on facade. On the west elevation is a shed roof projecting bay. Storm windows have metal frames. Buff vinyl siding, in simple drop configuration. Door and window surrounds, corner boards, bargeboards and knee braces are brown. Gray composition shingle roof. Vinyl siding on windowless shed roof dormer on facade. Brick chimney on the north slope.

Lawn with arborvitae on both sides of the facade. A blue ash tree and a sapling on parking area. Wood fence around the yard. One car garage at rear with front gable, brown roll composition roofing, brown lapped wood siding, and batten doors.

**PHOTOGRAPHS** (include photographs showing each side of building and any associated buildings)

Film roll no.: 34  
Negative no.: 5

Photographer: Carolyn Howard  
Location of negatives: City Of Grand Junction

**CONSTRUCTION HISTORY** (include description and dates of major additions, alterations, or demolitions): Vinyl siding, storm doors and windows. Basement wall replaced, 1983. Additional construction or modifications not noted in Assessor's records.

**HISTORICAL BACKGROUND** (discuss important persons and events associated with this building): R. T. Hogan (sp?) was the first owner, ca. 1923-1927, and Nellie and Leo Krueger, a plant chief with Mountain States Telephone and Telegraph Company, the tenants, ca. 1926. Naomi and William Schultz, a railroader, were owners/occupants, ca. 1928-1947.

**INFORMATION SOURCES** (be specific): Plat Map, Appraisal Card, Lot and Block Books, Grand Junction City Directories. Grand Junction Historic Resource Survey, 1981.

**SIGNIFICANCE** (check appropriate categories)

**Architectural significance:**

represents the work of a master

possess high artistic value

represents a type, period, or method of construction

**Historical significance:**

associated with significant person(s)

associated with significant event

associated with a pattern of events

contributes to an historic district

**National Register eligibility:**

Individual  yes  no

Criteria:  A  B  C  D

Area(s) of significance: Architecture

Contributes to a potential district:

yes no

District name:

**THEME(S):**

Period of significance: 1922

**STATEMENT OF SIGNIFICANCE** (briefly justify the significance checked above): The full height brick piers are seldom seen on Bungalows. The new vinyl siding is a style that is appropriate. Although not eligible for the National Register, this house may contribute to a local register.

**INVENTORY COMPLETED BY:** Museum Group Staff

**DATE:** 5/31/96

**AFFILIATION:** Museum of Western Colorado

**PHONE:** (970) 241-9117

**ADDRESS:** PO Box 20000-5020, Grand Junction, Colorado 81502-5020

**PROJECT NAME:** Grand Junction Historic Resources Survey, Phase 2



810 Ouray Ave., Grand Junction, Mesa Co, CO

2945-141-34-011

02/29/1996

Roll 34 Frame 5 View S Dir N/NE

5mE8419



810 Ouray Ave. , Grand Junction, Mesa Co, CO  
2945-141-34-011 02/29/1996  
Roll 34 Frame 5 View S Dir N/NE  
57E8419