

DATE SUBMITTED: 10-15-85

PERMIT # _____

FEE 5.00

FENCE PERMIT

GRAND JUNCTION PLANNING DEPARTMENT

BLDG ADDRESS: 1828 N. 20th

TAX SCHEDULE #: 2945-124-04-005

PROPERTY OWNER: Dan Jackson

PHONE: 241-9644

CONTRACTOR: J&S Fence Co. Inc.

PHONE: 243-2723

MATERIAL: redwood

HEIGHT: 6'

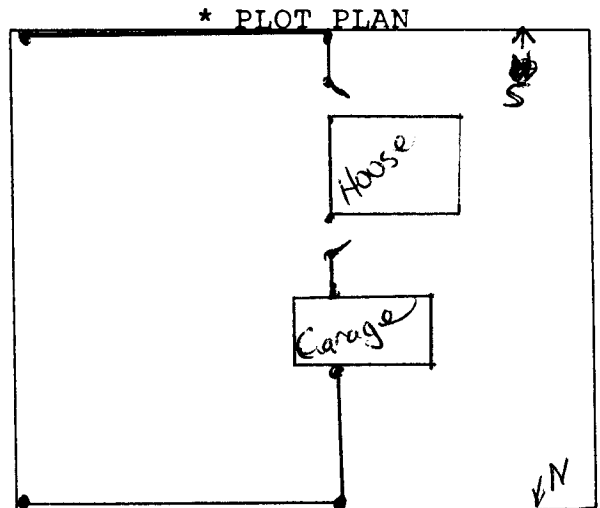

*Showing Property Line Dimensions, Easements, Streets, all Structures, and Setbacks from Property Lines.

FOR OFFICE USE ONLY

ZONE: RSF-8

SETBACKS: F S 0 R 0

SPECIAL CONDITIONS: _____



FINAL PERMIT



WILL REQUIRE SEPARATE PERMIT FROM THE CITY/COUNTY BUILDING DEPARTMENT.

ANY MODIFICATION TO THIS APPROVED FENCE PERMIT MUST BE APPROVED, IN WRITING, BY THIS DEPARTMENT.

I HEREBY ACKNOWLEDGE THAT I HAVE READ THIS APPLICATION AND THE ABOVE IS CORRECT, AND I AGREE TO COMPLY WITH THE REQUIREMENTS ABOVE. FAILURE TO COMPLY SHALL RESULT IN LEGAL ACTION.

Linda Westzel
SIGNATURE

APPROVED BY: Linda Westzel (DW)

DATE APPROVED: 10-15-85